

ROUTE	SECTION	COUNTY	TOTAL SHEETS	SHEET NUMBER
VARIOUS	2008-020 PP	LAKE	59	1

STATE OF ILLINOIS
DEPARTMENT OF TRANSPORTATION
DIVISION OF HIGHWAYS
DISTRICT ONE
PROPOSED HIGHWAY PLANS

CONTRACT NO. 60E49

D-91-413-08

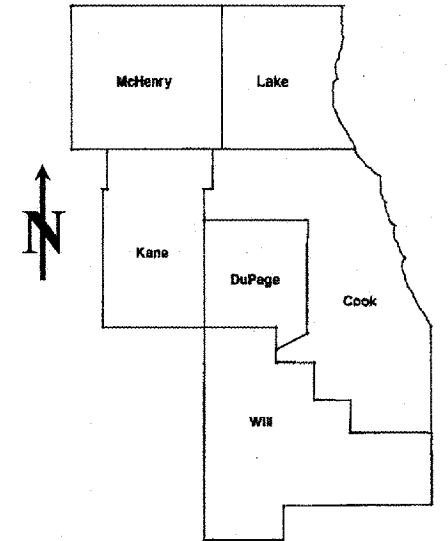

LOCATION OF IMPROVEMENT INDICATED THUS:

FOR INDEX OF SHEETS SEE SHEET 2

VARIOUS ROUTES
 SECTION: 2008-020 PP
 VARIOUS LOCATIONS IN WEST LAKE COUNTY
 PAVEMENT PATCHING
 LAKE COUNTY
 C-91-413-08

DISTRICT ONE - DESIGN - PLAN PREPARATION ENGINEER:
 KEN ENG / (847) 705-4247

CONTRACT NO. 60E49

STATE OF ILLINOIS DEPARTMENT OF TRANSPORTATION DIVISION OF HIGHWAYS
SUBMITTED: <u>APRIL 11, 2008</u> DEPUTY DIRECTOR OF HIGHWAYS, REGION ENGINEER
<u>April 18, 2008</u> INTERIM ENGINEER OF DESIGN AND ENVIRONMENT
<u>April 18, 2008</u> DIRECTOR, DIVISION OF HIGHWAYS

PRINTED BY THE AUTHORITY
OF THE STATE OF ILLINOIS

J.U.L.I.E.: JOINT UTILITY LOCATION
INFORMATION FOR EXCAVATION
(312) 744-7000

INDEX OF SHEETS

<u>SHEET NO.</u>	<u>DESCRIPTION</u>
1	TITLE SHEET
2	INDEX OF SHEETS, STATE STANDARDS AND GENERAL NOTES
3	SUMMARY OF QUANTITIES
4	GENERAL LOCATION MAP
5	SUMMARY OF PATCHING SCHEDULE
6-52	PATCHING SCHEDULE
53	SPECIAL DETAIL FOR PAVEMENT PATCHING FOR HMA SURFACED PAVEMENT
54	BUTT JOINT AND HMA TAPER DETAILS
55	TYPICAL APPLICATIONS: RAISED REFLECTIVE PAVEMENT MARKERS (SNOW-PLOW RESISTANT)
56	DISTRICT ONE TYPICAL PAVEMENT MARKINGS
57	TRAFFIC CONTROL AND PROTECTION OF TURN BAYS (TO REMAIN OPEN TO TRAFFIC)
58	ARTERIAL ROAD INFORMATION SIGN
59	TRAFFIC CONTROL AND PROTECTION FOR SIDE ROADS, INTERSECTIONS AND DRIVEWAYS

STATE STANDARDS

<u>STANDARD NO.</u>	<u>DESCRIPTION</u>
000001-05	TYPICAL SYMBOLS, ABBREVIATIONS AND PATTERNS
442201-03	CLASS C AND D PATCHES
701201-02	LANE CLOSURE, 2L, 2W, DAY ONLY
701306-01	LANE CLOSURE, 2L, 2W, SLOW MOVING OPERATIONS - DAY ONLY
701336-04	LANE CLOSURE, 2L, 2W, WORK AREAS IN SERIES
701501-04	URBAN LANE CLOSURE, 2L, 2W, UNDIVIDED
701601-05	URBAN LANE CLOSURE, MULTILANE, 1W OR 2W WITH NONTRAVERSABLE MEDIAN
701606-05	URBAN LANE CLOSURE, MULTILANE, 2W WITH MOUNTABLE MEDIAN
701701-05	URBAN LANE CLOSURE, MULTILANE INTERSECTION
701901	TRAFFIC CONTROL DEVICES

THE PAY ITEM "MIXTURE FOR CRACKS, JOINTS AND FLANGWAYS" SHALL BE USED IN AREAS WHERE THE EXISTING CRACK IS 2 INCHES OR LESS. THE CONTRACTOR SHALL CLEAN OUT ALL DEBRIS FROM THE CRACK. THE CLEAN OUT WORK SHALL BE INCLUDED IN THE COST OF "MIXTURE FOR CRACKS, JOINTS AND FLANGWAYS". THE ENGINEER SHALL DETERMINE THE LOCATIONS FOR THE PLACEMENT OF THE "MIXTURE FOR CRACKS, JOINTS AND FLANGWAYS".

GENERAL NOTES

BEFORE STARTING ANY EXCAVATION, THE CONTRACTOR SHALL CALL "JULIE" AT (800) 892-0123 OR 811 FOR FIELD LOCATIONS OF BURIED ELECTRIC, TELEPHONE AND GAS FACILITIES. (48 HOUR NOTIFICATION REQUIRED)

THE CONTRACTOR WILL NOT BE ALLOWED TO SET UP A YARD OR FIELD OFFICE ON STATE (OR TOLLWAY) PROPERTY WITHOUT WRITTEN PERMISSION FROM THE DEPARTMENT (OR ISTHA)

WHEN ARTIFICIAL LIGHTING IS UTILIZED IN NIGHT OPERATIONS, THE CONTRACTOR SHALL EXERCISE THE UTMOST PRECAUTIONS IN PREVENTING ADVERSE VISIBILITY TO THE MOTORING PUBLIC AND ADJOINING RESIDENTIAL AREAS.

ANY PAVEMENT MARKINGS AND RAISED REFLECTIVE PAVEMENT MARKERS OBLITERATED BY MILLING AND RESURFACING OPERATIONS ON SIDE STREETS AND ENTRANCES SHALL BE REPLACED AND PAID FOR IN KIND.

BEFORE BEGINNING ANY WORK, THE CONTRACTOR SHALL RETAIN AND RECORD FOR FUTURE REFERENCE, ALL EXISTING PAVEMENT MARKING LINES (AND RAISED REFLECTIVE PAVEMENT MARKERS) IN ORDER THAT THESE LOCATIONS CAN BE RE-ESTABLISHED FOR STRIPING. EXACT LOCATIONS OF ALL PAVEMENT MARKINGS SHALL BE AS DIRECTED BY THE ENGINEER.

ALL PAVEMENT PATCHING LOCATIONS WILL BE DETERMINED IN THE FIELD BY THE ENGINEER.

THE CONTRACTOR SHALL CONTACT THE DISTRICT ONE TRAFFIC CONTROL SUPERVISOR AT (847) 705-4470 A MINIMUM OF 72 HOURS IN ADVANCE OF BEGINNING WORK.

THE ENGINEER SHALL CONTACT MS. DEBBIE HANLON, AREA TRAFFIC FIELD ENGINEER AT (815) 438-2300 MINIMUM OF TWO (2) WEEKS PRIOR TO PLACEMENT OF PERMANENT PAVEMENT MARKINGS.

DOUBLE LANE MARKERS ARE TO BE USED AS SHOWN ON THE DISTRICT ONE DETAIL "TYPICAL APPLICATIONS - RAISED REFLECTIVE PAVEMENT MARKERS (SNOW-PLOW RESISTANT)" SHOWN IN THE PLANS.

THE EXISTING ROADWAY TYPICAL SECTION IS ASSUMED TO HAVE A 3 INCH HOT-MIX ASPHALT OVERLAY ON TOP OF A TEN INCH CONCRETE BASE.

ALL MILLING AREAS AS NOTED ON THE INDIVIDUAL PATCHING SCHEDULES WITH A PATCH WIDTH OF 3 FEET OR LESS AND PATCH LENGTH OF 25 FEET OR MORE SHALL BE PAID FOR AS HOT-MIX ASPHALT SURFACE REMOVAL (SPECIAL).

THE COST OF TRAFFIC CONTROL AND PROTECTION FOR THE PROJECT SHALL BE INCLUDED IN THE COST OF THE ASSOCIATED ROAD WORK.

HOT-MIX ASPHALT MIXTURE REQUIREMENTS

MIXTURE TYPE	AC TYPE	AIR VOIDS (%)
HOT-MIX ASPHALT SURFACE COURSE, MIX "D", N70 (IL 9.5 MM)	PG 64-22	4% @ 70 GYR
LEVELING BINDER (MM), N70	PG 64-22/58-22	4% @ 70 GYR
CLASS D PATCHES, (HMA BINDER IL-19.0 MM)	PG 64-22 *	4% @ 70 GYR
HOT-MIX ASPHALT REPLACEMENT OVER PATCHES, (HMA BINDER IL-19.0 MM)	PG 64-22 *	4% @ 70 GYR
TOP 1 1/2 INCH OF REPLACEMENT OVER PATCHES: [HMA SURFACE COURSE, MIX "D", N70 (IL 9.5 MM)]	PG 64-22	4% @ 70 GYR

THE UNIT WEIGHT USED TO CALCULATE ALL HOT-MIX ASPHALT SURFACE MIXTURE QUANTITIES IS 112 LBS/SY/IN.

* WHEN RAP EXCEEDS 20%, THE NEW ASPHALT BINDER IN THE MIX SHALL BE PG 58-22

F.A.P. RTE.	SECTION	COUNTY	TOTAL SHEETS	SHEET NO.
VAR.	2008-020 PP	LAKE	59	3
FED. ROAD DIST. NO. 1		ILLINOIS	HIGHWAY PROJECT	

CONTRACT NO. 60E49

SUMMARY OF QUANTITIES			URBAN 100% STATE	CONSTRUCTION TYPE CODE				
CODE NO	ITEM	UNIT	TOTAL QUANTITIES	1000				
40600200	BITUMINOUS MATERIALS (PRIME COAT)	TON	10	10				
40600300	AGGREGATE (PRIME COAT)	TON	47	47				
40600400	MIXTURE FOR CRACKS, JOINTS, AND FLANGEWAYS	TON	23	23				
40600635	LEVELING BINDER (MACHINE METHOD), N70	TON	395	395				
40600982	HOT-MIX ASPHALT SURFACE REMOVAL - BUTT JOINT	SO YD	1761	1761				
40601005	HOT-MIX ASPHALT REPLACEMENT OVER PATCHES	TON	2400	2400				
40603340	HOT-MIX ASPHALT SURFACE COURSE, MIX "D", N70	TON	1960	1960				
44000158	HOT-MIX ASPHALT SURFACE REMOVAL, 2 1/4"	SO YD	9382	9382				
44000196	HOT-MIX ASPHALT SURFACE REMOVAL, SPECIAL	SO YD	12982	12982				
44002212	HOT-MIX ASPHALT REMOVAL OVER PATCHES, 3"	SO YD	14288	14288				
44201761	CLASS D PATCHES, TYPE I, 10 INCH	SO YD	2209	2209				
44201765	CLASS D PATCHES, TYPE II, 10 INCH	SO YD	9483	9483				
44201769	CLASS D PATCHES, TYPE III, 10 INCH	SO YD	726	726				
44201771	CLASS D PATCHES, TYPE IV, 10 INCH	SO YD	571	571				
67000400	ENGINEER'S FIELD OFFICE, TYPE A	CAL MO	3	3				
67100100	MOBILIZATION	L SUM	1	1				
* 78000200	THERMOPLASTIC PAVEMENT MARKING - LINE 4"	FOOT	58120	58120				
* 78100100	RAISED REFLECTIVE PAVEMENT MARKER	EACH	1406	1406				
78300200	RAISED REFLECTIVE PAVEMENT MARKER REMOVAL	EACH	1406	1406				
X0322256	TEMPORARY INFORMATION SIGNING	SO FT	1080	1080				

SUMMARY OF QUANTITIES			CONSTRUCTION TYPE CODE					
CODE NO	ITEM	UNIT	TOTAL QUANTITIES	1000-2A				

* SPECIALTY ITEM

REVISIONS	
NAME	DATE

ILLINOIS DEPARTMENT OF TRANSPORTATION
SUMMARY OF QUANTITIES

PLOT DATE: 4/11/2008

4/11/2008 11:46:10 AM User:wjgreend

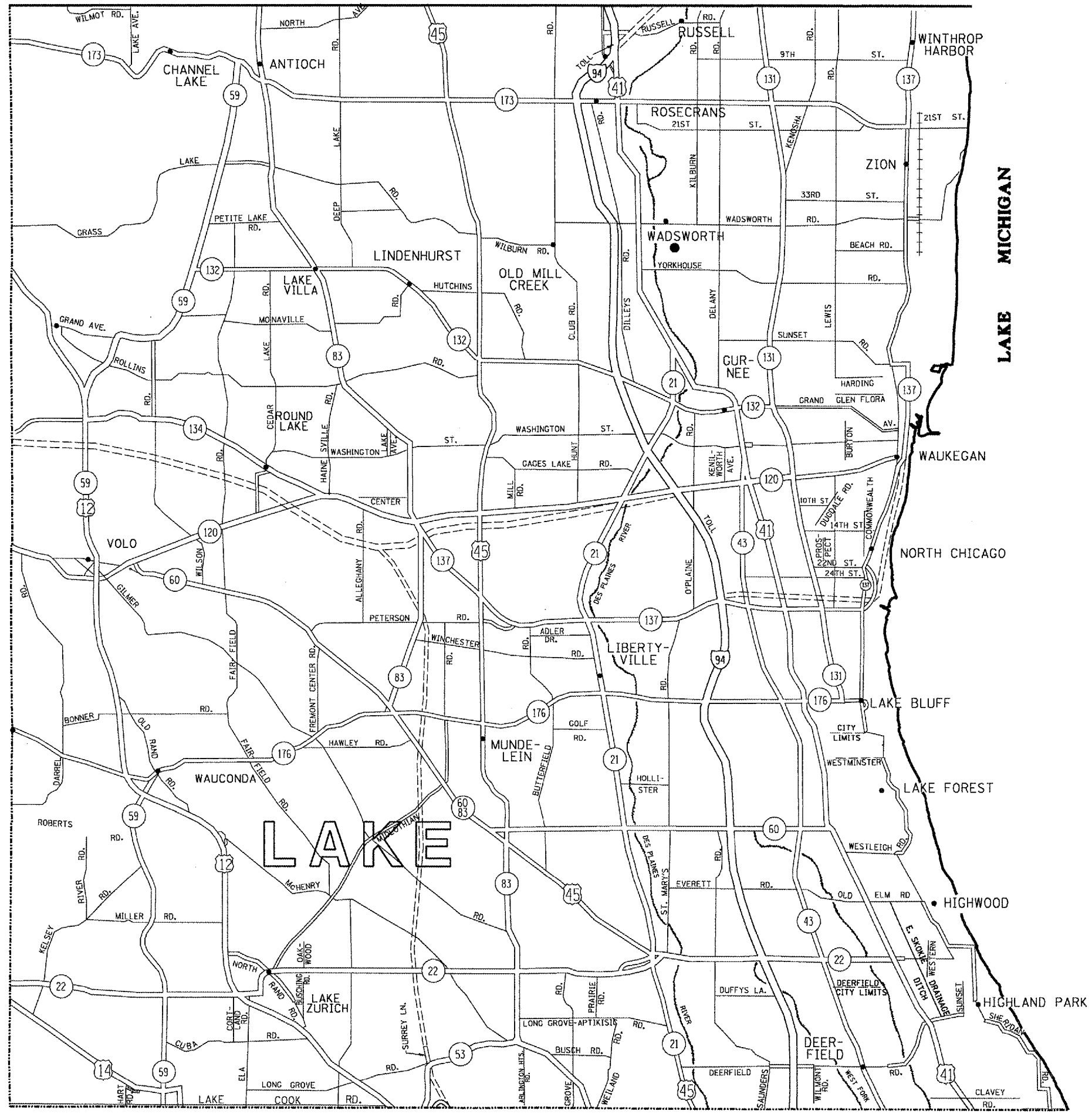

FILE NAME = c:\projects\dl36000\design_aa.dgn
 USER NAME = wilgreendp
 PLOT SCALE = 100.0000' / IN.
 PLOT DATE = 4/11/2008

DESIGNED -	REVISED -
DRAWN -	REVISED -
CHECKED -	REVISED -
DATE -	REVISED -

**STATE OF ILLINOIS
 DEPARTMENT OF TRANSPORTATION**

GENERAL LOCATION MAP - LAKE COUNTY

SCALE: SHEET NO. OF SHEETS STA. TO STA.

F.A. RTE.	SECTION	COUNTY	TOTAL SHEETS	SHEET NO.
VAR.	2008-020 PP	LAKE	59	4
CONTRACT NO. 60E49				
FED. ROAD DIST. NO. 1 (ILLINOIS) FED. AID PROJECT				

WEST LAKE COUNTY ROUTE SEGMENT	HMA SURF REM 2-1/4" & RESURF (SY)	HMA SURF REM (SP) & RESURF (SY)	CLASS D PATCH TYPE I (SY)	CLASS D PATCH TYPE II (SY)	CLASS D PATCH TYPE III (SY)	CLASS D PATCH TYPE IV (SY)	PAVT MARKING 4" (FT)	RAISED REFL PAVT MKS (EACH)
IL 53 (Hicks Rd.)	0	71	115	134	0	0	350	10
IL RTE 59 (EXIT RAMP- NORTH OF IL 134) FROM US 12 TO IL 173	0	615	0	347	0	0	4900	68
IL 59	580	345	136	173	0	0	1500	30
IL 60 (Peterson Road to IL 83 and IL 83 to IL 21)	13	191	35	78	76	0	450	8
IL 60/ 83	44	250	76	59	0	0	500	10
IL RTE 60 (PETERSON ROAD TO IL RTE 120)	589	183	0	565	0	0	5500	54
IL Rte 83	5044	557	0	916	0	0	2500	50
IL 83 (Peterson Road to IL 60 and IL 60 to Lake Cook Road)	88	917	116	117	0	0	400	40
IL RTE 120 (MILL ROAD TO US 12 / IL RTE 59)	479	695	0	516	0	0	3048	22
IL RTE 132 (GRAND AVENUE) - FROM U.S. ROUTE 45 TO IL ROUTE 59	319	211	35	692	87	0	1000	20
IL RTE 134 (IL RTE 120 TO US 12 / IL 59)	0	33	0	110	0	0	270	6
IL RTE 173 (Old Mill Creek Road to IL RTE 83)	729	393	0	664	20	133	2800	60
IL RTE 173, (IL RTE 83 to FOX RIVER BRIDGE)	0	66	11	32	0	77	190	10
IL 176 (IL 21 to Roberts Road (McHenry County Line))	366	441	188	143	61	0	2200	42
IL Rte 176 (Old Rockland Rd to EJ & E Railroad)	33	1243	150	82	20	0	1650	34
Midlothian Road (IL 176 to IL 22)	111	240	104	32	0	93	1300	14
Lake Cook Road	521	10	132	241	78	108	812	40
US 12	337	4967	612	1891	348	80	13200	600
US 14	96	33	383	841	0	0	1200	60
US 45 (STATE LINE ROAD TO PETERSON ROAD)	33	1192	4	1585	20	80	13700	200
US 45 (Peterson Road to IL 83 and IL 83 to IL 21)	0	275	112	265	16	0	650	28
SUMMARY TOTALS:	9382	12928	2209	9483	726	571	58120	1406
	SY	SY	SY	SY	SY	SY	FT	EACH

NOTE:

ALL MILLING AREAS AS NOTED ON THE INDIVIDUAL PATCHING SCHEDULES WITH A PATCH WIDTH OF 3 FEET OR LESS AND PATCH LENGTH OF 25 FEET OR MORE SHALL BE PAID FOR AS HOT-MIX ASPHALT SURFACE REMOVAL (SPECIAL).

FILE NAME = c:\projects\dl36008\design_aa.dgn	USER NAME = wjgreendp	DESIGNED -	REVISED -	STATE OF ILLINOIS DEPARTMENT OF TRANSPORTATION	SUMMARY OF PATCHING SCHEDULE LAKE COUNTY				F.A.P. RTE.	SECTION	COUNTY	TOTAL SHEETS	SHEET NO.
PLOT SCALE = 1/8" = 100.0000' / IN.	CHECKED -	REVISED -	REVISED -		SCALE:	SHEET NO.	OF	SHEETS	STA.	TO STA.	LAKE	59	5
PLOT DATE = 4/11/2008	DATE -	REVISED -	REVISED -		CONTRACT NO. 60E49								

ROUTE: US 12

CROSS STREETS		DIRECTION (EB/WB) (NB/SB)	LANE NO. (1, 2, 3)	PAVEMENT PATCH WIDTH	PAVEMENT PATCH LENGTH	REPAIR AREA (SQ FT)	REPAIR AREA (SQ YD)	HMA SURF REM 2-1/4" & RESURF	HMA SURF REM (SP) & RESURF	CLASS D PATCH TYPE I	CLASS D PATCH TYPE II	CLASS D PATCH TYPE III	CLASS D PATCH TYPE IV	PAVT MARKING 4"	RAISED REFL PAVT MKS
FROM	TO														
Lake Cook Rd	Plum Grove Rd.	NB	2	4	4	16	2			2					
		NB	2	4	4	16	2			2					
		NB	2	4	12	48	5				5				
Deer Park	Quentin	NB	2	6	15	90	10				10				
		NB	2	4	4	16	2			2					
		NB	2	4	4	16	2			2					
Quentin	S. Old Rand	NB	2	12	12	144	16				16				
		NB	2	4	6	24	3			3					
JL 22	N. Old Rand	NB	1	4	12	48	5				5				
		NB	1	4	6	24	3			3					
		NB	1	4	6	24	3			3					
		NB	1	4	6	24	3			3					
		NB	1	4	6	24	3			3					
		NB	1	6	12	72	8				8				
		NB	1	6	12	72	8				8				
		NB	2	4	12	48	5				5				
		NB	2	4	12	48	5				5				
		NB	2	4	12	48	5				5				
		NB	2	4	12	48	5				5				
		NB	2	4	12	48	5				5				
		NB	2	4	12	48	5				5				
		NB	2	4	6	24	3			3					
		NB	2	6	12	72	8				8				
		NB	2	8	25	200	22					22			
		NB	2	6	30	180	20					20			
		NB	2	6	30	180	20					20			
		NB	2	6	30	180	20					20			
		NB	2	6	30	180	20					20			
		NB	2	6	30	180	20					20			
		NB	CL	2	1000	1500	167		167						
		NB	RT EP	2	1000	1500	167		167						
		NB	2	12	15	180	20				20				
		NB	2	4	20	80	9				9				
N. Old Rand	Miller	NB	1	4	12	48	5				5				
		NB	1	4	12	48	5				5				
		NB	1	4	12	48	5				5				
		NB	1	4	12	48	5				5				
		NB	1	4	6	24	3			3					
		NB	1	4	6	24	3			3					
		NB	1	4	25	100	11			11					
		NB	1	4	25	100	11				11				
		NB	1	4	25	100	11				11				
		NB	1	6	12	72	8				8				
		NB	1	6	12	72	8				8				
		NB	1	6	12	72	8				8				
		NB	1	6	12	72	8				8				
		NB	2	4	12	48	5				5				
		NB	2	4	12	48	5				5				
		NB	2	4	6	24	3			3					
		NB	2	4	25	100	11			11					
		NB	2	6	12	72	8				8				
		NB	2	6	50	300	33	33							
		NB	2	12	100	1200	133	133							
		NB	CL	2	1000	1500	167		167						
		NB	RT EP	2	1000	1500	167		167						
Miller	Old McHenry	NB	1	4	12	48	5				5				
		NB	1	4	12	48	5				5				
		NB	1	4	12	48	5				5				
		NB	1	4	12	48	5				5				
		NB	1	4	6	24	3			3					
		NB	1	4	6	24	3			3					
		NB	1	4	6	24	3			3					
		NB	1	4	4	16	2			2					
		NB	1	4	4	16	2			2					
		NB	1	4	4	16	2			2					
		NB	1	4	4	16	2			2					
		NB	1	4	4	16	2			2					

CONTINUED ON THE NEXT SHEET

ROUTE: US 12

CROSS STREETS		DIRECTION (EB/WB) (NB/SB)	LANE NO. (1, 2, 3)	PAVEMENT PATCH WIDTH	PAVEMENT PATCH LENGTH	REPAIR AREA (SQ FT)	REPAIR AREA (SQ YD)	HMA SURF REM 2-1/4" & RESURF	HMA SURF REM (SP) & RESURF	CLASS D PATCH TYPE I	CLASS D PATCH TYPE II	CLASS D PATCH TYPE III	CLASS D PATCH TYPE IV	PAVT MARKING 4"	RAISED REFL PAVT MKS
FROM	TO														
		NB	1	4	4	16	2			2					
		NB	1	4	4	16	2			2					
		NB	1	4	4	16	2			2					
		NB	1	4	4	16	2			2					
		NB	1	6	12	72	8				8				
		NB	1	6	12	72	8				8				
		NB	1	6	12	72	8				8				
		NB	1	6	12	72	8				8				
		NB	1	6	12	72	8				8				
		NB	1	6	12	72	8				8				
		NB	1	12	12	144	16					16			
		NB	1	12	12	144	16					16			
		NB	1	12	12	144	16					16			
		NB	1	12	12	144	16					16			
		NB	1	12	12	144	16					16			
		NB	1	12	12	144	16					16			
		NB	2	4	12	48	5				5				
		NB	2	4	12	48	5				5				
		NB	2	4	12	48	5				5				
		NB	2	4	6	24	3			3					
		NB	2	4	6	24	3			3					
		NB	2	4	4	16	2			2					
		NB	2	4	4	16	2			2					
		NB	2	4	4	16	2			2					
		NB	2	6	12	72	8				8				
		NB	2	6	12	72	8				8				
		NB	2	6	12	72	8				8				
		NB	2	6	12	72	8				8				
		NB	2	6	12	72	8				8				
		NB	1	12	40	480	53						53		
		NB	1	6	40	240	27						27		
		NB	1	6	75	450	50	50							
		NB	2	12	40	480	53					53			
		NB	2	6	40	240	27					27			
		NB	LT EP	2	1000	1500	167		167						
		NB	CL	2	2000	3000	333		333						
		NB	RT EP	2	3000	4500	500		500						
Old McHenry	IL 59	NB	1	4	12	48	5				5				
		NB	1	4	12	48	5				5				
		NB	1	4	12	48	5				5				
		NB	1	4	12	48	5				5				
		NB	1	4	12	48	5				5				
		NB	1	4	12	48	5				5				
		NB	1	4	4	16	2			2					
		NB	1	4	4	16	2			2					
		NB	1	4	4	16	2			2					
		NB	1	12	12	144	16					16			
		NB	1	12	12	144	16					16			
		NB	2	4	12	48	5				5				
		NB	2	4	12	48	5				5				
		NB	2	4	12	48	5				5				
		NB	2	4	12	48	5				5				
		NB	2	4	12	48	5				5				
		NB	2	4	6	24	3			3					
		NB	2	4	4	16	2			2					
		NB	2	12	12	144	16					16			
		NB	2	12	12	144	16					16			
		NB	CL	2	1500	2250	250		250						
		NB	LT EP	2	1500	2250	250		250						
IL 59	Bonner	NB	2	4	12	48	5				5				
		NB	2	4	6	24	3			3					
		NB	2	4	6	24	3			3					
Case	IL 120	NB	2	4	4	16	2			2					
		NB	2	4	4	16	2			2					
		NB	2	4	12	48	5				5				
		NB	2	4	12	48	5				5				

CONTINUED ON THE NEXT SHEET

ROUTE: US 12

CROSS STREETS		DIRECTION (EB/WB) (NB/SB)	LANE NO. (1, 2, 3)	PAVEMENT PATCH WIDTH	PAVEMENT PATCH LENGTH	REPAIR AREA (SQ FT)	REPAIR AREA (SQ YD)	HMA SURF REM 2-1/4" & RESURF	HMA SURF REM (SP) & RESURF	CLASS D PATCH TYPE I	CLASS D PATCH TYPE II	CLASS D PATCH TYPE III	CLASS D PATCH TYPE IV	PAVT MARKING 4"	RAISED REFL PAVT MKS
FROM	TO														
<i>Volo Village Rd.</i>	<i>Fox Lake Rd.</i>	NB	CL	3	250	750	83		83						
HMA Sect 1		NB	2	4	4	16	2			2					
		NB	2	4	4	16	2			2					
		NB	1	5	4	20	2			2					
		NB	2	10	4	40	4			4					
		NB	CL	3	150	450	50		50						
		NB	2	12	4	48	5				5				
		NB	2	4	4	16	2			2					
		NB	1	12	4	48	5				5				
		NB	2	12	4	48	5				5				
		NB	CL	3	200	600	67		67						
		NB	1	12	4	48	5								
		NB	1	4	50	200	22	22							
		NB	2	4	4	16	2			2					
HMA Sect 2		NB	1	12	4	48	5				5				
		NB	2	12	4	48	5				5				
		NB	1	4	10	40	4			4					
		NB	1	4	4	16	2			2					
		NB	CL	2	200	300	33		33						
		NB	1	12	4	48	5				5				
Dry land bridge		NB	2	4	4	16	2			2					
		NB	2	4	4	16	2			2					
		NB	2	4	4	16	2			2					
		NB	2	4	4	16	2			2					
HMA sect 3		NB	CL	2	200	300	33		33						
		NB	1	12	4	48	5				5				
		NB	1	12	4	48	5				5				
		NB	2	12	4	48	5				5				
<i>Fox Lake Rd</i>	<i>Molidor</i>	NB	1	4	30	120	13				13				
		NB	1	12	4	48	5				5				
		NB	CL	2	200	300	33		33						
		NB	1	12	4	48	5				5				
		NB	1	6	4	24	3			3					
		NB	2	6	15	90	10				10				
		NB	2	12	4	48	5				5				
		NB	CL	2	100	150	17		17						
		NB	1	6	4	24	3			3					
		NB	1	12	4	48	5				5				
		NB	1	4	4	16	2			2					
		NB	2	4	4	16	2			2					
		NB	1	6	4	24	3			3					
		NB	1	12	4	48	5				5				
		NB	2	12	4	48	5				5				
		NB	1	4	15	60	7				7				
		NB	1	6	4	24	3			3					
		NB	2	6	10	60	7				7				
		NB	2	4	4	16	2			2					
		NB	1	12	4	48	5				5				
		NB	1	4	4	16	2			2					
		NB	2	4	20	80	9				9				
		NB	1	6	4	24	3			3					
		NB	1	4	6	24	3			3					
		NB	2	6	50	300	33	33							
		NB	1	12	4	48	5				5				
		NB	2	12	4	48	5				5				
		NB	2	6	15	90	10				10				
		NB	2	6	25	150	17					17			
		NB	1	4	4	16	2			2					
		NB	1	12	4	48	5				5				
		NB	CL	2	150	225	25		25						
		NB	1	12	4	48	5				5				
		NB	1	12	4	48	5				5				
		NB	2	6	4	24	3			3					
		NB	1	12	4	48	5				5				

CONTINUED ON THE NEXT SHEET

...projects\dl36008\design_aa.dgn 4/10/2008 4:16:13 PM User=wlgreendp

ROUTE: US 12

CROSS STREETS		DIRECTION (EB/WB) (NB/SB)	LANE NO. (1, 2, 3)	PAVEMENT PATCH WIDTH	PAVEMENT PATCH LENGTH	REPAIR AREA (SQ FT)	REPAIR AREA (SQ YD)	HMA SURF REM 2-1/4" & RESURF	HMA SURF REM (SP) & RESURF	CLASS D PATCH TYPE I	CLASS D PATCH TYPE II	CLASS D PATCH TYPE III	CLASS D PATCH TYPE IV	PAVT MARKING 4"	RAISED REFL PAVT MKS		
FROM	TO																
Molidor	IL 134	NB	1	4	6	24	3			3							
		NB	1	4	6	24	3			3							
		NB	2	6	6	36	4			4							
		NB	1	6	4	24	3			3							
		NB	1	4	4	16	2			2							
		NB	1	4	4	16	2			2							
		NB	2	12	4	48	5				5						
		NB	2	12	4	48	5				5						
		NB	CL	2	100	150	17		17								
		NB	1	6	15	90	10				10						
		NB	1	4	4	16	2			2							
		NB	1	4	4	16	2			2							
		NB	2	12	4	48	5				5						
		NB	1	12	4	48	5				5						
		NB	1	12	4	48	5				5						
		NB	2	12	4	48	5				5						
		NB	1	4	4	16	2			2							
		PCC 2 mi n/o Volo Village Rd 2.1 mi n/o V V Rd		NB	1	4	6	24	3			3					
				NB	1	4	6	24	3			3					
				NB	1	4	4	16	2			2					
NB	1			4	4	16	2			2							
NB	1			4	4	16	2			2							
NB	1			12	4	48	5				5						
NB	1			4	12	48	5				5						
NB	CL			3	200	600	67		67								
NB	1			6	4	24	3			3							
NB	1			6	15	90	10				10						
NB	2			12	4	48	5				5						
NB	2			6	4	24	3			3							
NB	1			6	4	24	3			3							
NB	2			12	4	48	5				5						
NB	1			3	50	150	17					17					
NB	1			4	6	24	3			3							
NB	CL			3	200	600	67		67								
NB	1			12	4	48	5				5						
Hartigan Rd.				NB	1	12	4	48	5				5				
				NB	1	12	4	48	5				5				
		NB	1	4	4	16	2			2							
		NB	1	12	6	72	8				8						
		NB	2	12	6	72	8				8						
		NB	1	12	8	96	11				11						
		NB	CL	3	200	600	67		67								
		NB	1	12	4	48	5				5						
		NB	1	12	4	48	5				5						
		NB	2	12	4	48	5				5						
		NB	1	12	4	48	5				5						
		NB	1	4	4	16	2			2							
		NB	1	12	4	48	5				5						
		NB	2	12	4	48	5				5						
		NB	2	6	4	24	3			3							
IL 134	LT turn lane to Big Hollow	NB	LT LN	12	4	48	5				5						
IL 134	IL 59	NB	1	4	12	48	5				5						
		NB	1	4	12	48	5				5						
		NB	1	4	12	48	5				5						
		NB	1	4	12	48	5				5						
		NB	1	4	12	48	5				5						
		NB	1	4	12	48	5				5						
		NB	1	4	12	48	5				5						
		NB	1	4	12	48	5				5						
		NB	1	4	12	48	5				5						
		NB	1	4	12	48	5				5						
		NB	1	4	12	48	5				5						
		NB	1	4	6	24	3			3							
		NB	1	4	6	24	3			3							
		NB	1	4	6	24	3			3							
		NB	1	4	6	24	3			3							
NB	1	4	6	24	3			3									
NB	1	20	12	240	27												

CONTINUED ON THE NEXT SHEET

ROUTE: US 12

CROSS STREETS		DIRECTION (EB/WB) (NB/SB)	LANE NO. (1, 2, 3)	PAVEMENT PATCH WIDTH	PAVEMENT PATCH LENGTH	REPAIR AREA (SQ FT)	REPAIR AREA (SQ YD)	HMA SURF REM 2-1/4" & RESURF	HMA SURF REM (SP) & RESURF	CLASS D PATCH TYPE I	CLASS D PATCH TYPE II	CLASS D PATCH TYPE III	CLASS D PATCH TYPE IV	PAVT MARKING 4"	RAISED REFL PAVT MKS
FROM	TO														
		NB	2	4	12	48	5				5				
		NB	2	4	12	48	5				5				
		NB	2	4	12	48	5				5				
	IL 59	NB	Ramp	4	12	48	5				5				
	IL 59	NB	Ramp	4	12	48	5				5				
		NB	CL	2	200	300	33		33						
		NB	1	4	6	24	3			3					
IL 59	Eagle Pt/ Sayton	NB	1	4	12	48	5				5				
		NB	1	4	12	48	5				5				
		NB	1	4	12	48	5				5				
		NB	1	4	12	48	5				5				
		NB	1	4	12	48	5				5				
		NB	1	4	12	48	5				5				
		NB	1	4	6	24	3			3					
		NB	1	4	6	24	3			3					
		NB	1	4	6	24	3			3					
		NB	1	4	6	24	3			3					
		NB	1	4	4	16	2			2					
		NB	1	12	12	144	16					16			
		NB	2	4	12	48	5				5				
		NB	2	4	12	48	5				5				
		NB	2	4	6	24	3			3					
		NB	2	4	6	24	3			3					
		NB	2	4	6	24	3			3					
		NB	2	4	6	24	3			3					
		NB	2	4	6	24	3			3					
		NB	2	4	6	24	3			3					
		NB	2	4	4	16	2			2					
Grand Ave	State Park Rd	NB	2	4	12	48	5				5				
		NB	2	4	6	24	3			3					
		NB	2	4	6	24	3			3					
		NB	2	4	4	16	2			2					
		NB	2	4	4	16	2			2					
State Park Rd	Grand Ave	SB		2	500	750	83		83						
Grand	Sayton	SB	1	4	12	48	5				5				
		SB	2	4	12	48	5				5				
Sayton	IL 59	SB	1	12	12	144	16					16			
		SB	1	4	6	24	3			3					
		SB	1	4	6	24	3			3					
		SB	1	4	6	24	3			3					
		SB	1	4	12	48	5				5				
		SB	1	4	12	48	5				5				
		SB	1	4	12	48	5				5				
		SB	1	4	12	48	5				5				
		SB	1	4	12	48	5				5				
		SB	1	4	12	48	5				5				
		SB	2	4	6	24	3			3					
		SB	2	4	6	24	3			3					
		SB	2	4	12	48	5				5				
		SB	2	4	12	48	5				5				
		SB	2	4	12	48	5				5				
		SB	2	4	12	48	5				5				
		SB	2	4	12	48	5				5				
		SB	2	4	4	16	2			2					
IL 59	IL 134	SB	1	4	12	48	5				5				
		SB	1	4	12	48	5				5				
		SB	1	4	12	48	5				5				
		SB	1	4	12	48	5				5				
		SB	1	4	12	48	5				5				
		SB	1	4	12	48	5				5				
		SB	2	4	12	48	5				5				
		SB	2	4	12	48	5				5				
		SB	2	4	1	4	1			1					
		SB	RT EP	2	200	300	33		33						
		SB	RT EP	2	200	300	33		33						
		SB	CL	2	200	300	33		33						
		SB	1	4	6	24	3			3					
		SB	1	4	6	24	3			3					

CONTINUED ON THE NEXT SHEET

...projects\dl35008\design_aa.dgn 4/10/2008 4:15:38 PM User=wlgreendp

ROUTE: US 12

CROSS STREETS		DIRECTION (EB/WB) (NB/SB)	LANE NO. (1, 2, 3)	PAVEMENT PATCH WIDTH	PAVEMENT PATCH LENGTH	REPAIR AREA (SQ FT)	REPAIR AREA (SQ YD)	HMA SURF REM 2-1/4" & RESURF	HMA SURF REM (SP) & RESURF	CLASS D PATCH TYPE I	CLASS D PATCH TYPE II	CLASS D PATCH TYPE III	CLASS D PATCH TYPE IV	PAVT MARKING 4"	RAISED REFL PAVT MKS			
FROM	TO																	
IL 134	Hartigan	SB	1	4	12	48	5				5							
		SB	1	4	12	48	5				5							
		SB	1	4	12	48	5				5							
		SB	1	4	12	48	5				5							
		SB	1	4	6	24	3			3								
		SB	1	4	4	16	2			2								
		SB	2	4	12	48	5					5						
		SB	2	4	12	48	5					5						
		SB	2	4	12	48	5					5						
		SB	2	4	6	24	3			3								
		SB	2	4	6	24	3			3								
		SB	LT TN 2	12	6	72	8					8						
		SB	LT TN 2	6	10	60	7					7						
		SB	CL	2	150	225	25		25			25						
		Hartigan	Molidor	SB	1	4	12	48	5				5					
				SB	1	4	12	48	5				5					
SB	1			4	12	48	5				5							
SB	1			4	12	48	5				5							
SB	1			4	12	48	5				5							
SB	1			4	12	48	5				5							
SB	1			4	12	48	5				5							
SB	1			4	12	48	5				5							
SB	1			4	12	48	5				5							
SB	1			4	12	48	5				5							
SB	1			4	6	24	3			3								
SB	1			4	4	16	2			2								
SB	1			4	4	16	2			2								
SB	1			4	12	48	5					5						
SB	1			4	12	48	5					5						
SB	1			4	12	48	5					5						
SB	1			4	12	48	5					5						
SB	1			4	12	48	5					5						
SB	1			4	12	48	5					5						
SB	1			4	4	16	2			2								
SB	1			4	4	16	2			2								
SB	1			4	10	40	4			4								
Molidor	Fox Lake Rd			SB	CL	2	100	150	17		17		17					
				SB	1	4	12	48	5				5					
				SB	1	4	12	48	5				5					
				SB	1	4	12	48	5				5					
				SB	1	4	12	48	5				5					
				SB	1	4	12	48	5				5					
		SB	1	4	12	48	5				5							
		SB	1	4	12	48	5				5							
		SB	1	4	12	48	5				5							
		SB	1	4	12	48	5				5							
		SB	1	4	6	24	3			3								
		SB	1	4	4	16	2			2								
		SB	1	4	4	16	2			2								
		SB	2	4	12	48	5					5						
		SB	2	4	12	48	5					5						
		SB	2	4	12	48	5					5						
		SB	2	4	12	48	5					5						
		SB	2	4	12	48	5					5						
		SB	2	4	12	48	5					5						
		SB	2	4	12	48	5					5						
		SB	2	4	12	48	5					5						
		SB	2	4	6	24	3			3								
		SB	2	4	6	24	3			3								
		SB	2	4	6	24	3			3								
		SB	2	4	4	16	2			2								
		SB	2	4	4	16	2			2								
		SB	2	4	4	16	2			2								
		SB	2	4	4	16	2			2								
	Turn lanes @ Fox Lake Rd	SB	RT EP	2	50	75	8				8							
		SB	LT EP	3	150	450	50		50									

CONTINUED ON THE NEXT SHEET

...projects\136008\design_aa.dgn 4/10/2008 4:15:20 PM User=wlgreendp

ROUTE: US 12

CROSS STREETS		DIRECTION (EB/WB) (NB/SB)	LANE NO. (1, 2, 3)	PAVEMENT PATCH WIDTH	PAVEMENT PATCH LENGTH	REPAIR AREA (SQ FT)	REPAIR AREA (SQ YD)	HMA SURF REM 2-1/4" & RESURF	HMA SURF REM (SP) & RESURF	CLASS D PATCH TYPE I	CLASS D PATCH TYPE II	CLASS D PATCH TYPE III	CLASS D PATCH TYPE IV	PAVT MARKING 4"	RAISED REFL PAVT MKS		
FROM	TO																
Fox Lake Rd	Volo Village Rd	SB	1	4	12	48	5				5						
		SB	1	4	12	48	5				5						
		SB	1	4	6	24	3			3							
		SB	1	4	12	48	5				5						
		SB	1	4	12	48	5				5						
		SB	1	4	12	48	5				5						
		SB	1	4	12	48	5				5						
		SB	1	4	12	48	5				5						
		SB	1	4	6	24	3			3							
		SB	1	4	4	16	2			2							
		SB	2	4	12	48	5				5						
		SB	2	4	4	16	2			2							
		SB	LT EP	3	100	300	33			33							
		SB	CL	3	100	300	33			33							
		SB	1	8	12	72	8				8						
		SB	LT EP	2	200	300	33			33							
		SB	LT EP	3	200	600	67			67							
		IL 120	Case Rd	SB	1	4	12	48	5				5				
SB	1			4	4	16	2			2							
SB	2			1000	1500	167			167								
SB	2			1000	1500	167			167								
Bonner	IL 59	SB	1	4	12	48	5				5						
		SB	1	4	6	24	3			3							
		SB	1	4	6	24	3			3							
		SB	1	4	6	24	3			3							
		SB	1	4	6	24	3			3							
		SB	1	4	6	24	3			3							
		SB	1	4	6	24	3			3							
		SB	1	4	4	16	2			2							
		SB	2	4	12	48	5				5						
		SB	2	4	12	48	5				5						
		SB	2	4	12	48	5				5						
		SB	2	4	12	48	5				5						
		SB	2	4	6	24	3			3							
		SB	2	4	6	24	3			3							
		SB	2	4	4	16	2			2							
		SB	2	4	4	16	2			2							
		SB	2	4	4	16	2			2							
		SB	2	4	4	16	2			2							
		IL 59	Old McHenry	SB	1	4	12	48	5				5				
				SB	1	4	12	48	5				5				
SB	1			4	12	48	5				5						
SB	1			4	6	24	3			3							
SB	1			4	6	24	3			3							
SB	2			4	12	48	5				5						
SB	2			4	12	48	5				5						
SB	2			4	12	48	5				5						
SB	2			4	12	48	5				5						
SB	2			4	6	24	3			3							
SB	2			4	6	24	3			3							
SB	2			4	4	16	2			2							
SB	CL			2	200	300	33			33							
SB	CL			2	200	300	33			33							
SB	RT EP			2	300	450	50			50							
SB	RT EP	2	300	450	50			50									
Old McHenry	Miller	SB	1	12	4	48	5				5						
		SB	1	12	4	48	5				5						
		SB	1	12	4	48	5				5						
		SB	1	12	4	48	5				5						
		SB	1	12	4	48	5				5						
		SB	1	12	4	48	5				5						
		SB	1	12	4	48	5				5						
		SB	1	12	4	48	5				5						
		SB	1	12	4	48	5				5						
		SB	1	12	4	48	5				5						
		SB	1	12	4	48	5				5						
		SB	1	12	4	48	5				5						

CONTINUED ON THE NEXT SHEET

...projects\dl36008\design_ea.dgn 4/10/2008 4:15:02 PM User=wlgreendp

ROUTE: US 12

CROSS STREETS		DIRECTION (EB/WB) (NB/SB)	LANE NO. (1, 2, 3)	PAVEMENT PATCH WIDTH	PAVEMENT PATCH LENGTH	REPAIR AREA (SQ FT)	REPAIR AREA (SQ YD)	HMA SURF REM 2-1/4" & RESURF	HMA SURF REM (SP) & RESURF	CLASS D PATCH TYPE I	CLASS D PATCH TYPE II	CLASS D PATCH TYPE III	CLASS D PATCH TYPE IV	PAVT MARKING 4"	RAISED REFL PAVT MKS
FROM	TO														
		SB	1	12	4	48	5				5				
		SB	1	12	4	48	5				5				
		SB	1	12	4	48	5				5				
		SB	1	6	4	24	3			3					
		SB	1	6	4	24	3			3					
		SB	1	6	4	24	3			3					
		SB	1	6	4	24	3			3					
		SB	1	6	4	24	3			3					
		SB	1	6	4	24	3			3					
		SB	1	6	4	24	3			3					
		SB	1	6	4	24	3			3					
		SB	1	6	4	24	3			3					
		SB	1	6	4	24	3			3					
		SB	1	6	4	24	3			3					
		SB	1	6	4	24	3			3					
		SB	1	6	4	24	3			3					
		SB	1	6	4	24	3			3					
		SB	1	6	4	24	3			3					
		SB	1	4	4	16	2			2					
		SB	1	4	4	16	2			2					
		SB	1	4	4	16	2			2					
		SB	1	4	4	16	2			2					
		SB	1	4	4	16	2			2					
		SB	1	4	4	16	2			2					
		SB	1	4	4	16	2			2					
		SB	1	4	4	16	2			2					
		SB	1	6	20	120	13				13				
		SB	1	6	20	120	13				13				
		SB	1	6	20	120	13				13				
		SB	1	6	20	120	13				13				
		SB	1	8	12	96	11				11				
		SB	2	4	12	48	5				5				
		SB	2	4	12	48	5				5				
		SB	2	4	12	48	5				5				
		SB	2	4	12	48	5				5				
		SB	2	4	12	48	5				5				
		SB	2	4	12	48	5				5				
		SB	2	4	6	24	3			3					
		SB	2	4	6	24	3			3					
		SB	2	4	6	24	3			3					
		SB	2	4	6	24	3			3					
		SB	2	4	6	24	3			3					
		SB	2	4	4	16	2			2					
		SB	2	4	4	16	2			2					
		SB	2	4	4	16	2			2					
		SB	2	4	4	16	2			2					
		SB	2	4	4	16	2			2					
		SB	2	4	4	16	2			2					
		SB	2	6	20	120	13				13				
		SB	2	8	12	96	11				11				
		SB	2	8	8	64	7				7				
		SB	1	4	4	16	2			2					
		SB	2	4	12	48	5				5				
		SB	RT EP	2	2500	3750	417		417						
		SB	CL	2	1300	1950	217		217						
Miller	Old Rand	SB	1	4	12	48	5				5				
		SB	1	4	12	48	5				5				
		SB	1	4	12	48	5				5				
		SB	1	4	12	48	5				5				
		SB	1	4	12	48	5				5				
		SB	1	4	12	48	5				5				
		SB	1	4	12	48	5				5				
		SB	1	4	12	48	5				5				
		SB	1	4	12	48	5				5				
		SB	1	4	6	24	3			3					

CONTINUED ON THE NEXT SHEET

...projects\dl36006\design_aa.dgn 4/10/2008 4:14:44 PM User=wlgreendp

ROUTE: US 12

CROSS STREETS		DIRECTION (EB/WB) (NB/SB)	LANE NO. (1, 2, 3)	PAVEMENT PATCH WIDTH	PAVEMENT PATCH LENGTH	REPAIR AREA (SQ FT)	REPAIR AREA (SQ YD)	HMA SURF REM 2-1/4" & RESURF	HMA SURF REM (SP) & RESURF	CLASS D PATCH TYPE I	CLASS D PATCH TYPE II	CLASS D PATCH TYPE III	CLASS D PATCH TYPE IV	PAVT MARKING 4"	RAISED REFL PAVT MKS
FROM	TO														
		SB	1	4	6	24	3			3					
		SB	1	4	6	24	3			3					
		SB	1	4	6	24	3			3					
		SB	1	4	4	16	2			2					
		SB	1	4	4	16	2			2					
		SB	1	4	4	16	2			2					
		SB	1	4	4	16	2			2					
		SB	1	6	20	120	13				13				
		SB	1	6	20	120	13				13				
		SB	1	6	12	72	8				8				
		SB	1	6	12	72	8				8				
		SB	2	4	12	48	5				5				
		SB	2	4	12	48	5				5				
		SB	2	4	12	48	5				5				
		SB	2	4	12	48	5				5				
		SB	2	4	12	48	5				5				
		SB	2	4	6	24	3			3					
		SB	2	4	6	24	3			3					
		SB	2	4	4	16	2			2					
		SB	2	4	4	16	2			2					
		SB	2	4	4	16	2			2					
		SB	2	4	4	16	2			2					
		SB	2	4	4	16	2			2					
		SB	2	4	4	16	2			2					
		SB	2	4	20	80	9				9				
		SB	2	6	20	120	13				13				
		SB	2	6	12	72	8				8				
		SB	2	6	12	72	8				8				
Old Rand	IL 22	SB	1	4	12	48	5				5				
		SB	1	4	12	48	5				5				
		SB	1	4	6	24	3			3					
		SB	1	4	6	24	3			3					
		SB	1	4	6	24	3			3					
		SB	1	4	4	16	2			2					
		SB	1	4	4	16	2			2					
		SB	1	4	4	16	2			2					
		SB	1	4	20	80	9				9				
		SB	1	4	20	80	9				9				
		SB	1	6	20	120	13				13				
		SB	1	6	20	120	13				13				
		SB	1	6	20	120	13				13				
		SB	1	6	20	120	13				13				
		SB	1	6	12	72	8				8				
		SB	1	6	12	72	8				8				
		SB	1	6	12	72	8				8				
		SB	1	6	12	72	8				8				
		SB	1	6	50	300	33	33							
		SB	1	6	50	300	33	33							
		SB	RT EP	2	1500	2250	250		250						
		SB	CL	2	1500	2250	250		250						
S. Old Rand		SB	HT SC	6	100	600	67								
Old Rand	Quentin	SB	2	4	4	16	2			2					
		SB	2	4	4	16	2			2					
Quentin	Deer Park	SB	2	4	4	16	2			2					
Deer Park	Plum Grove	SB	1	4	4	16	2			2					
		SB	2	4	4	16	2			2					

TOTALS: 337 SY 4967 SY 612 SY 1891 SY 348 SY 80 SY 13200 FT 600 EACH

...projects\136008\design_as.dgn 4/10/2008 4:14:24 PM User=wjlgreendp

ROUTE: US 14

CROSS STREETS		DIRECTION (EB/WB) (NB/SB)	LANE NO. (1, 2, 3)	PAVEMENT PATCH WIDTH	PAVEMENT PATCH LENGTH	REPAIR AREA (SQ FT)	REPAIR AREA (SQ YD)	HMA SURF REM 2-1/4" & RESURF	HMA SURF REM (SP) & RESURF	CLASS D PATCH TYPE I	CLASS D PATCH TYPE II	CLASS D PATCH TYPE III	CLASS D PATCH TYPE IV	PAVT MARKING 4"	RAISED REFL PAVT MKS
FROM	TO														
		NB	2	4	4	16	2			2					
		NB	2	4	4	16	2			2					
		NB	2	4	4	16	2			2					
		NB	2	4	4	16	2			2					
		NB	2	4	4	16	2			2					
		NB	2	4	4	16	2			2					
		NB	2	4	4	16	2			2					
		NB	2	4	4	16	2			2					
		NB	2	4	4	16	2			2					
		NB	2	4	4	16	2			2					
		NB	2	4	4	16	2			2					
		NB	2	4	4	16	2			2					
		NB	2	4	4	16	2			2					
		NB	1	6	12	72	8				8				
		NB	1	6	12	72	8				8				
		NB	2	6	12	72	8				8				
		NB	2	6	12	72	8				8				
		NB	2	6	20	120	13				13				
		NB	LT E/P	2	50	75	8	8							
Kelsey Road	IL 22	NB	1	4	12	48	5				5				
		NB	1	4	12	48	5				5				
		NB	1	4	12	48	5				5				
		NB	1	4	12	48	5				5				
		NB	1	4	12	48	5				5				
		NB	1	4	12	48	5				5				
		NB	1	4	12	48	5				5				
		NB	1	4	12	48	5				5				
		NB	1	4	12	48	5				5				
		NB	1	4	12	48	5				5				
		NB	2	4	12	48	5				5				
		NB	2	4	12	48	5				5				
		NB	2	4	12	48	5				5				
		NB	1	4	6	24	3			3					
		NB	1	4	6	24	3			3					
		NB	1	4	4	16	2			2					
		NB	1	4	4	16	2			2					
		NB	1	4	4	16	2			2					
		NB	1	4	4	16	2			2					
		NB	1	4	4	16	2			2					
		NB	1	4	4	16	2			2					
		NB	2	4	4	16	2			2					
		NB	2	4	4	16	2			2					
		NB	2	4	4	16	2			2					
		NB	2	4	4	16	2			2					
		NB	2	4	4	16	2			2					
		NB	2	4	4	16	2			2					
		NB	2	4	4	16	2			2					
		NB	2	4	4	16	2			2					
		NB	1	4	20	80	9				9				
		NB	2	6	12	72	8				8				

TOTALS: 96 SY 33 SY 383 SY 841 SY 1200 FT 60 EACH

...project\136006\design_aa.dgn 4/10/2008 4:12:29 PM User=wilgreendp

ROUTE: US 45 (STATE LINE ROAD TO PETERSON ROAD)

CROSS STREETS		DIRECTION (EB/WB) (NB/SB)	LANE NO. (1, 2, 3)	PAVEMENT PATCH WIDTH	PAVEMENT PATCH LENGTH	REPAIR AREA (SQ FT)	REPAIR AREA (SQ YD)	HMA SURF REM 2-1/4" & RESURF	HMA SURF REM (SP) & RESURF	CLASS D PATCH TYPE I	CLASS D PATCH TYPE II	CLASS D PATCH TYPE III	CLASS D PATCH TYPE IV	PAVT MARKING 4"	RAISED REFL PAVT MKS	
FROM	TO															
STATE LINE ROAD		NB	1	12	4	48	5				5					
		SB	1	12	10	120	13				13					
		CL	2	4	10	40	4			4						
		C/L	C/L	2	50	75	8		8							
		C/L	C/L	2	50	75	8		8							
		C/L	C/L	2	50	75	8		8							
		C/L	C/L	2	50	75	8		8							
		C/L	C/L	2	100	150	17		17							
		C/L	C/L	2	100	150	17		17							
		C/L	C/L	2	100	150	17		17							
		IL RTE 173	C/L	C/L	2	200	300	33		33						
	IL RTE 173		NB	1	12	4	48	5				5				
			NB	1	12	6	72	8				8				
			NB	1	12	6	72	8				8				
		NB	1	12	6	72	8				8					
		SB	1	12	6	72	8				8					
		SB	1	12	6	72	8				8					
		SB	1	6	10	60	7				7					
		CL	CL	2	50	75	8		8							
		CL	CL	2	50	75	8		8							
		CL	CL	2	50	75	8		8							
		GRASS LAKE ROAD	CL	CL	2	200	300	33		33						
GRASS LAKE ROAD			NB	1	12	4	48	5				5				
			NB	1	12	4	48	5				5				
			NB	1	12	6	72	8				8				
		NB	1	12	6	72	8				8					
		NB	1	12	6	72	8				8					
		NB	1	12	6	72	8				8					
		NB	1	12	6	72	8				8					
		SB	1	12	4	48	5				5					
		SB	1	12	4	48	5				5					
		SB	1	12	4	48	5				5					
		SB	1	12	4	48	5				5					
		SB	1	12	6	72	8				8					
		SB	1	12	6	72	8				8					
		SB	1	12	6	72	8				8					
		SB	1	12	6	72	8				8					
		SB	1	12	6	72	8				8					
		SB	1	12	6	72	8				8					
		SB	1	12	8	96	11				11					
		SB	1	12	10	120	13				13					
		SB	1	12	10	120	13				13					
		SB	1	12	10	120	13				13					
		SB	1	12	10	120	13				13					
		SB	1	6	20	120	13				13					
		SB	1	12	30	360	40						40			
		SB	1	12	30	360	40						40			
		NB	1	2	100	150	17		17							
		NB	1	2	100	150	17		17							
		NB	1	2	100	150	17		17							
	CL	CL	2	100	150	17		17								
	CL	CL	2	100	150	17		17								
	NB	1	2	150	225	25		25								
	SB	1	2	200	300	33		33								
	SAND LAKE ROAD	SB	1	2	200	300	33		33							
SAND LAKE ROAD		NB	1	12	4	48	5				5					
		NB	1	12	4	48	5				5					
		NB	1	12	4	48	5				5					
		NB	1	12	4	48	5				5					
		NB	1	12	4	48	5				5					

CONTINUED ON THE NEXT SHEET

ROUTE: US 45 (Peterson Road to IL 83 and IL 83 to IL 21)

CROSS STREETS		DIRECTION (EB/WB) (NB/SB)	LANE NO. (1, 2, 3)	PAVEMENT PATCH WIDTH	PAVEMENT PATCH LENGTH	REPAIR AREA (SQ FT)	REPAIR AREA (SQ YD)	HMA SURF REM 2-1/4" & RESURF	HMA SURF REM (SP) & RESURF	CLASS D PATCH TYPE I	CLASS D PATCH TYPE II	CLASS D PATCH TYPE III	CLASS D PATCH TYPE IV	PAVT MARKING 4"	RAISED REFL PAVT MKS
FROM	TO														
Peterson Road	IL 176	SB													
IL 176	Hawley Street	SB	2	4	12	48	5				5				
Hawley Street	Diamond Lake Road	SB	2	4	10	40	4			4					
		SB	1	4	4	16	2			2					
		SB	2	4	4	16	2			2					
		SB	2	2	100	150	17	17							
		SB	2	4	4	16	2			2					
		SB	2	4	4	16	2			2					
Diamond Lake Road	IL 60	SB	CL	2	150	225	25	25							
		SB	1	8	12	96	11				11				
		SB	2	8	12	96	11				11				
		SB	lane Lin	2	300	450	50	50							
		SB	1	4	12	48	5				5				
		SB	2	4	12	48	5				5				
		SB	2	4	4	16	2			2					
		SB	1	6	12	72	8				8				
		SB	2	6	12	72	8				8				
		SB	2	4	12	48	5				5				
		SB	lane Lin	2	100	150	17	17							
		SB	1	6	12	72	8				8				
		SB	2	6	12	72	8				8				
		SB	CL	2	300	450	50	50							
		SB	1	4	12	48	5				5				
		SB	2	4	6	24	3			3					
		SB	2	4	4	16	2			2					
		SB	2	4	4	16	2			2					
		SB	2	4	4	16	2			2					
		SB	1	4	4	16	2			2					
		SB	1	4	4	16	2			2					
		SB	2	4	4	16	2			2					
		SB	1	4	20	80	9				9				
		SB	1	4	20	80	9				9				
IL 60	IL 83	SB	1	4	12	48	5				5				
		SB	1	4	12	48	5				5				
IL 83	Butterfield Road	SB		4	4	16	2			2					
(2 Lane Section)		SB		4	4	16	2			2					
		SB		4	4	16	2			2					
		SB		4	4	16	2			2					
		SB		4	12	48	5				5				
Butterfield Road	Buffalo Grove Road	SB		4	4	16	2			2	2				
		SB		6	10	60	7				7				
		SB		4	4	16	2			2					
		SB		4	4	16	2			2					
		SB		2	100	150	17	17							
		SB		4	6	24	3			3					
		SB		4	4	16	2			2					
		SB		4	6	24	3			3					
Buffalo Grove Road	IL 21	SB		4	20	80	9				9				
		SB		4	20	80	9				9				
		SB		4	4	16	2			2					
		SB		4	6	24	3			3					
IL 21	Buffalo Grove Road	NB		4	4	16	2			2					
		NB		4	4	16	2			2					
		NB		4	4	16	2			2					
		NB		4	4	16	2			2					
		NB		4	10	40	4			4					
		NB		2	200	300	33	33			33				
		NB	RT E/P	2	50	75	8			8					

CONTINUED ON THE NEXT SHEET

ROUTE: US 45 (Peterson Road to IL 83 and IL 83 to IL 21)

CROSS STREETS		DIRECTION (EB/WB) (NB/SB)	LANE NO. (1, 2, 3)	PAVEMENT PATCH WIDTH	PAVEMENT PATCH LENGTH	REPAIR AREA (SQ FT)	REPAIR AREA (SQ YD)	HMA SURF REM 2-1/4" & RESURF	HMA SURF REM (SP) & RESURF	CLASS D PATCH TYPE I	CLASS D PATCH TYPE II	CLASS D PATCH TYPE III	CLASS D PATCH TYPE IV	PAVT MARKING 4"	RAISED REFL PAVT MKS
FROM	TO														
Buffalo Grove Road	IL 83	NB		4	20	80	9				9				
		NB		4	4	16	2		2						
		NB		4	20	80	9				9				
IL 83	IL 60	NB	Lane Lin	2	200	300	33		33						
		NB	1	4	4	16	2			2					
		NB	1	4	4	16	2			2					
		NB	1	4	4	16	2			2					
IL 60	Diamond Lake Road	NB	1	2	200	300	33		33						
		NB	2	4	6	24	3			3					
		NB	2	4	6	24	3			3					
		NB	2	4	6	24	3			3					
		NB	2	6	20	120	13				13				
		NB	2	8	12	96	11				11				
		NB	2	4	4	16	2			2					
		NB	1	4	4	16	2			2					
		NB	2	6	20	120	13				13				
		NB	2	6	6	36	4			4					
		NB	2	4	4	16	2			2					
		NB	2	12	12	144	16					16			
		NB	2	4	4	16	2			2					
		NB	1	6	12	72	8				8				
Diamond Lake Road	IL 176	NB	2	6	12	72	8				8				
		NB	2	4	30	120	13				13				
		NB	2	4	4	16	2			2					
		NB	2	4	4	16	2			2					
		NB	1	4	4	16	2			2					
		NB	2	4	4	16	2			2					
		NB	2	4	4	16	2			2					
		NB	2	4	4	16	2			2					
		NB	2	4	4	16	2			2					
		NB	2	4	20	80	9				9				

TOTALS:

0 SY 275 SY 112 SY 267 SY 16 SY 650 FT 28 EACH

ROUTE: IL 53 (Hicks Rd.)

CROSS STREETS		DIRECTION (EB/WB) (NB/SB)	LANE NO. (1, 2, 3)	PAVEMENT PATCH WIDTH	PAVEMENT PATCH LENGTH	REPAIR AREA (SQ FT)	REPAIR AREA (SQ YD)	HMA SURF REM 2-1/4" & RESURF	HMA SURF REM (SP) & RESURF	CLASS D PATCH TYPE I	CLASS D PATCH TYPE II	CLASS D PATCH TYPE III	CLASS D PATCH TYPE IV	PAVT MARKING 4"	RAISED REFL PAVT MKS	
FROM	TO															
US RT 12	Lake Cook Rd	NB	1	4	12	48	5				5					
		NB	1	4	12	48	5				5					
		NB	2	4	12	48	5				5					
		SB	CL	2	20	30	3		3							
		SB	2	4	6	24	3									
		SB	LT TN	4	12	48	5					5				
		SB	LT TN	4	4	16	2				2					
Lake Cook Rd	Long Grove Rd	SB	LT TN	4	4	16	2			2						
		SB	1	4	4	16	2			2						
		SB	1	4	4	16	2			2						
		SB	CL	2	20	30	3		3							
		SB	RT EP	2	20	30	3		3							
		SB	1	4	12	48	5					5				
		SB	1	4	4	16	2				2					
		SB	1	4	4	16	2				2					
		SB	1	4	4	16	2				2					
		SB	1	12	12	144	16						16			
		SB	1	6	12	72	8						8			
		SB	1	4	4	16	2				2					
		SB	CL	2	25	38	4		4							
		SB	1	6	10	60	7						7			
		Long Grove Rd	Lake Cook Rd	SB	1	6	6	36	4			4				
SB	1			6	6	36	4			4						
SB	1			4	4	16	2			2						
SB	1			4	4	16	2			2						
SB	1			4	4	16	2			2						
SB	CL			2	50	75	8		8							
SB	LN LI			2	200	300	33		33			33				
SB	1			4	4	16	2				2					
SB	1			4	4	16	2				2					
SB	1			4	4	16	2				2					
Lake Cook Rd	Long Grove Rd	NB	2	4	4	16	2			2						
		NB	2	4	4	16	2			2						
		NB	1	4	4	16	2			2						
		NB	1	6	6	36	4			4						
		NB	1	12	12	144	16						16			
		NB	1	6	12	72	8						8			
		NB	1	4	4	16	2				2					
Long Grove Rd	IL 83	NB	1	4	4	16	2			2						
		NB	1	4	4	16	2			2						
		NB	1	4	4	16	2			2						
		NB	1	6	6	36	4			4						
		NB	1	4	10	40	4			4						
		NB	CL	2	100	150	17		17							
		NB	1	4	6	24	3			3						
		NB	1	4	10	40	4			4						
		NB	1	4	4	16	2			2						
		NB	1	4	4	16	2			2						
		NB	1	4	4	16	2			2						
		NB	1	4	20	80	9						9			
		NB	1	4	4	16	2			2						
		NB	1	6	6	36	4			4						
		NB	1	4	4	16	2			2						
		NB	1	4	4	16	2			2						
		NB	1	6	6	36	4			4						
		NB	1	4	4	16	2			2						
		NB	1	4	4	16	2			2						
		NB	1	4	4	16	2			2						
NB	1	6	6	36	4			4								
NB	1	4	4	16	2			2								
NB	1	4	4	16	2			2								
NB	1	4	4	16	2			2								
NB	RT TN	4	4	16	2			2								
NB	RT TN	4	12	48	5						5					

TOTALS: 0 SY 71 SY 115 SY 134 SY 350 FT 10 EACH

FILE NAME = c:\projects\13808\design_aa.dgn
 USER NAME = wilgreendp
 PLOT SCALE = 100.0000' / IN.
 PLOT DATE = 4/18/2008

DESIGNED -	REVISIONS -
DRAWN -	REVISIONS -
CHECKED -	REVISIONS -
DATE -	REVISIONS -

**STATE OF ILLINOIS
 DEPARTMENT OF TRANSPORTATION**

**PATCHING SCHEDULE
 IL 53**

SCALE: SHEET NO. OF SHEETS STA. TO STA.

F.A.P. RTE. VAR.	SECTION 2008-020 PP	COUNTY LAKE	TOTAL SHEETS 59	SHEET NO. 26
CONTRACT NO. 60E49				

FED. ROAD DIST. NO. 1 ILLINOIS FED. AID PROJECT

ROUTE: IL RTE 59 (EXIT RAMP- NORTH OF IL 134) FROM US 12 TO IL 173

CROSS STREETS		DIRECTION (EB/WB) (NB/SB)	LANE NO. (1, 2, 3)	PAVEMENT PATCH WIDTH	PAVEMENT PATCH LENGTH	REPAIR AREA (SQ FT)	REPAIR AREA (SQ YD)	HMA SURF REM 2-1/4" & RESURF	HMA SURF REM (SP) & RESURF	CLASS D PATCH TYPE I	CLASS D PATCH TYPE II	CLASS D PATCH TYPE III	CLASS D PATCH TYPE IV	PAVT MARKING 4"	RAISED REFL PAVT MKS
FROM	TO														
U.S. 12		NB	1	12	4	48	5				5				
		NB	1	12	6	72	8				8				
		NB	1	12	6	72	8				8				
		NB	1	12	6	72	8				8				
		NB	1	12	6	72	8				8				
		NB	1	12	6	72	8				8				
		NB	1	12	8	96	11				11				
		NB	2	12	8	96	11				11				
		NB	1	12	10	120	13				13				
		NB	1	6	20	120	13				13				
		NB	1	6	20	120	13				13				
		SB	1	12	6	72	8				8				
		SB	1	12	6	72	8				8				
		CL	1	2	50	75	8		50						
		CL	1	2	50	75	8		50						
		CL	1	2	100	150	17		17						
		CL	1	2	100	150	17		17						
		CL	1	2	200	300	33		33						
		CL	1	2	200	300	33		33						
	DEVLIN ROAD	CL	1	2	300	450	50		50						
DEVLIN ROAD		SB	1	12	6	72	8				8				
		SB	1	12	6	72	8				8				
		CL	CL	2	50	75	8		8						
		CL	CL	2	50	75	8		8						
		CL	CL	2	50	75	8		8						
		CL	CL	2	50	75	8		8						
		CL	CL	2	50	75	8		8						
		CL	CL	2	50	75	8		8						
		CL	CL	2	50	75	8		8						
		CL	CL	2	100	150	17		17						
		CL	CL	2	100	150	17		17						
	WILSON ROAD	CL	CL	2	100	150	17		17						
WILSON ROAD		CL	CL	2	200	300	33		33						
		NB	1	12	8	96	11				11				
		NB	1	20	6	120	13				13				
		SB	1	12	6	72	8				8				
		SB	1	12	6	72	8				8				
		SB	1	12	6	72	8				8				
		SB	2	12	10	120	13				13				
		SB	2	12	10	120	13				13				
		CL	CL	2	50	75	8		8						
		CL	CL	2	50	75	8		8						
		SB	1	2	50	75	8		8						
		SB	1	2	50	75	8		8						
		SB	1	2	50	75	8		8						
		SB	1	2	50	75	8		8						
		SB	1	2	50	75	8		8						
		NB	1	2	50	75	8		8						
		NB	1	2	50	75	8		8						

CONTINUED ON THE NEXT SHEET

ROUTE: **IL RTE 59 (EXIT RAMP- NORTH OF IL 134) FROM US 12 TO IL 173**

CROSS STREETS		DIRECTION (EB/WB) (NB/SB)	LANE NO. (1, 2, 3)	PAVEMENT PATCH WIDTH	PAVEMENT PATCH LENGTH	REPAIR AREA (SQ FT)	REPAIR AREA (SQ YD)	HMA SURF REM 2-1/4" & RESURF	HMA SURF REM (SP) & RESURF	CLASS D PATCH TYPE I	CLASS D PATCH TYPE II	CLASS D PATCH TYPE III	CLASS D PATCH TYPE IV	PAVT MARKING 4"	RAISED REFL PAVT MKS
FROM	TO														
CON'T WILSON ROAD		NB	1	2	50	75	8		8						
		NB	1	2	50	75	8		8						
		NB	1	2	50	75	8		8						
		NB	1	2	100	150	17		17						
		SB	1	2	100	150	17		17						
		SB	1	2	100	150	17		17						
		SB	1	2	100	150	17		17						
	MONAVILLE ROAD	NB	1	2	200	300	33		33						
MONAVILLE ROAD		NB	1	12	4	48	5				5				
		NB	1	12	6	72	8				8				
		SB	1	12	4	48	5				5				
		SB	1	12	4	48	5				5				
		SB	1	12	4	48	5				5				
		SB	1	12	4	48	5				5				
		SB	1	12	6	72	8				8				
	IL. RTE 132	NB	1	2	100	150	17		17						
IL. RTE 132		NB	1	12	4	48	5				5				
		NB	1	12	4	48	5				5				
		NB	1	12	4	48	5				5				
		NB	1	12	6	72	8				8				
		NB	1	12	6	72	8				8				
		NB	1	12	6	72	8				8				
		NB	1	12	10	120	13				13				
		SB	1	12	4	48	5				5				
	GRASS LAKE ROAD	SB	1	12	6	72	8				8				
GRASS LAKE ROAD		NB	1	12	6	72	8				8				
		SB	1	12	6	72	8				8				
		SB	1	12	6	72	8				8				
	IL. RTE 173	CL	CL	2	50	75	8				8				

TOTALS:

615
SY

347
SY

4900
FT

68
EACH

ROUTE: IL 59

CROSS STREETS		DIRECTION (EB/WB) (NB/SB)	LANE NO. (1, 2, 3)	PAVEMENT PATCH WIDTH	PAVEMENT PATCH LENGTH	REPAIR AREA (SQ FT)	REPAIR AREA (SQ YD)	HMA SURF REM 2-1/4" & RESURF	HMA SURF REM (SP) & RESURF	CLASS D PATCH TYPE I	CLASS D PATCH TYPE II	CLASS D PATCH TYPE III	CLASS D PATCH TYPE IV	PAVT MARKING 4"	RAISED REFL PAVT MKS	
FROM	TO															
US 12	Roberts Rd	SB	1	4	4	16	2			2						
		SB	1	4	4	16	2			2						
		SB	1	6	20	120	13									
		SB	1	4	4	16	2			2						
		SB	1	2	200	300	33		33							
		SB	1	4	6	24	3			3						
		SB	1	4	6	24	3			3						
		SB	1	4	4	16	2			2						
		SB	1	4	4	16	2			2						
		SB	RT EP	2	100	150	17		17							
Kelsey	Miller	SB	1	4	4	16	2			2						
		SB	1	4	4	16	2			2						
		SB	1	4	4	16	2			2						
Miller	IL 22	SB	1	12	50	600	67	50								
		SB	1	4	100	400	44	44								
		SB	1	4	50	200	22	22								
		SB	1	4	20	80	9				9					
		SB	1	4	10	40	4			4						
		SB	RT EP	2	200	300	33		33							
		SB	1	4	50	200	22	22								
		SB	RT EP	2	75	113	13		13							
		SB	1	4	4	16	2			2						
		SB	1	4	4	16	2			2						
		SB	1	4	4	16	2			2						
		SB	1	4	150	600	67	67								
		SB	1	4	10	40	4			4						
		SB	1	4	4	16	2			2						
IL 22	Cuba	SB	1	4	100	400	44	44								
		SB	1	4	4	16	2			2						
		SB	1	4	4	16	2			2						
		SB	1	4	4	16	2			2						
		SB	1	4	4	16	2			2						
		SB	1	4	50	200	22	22								
		SB	RT EP	2	200	300	33		33							
		SB	1	4	6	24	3			3						
		SB	RT EP	2	200	300	33		33							
		SB	1	4	4	16	2			2						
		SB	1	4	4	16	2			2						
		SB	1	4	4	16	2			2						
		SB	RT EP	2	200	300	33		33							
		SB	1	4	4	16	2			2						
		SB	1	4	4	16	2			2						
		SB	1	4	4	16	2			2						
		SB	6	50	300	33	33		33							
		SB	LT EP	2	300	450	50		50							
		SB	LT TN	6	20	120	13				13					
		SB	LT TN	4	6	24	3			3	3					
Cuba	US 14	SB	LT EP	2	100	150	17		17							
		SB	1	4	6	24	3			3						
		SB	1	4	6	24	3			3						
		SB	1	4	4	16	2			2						
		SB	1	4	12	48	5				5					
		SB	1	4	12	48	5				5					
		SB	1	4	50	200	22	22								

CONTINUED ON THE NEXT SHEET

ROUTE: IL 59

CROSS STREETS		DIRECTION (EB/WB) (NB/SB)	LANE NO. (1, 2, 3)	PAVEMENT PATCH WIDTH	PAVEMENT PATCH LENGTH	REPAIR AREA (SQ FT)	REPAIR AREA (SQ YD)	HMA SURF REM 2-1/4" & RESURF	HMA SURF REM (SP) & RESURF	CLASS D PATCH TYPE I	CLASS D PATCH TYPE II	CLASS D PATCH TYPE III	CLASS D PATCH TYPE IV	PAVT MARKING 4"	RAISED REFL PAVT MKS
FROM	TO														
US 14	Lake Cook Rd	SB	1	4	6	24	3			3					
		SB	1	4	6	24	3			3					
		SB	1	4	12	48	5				5				
		SB	1	4	4	16	2			2					
		SB	1	4	4	16	2			2					
		SB	1	4	4	16	2			2					
		SB	1	4	4	16	2			2					
Lake Cook Rd	US 14	NB	1	4	12	48	5				5				
		NB	1	4	12	48	5				5				
		NB	1	4	12	48	5				5				
US 14	Cuba	NB	1	4	20	80	9				9				
		NB	1	4	12	48	5				5				
		NB	1	4	12	48	5				5				
		NB	1	4	12	48	5				5				
		NB	1	4	100	400	44	44							
		NB	RT EP	2	300	450	50		50						
		NB	1	4	4	16	2			2					
		NB	1	4	4	16	2			2					
		NB	1	4	20	80	9				9				
Cuba	IL 22	NB	1	4	4	16	2			2					
		NB	1	4	4	16	2			2					
		NB	1	4	20	80	9				9				
		NB	1	6	15	90	10				10				
		NB	1	4	4	16	2			2					
		NB	1	4	4	16	2			2					
		NB	1	4	4	16	2			2					
		NB	1	4	4	16	2			2					
		NB	1	4	4	16	2			2					
		NB	1	4	50	200	22	22							
		NB	1	4	4	16	2			2	2				
		NB	1	4	4	16	2			2	2				
IL 22	Miller	NB	1	12	100	1200	133	133							
		NB	1	4	50	200	22	22							
		NB	1	4	4	16	2			2					
		NB	1	4	4	16	2			2					
		NB	1	4	20	80	9				9				
		NB	1	4	4	16	2			2					
		NB	1	4	4	16	2			2					
		NB	1	4	30	120	13				13				
Miller	Kelsey	NB	1	4	4	16	2			2					
		NB	1	4	4	16	2			2					
		NB	1	4	4	16	2			2					
		NB	1	4	4	16	2			2					
Roberts	US 12	NB	1	6	50	300	33	33							
		NB	1	6	20	120	13				13				
		NB	1	4	12	48	5				5				
		NB	1	4	6	24	3			3					
		NB	CL	2	200	300	33		33						
		NB	1	8	12	96	11				11				
		NB	1	4	4	16	2			2					
		NB	1	4	4	16	2			2					
		NB	1	4	20	80	9				9				
		NB	1	4	4	16	2			2					
		NB	1	4	4	16	2			2					
		NB	1	4	10	40	4			4					
		NB	1	4	6	24	3			3					

TOTALS: 3738 580 SY 345 SY 136 SY 173 SY 1500 FT 30 EACH

FILE NAME = c:\projects\dl35008\design_aa.dgn
 PLOT SCALE = 100.0000' / IN.
 PLOT DATE = 4/18/2008

USER NAME = wjgreenp
 DESIGNED -
 DRAWN -
 CHECKED -
 DATE -

REVISED -
 REVISED -
 REVISED -
 REVISED -

STATE OF ILLINOIS
 DEPARTMENT OF TRANSPORTATION

PATCHING SCHEDULE
 IL 59
 SCALE: SHEET NO. OF SHEETS STA. TO STA.

F.A.P. RTE. SECTION COUNTY TOTAL SHEETS SHEET NO.
 VAR. 2008-020 PP LAKE 59 30
 CONTRACT NO. 60E49
 FED. ROAD DIST. NO. 1 ILLINOIS FED. AID PROJECT

PROJECT: dl35008\design_aa.dgn 4/10/2008 4:25:27 PM User: wjgreenp

ROUTE: IL 60 (Peterson Road to IL 83 and IL 83 to IL 21)

CROSS STREETS		DIRECTION (EB/WB) (NB/SB)	LANE NO. (1, 2, 3)	PAVEMENT PATCH WIDTH	PAVEMENT PATCH LENGTH	REPAIR AREA (SQ FT)	REPAIR AREA (SQ YD)	HMA SURF REM 2-1/4" & RESURF	HMA SURF REM (SP) & RESURF	CLASS D PATCH TYPE I	CLASS D PATCH TYPE II	CLASS D PATCH TYPE III	CLASS D PATCH TYPE IV	PAVT MARKING 4"	RAISED REFL PAVT MKS
FROM	TO														
Peterson Road	Freemont Center Road	EB		4	4	16	2			2					
		EB		4	4	16	2			2					
		EB		4	4	16	2			2					
		EB	RT E/P	2	100	150	17					17			
Freemont Center Road	IL 83	EB		4	4	16	2			2					
		EB		4	4	16	2			2					
		EB		4	4	16	2			2					
		EB		4	10	40	4			4					
		EB		4	4	16	2			2					
		EB		4	4	16	2			2					
		EB		4	4	16	2			2					
		EB		4	4	16	2			2					
		EB		4	4	16	2			2					
		EB		4	4	16	2			2					
		EB	RT E/P	2	150	225	25		25						
Note: The area will IL 60 and IL 83 run concurrently will be compiled on a separate spreadsheet.															
IL 83	US 45	EB													
US 45	Butterfield Road	EB													
Butterfield Road	IL 21	EB													
IL 21	Butterfield Road	WB													
Butterfield Road	US 45	WB	1	12	12	144	16					16			
		WB	1	4	4	16	2			2					
US 45	IL 83	WB													
Note: The area will IL 60 and IL 83 run concurrently will be compiled on a separate spreadsheet.															
IL 83	Freemont Center Road	WB	CL	2	300	450	50		50						
		WB		2	500	750	83		83						
		WB		2	200	300	33		33						
		WB		4	30	120	13				13				
		WB		4	20	80	9				9				
		WB		4	20	80	9				9				
		WB		4	12	48	5				5				
		WB		4	12	48	5				5				
		WB		6	20	120	13	13							
		WB		4	10	40	4			4					
		WB		12	20	240	27					27			
		WB		6	10	60	7				7				
		WB		12	12	144	16					16			
		WB		6	10	60	7				7				
		WB		6	20	120	13				13				
		WB		4	6	24	3			3					
Freemont Center Road	Peterson Road	WB		6	15	90	10				10				

TOTALS: 13 SY 191 SY 35 SY 78 SY 76 SY 450 FT 8 EACH

ROUTE: IL 60/83

CROSS STREETS		DIRECTION (EB/WB) (NB/SB)	LANE NO. (1, 2, 3)	PAVEMENT PATCH WIDTH	PAVEMENT PATCH LENGTH	REPAIR AREA (SQ FT)	REPAIR AREA (SQ YD)	HMA SURF REM 2-1/4" & RESURF	HMA SURF REM (SP) & RESURF	CLASS D PATCH TYPE I	CLASS D PATCH TYPE II	CLASS D PATCH TYPE III	CLASS D PATCH TYPE IV	PAVT MARKING 4"	RAISED REFL PAVT MKS
FROM	TO														
N/O IL 176	IL 176	SB	1	4	12	48	5				5				
		SB	1	4	4	16	2			2					
		SB	1	4	4	16	2			2					
		SB	1	4	4	16	2			2					
IL 176	Hawley	SB	1	4	6	24	3				3				
		SB	1	4	4	16	2				2				
		SB	1	4	4	16	2				2				
		SB	1	4	6	24	3				3				
Hawley	Midlothian	SB	1	4	12	48	5				5				
		SB	CL	2	300	450	50		50						
		SB	1	4	30	120	13					13			
		SB	1	4	20	80	9					9			
		SB	CL	2	200	300	33		33						
Midlothian	Diamond Lake Rd	SB	1	4	10	40	4				4				
		SB	1	4	200	300	33		33						
		SB	1	4	4	16	2				2				
		SB	1	4	4	16	2				2				
		SB	1	4	4	16	2				2				
		SB	1	4	6	24	3				3				
		SB	1	4	6	24	3				3				
		SB	1	4	4	16	2				2				
		SB	1	4	4	16	2				2				
		SB	1	4	4	16	2				2				
		SB	1	4	4	16	2				2				
		SB	1	4	20	80	9					9			
		SB	1	4	10	40	4				4				
		SB	1	4	4	16	2				2				
		SB	1	4	4	16	2				2				
		SB	1	4	4	16	2				2				
		SB	1	4	30	120	13					13			
		SB	1	4	6	24	3				3				
SB	1	4	6	24	3				3						
SB	1	4	4	16	2				2						
IL 60	Diamond Lake Rd	NB	2	4	4	16	2				2				
		NB	2	4	4	16	2				2				
Diamond Lake Rd	Midlothian	NB	1	4	4	16	2				2				
		NB	1	4	4	16	2				2				
		NB	1	4	4	16	2				2				
		NB	1	4	4	16	2				2				
		NB	1	4	4	16	2				2				
		NB	1	4	6	24	3				3				
Midlothian	Hawley	NB	1	2	700	1050	117		117						
		NB	1	4	6	24	3				3				
		NB	1	4	12	48	5				5				
		NB	1	4	50	200	22	22							
Hawley	N/O IL 176	NB	1	4	4	16	2				2				
		NB	1	4	4	16	2				2				
		NB	1	4	50	200	22	22							
		NB	1	4	4	16	2				2				
		NB	1	4	4	16	2				2				
		NB	1	2	100	150	17		17						

TOTALS: 44 SY 250 SY 76 SY 59 SY 500 FT 10 EACH

FILE NAME =
c:\projects\dl135008\design_00.dgn

USER NAME = wlgreendp
DESIGNED -
DRAWN -
PLOT SCALE = 100.0000' / IN.
CHECKED -
PLOT DATE = 4/18/2008
DATE -

REVISOR -
REVISOR -
REVISOR -
REVISOR -

STATE OF ILLINOIS
DEPARTMENT OF TRANSPORTATION

PATCHING SCHEDULE
IL 60/83

SCALE: SHEET NO. OF SHEETS STA. TO STA.

F.A.P. RTE.	SECTION	COUNTY	TOTAL SHEETS	SHEET NO.
VAR.	2008-020 PP	LAKE	59	32
CONTRACT NO. 60E49				
FED. ROAD DIST. NO. 1 ILLINOIS FED. AID PROJECT				

ROUTE: IL RTE 60 (PETERSON ROAD TO IL RTE 120)

CROSS STREETS		DIRECTION (EB/WB) (NB/SB)	LANE NO. (1, 2, 3)	PAVEMENT PATCH WIDTH	PAVEMENT PATCH LENGTH	REPAIR AREA (SQ FT)	REPAIR AREA (SQ YD)	HMA SURF REM 2-1/4" & RESURF	HMA SURF REM (SP) & RESURF	CLASS D PATCH TYPE I	CLASS D PATCH TYPE II	CLASS D PATCH TYPE III	CLASS D PATCH TYPE IV	PAVT MARKING 4"	RAISED REFL PAVT MKS
FROM	TO														
		EB	1	12	6	72	8				8				
		EB	1	12	6	72	8				8				
		EB	1	12	6	72	8				8				
		EB	1	12	6	72	8				8				
		EB	1	12	6	72	8				8				
		EB	1	12	6	72	8				8				
		EB	1	12	6	72	8				8				
		EB	1	12	6	72	8				8				
		EB	1	12	6	72	8				8				
		EB	1	12	6	72	8				8				
		EB	1	12	6	72	8				8				
		EB	1	12	10	120	13				13				
		EB	1	12	10	120	13				13				
		EB	1	12	10	120	13				13				
		EB	1	12	10	120	13				13				
		WB	1	12	4	48	5				5				
		WB	1	12	4	48	5				5				
		WB	1	12	4	48	5				5				
		WB	1	12	6	72	8				8				
		WB	1	12	6	72	8				8				
		WB	1	12	6	72	8				8				
		WB	1	12	6	72	8				8				
		WB	1	12	6	72	8				8				
		WB	1	12	6	72	8				8				
		WB	1	12	6	72	8				8				
		WB	1	12	6	72	8				8				
		WB	1	12	6	72	8				8				
		WB	1	12	6	72	8				8				
		WB	1	12	6	72	8				8				
		WB	1	12	6	72	8				8				
		WB	1	12	6	72	8				8				
		WB	1	12	6	72	8				8				
		WB	1	6	200	1200	133	133							
		WB	1	6	200	1200	133	133							
		WB	1	6	200	1200	133	133							
		CL	CL	2	50	75	8		8						
		CL	CL	2	50	75	8		8						
		CL	CL	2	100	150	17		17						
		CL	CL	2	100	150	17		17						
		CL	CL	2	100	150	17		17						
		CL	CL	2	100	150	17		17						
		CL	CL	2	100	150	17		17						
		CL	CL	2	100	150	17		17						
		CL	CL	2	100	150	17		17						
		CL	CL	2	200	300	33		33						
	IL RTE 120	CL	CL	2	200	300	33		33						

TOTALS: 589 SY 183 SY 565 SY 5500 FT 54 EACH

...projects\dl36008\design_ee.dgn 4/10/2008 4:24:15 PM User=wilgreendp

ROUTE: IL Rte 83

CROSS STREETS		DIRECTION (EB/WB) (NB/SB)	LANE NO. (1, 2, 3)	PAVEMENT PATCH WIDTH	PAVEMENT PATCH LENGTH	REPAIR AREA (SQ FT)	REPAIR AREA (SQ YD)	HMA SURF REM 2-1/4" & RESURF	HMA SURF REM (SP) & RESURF	CLASS D PATCH TYPE I	CLASS D PATCH TYPE II	CLASS D PATCH TYPE III	CLASS D PATCH TYPE IV	PAVT MARKING 4"	RAISED REFL PAVT MKS
FROM	TO														
IL Rte 173		N/B	1	12	100	1200	133	133							
	Total 8 Each	N/B	1	6	12	72	64				64				
	Total 3 Each	S/B	1	6	12	72	24				24				
		N/B	1	4	20	80	9				9				
	Total 5 Ea	N/B & S/B	1	12	6	72	40				40				
		N/B	1	6	20	120	13				13				
		N/B	1	6	12	72	8				8				
		S/B	1	6	30	180	20				20				
		N/B	1	6	100	600	67	67							
		S/B	1	12	6	72	8				8				
		N/B	1	4	20	80	9				9				
		N/B	1	6	20	120	13				13				
	Total 4 Ea	N/B & S/B	1	8	12	96	43				43				
		S/B	1	6	100	600	67	67							
	Total 2 Ea	N/B & S/B	1	6	12	72	16				16				
	Total 6 E	S/B	1	6	12	72	48				48				
	WISCONSIN ST LINE	S/B	1	2	50	75	8		8						
IL Rte 173		S/B	1	6	20	120	13				13				
	Total 2 Each	S/B	1	6	12	72	16				16				
	Total 4 Each	N/B	1	12	6	72	32				32				
		S/B	1	4	10	40	4				4				
		S/B	1	4	100	400	44	44							
		S/B	1	4	50	200	22				22				
		S/B	C/L	4	100	400	44	44							
		N/B	1	4	300	1200	133	4133							
		S/B	1	4	50	200	22	22							
	Total 2	N/B & S/B	1	12	6	72	16				16				
		S/B	1	12	8	96	11				11				
		C.L.	1	2	150	225	25	25							
	Total 2	S/B	1	4	25	100	22				22				
		N/B	1	12	6	72	8				8				
	Total 2	N/B & S/B	1	12	6	72	16				16				
		C.L.	C.L.	2	50	75	8		8						
	Grass Lake Rd. (Tot 2)	N/B & S/B	1	6	12	72	16				16				
Grass Lake Road		N/B	1	4	250	1000	111	111							
		N/B	1	6	12	72	8								
		S/B	1	4	100	400	44	44							
		S/B	1	4	100	400	44	44							
	Total 2 Each	N/B & S/B	1	12	6	72	16				16				
		C.L.	C.L.	2	100	150	17		17						
		S/B	1	4	150	600	67	67							
	Total 2 Each	S/B	1	12	6	72	16				16				
	Total 2 Each	N/B & S/B	1	12	6	72	16				16				
	Petite Lake (Tot 3 Ea)	N/B, Med, S/B	1	12	6	72	24				24				
IL 132		S/B	1	6	25	150	17				17				
	Total 2 Each	N/B & S/B	1	6	12	72	16				16				
	Total 2 Each	N/B & S/B	1	6	12	72	16				16				
	Total 2 Each	N/B & S/B	1	6	12	72	16				16				
		C.L.	1	2	100	150	17		17						
	Total 2 Each	N/B & S/B	1	12	6	72	16				16				

CONTINUED ON THE NEXT SHEET

ROUTE: IL Rte 83

CROSS STREETS		DIRECTION (EB/WB) (NB/SB)	LANE NO. (1, 2, 3)	PAVEMENT PATCH WIDTH	PAVEMENT PATCH LENGTH	REPAIR AREA (SQ FT)	REPAIR AREA (SQ YD)	HMA SURF REM 2-1/4" & RESURF	HMA SURF REM (SP) & RESURF	CLASS D PATCH TYPE I	CLASS D PATCH TYPE II	CLASS D PATCH TYPE III	CLASS D PATCH TYPE IV	PAVT MARKING 4"	RAISED REFL PAVT MKS
FROM	TO														
		S/B	1	12	6	72	8				8				
		S/B	1	4	10	40	4				4				
		C.L.	C.L.	2	2000	3000	333		333						
		S/B	1	2	100	150	17		17						
		S/B	1	4	100	400	44	44							
	Rollins Rd (Total 3 Ea)	N/B & S/B	1	12	6	72	24				24				
Rollins Road		S/B	1	2	200	300	33		33						
		N/B	1	2	200	300	33		33						
		N/B	1	12	6	72	8				8				
	Total 2 Each	N/B & S/B	1	12	6	72	16				16				
	Lake Street (Tot 2 Ea)	N/B & S/B	1	2	150	225	50		50						
		S/B	1	6	6	36	4				4				
		C/L	C/L	2	200	300	33		33						
		N/B	1	12	6	72	8				8				
		N/B	1	12	6	72	8				8				
	2 EA, TOT 4	N/B & S/B	1	12	6	72	32				32				
		N/B	1	4	100	400	44	44							
	Total 2 Ea	N/B & S/B	1	12	6	72	16				16				
		S/B	1	2	50	75	8		8						
	3EA, TOTAL 6	N/B & S/B	1	6	12	72	48				48				
	IL Rte 137	N/B & S/B	1	6	12	72	16				16				
IL Rte 137		S/B	1	6	10	60	7				7				
		S/B	1	6	20	120	13				13				
		N/B	1	4	50	200	22	22							
	2 Each	N/B & S/B	1	12	8	96	21				21				
		S/B	1	6	100	600	67	67							
		N/B	1	4	50	200	22	22							
		S/B	1	6	20	120	13				13				
	3 Each	N/B	1	12	6	72	24				24				
		N/B	1	4	50	200	22	22							
	Petersen Rd	S/B	1	4	50	200	22	22							

TOTALS 5044 SY 557 SY 916 SY 2500 FT 50 EACH

ROUTE: IL 83 (Peterson Road to IL 60 and IL 60 to Lake Cook Road)

CROSS STREETS		DIRECTION (EB/WB) (NB/SB)	LANE NO. (1, 2, 3)	PAVEMENT PATCH WIDTH	PAVEMENT PATCH LENGTH	REPAIR AREA (SQ FT)	REPAIR AREA (SQ YD)	HMA SURF REM 2-1/4" & RESURF	HMA SURF REM (SP) & RESURF	CLASS D PATCH TYPE I	CLASS D PATCH TYPE II	CLASS D PATCH TYPE III	CLASS D PATCH TYPE IV	PAVT MARKING 4"	RAISED REFL PAVT MKS
FROM	TO														
Peterson Road	IL 60	SB		2	100	150	17		17						
		SB		4	6	24	3			3					
		SB		4	10	40	4			4					
		SB		4	10	40	4			4					
IL 60	US 45	SB	1	4	4	16	2			2					
		SB	1	4	4	16	2			2					
		SB	1	4	20	80	9				9				
		SB	1	4	4	16	2			2					
US 45	Gilmer Road	SB	2	4	6	24	3			3					
		SB	lane Lin	2	300	450	50		50						
		SB	lane Lin	2	200	300	33		33						
		SB	1	4	4	16	2			2					
US 45	Gilmer Road	SB	1	4	4	16	2			2					
		SB	1	4	4	16	2			2					
		SB	1	4	4	16	2			2					
		SB	1	4	4	16	2			2					
		SB	1	4	4	16	2			2					
		SB	1	4	4	16	2			2					
		SB	1	4	4	16	2			2					
		SB	1	4	12	48	5				5				
		SB	1	4	4	16	2			2					
		SB	1	4	4	16	2			2					
		SB	2	4	4	16	2			2					
		SB	1	4	4	16	2			2					
Gilmer Road	IL 22	SB	1	4	12	48	5				5				
		SB	2	4	12	48	5				5				
		SB	1	4	4	16	2			2					
		SB	2	8	12	96	11				11				
IL 22	IL 53	SB	1	4	4	16	2			2					
		SB	1	4	4	16	2			2					
		SB	2	4	4	16	2			2					
		SB	2	4	4	16	2			2					
IL 53	Arlington Heights Road	SB	2	4	12	48	5				5				
		SB	1	4	12	48	5				5				
		SB	2	4	12	48	5				5				
		SB	LT Turn	4	12	48	5				5				
Arlington Heights Road	Buffalo Grove Road	SB	2	4	4	16	2			2					
		SB	1	4	4	16	2			2					
		SB	2	4	4	16	2			2					
		SB	2	4	12	48	5			5					
Buffalo Grove Road	Lake Cook Road	SB	2	2	200	300	33		33						
		SB	2	2	200	300	33		33						
		SB	2	4	100	400	44	44							
		SB	1	2	1000	1500	167		167						
Lake Cook Road	Buffalo Grove Road	SB	1	4	4	16	2			2					
		NB	1	2	2000	3000	333		333						
		NB	2	4	4	16	2			2					
		NB	2	4	4	16	2			2					
Lake Cook Road	Buffalo Grove Road	NB	lane Lin	2	1000	1500	167		167						
		NB	2	4	100	400	44	44							

CONTINUED ON THE NEXT SHEET

ROUTE: IL 83 (Peterson Road to IL 60 and IL 60 to Lake Cook Road)

CROSS STREETS		DIRECTION (EB/WB) (NB/SB)	LANE NO. (1, 2, 3)	PAVEMENT PATCH WIDTH	PAVEMENT PATCH LENGTH	REPAIR AREA (SQ FT)	REPAIR AREA (SQ YD)	HMA SURF REM 2-1/4" & RESURF	HMA SURF REM (SP) & RESURF	CLASS D PATCH TYPE I	CLASS D PATCH TYPE II	CLASS D PATCH TYPE III	CLASS D PATCH TYPE IV	PAVT MARKING 4"	RAISED REFL PAVT MKS
FROM	TO														
Buffalo Grove Road	Arlington Heights Road	NB	1	4	4	16	2			2					
		NB	2	4	4	16	2			2					
		NB	1	4	4	16	2			2					
		NB	2	4	4	16	2			2					
		NB	1	4	4	16	2			2					
		NB	2	4	4	16	2			2					
Arlington Heights Road	IL 53	NB	1	4	4	16	2			2					
		NB	2	4	12	48	5				5				
IL 53	IL 22	NB	1	4	4	16	2			2					
IL 22	Gilmer Road	NB	2	4	4	16	2			2					
		NB	1	4	4	16	2			2					
		NB	2	4	4	16	2			2					
		NB	1	4	4	16	2			2					
Gilmer Road	US 45	NB	CL	2	100	150	17				17				
		NB	1	4	4	16	2			2					
US 45	IL 60	NB	2	6	10	60	7				7				
		NB	1	2	300	450	50		50						
IL 60	Winchester Road	NB		2	100	150	17		17						
		NB		4	4	16	2			2					
		NB		4	4	16	2			2					
		NB		4	4	16	2			2					
		NB		2	100	150	17		17						
Winchester Road	Peterson Road	NB		4	6	24	3			3					
		NB		4	4	16	2			2					
		NB		4	4	16	2			2					

TOTALS:

88
SY

917
SY

116
SY

117
SY

400
FT

40
EACH

FILE NAME =
c:\projects\dl36008\design_00.dgn

USER NAME = wlgreendp
DESIGNED -
DRAWN -
PLOT SCALE = 100.0000' / IN.
CHECKED -
PLT DATE = 4/10/2008
DATE -

REVISED -
REVISED -
REVISED -
REVISED -

STATE OF ILLINOIS
DEPARTMENT OF TRANSPORTATION

PATCHING SCHEDULE
IL 83

SCALE: SHEET NO. OF SHEETS STA. TO STA.

F.A.P. RTE.	SECTION	COUNTY	TOTAL SHEETS	SHEET NO.
VAR.	2008-020 PP	LAKE	59	38
FED. ROAD DIST. NO. 1 ILLINOIS FED. AID PROJECT CONTRACT NO. 60E49				

ROUTE: IL RTE 120 (MILL ROAD TO US 12 / IL RTE 59)

CROSS STREETS		DIRECTION (EB/WB) (NB/SB)	LANE NO. (1, 2, 3)	PAVEMENT PATCH WIDTH	PAVEMENT PATCH LENGTH	REPAIR AREA (SQ FT)	REPAIR AREA (SQ YD)	HMA SURF REM 2-1/4" & RESURF	HMA SURF REM (SP) & RESURF	CLASS D PATCH TYPE I	CLASS D PATCH TYPE II	CLASS D PATCH TYPE III	CLASS D PATCH TYPE IV	PAVT MARKING 4"	RAISED REFL PAVT MKS
FROM	TO														
MILL ROAD		EB	1	12	4	48	5				5				
		EB	1	12	4	48	5				5				
		EB	1	12	4	48	5				5				
		EB	1	12	4	48	5				5				
		EB	1	12	6	72	8				8				
		EB	1	12	6	72	8				8				
		EB	1	12	6	72	8				8				
		EB	1	12	10	120	13				13				
		EB	1	12	10	120	13				13				
		WB	1	12	6	72	8				8				
		WB	1	12	6	72	8				8				
		CL	CL	2	100	150	17		17						
		CL	CL	2	100	150	17		17						
		EB	1	2	100	150	17		17						
		EB	1	2	100	150	17		17						
	US RTE 45	EB	1	2	100	150	17		17						
US RTE 45		EB	1	12	6	72	8				8				
		EB	1	12	6	72	8				8				
		EB	1	12	6	72	8				8				
		EB	1	12	6	72	8				8				
		EB	1	12	6	72	8				8				
		EB	1	12	10	120	13				13				
		EB	1	12	10	120	13				13				
		EB	1	12	200	2400	267	267							
		EB	1	12	30	360	40	40							
		WB	1	12	6	72	8				8				
		WB	1	12	6	72	8				8				
		WB	1	12	6	72	8				8				
		WB	1	12	6	72	8				8				
		WB	1	4	200	800	89	89							
		WB	1	4	50	200	22	22							
		CL	1	2	100	150	17		17						
		CL	1	2	100	150	17		17						
		CL	1	2	100	150	17		17						
		EB	1	2	100	150	17		17						
		EB	1	2	100	150	17		17						
		EB	1	2	200	300	33		33						
		EB	1	2	200	300	33		33						
		EB	1	2	200	300	33		33						
		EB	1	2	200	300	33		33						
	IL RTE 83	EB	1	2	200	300	33		33						
IL RTE 83		EB	1	12	10	120	13				13				
		WB	1	12	4	48	5				5				
		WB	1	12	4	48	5				5				
		WB	1	12	6	72	8				8				
		WB	1	2	100	150	17		17						
	ALLEGHANY ROAD	WB	1	2	100	150	17		17						
CONT ALLEGHANY RD		EB	1	12	6	72	8				8				
		EB	1	12	6	72	8				8				
		EB	1	12	6	72	8				8				
		EB	1	12	6	72	8				8				
		EB	1	12	6	72	8				8				
		EB	1	12	8	96	11				11				
		EB	1	6	50	300	33	33							
		EB	1	12	10	120	13				13				

CONTINUED ON THE NEXT SHEET

ROUTE: IL RTE 120 (MILL ROAD TO US 12 / IL RTE 59)

CROSS STREETS		DIRECTION (EB/WB) (NB/SB)	LANE NO. (1, 2, 3)	PAVEMENT PATCH WIDTH	PAVEMENT PATCH LENGTH	REPAIR AREA (SQ FT)	REPAIR AREA (SQ YD)	HMA SURF REM 2-1/4" & RESURF	HMA SURF REM (SP) & RESURF	CLASS D PATCH TYPE I	CLASS D PATCH TYPE II	CLASS D PATCH TYPE III	CLASS D PATCH TYPE IV	PAVT MARKING 4"	RAISED REFL PAVT MKS
FROM	TO														
		EB	1	2	100	150	17		17						
		EB	1	2	100	150	17		17						
		EB	1	2	100	150	17		17						
		EB	1	2	100	150	17		17						
		EB	1	2	100	150	17		17						
		EB	1	2	100	150	17		17						
		EB	1	2	100	150	17		17						
		EB	1	2	100	150	17		17						
		EB	1	2	100	150	17		17						
		EB	1	2	200	300	33		33						
		WB	1	12	4	48	5				5				
		WB	1	12	6	72	8				8				
		WB	1	12	6	72	8				8				
		WB	1	12	10	120	13				13				
HAINSEVILLE ROAD	HAINSEVILLE ROAD	EB	1	12	6	72	8				8				
		EB	1	12	6	72	8				8				
		EB	1	12	10	120	13				13				
		EB	1	12	10	120	13				13				
		WB	1	12	4	48	5				5				
		WB	1	12	4	48	5				5				
		WB	1	12	4	48	5				5				
		WB	1	12	4	48	5				5				
		WB	1	12	4	48	5				5				
		WB	1	12	6	72	8				8				
		WB	1	12	6	72	8				8				
		WB	1	12	6	72	8				8				
		WB	2	12	4	48	5				5				
		WB	2	12	4	48	5				5				
		CL	CL	2	50	75	8		8						
		CL	CL	2	100	150	17		17						
		CL	CL	2	200	300	33		33						
FAIRFIELD ROAD	FAIRFIELD ROAD	EB	1	12	4	48	5				5				
		EB	1	12	6	72	8				8				
		EB	1	12	6	72	8				8				
		EB	2	12	6	72	8				8				
		EB	2	12	6	72	8				8				
		WB	1	12	4	48	5				5				
		WB	1	12	4	48	5				5				
		WB	1	12	4	48	5				5				
		WB	1	12	4	48	5				5				
		WB	1	12	6	72	8				8				
		WB	1	12	6	72	8				8				
		EB	1	6	30	180	20	20							
		EB	1	2	50	75	8	8							
		CL	CL	2	100	150	17		17						
		CL	CL	2	100	150	17		17						
		EB	1	2	100	150	17		17						
		EB	1	2	100	150	17		17						
	US. RTE 12	EB	1	2	100	150	17		17						

TOTALS: 479 SY 695 SY 516 SY 3048 FT 22 EACH

..project\136008\design_aa.dgn 4/10/2008 4:22:25 PM User=wilgreendp

ROUTE: IL RTE 132 (GRAND AVENUE) - FROM U.S. ROUTE 45 TO IL ROUTE 59

CROSS STREETS		DIRECTION (EB/WB)	LANE NO. (1, 2, 3)	PAVEMENT PATCH WIDTH	PAVEMENT PATCH LENGTH	REPAIR AREA (SQ FT)	REPAIR AREA (SQ YD)	HMA SURF REM 2-1/4" & RESURF	HMA SURF REM (SP) & RESURF	CLASS D PATCH TYPE I	CLASS D PATCH TYPE II	CLASS D PATCH TYPE III	CLASS D PATCH TYPE IV	PAVT MARKING 4"	RAISED REFL PAVT MKS	
FROM	TO															
U.S 45		WB	2	2	6	12	1		1							
		WB	2	4	10	40	4			4						
		WB	2	4	10	40	4			4						
		C/L	C/L	2	150	225	25		25							
		WB	2	6	10	60	7				7					
		EB	2	6	6	36	4			4						
		EB	2	6	6	36	4			4						
		EB	1	6	12	72	8				8					
		EB	2	4	10	40	4			4						
		EB	1	4	12	48	5				5					
		EB	2	4	6	24	3			3						
		EB	2	4	6	24	3			3						
	SAND LAKE ROAD	SAND LAKE ROAD	EB	2	4	6	24	3			3					
			WB	1	12	15	180	20				20				
		CL	1	2	10	15	2		2							
		WB	2	4	15	60	7				7					
		WB	1	12	8	96	11				11					
		WB	1	12	8	96	11				11					
		WB	1	12	6	72	8				8					
		WB	1	12	6	72	8				8					
		EB	2	4	10	40	4			4						
		EB	1	4	25	100	11				11					
		CL	CL	2	50	75	8		8							
		EB	2	6	12	72	8				8					
		EB	1	6	12	72	8				8					
		EB	2	6	12	72	8				8					
DEEP LAKE ROAD	DEEP LAKE ROAD	EB	2	6	12	72	8				8					
		CL	CL	2	24	36	4		4							
		WB	1	12	40	480	53	53								
		WB	2	12	40	480	53	53								
		WB	1	12	60	720	80	80								
		CL	CL	2	30	45	5		5							
		WB	2	12	100	1200	133	133								
		WB	1	12	6	72	8				8					
		WB	2	12	6	72	8				8					
		WB	1	12	6	72	8				8					
		WB	2	12	6	72	8				8					
		WB	1	12	6	72	8				8					
		WB	2	12	6	72	8				8					
		WB	2	12	15	180	20					20				
	WB	2	12	6	72	8				8						
	WB	2	12	6	72	8				8						
	WB	2	12	6	72	8				8						
	WB	2	12	6	72	8				8						
	WB	2	12	6	72	8				8						
	WB	2	12	6	72	8				8						
	WB	2	12	6	72	8				8						
	WB	2	12	6	72	8				8						
	WB	2	12	6	72	8				8						
	WB	2	12	6	72	8				8						
	WB	2	12	6	72	8				8						
	WB	2	12	6	72	8				8						
	WB	2	12	6	72	8				8						
	CL	CL	2	100	150	17		17								
	CL	CL	2	300	450	50		50								
	CL	CL	2	200	300	33		33								
	CL	CL	2	200	300	33		33								
	EB	1	6	12	72	8				8						
	EB	2	6	12	72	8				8						
	EB	2	6	12	72	8				8						
	CL	CL	2	200	300	33		33								
	EB	1	12	20	240	27					27					
	EB	1	6	12	72	8				8						
	EB	1	6	12	72	8				8						
	EB	1	6	12	72	8				8						
	EB	1	6	12	72	8				8						
	EB	1	6	12	72	8				8						
	IL RTE 83	EB	1	6	12	72	8				8					

CONTINUED ON THE NEXT SHEET

ROUTE: **IL RTE 134 (IL RTE 120 TO US 12 / IL 59)**

CROSS STREETS		DIRECTION (EB/WB) (NB/SB)	LANE NO. (1, 2, 3)	PAVEMENT PATCH WIDTH	PAVEMENT PATCH LENGTH	REPAIR AREA (SQ FT)	REPAIR AREA (SQ YD)	HMA SURF REM 2-1/4" & RESURF	HMA SURF REM (SP) & RESURF	CLASS D PATCH TYPE I	CLASS D PATCH TYPE II	CLASS D PATCH TYPE III	CLASS D PATCH TYPE IV	PAVT MARKING 4"	RAISED REFL PAVT MKS
FROM	TO														
IL RTE 120		EB	1	12	4	48	5				5				
		EB	1	12	4	48	5				5				
	FAIRFIELD ROAD	WB	1	12	4	48	5				5				
FAIRFIELD ROAD		EB	1	12	4	48	5				5				
		EB	1	12	4	48	5				5				
		EB	1	12	4	48	5				5				
		EB	1	12	4	48	5				5				
		EB	1	12	4	48	5				5				
		EB	1	12	6	72	8				8				
		EB	1	12	6	72	8				8				
		EB	1	12	6	72	8				8				
		WB	1	12	4	48	5				5				
		WB	1	12	4	48	5				5				
		EB	1	2	50	75	8		8						
	WILSON ROAD	CL	CL	2	100	150	17		17		17				
WILSON ROAD		WB	1	12	6	72	8				8				
		WB	1	12	6	72	8				8				
	US 12 / IL 59	WB	1	2	50	75	8		8						

TOTALS:

0
SY

33
SY

110
SY

270
FT

6
EACH

ROUTE: IL RTE 173 (Old Mill Creek Road to IL RTE 83)

CROSS STREETS		DIRECTION	LANE	PAVEMENT	PAVEMENT	REPAIR	REPAIR	HMA SURF REM 2-1/4"	HMA SURF REM (SP)	CLASS D	CLASS D	CLASS D	CLASS D	PAVT	RAISED
FROM	TO	(EB/WB) (NB/SB)	NO. (1, 2, 3)	PATCH WIDTH	PATCH LENGTH	AREA (SQ FT)	AREA (SQ YD)	& RESURF	& RESURF	PATCH TYPE I	PATCH TYPE II	PATCH TYPE III	PATCH TYPE IV	MARKING 4"	REFL PAVT MKS
Old Mill Creek Road	Total 20	WB	1,2	12	6	1440	160				160				
		W/B	1	4	14	56	6			6					
		WB	1	2	250	375	42		42						
		W/B	1	2	100	150	17		17						
		W/B	1	12	150	1800	200	200							
	TOTAL 14 EA	WB	1,2	6	12	72	112				112				
		EB	2	2	150	225	25		25						
		EB	RAMP	8	8	64	7				7				
		EB	1	2	100	150	17		17						
		EB	2	2	75	113	13		13						
		EB	1	6	18	108	12				12				
	HUNT CLUB ROAD	EB	2	8	100	800	89	89							
HUNT CLUB ROAD		WB	1	6	12	72	8				8				
		WB	1	12	15	180	20				20				
		CL	1	2	30	45	5		5						
	TOTAL 2 EA	WB	1	12	6	72	16				16				
		WB	1	2	50	75	8				8				
		WB	1	2	200	300	33		33						
		WB	1	2	100	150	17		17						
		WB	1	12	6	72	8				8				
		EB	C.L.	2	100	150	17		17						
		EB	1	12	25	300	33						33		
		WB	1	2	100	150	17		17						
		WB	1	12	25	300	33						33		
		WB	1	2	60	90	10		10						
		WB	1	6	60	360	40	40							
		WB	C.L.	2	200	300	33		30						
		WB	1	2	50	75	8		8						
		WB	1	12	6	72	8				8				
		WB	1	6	20	120	13				13				
		WB	1	2	100	150	17		17						
		EB	1	12	30	360	40						40		
		EB	1	2	100	150	17		17						
		EB	1	6	15	90	10				10				
		EB	1	8	50	400	44	44							
		C.L.	C.L.	2	50	75	8		8						
		EB	1	12	20	240	27						27		
	US RTE 45	WB	1	2	100	150	17		17						
US RTE 45	TOTAL 10 EA	WB/EB	1	12	6	72	80				80				
	TOTAL 2 EA	WB/EB	1	12	8	96	21				21				
		EB	1	6	20	120	13				13				
	TOTAL 2 EA	C.L. & WB	2	100	150	33			33						
		WB	1	8	12	96	11				11				
		WB	1	4	12	48	5				5				
		EB	1	6	10	60	7				7				
	SAVAGE RD.TOT 4 EA	WB	SHLD	4	100	400	178	178							
SAVAGE RD	TOTAL 8 EA	WB/EB	1	12	6	72	64				64				
	TOTAL 2 EA	C.L. & WB	2	100	150	33			33						
	TOTAL 2 EA	WB	1	4	6	24	5				5				
	DEEP LAKE ROAD	W/B	SHLDR	4	200	800	89	89							
DEEP LAKE ROAD	TOTAL 12 EA	WB/EB	1	12	6	72	96				96				
	TOTAL 2 EA	WB/EB	SHLDR	4	100	400	89	89							
	IL RTE 83	C.L.	C.L.	2	100	150	17		17						

TOTALS:

729 SY 393 SY 664 SY 20 SY 133 SY 2800 FT 60 EACH

FILE NAME =
c:\projects\136006\design_sa.dgn

USER NAME = wjlgreendp
DESIGNED -
DRAWN -
PLOT SCALE = 1/8" = 100.0000' / IN.
CHECKED -
PLOT DATE = 4/18/2008

DESIGNED -
DRAWN -
CHECKED -
DATE -

REVISED -
REVISED -
REVISED -
REVISED -

STATE OF ILLINOIS
DEPARTMENT OF TRANSPORTATION

PATCHING SCHEDULE
IL 173

SCALE: SHEET NO. OF SHEETS STA. TO STA.

F.A.P. RTE.	SECTION	COUNTY	TOTAL SHEETS	SHEET NO.
VAR.	2008-020 PP	LAKE	59	44
CONTRACT NO. 60E49				
FED. ROAD DIST. NO. 1 ILLINOIS FED. AID PROJECT				

ROUTE: IL 176 (IL 21 to Roberts Road (McHenry County Line))

CROSS STREETS		DIRECTION (EB/WB) (NB/SB)	LANE NO. (1, 2, 3)	PAVEMENT PATCH WIDTH	PAVEMENT PATCH LENGTH	REPAIR AREA (SQ FT)	REPAIR AREA (SQ YD)	HMA SURF REM 2-1/4" & RESURF	HMA SURF REM (SP) & RESURF	CLASS D PATCH TYPE I	CLASS D PATCH TYPE II	CLASS D PATCH TYPE III	CLASS D PATCH TYPE IV	PAVT MARKING 4"	RAISED REFL PAVT MKS
FROM	TO														
IL 21	Garfield	WB			0	0									
Garfield	Butterfield Road	WB		4	4	16	2			2					
		WB		4	4	16	2			2					
		WB		4	4	16	2			2					
		WB	LT E/P	2	100	150	17		17						
Butterfield Road	Hawley Street	WB		4	4	16	2			2					
		WB		4	4	16	2			2					
		WB		4	100	400	44	44							
		WB		4	6	24	3			3					
		WB		4	4	16	2			2					
		WB	LT E/P	2	200	300	33		33						
Hawley Street	US 45	WB		4	10	40	4			4					
		WB		4	30	120	13				13				
US 45	Midlothian	WB		12	20	240	27					27			
		WB		4	4	16	2			2					
		WB		4	4	16	2			2					
		WB		4	4	16	2			2					
		WB	CL	2	100	150	17		17						
		WB	CL	2	500	750	83		83						
Midlothian	IL 60/83	WB		4	12	48	5				5				
		WB		4	10	40	4			4					
IL 60/83	Gilmer Road	WB		6	6	36	4			4					
		WB		6	20	120	13				13				
Gilmer Road	Fairfield Road	WB		4	6	24	3			3					
		WB		4	4	16	2			2					
		WB		4	4	16	2			2					
		WB		4	4	16	2			2					
		WB		4	4	16	2			2					
Fairfield Road	Main Street (Wauconda)	WB		4	4	16	2			2					
		WB	CL	2	200	300	33		33						
Main Street (Wauconda)	US 12	WB		4	4	16	2			2					
		WB		4	6	24	3			3					
		WB		6	4	24	3			3					
		WB		4	6	24	3			3					
US 12	Darrel Road	WB	RT E/P	2	200	300	33		33						
		WB		4	6	24	3			3					
		WB		4	10	40	4			4					
		WB	CL	2	150	225	25		25						
Darrel Road	Roberts Road	WB		4	4	16	2			2					
		WB		4	6	24	3			3					
		WB		4	6	24	3			3					
						0	0								
Roberts Road	Darrel Road	EB		2	100	150	17		17						
		EB		4	4	16	2			2					
		EB		4	4	16	2			2					
		EB		4	4	16	2			2					
Darrel Road	US 12	EB		4	4	16	2			2					
		EB		4	4	16	2			2					
		EB		4	40	160	18				18				
		EB		4	4	16	2			2					
		EB		4	4	16	2			2					
		EB		24	50	1200	133	133							
US 12	Main Street (Wauconda)	EB		4	4	16	2			2					
		EB		4	4	16	2			2					
		EB		4	4	16	2			2					
		EB		4	4	16	2			2					
		EB		4	6	24	3			3					
		EB		4	4	16	2			2					
		EB		4	4	16	2			2					
		EB		4	4	16	2			2					
		EB		4	4	16	2			2					
		EB		4	4	16	2			2					
Main Street (Wauconda)	Fairfield Road	EB		4	4	16	2			2					

CONTINUED ON THE NEXT SHEET

...projects\dl136808\design_aa.dgn 4/10/2008 4:19:32 PM User=wjgroendp

ROUTE: IL 176 (IL 21 to Roberts Road (McHenry County Line))

CROSS STREETS		DIRECTION (EB/WB) (NB/SB)	LANE NO. (1, 2, 3)	PAVEMENT PATCH WIDTH	PAVEMENT PATCH LENGTH	REPAIR AREA (SQ FT)	REPAIR AREA (SQ YD)	HMA SURF REM 2-1/4" & RESURF	HMA SURF REM (SP) & RESURF	CLASS D PATCH TYPE I	CLASS D PATCH TYPE II	CLASS D PATCH TYPE III	CLASS D PATCH TYPE IV	PAVT MARKING 4"	RAISED REFL PAVT MKS
FROM	TO														
Fairfield Road	Gilmer Road	EB		4	10	40	4			4					
		EB		4	4	16	2			2					
		EB		4	4	16	2			2					
		EB		4	4	16	2			2					
		EB		4	4	16	2			2					
		EB		4	4	16	2			2					
		EB		4	10	40	4			4					
		EB		4	4	16	2			2					
Gilmer Road	IL 60/83	EB		4	4	16	2			2					
		EB		6	20	120	13				13				
		EB		6	20	120	13				13				
		EB		6	20	120	13				13				
		EB		6	6	36	4			4					
		EB		6	25	150	17					17			
		EB		6	25	150	17					17			
		EB		4	6	24	3			3					
		EB		4	6	24	3			3					
		EB		4	4	16	2			2					
IL 60/83	Midlothian	EB		4	6	24	3			3					
		EB		6	10	60	7				7				
		EB		4	4	16	2			2					
		EB		4	4	16	2			2					
		EB		6	10	60	7				7				
Midlothian	US 45	EB		4	4	16	2			2					
		EB		4	4	16	2			2					
		EB		4	12	48	5				5				
		EB		4	12	48	5				5				
US 45	Hawley Street	EB		4	12	48	5				5				
		EB		6	75	450	50	50							
		EB		4	4	16	2			2					
		EB		4	50	200	22	22							
		EB		4	100	400	44	44							
Hawley Street	Butterfield Road	EB		4	4	16	2			2					
		EB		4	4	16	2			2					
		EB	CL	2	200	300	33		33						
		EB		4	4	16	2			2					
		EB	CL	2	500	750	83		83						
		EB		4	150	600	67	67							
Butterfield Road	Garfield Ave.	EB		4	4	16	2			2					
		EB		4	4	16	2			2					
		EB		4	4	16	2			2					
		EB		4	4	16	2			2					
		EB		4	4	16	2			2					
		EB		6	12	72	8				8				
		EB		4	4	16	2			2					
		EB		4	4	16	2			2					
		EB		4	4	16	2			2					
		EB		4	4	16	2			2					
		EB		4	12	48	5				5				
		EB		6	20	120	13				13				
		EB		4	6	24	3			3					
		EB		4	6	24	3			3					
		EB		4	4	16	2			2					
		EB		4	4	16	2			2					
Garfield Ave.	IL 21	EB		3	200	600	67		67						
		EB		4	4	16	2	2							
		EB		4	4	16	2	2							
		EB		4	4	16	2	2							

TOTALS: 366 SY 441 SY 188 SY 143 SY 61 SY 2200 FT 42 EACH

...projects\dl36008\design_a.dgn 4/10/2008 4:18:15 PM User=wlgreendp

ROUTE: IL Rte 176 (Old Rockland Rd to EJ & E Railroad)

CROSS STREETS		DIRECTION (EB/WB) (NB/SB)	LANE NO. (1, 2, 3)	PAVEMENT PATCH WIDTH	PAVEMENT PATCH LENGTH	REPAIR AREA (SQ FT)	REPAIR AREA (SQ YD)	HMA SURF REM 2-1/4" & RESURF	HMA SURF REM (SP) & RESURF	CLASS D PATCH TYPE I	CLASS D PATCH TYPE II	CLASS D PATCH TYPE III	CLASS D PATCH TYPE IV	PAVT MARKING 4"	RAISED REFL PAVT MKS
FROM	TO														
Old Rockland Rd	Entrance Ramp for I94	EB	2	1	2	2	1			1					
Old Rockland Rd	Entrance Ramp for I94	EB	1	1	2	2	1			1					
Old Rockland Rd	Entrance Ramp for I94	EB	1	12	2	24	3			3					
Old Rockland Rd	Entrance Ramp for I94	EB	2	2	3	6	1			1					
Old Rockland Rd	Entrance Ramp for I94	EB	2	3	1	3	1			1					
Old Rockland Rd	Entrance Ramp for I94	EB	1	3	1	3	1			1					
Old Rockland Rd	Entrance Ramp for I94	EB	2	1	1	1	1			1					
Old Rockland Rd	Entrance Ramp for I94	EB	1	12	4	48	5				5				
Old Rockland Rd	Entrance Ramp for I94	EB	2	6	12	72	8				8				
Old Rockland Rd	Entrance Ramp for I94	EB	1	1	1	1	1			1					
Old Rockland Rd	Entrance Ramp for I94	EB	1	3	250	750	83		83						
Old Rockland Rd	Entrance Ramp for I94	EB	1	3	3	9	1			1					
Old Rockland Rd	Entrance Ramp for I94	EB	1	3	3	9	1			1					
Old Rockland Rd	Entrance Ramp for I94	EB	1	3	3	9	1			1					
Old Rockland Rd	Entrance Ramp for I94	EB	LT TL	3	200	600	67		67						
Old Rockland Rd	Entrance Ramp for I94	EB	1	2	2	4	1			1					
Old Rockland Rd	Entrance Ramp for I94	EB	LT TL	8	2	16	2			2					
Old Rockland Rd	Entrance Ramp for I94	EB	2	2	2	4	1			1					
Old Rockland Rd	Entrance Ramp for I94	EB	LT TL	12	2	24	3			3					
Old Rockland Rd	Entrance Ramp for I94	EB	1	12	2	24	3			3					
Old Rockland Rd	Entrance Ramp for I94	EB	1	12	4	48	5				5				
Old Rockland Rd	Entrance Ramp for I94	EB	2	12	4	48	5				5				
Old Rockland Rd	Entrance Ramp for I94	EB	1	12	2	24	3			3					
Old Rockland Rd	Entrance Ramp for I94	EB	2	12	2	24	3			3					
Old Rockland Rd	Entrance Ramp for I94	EB	2	6	2	12	1			1					
Old Rockland Rd	Entrance Ramp for I94	EB	1	12	4	48	5				5				
Old Rockland Rd	Entrance Ramp for I94	EB	2	12	4	48	5				5				
Old Rockland Rd	Entrance Ramp for I94	EB	1	12	2	24	3			3					
Old Rockland Rd	Entrance Ramp for I94	EB	2	12	2	24	3			3					
Old Rockland Rd	Entrance Ramp for I94	EB	2	6	2	12	1			1					
Old Rockland Rd	Entrance Ramp for I94	EB	1	12	4	48	5				5				
Old Rockland Rd	Entrance Ramp for I94	EB	2	3	3	9	1			1					
Old Rockland Rd	Entrance Ramp for I94	EB	1	3	3	9	1			1					
Old Rockland Rd	Entrance Ramp for I94	EB	2	3	3	9	1			1					
Old Rockland Rd	Entrance Ramp for I94	EB	1	12	2	24	3			3					
Old Rockland Rd	Entrance Ramp for I94	EB	2	12	3	36	4			4					
Old Rockland Rd	Entrance Ramp for I94	EB	2	4	4	16	2			2					
Old Rockland Rd	Entrance Ramp for I94	EB	2	4	4	16	2			2					
Old Rockland Rd	Entrance Ramp for I94	EB	2	6	6	36	4			4					
Old Rockland Rd	Entrance Ramp for I94	EB	LT TL	8	36	288	32	32							
Old Rockland Rd	Entrance Ramp for I94	EB	1	12	4	48	5				5				
Entrance Ramp for I94	Exit Ramp for I94	EB	2	2	3	6	1			1					
Entrance Ramp for I94	Exit Ramp for I94	EB	2	3	2	6	1			1					
Entrance Ramp for I94	Exit Ramp for I94	EB	1	12	2	24	3			3					
Entrance Ramp for I94	Exit Ramp for I94	EB	2	12	2	24	3			3					
Entrance Ramp for I94	Exit Ramp for I94	EB	2	6	2	12	1			1					
Entrance Ramp for I94	Exit Ramp for I94	EB	1	3	500	1500	167		167						
Entrance Ramp for I94	Exit Ramp for I94	EB	2	2	2	4	1			1					
Entrance Ramp for I94	Exit Ramp for I94	EB	2	1	1	1	1			1					
Entrance Ramp for I94	Exit Ramp for I94	EB	2	1	1	1	1			1					
Entrance Ramp for I94	Exit Ramp for I94	EB	2	1	1	1	1			1					
Entrance Ramp for I94	Exit Ramp for I94	EB	2	2	3	6	1			1					
Entrance Ramp for I94	Exit Ramp for I94	EB	2	4	4	16	2			2					
Entrance Ramp for I94	Exit Ramp for I94	EB	2	12	2	24	3			3					
Entrance Ramp for I94	Exit Ramp for I94	EB	1	3	700	2100	233		233						
Entrance Ramp for I94	Exit Ramp for I94	EB	1	6	18	108	12				12				
Entrance Ramp for I94	Exit Ramp for I94	EB	2	2	2	4	1			1					
Entrance Ramp for I94	Exit Ramp for I94	EB	2	2	2	4	1			1					
Entrance Ramp for I94	Exit Ramp for I94	EB	2	1	1	1	1			1					
Entrance Ramp for I94	Exit Ramp for I94	EB	2	1	1	1	1			1					
Entrance Ramp for I94	Exit Ramp for I94	EB	2	4	2	8	1			1					
Entrance Ramp for I94	Exit Ramp for I94	EB	2	4	4	16	2			2					
Entrance Ramp for I94	Exit Ramp for I94	EB	2	3	2	6	1			1					
Entrance Ramp for I94	Exit Ramp for I94	EB	2	2	2	4	1			1					
Entrance Ramp for I94	Exit Ramp for I94	EB	2	1	1	1	1			1					
Entrance Ramp for I94	Exit Ramp for I94	EB	1	1	1	1	1			1					
Exit Ramp for I94	Bradley Rd	EB	1	1	1	1	1			1					
Exit Ramp for I94	Bradley Rd	EB	1	1	1	1	1			1					
Exit Ramp for I94	Bradley Rd	EB	1	2	6	12	1			1					
Exit Ramp for I94	Bradley Rd	EB	1	2	6	12	1			1					
Exit Ramp for I94	Bradley Rd	EB	1	2	2	4	1			1					
Exit Ramp for I94	Bradley Rd	EB	2	2	2	4	1			1					
Exit Ramp for I94	Bradley Rd	EB	2	6	12	72	8				8				
Exit Ramp for I94	Bradley Rd	EB	2	4	4	16	2			2					
Exit Ramp for I94	Bradley Rd	EB	2	6	30	180	20					20			

CONTINUED ON THE NEXT SHEET

FILE NAME =	USER NAME = wjgroendp	DESIGNED -	REVISED -	STATE OF ILLINOIS DEPARTMENT OF TRANSPORTATION	PATCHING SCHEDULE IL 176				F.A.P. RTE.	SECTION	COUNTY	TOTAL SHEETS	SHEET NO.
oc:\projects\136038\design_sa.dgn		DRAWN -	REVISED -		SCALE:	SHEET NO.	OF	SHEETS	STA.	TO STA.	LAKE	59	48
		CHECKED -	REVISED -								FED. ROAD DIST. NO. 1	ILLINOIS	FED. AID PROJECT
		DATE -	REVISED -									CONTRACT NO. 60E49	

ROUTE: IL Rte 176 (Old Rockland Rd to EJ & E Railroad)

CROSS STREETS		DIRECTION (EB/WB) (NB/SB)	LANE NO. (1, 2, 3)	PAVEMENT PATCH WIDTH	PAVEMENT PATCH LENGTH	REPAIR AREA (SQ FT)	REPAIR AREA (SQ YD)	HMA SURF REM 2-1/4" & RESURF	HMA SURF REM (SP) & RESURF	CLASS D PATCH TYPE I	CLASS D PATCH TYPE II	CLASS D PATCH TYPE III	CLASS D PATCH TYPE IV	PAVT MARKING 4"	RAISED REFL PAVT MKS
FROM	TO														
Bradley Rd	Railroad X-ing	EB	2	6	12	72	8				8				
Bradley Rd	Railroad X-ing	EB	2	1	1	1	1			1					
Bradley Rd	Railroad X-ing	EB	1	2	6	12	1			1					
Bradley Rd	Railroad X-ing	EB	1	2	2	4	1			1					
Bradley Rd	Railroad X-ing	EB	1	2	2	4	1			1					
Bradley Rd	Railroad X-ing	EB	1	1	2	2	1			1					
Bradley Rd	Railroad X-ing	EB	1	2	2	4	1			1					
Bradley Rd	Railroad X-ing	EB	1	8	2	16	2			2					
Bradley Rd	Railroad X-ing	EB	1	4	2	8	1			1					
Railroad X-ing	Bradley Rd	WB	1	4	2	8	1			1					
Railroad X-ing	Bradley Rd	WB	1	1	1	1	1			1					
Railroad X-ing	Bradley Rd	WB	1	2	2	4	1			1					
Railroad X-ing	Bradley Rd	WB	1	2	4	8	1			1					
Railroad X-ing	Bradley Rd	WB	1	2	4	8	1			1					
Bradley Rd	Exit Ramp for I94	WB	1	1	1	1	1	1							
Bradley Rd	Exit Ramp for I94	WB	1	3	50	150	17		17						
Bradley Rd	Exit Ramp for I94	WB	1	3	50	150	17		17						
Bradley Rd	Exit Ramp for I94	WB	1	2	4	8	1			1					
Bradley Rd	Exit Ramp for I94	WB	LT TL	3	50	150	17		17						
Exit Ramp for I94	Entrance Ramp for I94	WB	1	3	25	75	8				8				
Exit Ramp for I94	Entrance Ramp for I94	WB	1	3	800	2400	267		267						
Exit Ramp for I94	Entrance Ramp for I94	WB	2	2	2	4	1			1					
Exit Ramp for I94	Entrance Ramp for I94	WB	2	2	2	4	1			1					
Exit Ramp for I94	Entrance Ramp for I94	WB	2	4	2	8	1			1					
Exit Ramp for I94	Entrance Ramp for I94	WB	2	4	2	8	1			1					
Exit Ramp for I94	Entrance Ramp for I94	WB	2	6	2	12	1			1					
Exit Ramp for I94	Entrance Ramp for I94	WB	2	12	2	24	3			3					
Exit Ramp for I94	Entrance Ramp for I94	WB	2	6	2	12	1			1					
Exit Ramp for I94	Entrance Ramp for I94	WB	RT TL	6	2	12	1			1					
Exit Ramp for I94	Entrance Ramp for I94	WB	RT TL	8	2	16	2			2					
Exit Ramp for I94	Entrance Ramp for I94	WB	RT TL	8	2	16	2			2					
Exit Ramp for I94	Entrance Ramp for I94	WB	RT TL	12	2	24	3			3					
Exit Ramp for I94	Entrance Ramp for I94	WB	RT TL	3	250	750	83		83						
Exit Ramp for I94	Entrance Ramp for I94	WB	1	12	2	24	3			3					
Exit Ramp for I94	Entrance Ramp for I94	WB	2	12	2	24	3			3					
Exit Ramp for I94	Entrance Ramp for I94	WB	2	2	2	4	1			1					
Entrance Ramp for I94	Old Rockland Rd	WB	1	3	800	2400	267		267						
Entrance Ramp for I94	Old Rockland Rd	WB	1	12	2	24	3			3					
Entrance Ramp for I94	Old Rockland Rd	WB	2	12	2	24	3			3					
Entrance Ramp for I94	Old Rockland Rd	WB	2	12	2	24	3			3					
Entrance Ramp for I94	Old Rockland Rd	WB	2	12	6	72	8				8				
Entrance Ramp for I94	Old Rockland Rd	WB	1	12	4	48	5				5				
Entrance Ramp for I94	Old Rockland Rd	WB	2	12	2	24	3			3					
Entrance Ramp for I94	Old Rockland Rd	WB	1	12	2	24	3			3					
Entrance Ramp for I94	Old Rockland Rd	WB	1	12	2	24	3			3					
Entrance Ramp for I94	Old Rockland Rd	WB	2	4	4	16	2			2					
Entrance Ramp for I94	Old Rockland Rd	WB	2	4	4	16	2			2					
Entrance Ramp for I94	Old Rockland Rd	WB	2	4	4	16	2			2					
Entrance Ramp for I94	Old Rockland Rd	WB	2	4	4	16	2			2					
Entrance Ramp for I94	Old Rockland Rd	WB	2	2	2	4	1			1					
Entrance Ramp for I94	Old Rockland Rd	WB	2	6	6	36	4			4					
Entrance Ramp for I94	Old Rockland Rd	WB	2	2	2	4	1			1					
Entrance Ramp for I94	Old Rockland Rd	WB	2	6	2	12	1			1					
Entrance Ramp for I94	Old Rockland Rd	WB	2	3	50	150	17		17						
Entrance Ramp for I94	Old Rockland Rd	WB	2	3	25	75	8		8						

TOTALS:

33 SY 1243 SY 150 SY 82 SY 20 SY 1650 FT 34 EACH

FILE NAME =
c:\p\proj\136008\design\aa.dgn

USER NAME = wjgreendp
PLOT SCALE = 100.0000 "/ IN.
PLOT DATE = 4/10/2008

DESIGNED -
DRAWN -
CHECKED -
DATE -

REVISED -
REVISED -
REVISED -
REVISED -

STATE OF ILLINOIS
DEPARTMENT OF TRANSPORTATION

PATCHING SCHEDULE
IL 176

SCALE: SHEET NO. OF SHEETS STA. TO STA.

F.A.P. RTE.	SECTION	COUNTY	TOTAL SHEETS	SHEET NO.
VAR.	2008-020 PP	LAKE	59	49
CONTRACT NO. 60E49				

FED. ROAD DIST. NO. 1 ILLINOIS FED. AID PROJECT

ROUTE: Lake Cook Road

CROSS STREETS		DIRECTION (EB/WB) (NB/SB)	LANE NO. (1, 2, 3)	PAVEMENT PATCH WIDTH	PAVEMENT PATCH LENGTH	REPAIR AREA (SQ FT)	REPAIR AREA (SQ YD)	HMA SURF REM 2-1/4" & RESURF	HMA SURF REM (SP) & RESURF	CLASS D PATCH TYPE I	CLASS D PATCH TYPE II	CLASS D PATCH TYPE III	CLASS D PATCH TYPE IV	PAVT MARKING 4"	RAISED REFL PAVT MKS
FROM	TO														
Quentin Road	Ela Road	WB		4	12	48	5				5				
		WB		4	12	48	5				5				
		WB		6	25	150	17				17				
		WB		4	4	16	2			2					
		WB		4	4	16	2			2					
		WB		4	4	16	2			2					
		WB		4	6	24	3			3					
		WB		4	6	24	3			3					
		WB		4	50	200	22	22							
Ela Road	US 14	WB		4	30	120	13				13				
Hart Road	IL 62	WB		4	6	24	3			3					
		WB		4	6	24	3			3					
		WB		4	6	24	3			3					
		WB		4	6	24	3			3					
		WB		4	4	16	2			2					
		WB		4	6	24	3			3					
		WB		4	6	24	3			3					
		WB		4	6	24	3			3					
		WB		4	4	16	2			2					
		WB		4	12	48	5				5				
		WB		6	20	120	13				13				
		WB		6	50	300	33	33							
		WB		4	50	200	22	22							
		WB		4	50	200	22	22							
		WB		4	20	80	9				9				
		WB		4	20	80	9				9				
		WB		4	12	48	5				5				
		WB		4	6	24	3			3					
		WB		4	12	48	5				5				
IL 62	Cook Cty Line	EB		4	4	16	2			2					
Cook Cty Line	Ridge Road	EB		4	6	24	3			3					
		EB		12	100	1200	133	133							
		EB		12	10	120	13				13				
		EB		6	12	72	8				8				
		EB		6	20	120	13				13				
		EB		4	12	48	5				5				
		EB		4	4	16	2			2					
		EB		4	4	16	2			2					
		EB		6	15	90	10				10				
		EB		4	4	16	2			2					
		EB		4	4	16	2			2					
		EB		4	4	16	2			2					
		EB		4	4	16	2			2					
		EB		4	4	16	2			2					
		EB		4	4	16	2			2					
		EB		4	4	16	2			2					
		EB		4	4	16	2			2					
		EB		4	4	16	2			2					
		EB		4	4	16	2			2					
		EB		4	4	16	2			2					
		EB		4	4	16	2			2					
		EB		4	4	16	2			2					
		EB		4	4	16	2			2					
		EB		4	4	16	2			2					
		EB		4	6	24	3			3					
		EB		12	20	240	27						27		

CONTINUED ON THE NEXT SHEET

...projects\dl35003\design_00.dgn 4/18/2008 4:17:26 PM User=wjgraendp

ROUTE: Lake Cook Road

CROSS STREETS		DIRECTION (EB/WB) (NB/SB)	LANE NO. (1, 2, 3)	PAVEMENT PATCH WIDTH	PAVEMENT PATCH LENGTH	REPAIR AREA (SQ FT)	REPAIR AREA (SQ YD)	HMA SURF REM 2-1/4" & RESURF	HMA SURF REM (SP) & RESURF	CLASS D PATCH TYPE I	CLASS D PATCH TYPE II	CLASS D PATCH TYPE III	CLASS D PATCH TYPE IV	PAVT MARKING 4"	RAISED REFL PAVT MKS
FROM	TO														
Ridge Road	Hart Road	EB		4	12	48	5				5				
		EB		4	6	24	3			3					
		EB		4	6	24	3			3					
		EB		4	4	16	2			2					
		EB		4	4	16	2			2					
		EB		4	4	16	2			2					
		EB		6	15	90	10				10				
		EB		12	20	240	27						27		
		EB		12	15	180	20					20			
		EB		4	6	24	3			3					
		EB		4	6	24	3			3					
		EB		12	20	240	27						27		
		EB		6	20	120	13				13				
		EB		6	30	180	20					20			
		EB		6	12	72	8				8				
		EB		6	4	24	3			3					
		EB		4	50	200	22	22							
		EB		4	4	16	2			2					
		EB		4	4	16	2			2					
		EB		4	6	24	3			3					
		EB		4	6	24	3			3					
		EB		4	4	16	2			2					
		EB		4	4	16	2			2					
		EB		12	10	120	13				13				
		EB		6	30	180	20					20			
		EB		4	12	48	5				5				
		EB		4	15	60	7				7				
		EB		4	4	16	2			2					
		EB		4	40	160	18					18			
		EB		4	6	24	3			3					
		EB		4	6	24	3			3					
		EB		6	20	120	13				13				
		EB		4	6	24	3			3					
		EB		12	20	240	27						27		
		EB		4	4	16	2			2					
		EB		6	100	600	67	67							
		EB		6	10	60	7				7				
US 14	Ela Road	EB		4	12	48	5				5				
		EB		4	4	16	2			2					
		EB		4	6	24	3			3					
Ela Road	Quentin Road	EB		6	100	600	67	67							
		EB		6	50	300	33	33							
		EB		6	50	300	33	33							
		EB		6	6	36	4			4					
		EB		6	100	600	67	67							
		EB		6	20	120	13				13				
		EB		4	6	24	3			3					
		EB		6	10	60	7				7				
		EB		4	10	40	4			4					
		EB		3	30	90	10		10						
		EB		4	12	48	5			5					

TOTALS: 521 SY 10 SY 132 SY 241 SY 78 SY 108 SY 812 FT 40 EACH

...projects\dl36208\design_00.dgn 4/10/2008 4:17:07 PM User=wlgreendp

ROUTE: Midlothian Road (IL 176 to IL 22)

CROSS STREETS		DIRECTION (EB/WB) (NB/SB)	LANE NO. (1, 2, 3)	PAVEMENT PATCH WIDTH	PAVEMENT PATCH LENGTH	REPAIR AREA (SQ FT)	REPAIR AREA (SQ YD)	HMA SURF REM 2-1/4" & RESURF	HMA SURF REM (SP) & RESURF	CLASS D PATCH TYPE I	CLASS D PATCH TYPE II	CLASS D PATCH TYPE III	CLASS D PATCH TYPE IV	PAVT MARKING 4"	RAISED REFL PAVT MKS
FROM	TO														
IL 176	Hawley Street	SB		4	4	16	2			2					
Hawley Street	IL 60/83	SB		4	12	48	5				5				
		SB		4	4	16	2			2					
		SB		4	4	16	2			2					
		SB	CL	2	200	300	33		33						
		SB		4	6	24	3			3					
		SB		4	4	16	2			2					
IL 60/83	Gilmer Road	SB		4	6	24	3								
		SB		4	4	16	2			2					
		SB	LT E/P	2	200	300	33		33						
		SB		4	4	16	2			2					
		SB		6	10	60	7				7				
		SB		4	20	80	9				9				
		SB	RT E/P	2	200	300	33		33						
		SB	CL	2	200	300	33		33						
		SB		4	10	40	4			4					
		SB	RT E/P	2	200	300	33		33						
Gilmer Road	Old McHenry Road	SB		4	4	16	2			2					
		SB		4	4	16	2			2					
		SB		4	4	16	2			2					
		SB		4	4	16	2			2					
		SB		8	30	240	27						27		
		SB	Rt Turn	6	6	36	4			4					
		SB		4	4	16	2			2					
		SB		12	25	300	33						33		
Old McHenry Road	Oakwood	SB		4	4	16	2			2					
		SB		4	4	16	2			2					
		SB		4	4	16	2			2					
		SB		4	4	16	2			2					
Oakwood	IL 22	SB		4	4	16	2			2					
		SB		4	4	16	2			2					
IL 22	Oakwood	NB		4	6	24	3			3					
		NB		12	25	300	33						33		
		NB		4	4	16	2			2					
Oakwood	Old McHenry Road	NB		4	12	48	5				5				
		NB		4	4	16	2			2					
		NB		4	100	400	44	44							
		NB		4	4	16	2			2					
		NB		12	50	600	67	67							
Old McHenry Road	Gilmer Road	NB		4	4	16	2			2					
		NB		4	4	16	2			2					
Roberts Road	Darrel Road	NB		4	6	24	3			3					
		NB		4	6	24	3			3					
		NB		4	4	16	2			2					
		NB		4	4	16	2			2					
		NB		4	12	48	5				5				
		NB		4	4	16	2			2					
		NB		2	150	225	25		25						
Gilmer Road	IL 60/83	NB		4	4	16	2			2					
		NB		4	4	16	2			2					
		NB		4	4	16	2			2					
		NB		4	10	40	4			4					
		NB		4	6	24	3			3					
		NB		4	6	24	3			3					
		NB		4	4	16	2			2					
		NB		4	4	16	2			2					
		NB		4	4	16	2			2					
		NB		4	4	16	2			2					
		NB	CL	2	150	225	25		25						
IL 60/83	Hawley Street	NB		4	4	16	2			2					
		NB		4	4	16	2			2					
		NB		4	4	16	2			2					
		NB	RT E/P	2	150	225	25		25						
Hawley Street	IL 176	NB		4	4	16	2			2					
		NB		4	10	40	4			4					
		NB		4	10	40	4			4					

111 SY 240 SY 104 SY 32 SY 93 SY 1300 FT 14 EACH

FILE NAME = c:\projects\dl36008\design_aa.dgn
 USER NAME = wlgroendp
 PLOT SCALE = 100.0000 / IN.
 PLOT DATE = 4/10/2008

DESIGNED -	REVISED -
DRAWN -	REVISED -
CHECKED -	REVISED -
DATE -	REVISED -

STATE OF ILLINOIS
DEPARTMENT OF TRANSPORTATION

PATCHING SCHEDULE
MIDLOTHIAN RD.

SCALE: SHEET NO. OF SHEETS STA. TO STA.

F.A.P. RTE.	SECTION	COUNTY	TOTAL SHEETS	SHEET NO.
VAR.	2008-020 PP	LAKE	59	52
CONTRACT NO. 60E49				
FED. ROAD DIST. NO. 1 ILLINOIS FED. AID PROJECT				

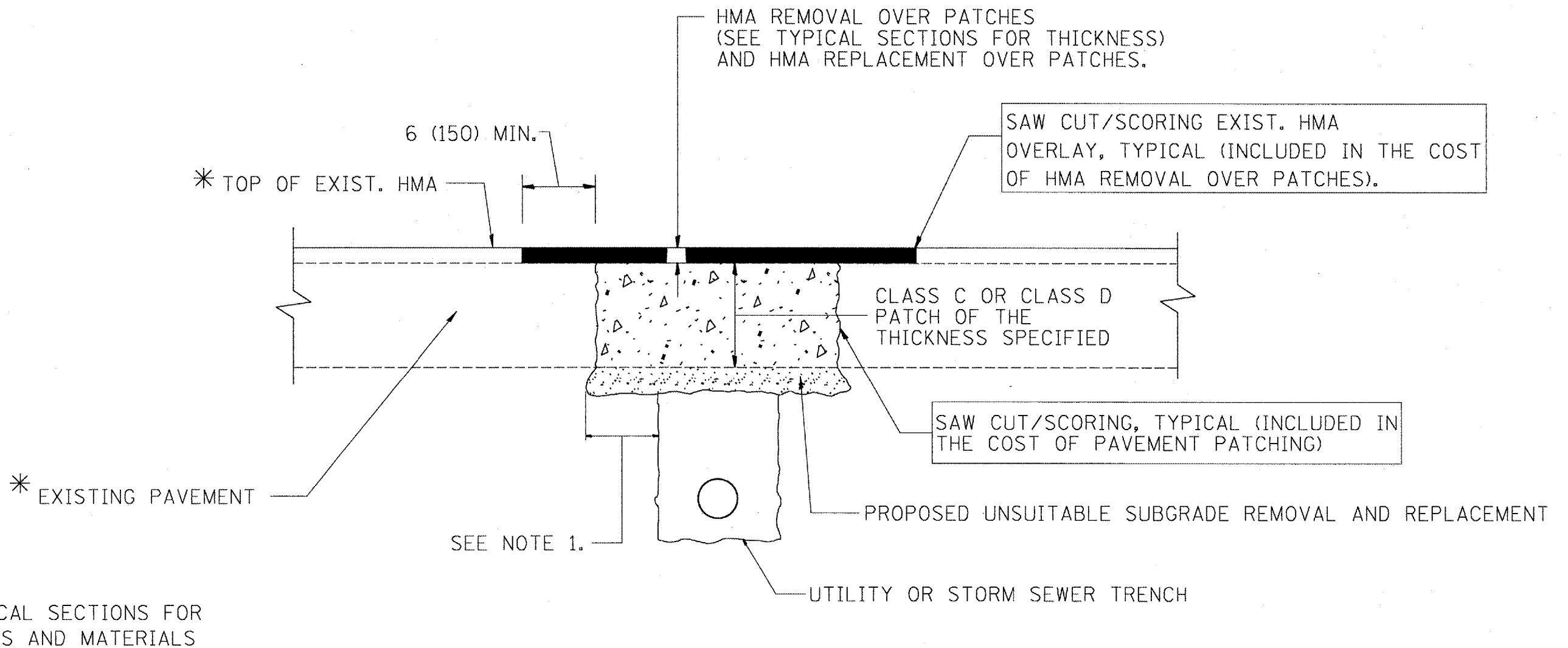

* SEE TYPICAL SECTIONS FOR THICKNESS AND MATERIALS

NOTES:

1. THE WIDTH OF THE FULL DEPTH PATCH OVER A TRENCH SHALL BE 12 (300) WIDER ON EACH SIDE OF THE TRENCH.
2. FOR METHOD OF MEASUREMENT AND BASIS OF PAYMENT, SEE RECURRING SPECIAL PROVISION "PATCHING WITH HOT-MIX ASPHALT OVERLAY REMOVAL".
3. THE TOP 1 1/2 INCHES OF PROPOSED HOT-MIX ASPHALT REPLACEMENT OVER PATCHES SHALL BE HOT-MIX ASPHALT SURFACE COURSE, MIX "D", N70. THE COST SHALL BE INCLUDED IN THE COST OF THE PAY ITEM FOR HOT-MIX ASPHALT REPLACEMENT OVER PATCHES.

SEQUENCE OF CONSTRUCTION

1. REMOVE THE EXISTING HMA MATERIAL OVER THE AREA TO BE PATCHED.
2. REMOVE AND REPLACE FULL DEPTH PATCHES
3. REPLACE HMA MATERIAL OVER THE AREA TO BE PATCHED.

ALL DIMENSIONS ARE IN INCHES (MILLIMETERS) UNLESS OTHERWISE SHOWN.

FILE NAME =	USER NAME = wlgreendp	DESIGNED - R. SHAH	REVISED - A. ABBAS 01-20-98	STATE OF ILLINOIS DEPARTMENT OF TRANSPORTATION	SPECIAL DETAIL PAVEMENT PATCHING FOR HMA SURFACED PAVEMENT			F.A. . RTE.	SECTION	COUNTY	TOTAL SHEETS	SHEET NO.
\\dist\ntfs2\users\wlgreendp\Desktop\bd22.dgn		DRAWN -	REVISED - A. ABBAS 04-27-98		VAR.	2008-020 PP	LAKE	59	53			
PLOT SCALE = 100.000 ' / IN.		CHECKED -	REVISED - R. BORO 01-01-07		BD400-04 (BD-22)			CONTRACT NO. 60E49				
PLOT DATE = 4/18/2008		DATE - 10-25-94	REVISED - R. BORO 09-04-07		SCALE: NONE	SHEET NO. 1 OF 1 SHEETS	STA.	TO STA.		FED. ROAD DIST. NO. 1 ILLINOIS FED. AID PROJECT		

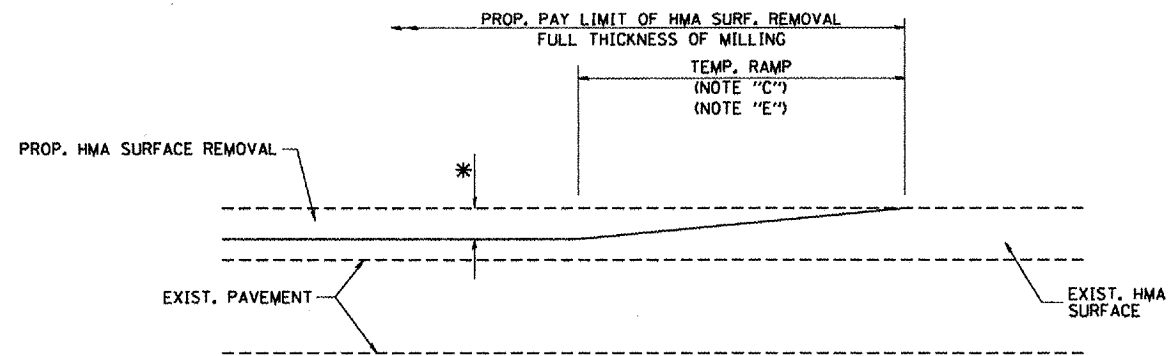

MILLED TEMPORARY RAMP
(FOR BUTT JOINT AND HMA TAPER SEE DETAIL BELOW)

OPTION 1

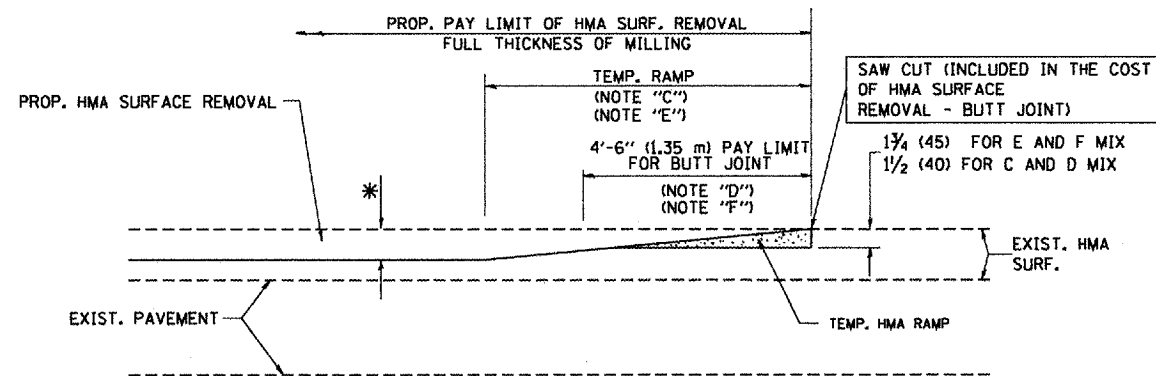

HMA CONSTRUCTED TEMPORARY RAMP
(FOR BUTT JOINT AND HMA TAPER SEE DETAIL BELOW)

OPTION 2

TYPICAL TEMPORARY RAMP

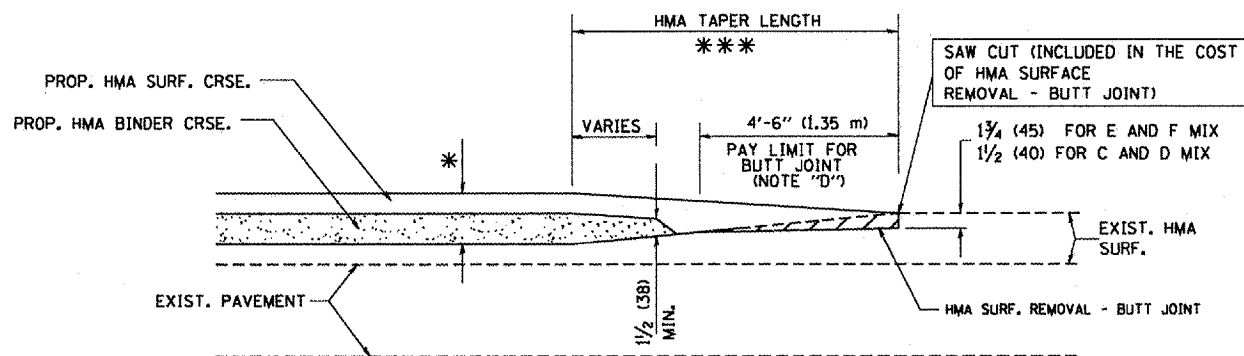

BUTT JOINT AND
HMA TAPER

TYPICAL BUTT JOINT AND HMA TAPER
FOR MILLING AND RESURFACING

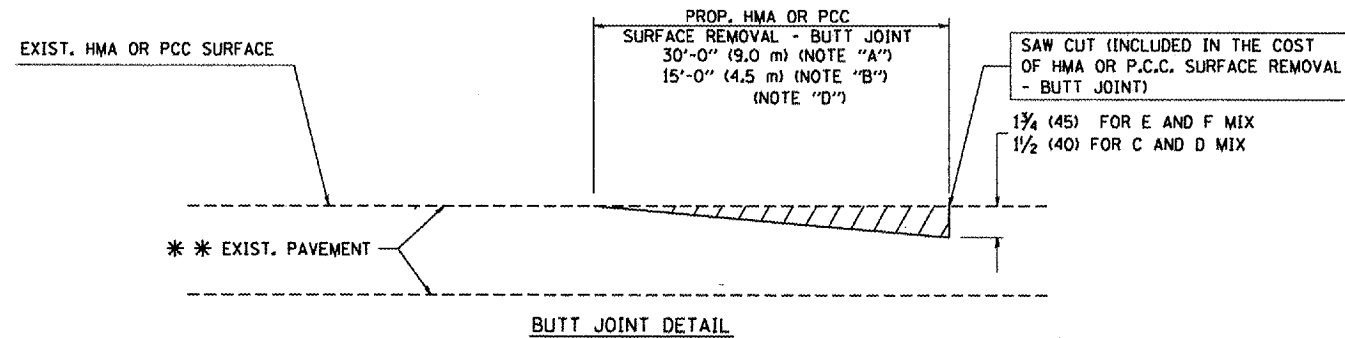

BUTT JOINT DETAIL

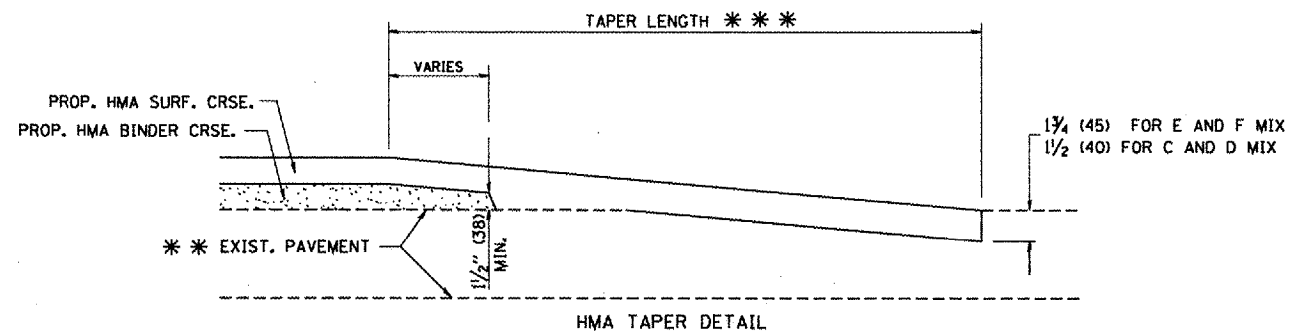

HMA TAPER DETAIL

TYPICAL BUTT JOINT AND HMA TAPER
FOR RESURFACING ONLY

*** PC CONCRETE, HMA OR HMA RESURFACED PAVEMENT.

NOTES

- A: MAINLINE ROADWAYS AND MAJOR SIDE ROADS.
 - B: MINOR SIDE ROADS.
 - C: THE TEMP. RAMP SHALL BE CONSTRUCTED IMMEDIATELY UPON REMOVAL OF THE EXISTING HMA SURFACE.
 - D: THE BUTT JOINT SHALL BE CONSTRUCTED IMMEDIATELY PRIOR TO PLACING THE PROPOSED HMA COURSES.
 - E: TAPER THE TEMP. RAMP AT A RATE OF 3'-0" (900 mm) PER 1 INCH (25 mm) OF MILLING THICKNESS.
 - F: INSTALLATION AND REMOVAL OF THE 4'-6" (1.35 m) TEMP. RAMP IS INCLUDED IN COST OF HMA SURFACE REMOVAL - BUTT JOINT
 - G: SEE ARTICLE 406.08 AND 406.14 OF THE STANDARD SPECIFICATIONS FOR "HMA AND/OR PCC SURFACE REMOVAL, BUTT JOINT".
- * SEE TYPICAL SECTIONS FOR MILLING THICKNESS.
- *** 20'-0" (6.1 m) PER 1 (25) RESURFACING (NOTE "A")
10'-0" (3.0 m) PER 1 (25) RESURFACING (NOTE "B")

BASIS OF PAYMENT:

THE BUTT JOINT WILL BE PAID FOR AT THE CONTRACT UNIT PRICE PER SQUARE YARD (SQUARE METER) FOR "HOT-MIX ASPHALT SURFACE REMOVAL - BUTT JOINT" OR FOR "PORTLAND CEMENT CONCRETE SURFACE REMOVAL - BUTT JOINT".

ALL DIMENSIONS ARE IN INCHES (MILLIMETERS) UNLESS OTHERWISE SHOWN.

FILE NAME = W:\detroit\22x34\bd32.dgn	USER NAME = geglennobc	DESIGNED - M. DE YONG	REVISED - R. SHAH 10-25-94
		DRAWN -	REVISED - A. ABBAS 03-21-97
	PLOT SCALE = 50.0000' / IN.	CHECKED -	REVISED - M. GOMEZ 04-06-01
	PLOT DATE = 1/4/2000	DATE - 06-13-90	REVISED - R. BORO 01-01-07

STATE OF ILLINOIS
DEPARTMENT OF TRANSPORTATION

BUTT JOINT AND HMA TAPER DETAILS		F.A. RTE.	SECTION	COUNTY	TOTAL SHEETS	SHEET NO.
SCALE: NONE	SHEET NO. 1 OF 1 SHEETS	VAR.	2008-020 PP	LAKE	59	54
			BD400-05	BD32	CONTRACT NO. 60549	
			FED. ROAD DIST. NO. 1 (ILLINOIS) FED. AID PROJECT			

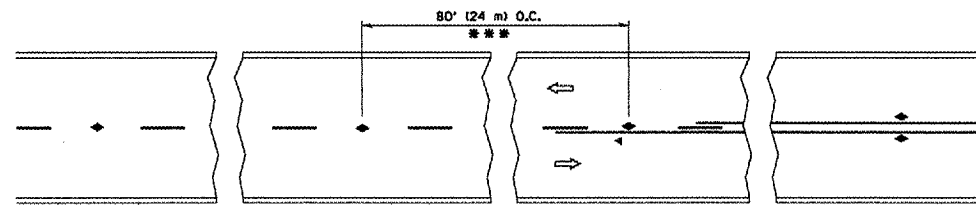

*** REDUCE TO 40' (12 m) O.C. ON CURVES WITH POSTED OR ADVISORY SPEED 45 M.P.H. (70 km/h) OR LESS.

TWO-LANE/TWO-WAY

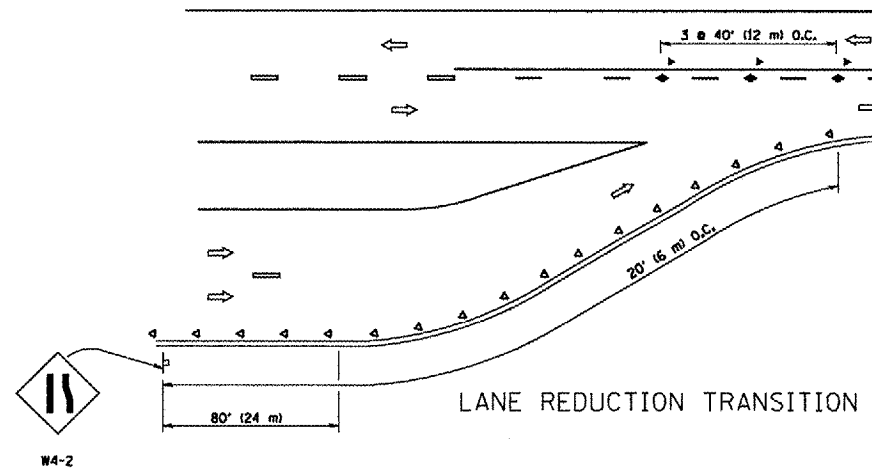

LANE REDUCTION TRANSITION

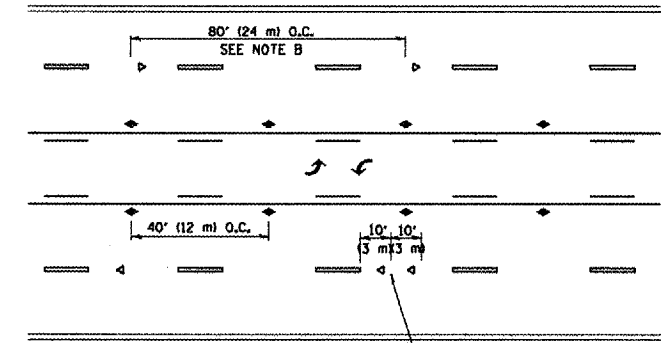

SEE NOTE A

TWO-WAY LEFT TURN

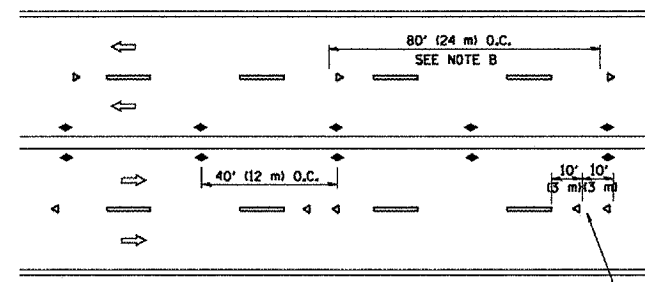

SEE NOTE A

MULTI-LANE/UNDIVIDED

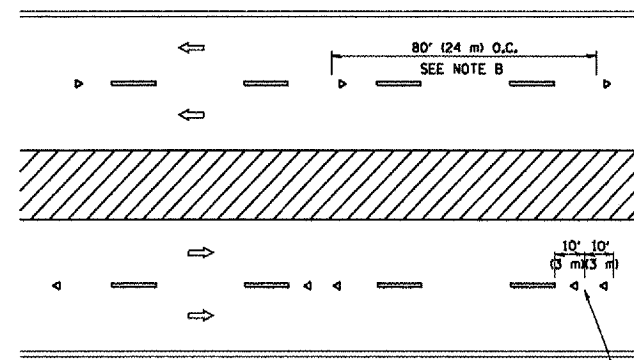

SEE NOTE A

MULTI-LANE/DIVIDED

GENERAL NOTES

1. MARKERS USED WITH DASHED LINES SHALL BE CENTERED IN THE GAP BETWEEN SEGMENTS.
2. MARKERS USED ADJACENT TO SOLID LINES SHALL BE OFFSET 2 TO 3 (50 TO 75) TOWARD TRAFFIC AS SHOWN.
3. MARKERS THROUGH TANGENTS LESS THAN 500' (150 m) IN LENGTH BETWEEN CURVES SHALL BE INSTALLED AT THE LESSER OF THE TWO CURVE SPACINGS.

LANE MARKER NOTES

- B. REDUCE TO 40' (12 m) O.C. ON CURVES WHERE ADVISORY SPEEDS ARE 10 M.P.H. (16 km/h) LOWER THAN POSTED SPEEDS.

- A. USE DOUBLE LANE LINE MARKERS SPACED AS SHOWN.

SYMBOLS

- YELLOW STRIPE
- WHITE STRIPE
- ◀ ONE-WAY AMBER MARKER
- ◀ ONE-WAY CRYSTAL MARKER (W/O)
- ◀ TWO-WAY AMBER MARKER

DESIGN NOTES

1. DOUBLE LANE LINE MARKERS SHALL BE USED UNLESS SPECIFIED OTHERWISE.
2. EXCEPT AS SHOWN ON THE LANE REDUCTION TRANSITION AND FREEWAY EXIT RAMP DETAIL, MARKERS ARE NOT TO BE SPECIFIED ON RIGHT EDGE LINES.
3. THE EXACT MARKER LIMITS, SPACING, AND COLOR SHOULD BE INCLUDED IN THE PLANS.
4. MARKERS SHOULD NOT BE USED ALONGSIDE CURBS EXCEPT FOR EXTREMELY SHORT SECTIONS OF CURBS WHERE NOT MORE THAN TWO MARKERS WOULD BE INVOLVED.

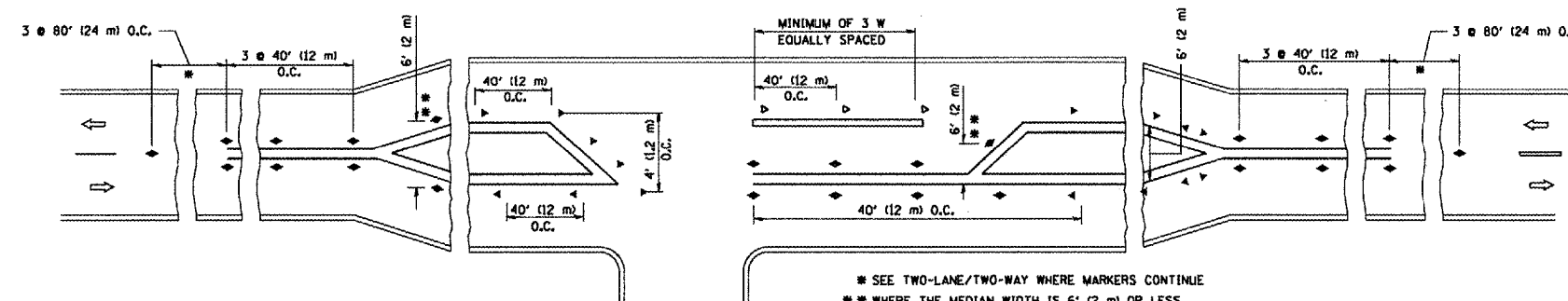

* SEE TWO-LANE/TWO-WAY WHERE MARKERS CONTINUE
 ** WHERE THE MEDIAN WIDTH IS 6' (2 m) OR LESS USE TWO-WAY MARKERS.

LEFT TURN

All dimensions are in inches (millimeters) unless otherwise shown.

FILE NAME = M:\diststd\22434\tol1.dgn	USER NAME = gaglionobts	DESIGNED -	REVISED - T. RAMMACHER 09-19-94
		DRAWN -	REVISED - T. RAMMACHER 03-12-99
	PLOT SCALE = 50.000' / IN.	CHECKED -	REVISED - T. RAMMACHER 01-06-00
	PLOT DATE = 1/4/2000	DATE -	REVISED -

STATE OF ILLINOIS
 DEPARTMENT OF TRANSPORTATION

TYPICAL APPLICATIONS			
RAISED REFLECTIVE PAVEMENT MARKERS (SNOW-PLOW RESISTANT)			
SCALE: NONE	SHEET NO. 1 OF 1 SHEETS	STA.	TO STA.

F.A. RTE.	SECTION	COUNTY	TOTAL SHEETS	SHEET NO.
VAR 2008-020 PP	LAKE	59	53	
TC-11			CONTRACT NO. 60E49	
FED. ROAD DIST. NO. 1 ILLINOIS FED. AID PROJECT				

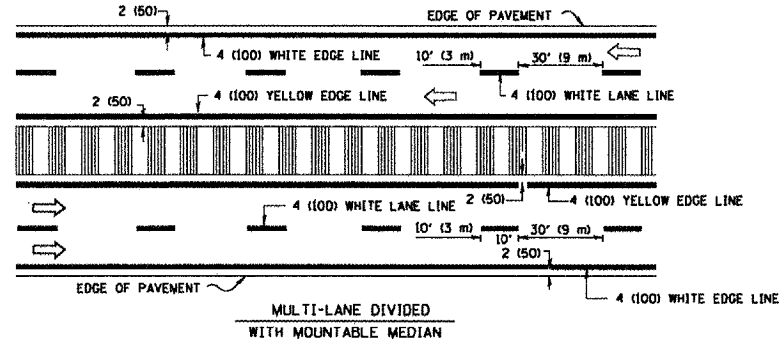
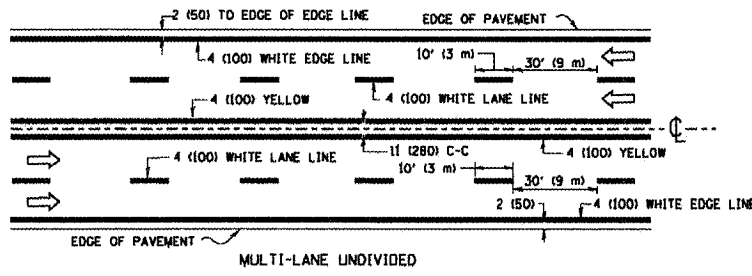
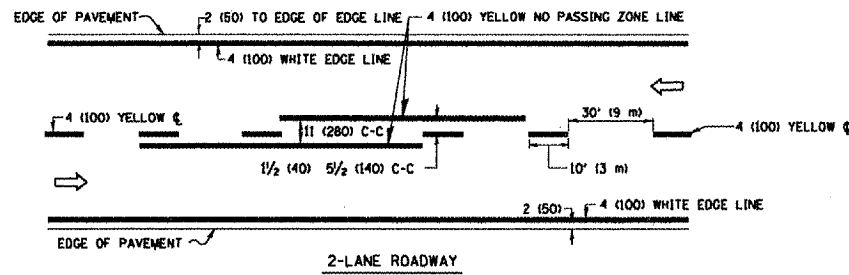

TYPICAL LANE AND EDGE LINE MARKING

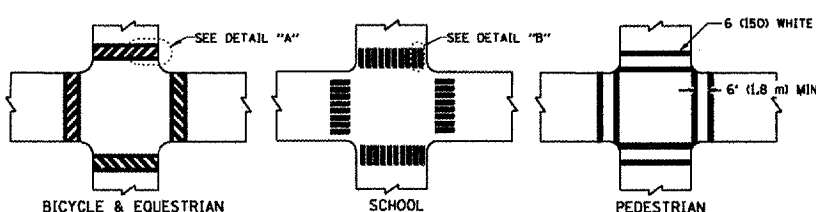

TYPICAL CROSSWALK MARKING

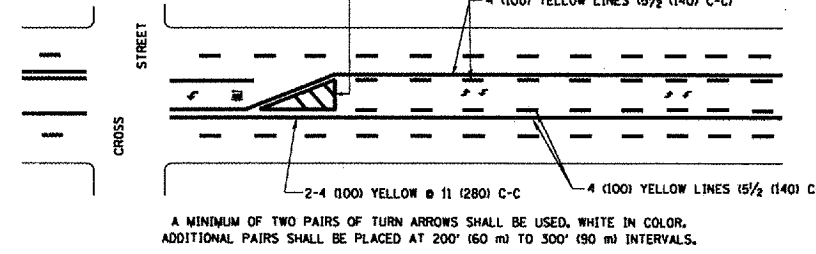
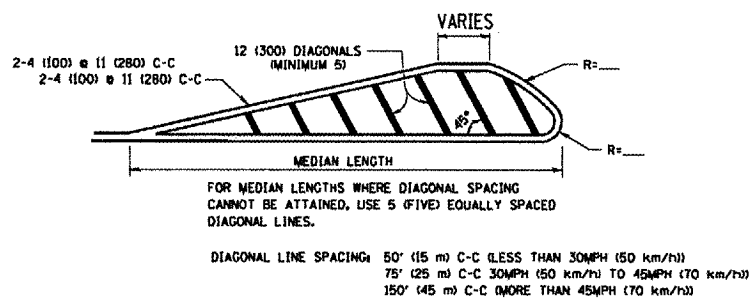
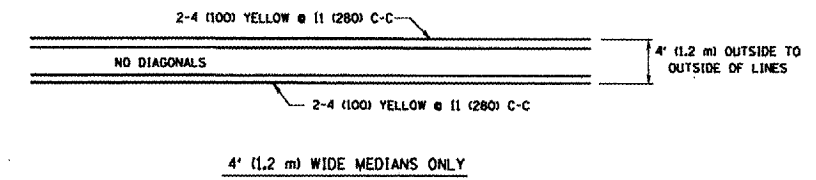

TYPICAL PAINTED MEDIAN MARKING

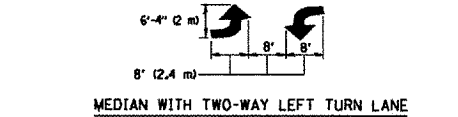

TYPICAL TURN LANE MARKING

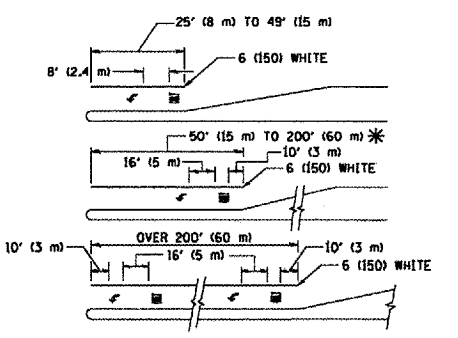

TYPICAL LEFT (OR RIGHT) TURN LANE

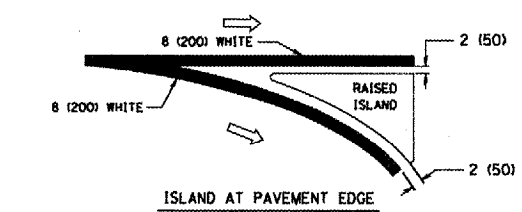
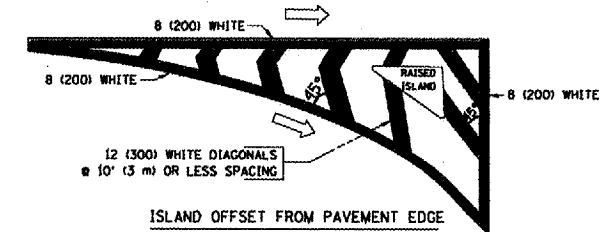

TYPICAL ISLAND MARKING

TYPE OF MARKING	WIDTH OF LINE	PATTERN	COLOR	SPACING / REMARKS
CENTERLINE ON 2 LANE PAVEMENT	4 (100)	SKIP-DASH	YELLOW	10' (3 m) LINE WITH 30' (9 m) SPACE
CENTERLINE ON MULTI-LANE UNDIVIDED PAVEMENT	2 @ 4 (100)	SOLID	YELLOW	11 (280) C-C
NO PASSING ZONE LINES FOR ONE DIRECTION FOR BOTH DIRECTIONS	4 (100) 2 @ 4 (100)	SOLID SOLID	YELLOW YELLOW	5/2 (140) C-C FROM SKIP-DASH CENTERLINE 11 (280) C-C OMIT SKIP-DASH CENTERLINE BETWEEN
LANE LINES	4 (100) 5 (125) ON FREEWAYS	SKIP-DASH SKIP-DASH	WHITE WHITE	10' (3 m) LINE WITH 30' (9 m) SPACE
DOTTED LINES (EXTENSIONS OF CENTER, LANE OR TURN LANE MARKINGS)	SAME AS LINE BEING EXTENDED	SKIP-DASH	SAME AS LINE BEING EXTENDED	2' (600) LINE WITH 6' (1.8 m) SPACE
EDGE LINES	4 (100)	SOLID	YELLOW-LEFT WHITE-RIGHT	OUTLINE MOUNTABLE MEDIANS IN YELLOW; EDGE LINES ARE NOT USED NEXT TO BARRIER CURB
TURN LANE MARKINGS	6 (150) LINE; FULL SIZE LETTERS & SYMBOLS (8' (2.4 m))	SOLID	WHITE	SEE TYPICAL TURN LANE MARKING DETAIL
TWO WAY LEFT TURN MARKING	2 @ 4 (100) EACH DIRECTION 8' (2.4 m) LEFT ARROW	SKIP-DASH AND SOLID IN PAIRS	YELLOW WHITE	10' (3 m) LINE WITH 30' (9 m) SPACE FOR SKIP-DASH 5/2 (140) C-C BETWEEN SOLID LINE AND SKIP-DASH LINE SEE TYPICAL TWO-WAY LEFT TURN MARKING DETAIL
CROSSWALK LINES (PEDESTRIAN A. DIAGONALS (BIKE & EQUESTRIAN B. LONGITUDINAL BARS (SCHOOL))	2 @ 6 (150) 12 (300) @ 45° 12 (300) @ 90°	SOLID SOLID SOLID	WHITE WHITE WHITE	NOT LESS THAN 6' (1.8 m) APART 2' (600) APART SEE TYPICAL CROSSWALK MARKING DETAILS.
STOP LINES	24 (600)	SOLID	WHITE	PLACE 4' (1.2 m) IN ADVANCE OF AND PARALLEL TO CROSSWALK, IF PRESENT. OTHERWISE, PLACE AT DESIRED STOPPING POINT. PARALLEL TO CROSSROAD CENTERLINE, WHERE POSSIBLE.
PAINTED MEDIANS	2 @ 4 (100) WITH 12 (300) DIAGONALS @ 45° NO DIAGONALS USED FOR 4' (1.2 m) WIDE MEDIANS	SOLID	YELLOW; TWO WAY TRAFFIC WHITE; ONE WAY TRAFFIC	11 (280) C-C FOR THE DOUBLE LINE SEE TYPICAL PAINTED MEDIAN MARKING.
CORE MARKING AND CHANNELIZING LINES	8 (200) WITH 12 (300) DIAGONALS @ 45°	SOLID	WHITE	DIAGONALS: 15' (4.5 m) C-C (LESS THAN 30MPH (50 km/h)) 20' (6 m) C-C (30MPH (50 km/h) TO 45MPH (70 km/h)) 30' (9 m) C-C (OVER 45MPH (70 km/h))
RAILROAD CROSSING	24 (600) TRANSVERSE LINES; "RR" IS 6' (1.8 m) LETTERS; 16 (400) LINE FOR "X"	SOLID	WHITE	SEE STATE STANDARD 780001 AREA OF: "R"=3.6 SQ. FT. (0.33 m ²) EACH "X"=54.0 SQ. FT. (5.0 m ²)
SHOULDER DIAGONALS	12 (300) @ 45°	SOLID	WHITE - RIGHT YELLOW - LEFT	50' (15 m) C-C (LESS THAN 30MPH (50 km/h)) 75' (25 m) C-C (30 MPH (50 km/h) TO 45MPH (70 km/h)) 150' (45 m) C-C (OVER 45MPH (70 km/h))

FOR FURTHER DETAILS ON PAVEMENT MARKING REFER TO STANDARD SPECIFICATIONS FOR ROAD AND BRIDGE CONSTRUCTION AND STATE STANDARD 780001.

All dimensions are in inches (millimeter) unless otherwise shown.

FILE NAME = W:\dists\22x34\13.dgn	USER NAME = gajlionabt	DESIGNED - EVERS	REVISED - T. RAMMACHER 10-27-94
		DRAWN -	REVISED - A. HOUSEH 10-09-96
	PLOT SCALE = 5/8" = 1' IN.	CHECKED -	REVISED - A. HOUSEH 10-17-96
	PLOT DATE = 1/4/2008	DATE - 03-19-90	REVISED - T. RAMMACHER 01-06-00

STATE OF ILLINOIS
DEPARTMENT OF TRANSPORTATION

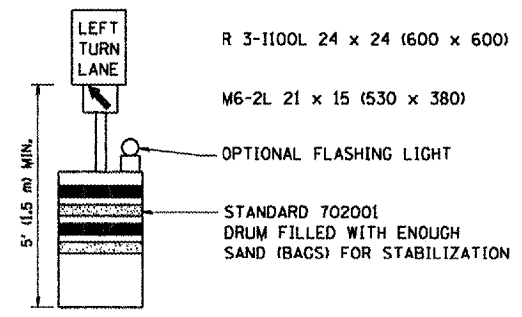
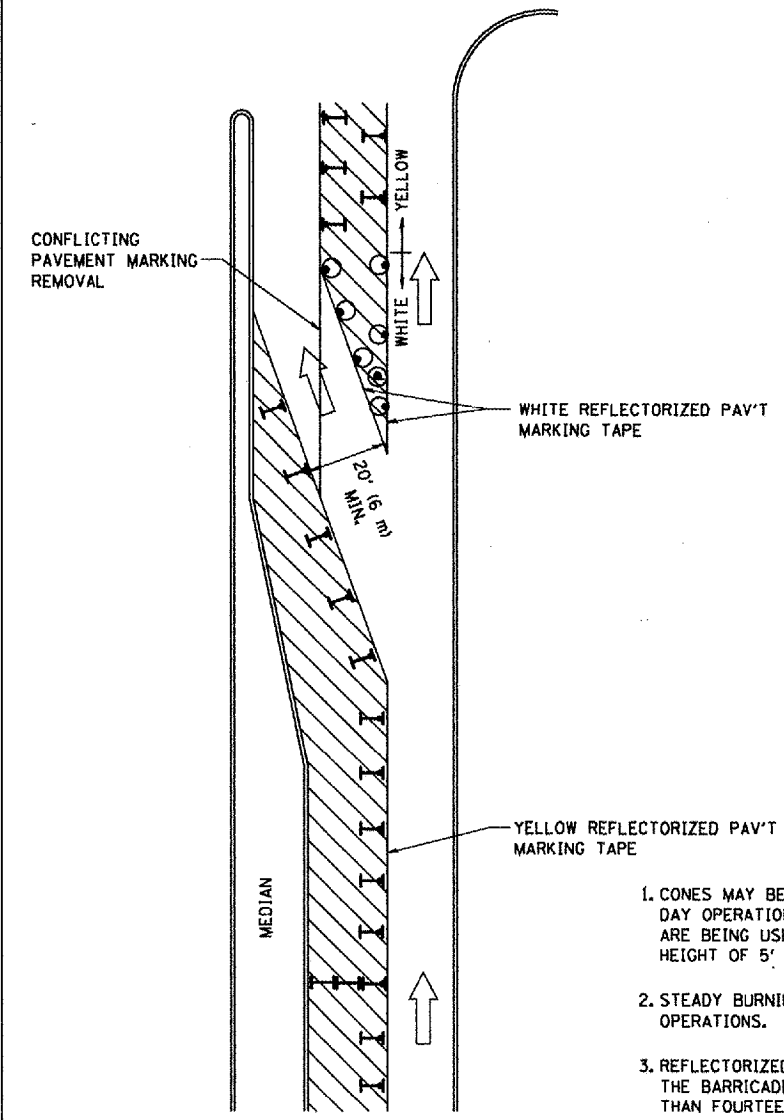

DISTRICT ONE		F.A. RTE.	SECTION	COUNTY	TOTAL SHEETS	SHEET NO.
TYPICAL PAVEMENT MARKINGS		VAL 2008-020 PP	LAKE	59	50	60849
SCALE: NONE	SHEET NO. 1 OF 1 SHEETS	STA.	TO STA.	FED. ROAD DIST. NO. 1 (ILLINOIS) FED. AID PROJECT		



GENERAL NOTES

1. CONES MAY BE SUBSTITUTED FOR BARRICADES OR DRUMS AT HALF THE SPACING DURING DAY OPERATIONS. CONES SHALL BE A MINIMUM OF 28 (710) IN HEIGHT. WHEN CONES ARE BEING USED, THE "LEFT TURN LANE" SIGN MAY BE SKID MOUNTED AT A MINIMUM HEIGHT OF 5' (1.5 m).
2. STEADY BURNING LIGHTS WILL NOT BE REQUIRED ON BARRICADES OR DRUMS FOR DAY OPERATIONS. ALL LIGHTS SHALL BE MONODIRECTIONAL.
3. REFLECTORIZED TEMPORARY PAVEMENT MARKING TAPE SHALL BE PLACED THROUGHOUT THE BARRICADED AREA OF EACH TURN BAY WHERE THE CLOSURE TIME IS GREATER THAN FOURTEEN DAYS.
4. THIS APPLICATION ALSO APPLIES WHEN WORK IS BEING PERFORMED IN THE RIGHT LANE(S) AND THE RIGHT TURN BAY IS TO REMAIN OPEN. UNDER THIS CONDITION, "RIGHT TURN LANE" R3-100 24 x 24 (600 x 600) AND M6-2R 21 x 15 (530 x 380) SHALL BE USED.
5. THESE CONTROLS SHALL SUPPLEMENT MAINLINE TRAFFIC CONTROL FOR LANE CLOSURES.
6. LONGITUDINAL DIMENSIONS MAY BE ADJUSTED TO FIT FIELD CONDITIONS.
7. FORM BT 725 IS REQUIRED.
8. TRAFFIC CONTROL AND PROTECTION AT TURN BAYS (TO REMAIN OPEN TO TRAFFIC) SHALL BE INCLUDED IN THE COST SPECIFIED TRAFFIC CONTROL STANDARDS OR ITEMS.

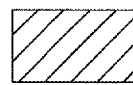
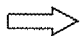
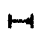
LEGEND

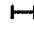
-  WORK AREA
-  LANE OPEN TO TRAFFIC
-  TYPE I OR II BARRICADE WITH STEADY BURN LIGHT
-  DRUM WITH STEADY BURN LIGHT
-  DRUM WITH SIGN (WITH OPTIONAL FLASHING LIGHT) SEE DETAIL
-  TYPE I OR II CHECK BARRICADE WITH FLASHING LIGHT

All dimensions are in inches (millimeters) unless otherwise shown.

FILE NAME =	USER NAME = gaglianott	DESIGNED -	REVISED -T. RAMMACHER 09-08-94
W:\distrato\22x34\tol4.dgn		DRAWN -	REVISED - A. HOUSEH 11-07-95
		PLOT SCALE = 50.0000' / IN.	REVISED - A. HOUSEH 10-12-96
		CHECKED -	REVISED -T. RAMMACHER 01-06-00
		PLOT DATE = 1/4/2008	

**STATE OF ILLINOIS
DEPARTMENT OF TRANSPORTATION**

**TRAFFIC CONTROL AND PROTECTION AT TURN BAYS
(TO REMAIN OPEN TO TRAFFIC)**

SCALE: NONE SHEET NO. 1 OF 1 SHEETS STA. TO STA.

F.A. RTE.	SECTION	COUNTY	TOTAL SHEETS	SHEET NO.
VAR 2008-020 PP	LAKE	59	57	
TC-14	CONTRACT NO. 60E49			
FED. ROAD DIST. NO. 1 ILLINOIS FED. AID PROJECT				

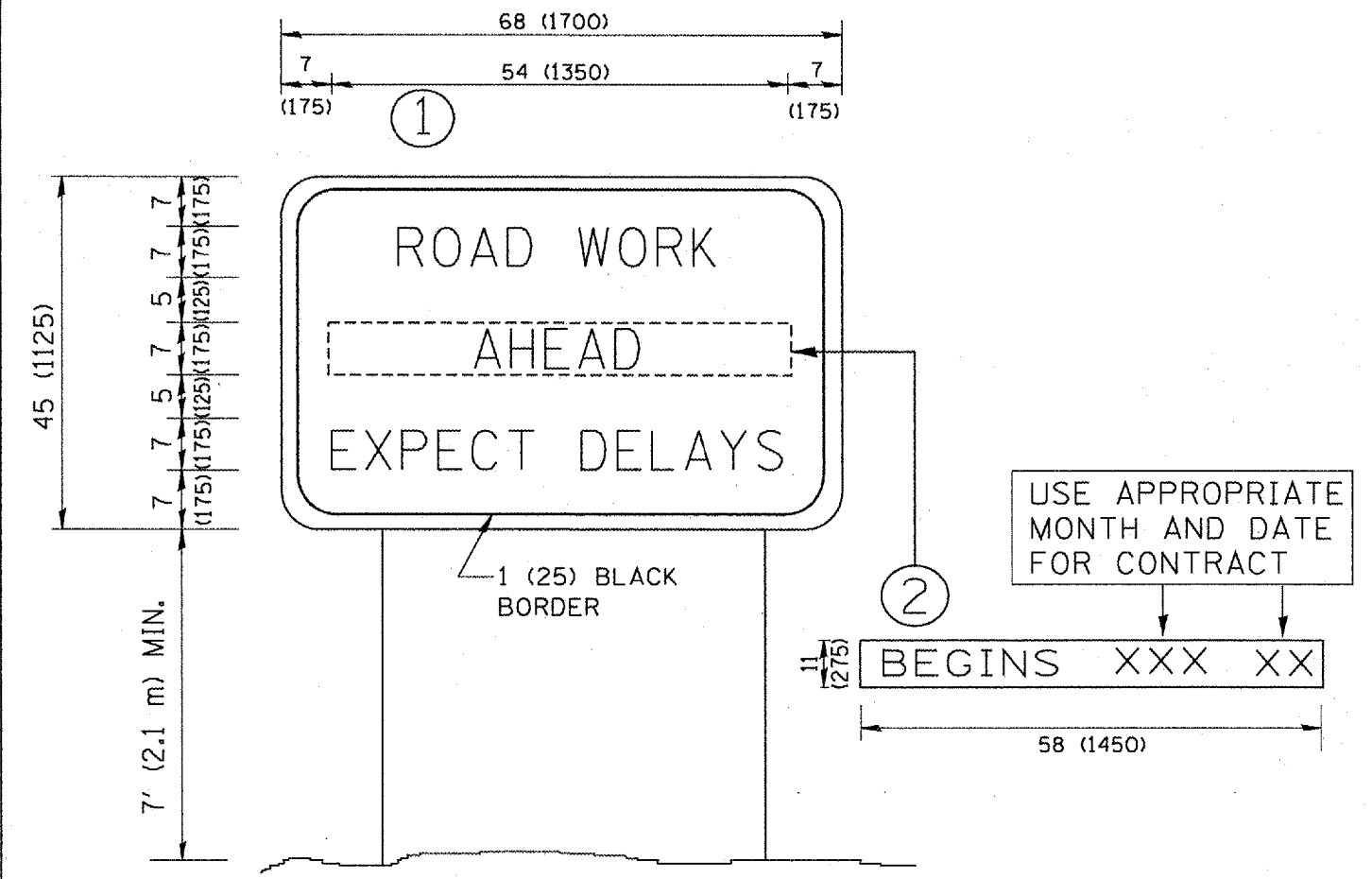

NOTES:

1. USE BLACK LETTERING ON ORANGE BACKGROUND.
2. ERECT SIGNS IN ADVANCE OF THE LOCATION FOR THE "ROAD CONSTRUCTION AHEAD" SIGN AT LOCATIONS AS DIRECTED BY THE ENGINEER.
3. ERECT SIGN ① WITH INSTALLED PANEL ② ONE WEEK PRIOR TO THE START OF CONSTRUCTION.
4. REMOVE PANEL ② SOON AFTER THE START OF CONSTRUCTION.
5. SEE SPECIAL PROVISION FOR "TEMPORARY INFORMATION SIGNING" FOR ADDITIONAL INFORMATION.
6. ONE SIGN ASSEMBLY EQUALS 25.70 SQ. FT. (2.3 SQ. M.)
7. SHALL BE PAID FOR AS TEMPORARY INFORMATION SIGNING.

ALL DIMENSIONS ARE IN INCHES (MILLIMETERS) UNLESS OTHERWISE SHOWN.

FILE NAME = M:\d\state\22x34\co22.dgn	USER NAME = goglianob	DESIGNED -	REVISED - R. MIRS 09-15-97
		DRAWN -	REVISED - R. MIRS 12-11-97
	PLOT SCALE = 50.000 ' / IN.	CHECKED -	REVISED - T. RAMWACHER 02-02-99
	PLOT DATE = 1/4/2008	DATE -	REVISED - C. JUCIUS 01-31-07

**STATE OF ILLINOIS
DEPARTMENT OF TRANSPORTATION**

ARTERIAL ROAD INFORMATION SIGN	
SCALE: NONE	SHEET NO. 1 OF 1 SHEETS
STA.	TO STA.

F.A. RTE.	SECTION	COUNTY	TOTAL SHEETS	SHEET NO.
JAR 2008-020 PP	LAKE	LAKE	59	58
TC-22		CONTRACT NO. 60E49		
FED. ROAD DIST. NO. 1 ILLINOIS FED. AID PROJECT				

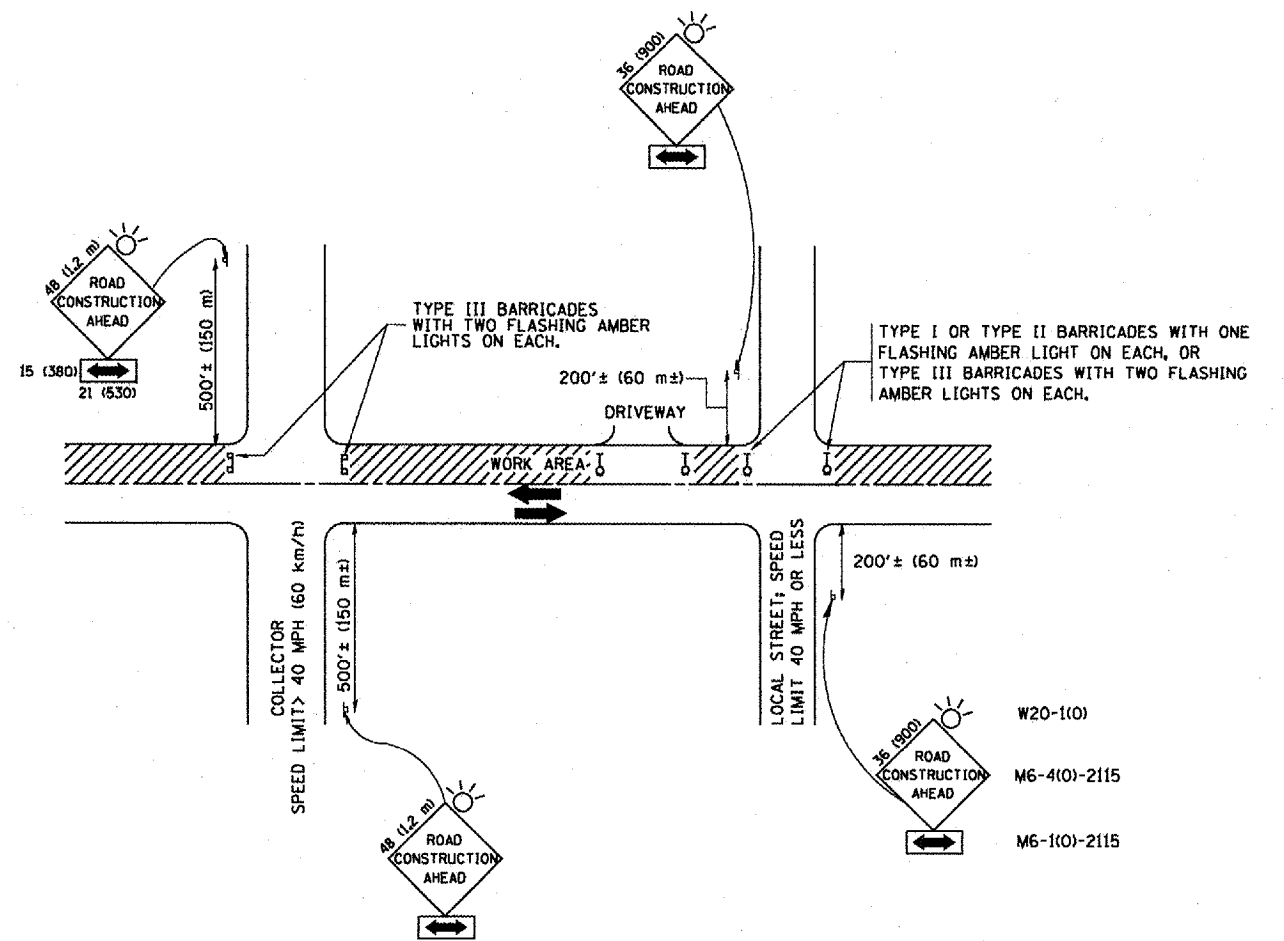

TRAFFIC CONTROL AND PROTECTION FOR SIDE ROADS, INTERSECTIONS, AND DRIVEWAYS

NOTES:

A. FOR NO LANE RESTRICTION ON THE SIDE ROAD OR DRIVEWAYS

1. SIDE ROAD WITH A SPEED LIMIT OF 40 MPH (60 km/h) OR LESS AS SHOWN ON THE DRAWING AND AS DIRECTED BY THE ENGINEER:

a) ONE ROAD CONSTRUCTION AHEAD SIGN 36 x 36 (900x900) WITH A FLASHER AND FLAG MOUNTED ON IT APPROXIMATELY 200' (60 m) IN ADVANCE OF THE MAIN ROUTE.

b) THE CLOSED PORTION OF THE MAIN ROUTE SHALL BE PROTECTED BY BLOCKING WITH TYPE I, TYPE II OR TYPE III BARRICADES, 1/3 OF THE CROSS SECTION OF THE CLOSED PORTION.

2. SIDE ROAD WITH A SPEED LIMIT GREATER THAN 40 MPH (60 km/h) AS SHOWN ON THE DRAWING AND AS DIRECTED BY THE ENGINEER:

a) ONE ROAD CONSTRUCTION AHEAD SIGN 48 x 48 (1.2 m x 1.2 m) WITH A FLASHER MOUNTED ON IT APPROXIMATELY 500' (150 m) IN ADVANCE OF THE MAIN ROUTE.

b) THE CLOSED PORTION OF THE MAIN ROUTE SHALL BE PROTECTED BY BLOCKING WITH TYPE III BARRICADES, 1/2 OF THE CROSS SECTION OF THE CLOSED PORTION.

3. WHEN THE SIDE ROAD LIES BETWEEN THE BEGINNING OF THE MAINLINE SIGNING AND THE WORK ZONE, A SINGLE HEADED ARROW (M6-1) SHALL BE USED IN LIEU OF THE DOUBLE HEADED ARROW (M6-4).

B. FOR A LANE CLOSURE ON A SIDE ROAD OR DRIVEWAY:

USE APPLICABLE PORTIONS OF THE TYPICAL APPLICATION OF TRAFFIC CONTROL DEVICES (STD. 701501, STD. 701606 OR THE APPROPRIATE STANDARD). THE SPACING OF SIGNS AND BARRICADES SHALL BE ADJUSTED FOR FIELD CONDITIONS AS DIRECTED BY THE ENGINEER. THE DIRECTIONAL ARROW SHALL BE COVERED OR REMOVED WHEN NO LONGER CONSISTENT WITH THE SIDE ROAD LANE CLOSURE.

C. ADVANCE WARNING SIGNS ARE TO BE OMITTED ON DRIVEWAY UNLESS OTHERWISE NOTED.

D. THE TRAFFIC CONTROL AND PROTECTION FOR SIDE ROADS, INTERSECTIONS, AND DRIVEWAYS SHALL BE INCIDENTAL TO THE COST OF SPECIFIED TRAFFIC CONTROL STANDARDS OR ITEMS.

All dimensions are in millimeters (inches) unless otherwise shown.

FILE NAME = W:\distsd\22x34\col8.dgn	USER NAME = gaglierab	DESIGNED - LHA	REVISED - J. OBERLE 10-18-95
		DRAWN -	REVISED - A. HOUSEH 03-06-96
	PLOT SCALE = 50.000' / IN.	CHECKED -	REVISED - A. HOUSEH 10-15-96
	PLOT DATE = 1/4/2008	DATE - 06-89	REVISED - T. RAMMACHER 01-06-00

STATE OF ILLINOIS
DEPARTMENT OF TRANSPORTATION

TRAFFIC CONTROL AND PROTECTION FOR SIDE ROADS, INTERSECTIONS, AND DRIVEWAYS		F.A. RTE.	SECTION	COUNTY	TOTAL SHEETS	SHEET NO.
SCALE: NONE	SHEET NO. 1 OF 1 SHEETS	VAR. 2008-020 PP	LAKE	59	59	
	STA. TO STA.	TC-10	CONTRACT NO. 60549			
FED. ROAD DIST. NO. 1 ILLINOIS FED. AID PROJECT						