

APR 27 2007 7:40 AM BAK
 I:\AIRPORTS\CARMA\B01-07TKYX\AIRPORT\SHEETS\R-1915TK.DWG - STA. 21+50 TO STA. 30+00

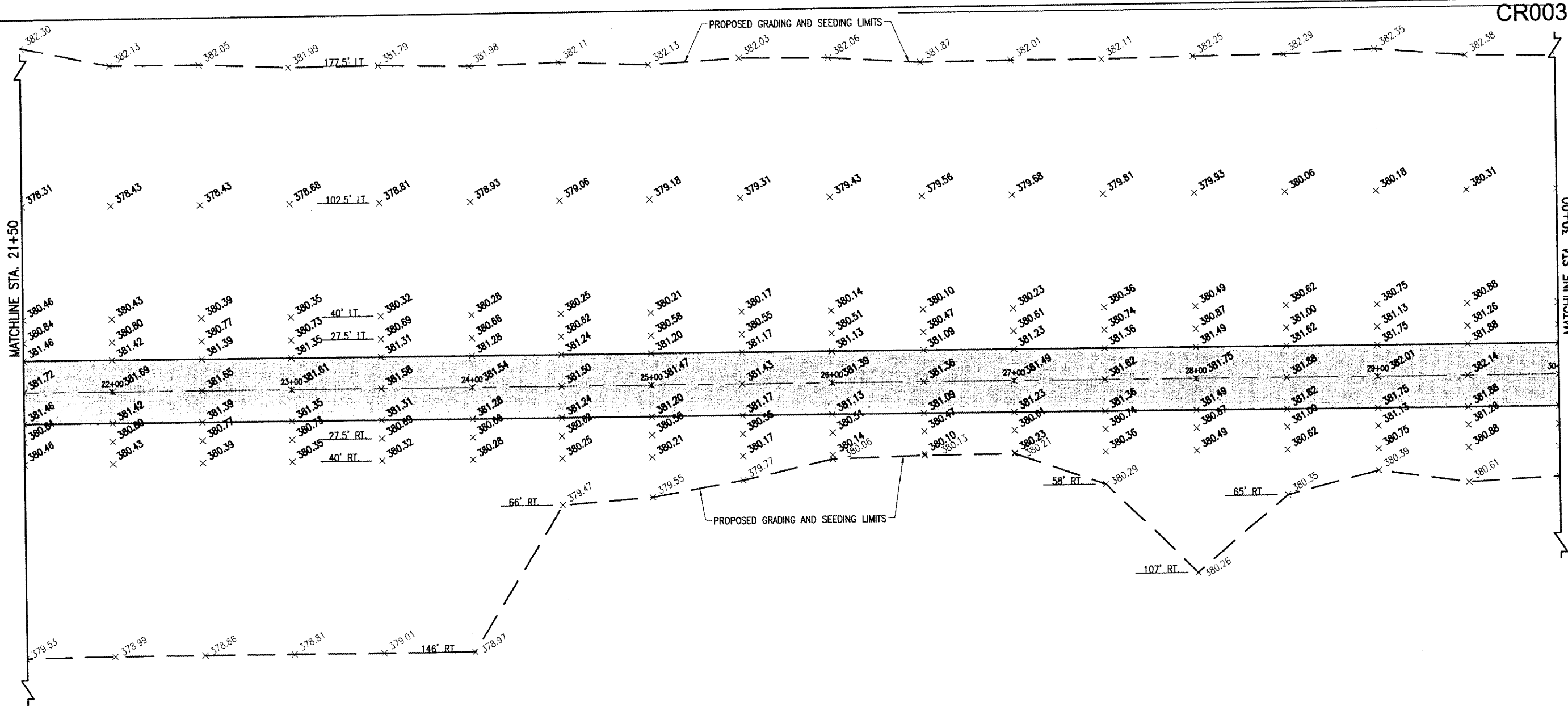

- LEGEND**
- EXISTING PAVEMENT
 - PROPOSED PAVEMENT
 - PROPOSED GRADING AND SEEDING LIMITS
 - EXISTING GRADE
 - PROPOSED GRADE

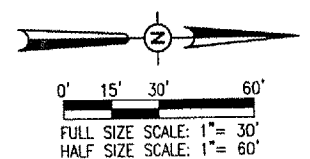

DATE	REVISION	BY

**CARMI MUNICIPAL AIRPORT
 CARMI, ILLINOIS**

IL PROJ.: CUL-3683 A.I.P. PROJ.: 3-17-0109-87

REL. Project No. 801-07TKXD.0800	DATE: 11/15/06
Revision: R-1915TK.DWG	LAYOUT: SEP 11/15/06
Scale: 1" = 30'	DRAWN: BAK 11/15/06
	REVIEWED: CAH 03/27/07

HANSON
 Hanson Professional Services Inc.
 1626 South Sixth Street
 Springfield, Illinois 62702-2886
 Offices Nationwide

**EXTEND PARTIAL
 PARALLEL TAXIWAY**
 PROPOSED
 STAKING PLAN
 STA. 21+50 TO STA. 30+00