

APR 18, 2008 11:13 AM HARRIO1115
 I:\AIRPORTS\DECATUR\07AQ169\CADD\AIRPORT\MODEL\R-SITE-APRON_XSEC.DWG - 22 x 34 PLAN

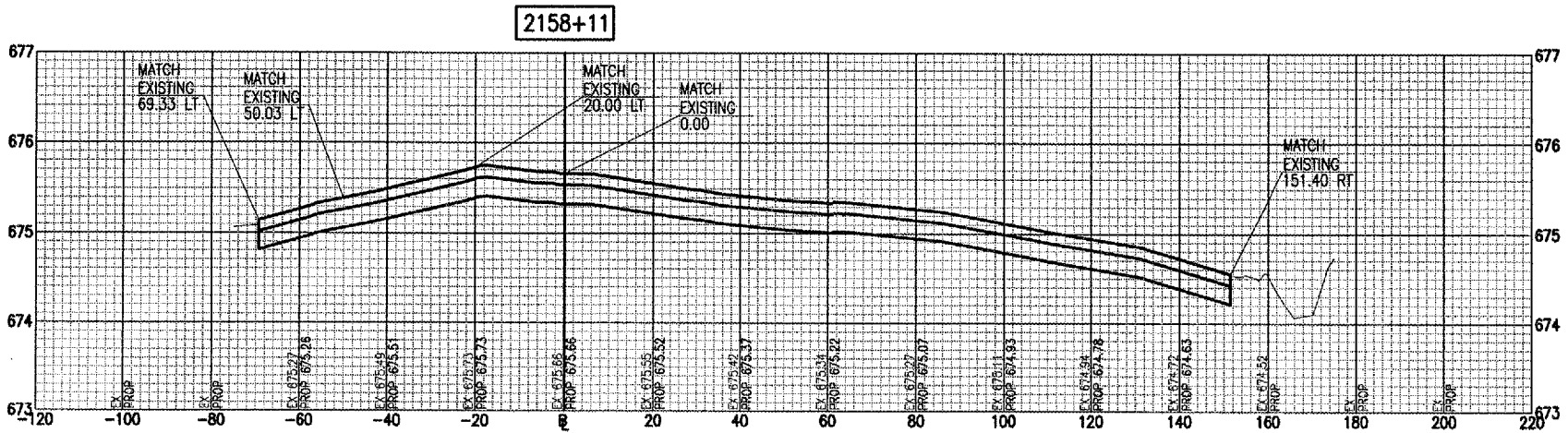

DATE	REVISION	BY

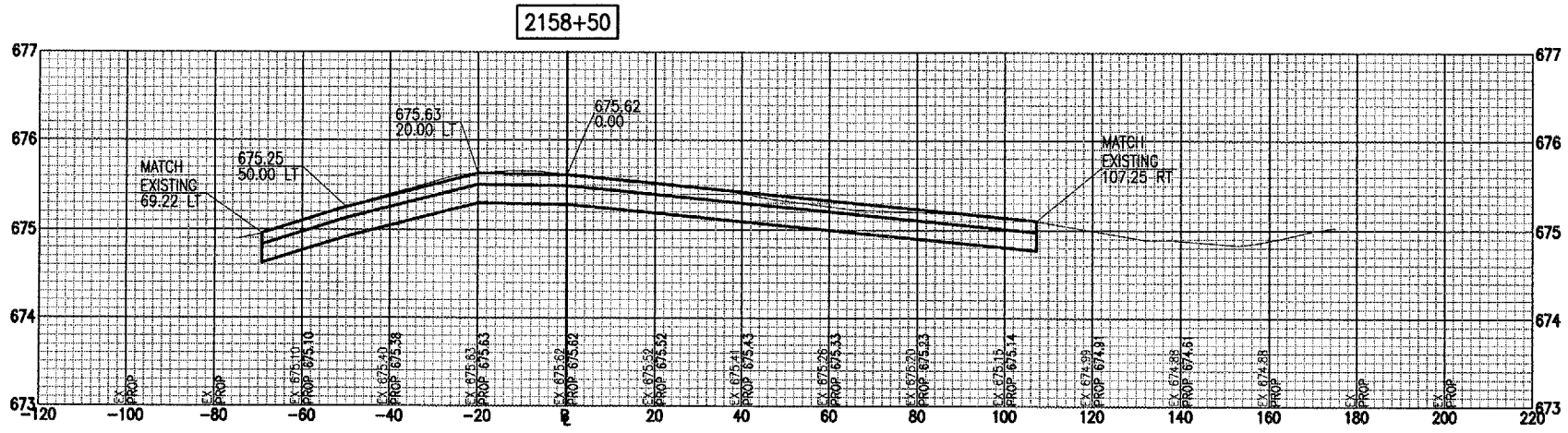
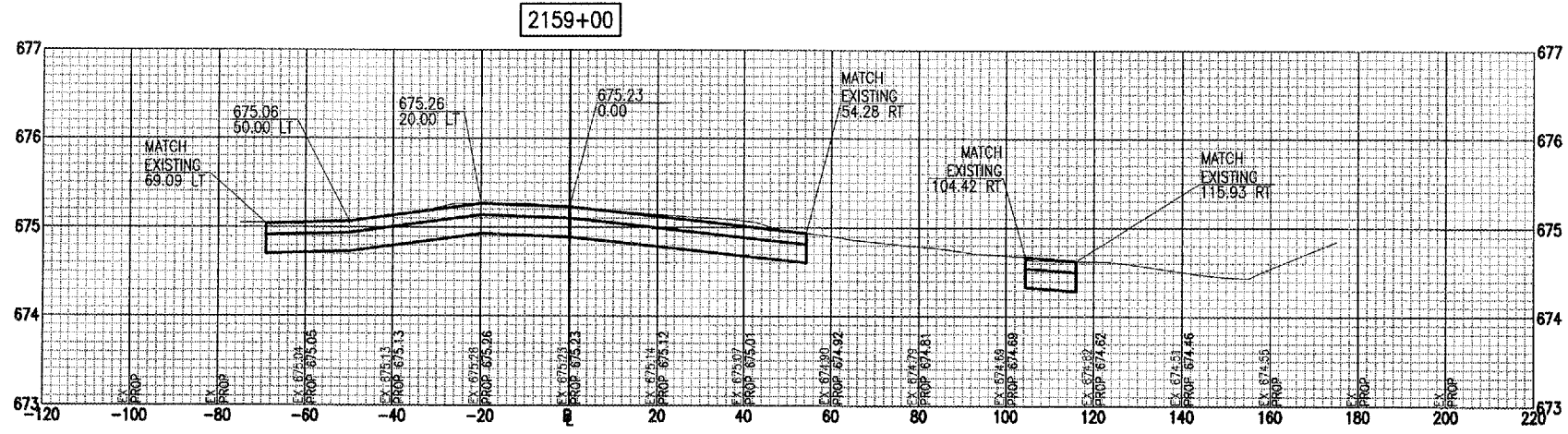

IL PROJ: DEC-3799 A.I.P. PROJ.: 3-17-0033-XX

H&E Project No. 07AQ169D_0802 Filename: R-SITE-APRON_XSEC.DWG Scale: 1"=20'H 1"=1'V Date: 04/18/08	LAYOUT DAK 04/17/08 DRAWN DAK 04/17/08 REVIEWED JDW 04/17/08
---	--



Hanson Professional Services Inc.
 15150 Springdale Avenue
 Springfield, Illinois 62703-2886
 Offices Nationwide

RECONSTRUCT
 TAXIWAY "A" AND
 ADJACENT GA APRON
 GENERAL AVIATION APRON
 PROPOSED CROSS SECTIONS
 STA. 2158+11 TO STA. 2159+00