

AIRPORT ENTRANCE ROAD

EXISTING PARKING LOT

PROPOSED APRON EXPANSION

EXISTING APRON

EXISTING HANGAR

QUANTITIES				
ITEM No.	DESCRIPTION	UNIT	QUANTITY	AS BUILT QUANTITY
AR152410	UNCLASSIFIED EXCAVATION	C.Y.	12	
AR152442	OFFSITE BORROW EXCAVATION	C.Y.	84	
AR209510	CRUSHED AGGREGATE BASE COURSE	TON	114	
AR501506	6" P.C.C. PAVEMENT	S.Y.	488	

COORDINATE DATA				
ID.	STATION	OFFSET	NORTHING	EASTING
A	0+25	R	729381.69	950387.35
B	0+95	R	729451.69	950386.92
C	1+95	R	729551.69	950386.31
D	2+16	R	729572.69	950386.18
1	0+75	50.0' LT.	729431.38	950337.06
2	0+75	88.4' LT.	729431.15	950298.65
3	0+90	88.4' LT.	729450.78	950298.55
4	0+90	86.0' LT.	729450.84	950300.94
5	1+95	86.0' LT.	729551.16	950300.31
6	1+95	50.0' LT.	729551.38	950336.66

- LEGEND**
- EXISTING PAVEMENT
  - EXISTING BUILDING
  - EXISTING PROPERTY LINE
  - EXISTING CLASS E FENCE
  - EXISTING INLET
  - EXISTING BEACON
  - PROPOSED P.C.C. PAVEMENT

DATE	REVISION	BY

FLORA AIRPORT  
FLORA, ILLINOIS

A.I.P. PROJ.: 3-17-0044-B14  
IL PROJ.: FOA-3758

REV. Project No. 07A0122D_0800	01/10/08
Extrama R-121CON.DWG	CCC
Scale 1" = 10'	CCC
Date 01/10/08	CAH
LAYOUT	01/10/08
DRAWN	01/10/08
REVIEWED	01/25/08

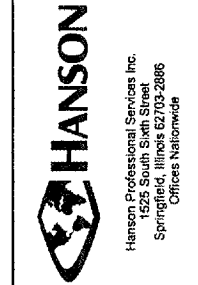

EXPAND HANGAR PAVEMENT  
PROPOSED CONSTRUCTION PLAN

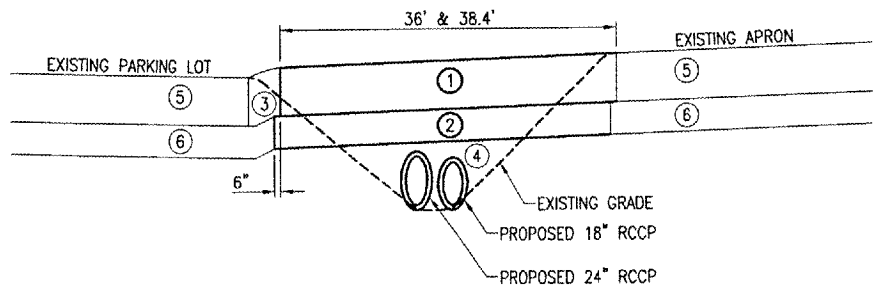
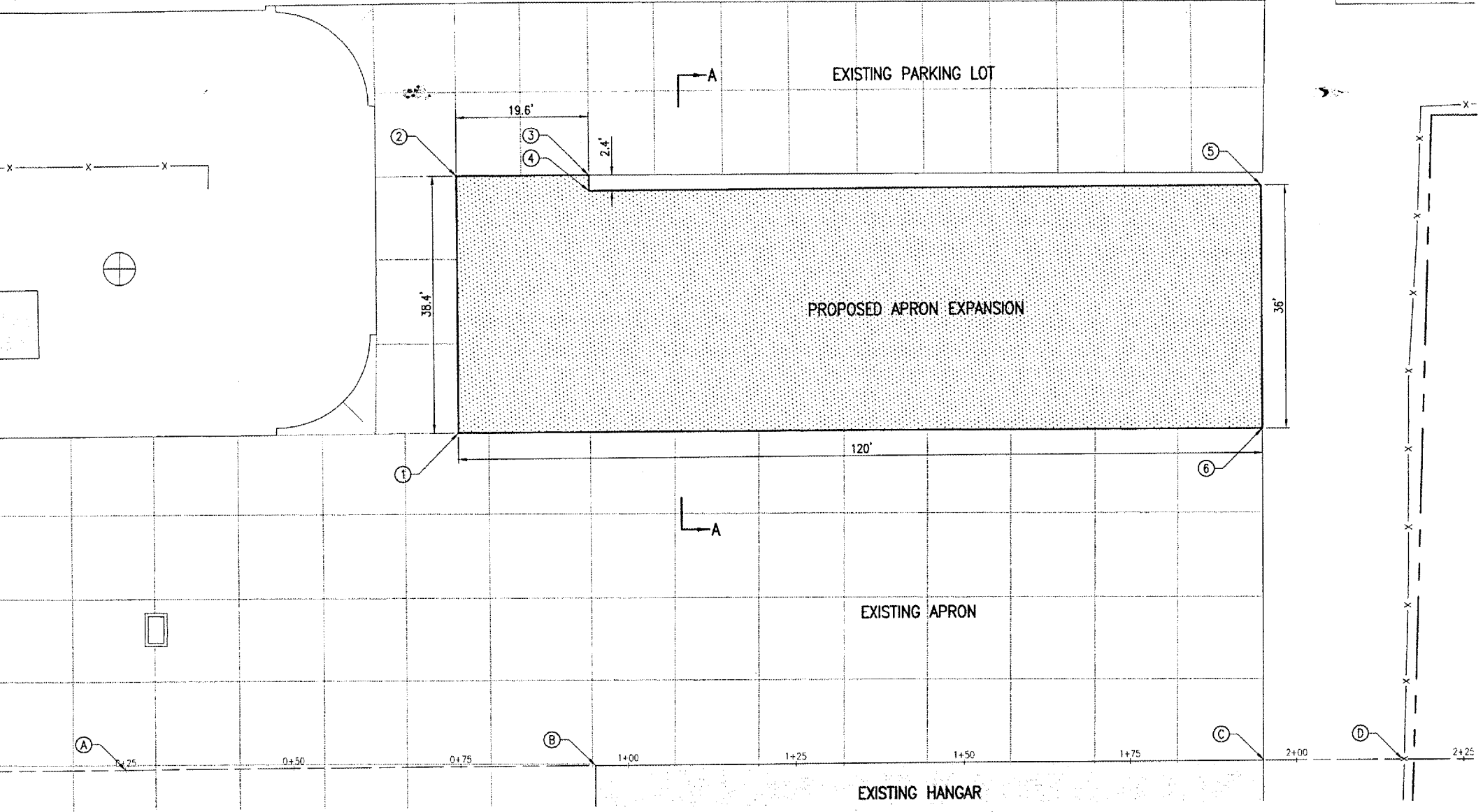

TYPICAL SECTION A-A  
SCALE: N/A

**TYPICAL SECTION LEGEND**

- ① PROPOSED 501: P.C.C. (6" DEPTH)
- ② PROPOSED 209: AGGREGATE BASE COURSE (4" DEPTH)
- ③ PROPOSED 209: AGGREGATE BASE COURSE (6" DEPTH)
- ④ PROPOSED 152: EARTH FILL
- ⑤ EXISTING 501: P.C.C. (6" DEPTH)
- ⑥ EXISTING 209: AGGREGATE BASE COURSE (4" DEPTH)

