

REVISIONS		
NUMBER	BY	DATE

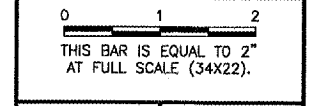

LEGEND

- ◻ EXISTING BASE MOUNTED MEDIUM INTENSITY TAXIWAY LIGHT
- EXISTING STAKE MOUNTED MEDIUM INTENSITY TAXIWAY LIGHT
- ◻ EXISTING STAKE MOUNTED MEDIUM INTENSITY RUNWAY LIGHT
- ◻ EXISTING BASE MOUNTED MEDIUM INTENSITY RUNWAY LIGHT
- EXISTING STAKE MOUNTED THRESHOLD LIGHT
- ◻ EXISTING BASE MOUNTED THRESHOLD LIGHT
- (4) EXISTING CONCRETE ENCASED DUCT BANK (NUMBER OF WAYS)
- GRS EXISTING GRS CONDUIT (CONDUIT SIZE NOTED)
- HH EXISTING ELECTRICAL HANDHOLE
- ⊙ EXISTING ELECTRICAL SPLICE CAN
- ⊠ EXISTING WIND CONE
- ≡ EXISTING AIRFIELD GUIDANCE SIGN
- CKT#1 --- EXISTING RUNWAY 4/22 CIRCUIT
- CKT#2 --- EXISTING RUNWAY 16/34 CIRCUIT
- CKT#3 --- EXISTING TAXIWAY A, AA, C, D, E CIRCUIT
- CKT#4 --- EXISTING TAXIWAY B/BB CIRCUIT
- CKT#5 --- EXISTING TAXIWAY H CIRCUIT
- CKT#7 --- EXISTING WINDCONE/RUNWAY 4 PAPI
- CKT#8 --- EXISTING WINDCONE/RUNWAY 22 PAPI
- CKT#10 --- EXISTING RUNWAY 22 REIL
- CKT#11 --- EXISTING AWOS
- CKT#17 --- EXISTING RUNWAY 16 PAPI
- CKT#18 --- EXISTING RUNWAY 34 PAPI
- ⊙ E EXISTING ELECTRICAL MANHOLE
- □ □ EXISTING PRECISION APPROACH PATH INDICATORS (PAPI) L-880 SYSTEM
- △ EXISTING RUNWAY END IDENTIFIER LIGHT (REIL)
- NEW STAKE MOUNTED THRESHOLD LIGHT
- ◻ NEW BASE MOUNTED THRESHOLD LIGHT
- ◻ NEW BASE MOUNTED RUNWAY LIGHT
- NEW STAKE MOUNTED RUNWAY LIGHT
- NEW STAKE MOUNTED MEDIUM INTENSITY TAXIWAY LIGHT
- ◻ NEW BASE MOUNTED MEDIUM INTENSITY TAXIWAY LIGHT
- ≡ NEW AIRFIELD GUIDANCE SIGN
- ≡ EXISTING AIRFIELD GUIDANCE SIGN TO BE MODIFIED
- ≡ RELOCATED AIRFIELD GUIDANCE SIGN
- ⊙ NEW SPLICE CAN
- (4) NEW GRS CONDUIT (SIZE NOTED)
- HH NEW HANDHOLE
- CKT#2 --- NEW CIRCUIT #2, 1/C #8 5KV L-824 TYPE C CABLE IN 3/4" UNIT DUCT
- CKT#5 --- NEW CIRCUIT #5, 1/C #8 5KV L-824 TYPE C CABLE IN 3/4" UNIT DUCT

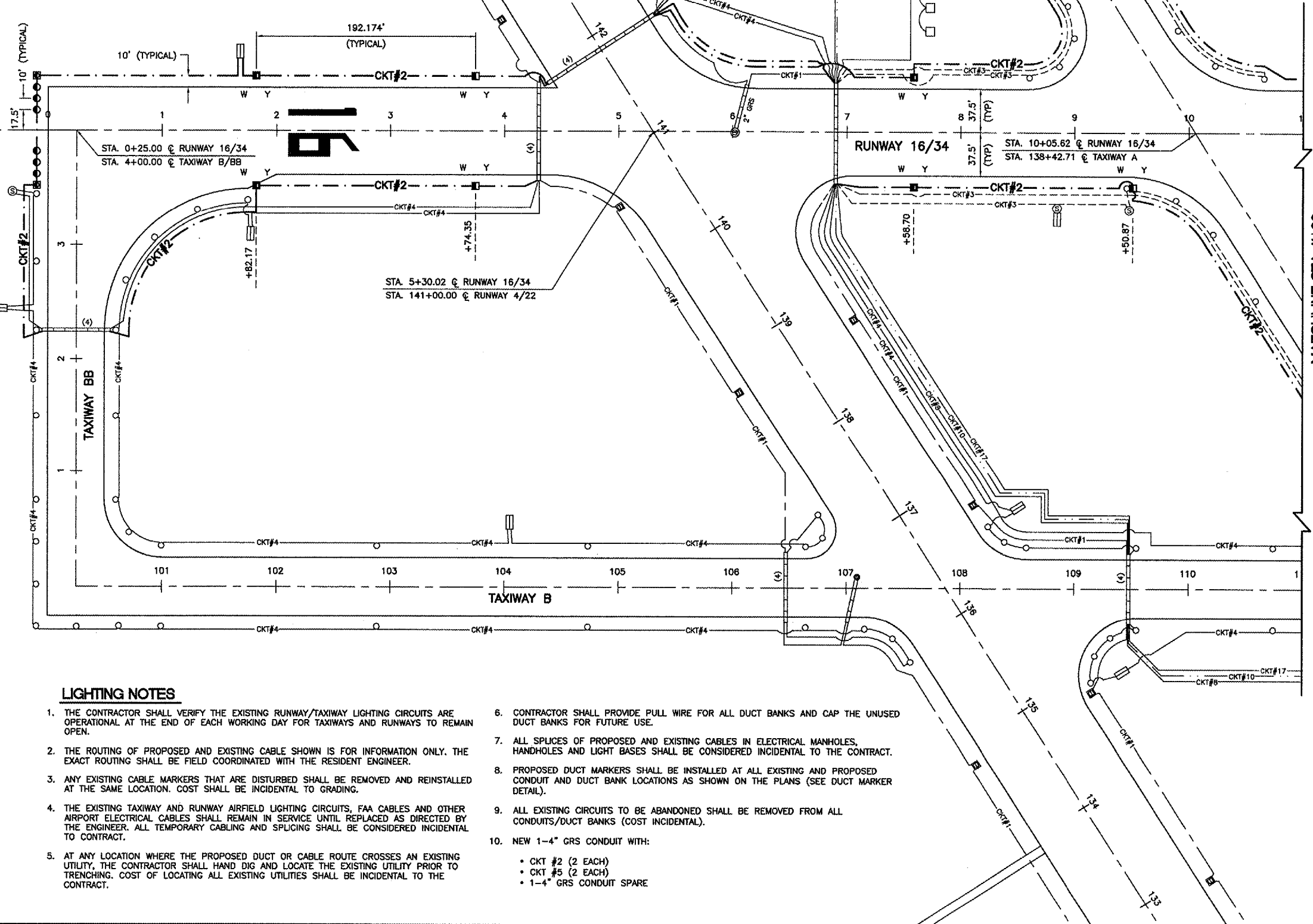
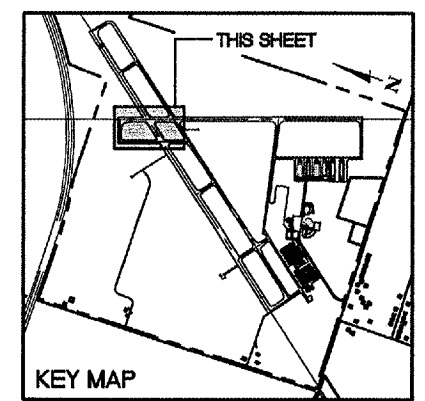

LIGHTING NOTES

1. THE CONTRACTOR SHALL VERIFY THE EXISTING RUNWAY/TAXIWAY LIGHTING CIRCUITS ARE OPERATIONAL AT THE END OF EACH WORKING DAY FOR TAXIWAYS AND RUNWAYS TO REMAIN OPEN.
2. THE ROUTING OF PROPOSED AND EXISTING CABLE SHOWN IS FOR INFORMATION ONLY. THE EXACT ROUTING SHALL BE FIELD COORDINATED WITH THE RESIDENT ENGINEER.
3. ANY EXISTING CABLE MARKERS THAT ARE DISTURBED SHALL BE REMOVED AND REINSTALLED AT THE SAME LOCATION. COST SHALL BE INCIDENTAL TO GRADING.
4. THE EXISTING TAXIWAY AND RUNWAY AIRFIELD LIGHTING CIRCUITS, FAA CABLES AND OTHER AIRPORT ELECTRICAL CABLES SHALL REMAIN IN SERVICE UNTIL REPLACED AS DIRECTED BY THE ENGINEER. ALL TEMPORARY CABLING AND SPLICING SHALL BE CONSIDERED INCIDENTAL TO CONTRACT.
5. AT ANY LOCATION WHERE THE PROPOSED DUCT OR CABLE ROUTE CROSSES AN EXISTING UTILITY, THE CONTRACTOR SHALL HAND DIG AND LOCATE THE EXISTING UTILITY PRIOR TO TRENCHING. COST OF LOCATING ALL EXISTING UTILITIES SHALL BE INCIDENTAL TO THE CONTRACT.
6. CONTRACTOR SHALL PROVIDE PULL WIRE FOR ALL DUCT BANKS AND CAP THE UNUSED DUCT BANKS FOR FUTURE USE.
7. ALL SPLICES OF PROPOSED AND EXISTING CABLES IN ELECTRICAL MANHOLES, HANDHOLES AND LIGHT BASES SHALL BE CONSIDERED INCIDENTAL TO THE CONTRACT.
8. PROPOSED DUCT MARKERS SHALL BE INSTALLED AT ALL EXISTING AND PROPOSED CONDUIT AND DUCT BANK LOCATIONS AS SHOWN ON THE PLANS (SEE DUCT MARKER DETAIL).
9. ALL EXISTING CIRCUITS TO BE ABANDONED SHALL BE REMOVED FROM ALL CONDUITS/DUCT BANKS (COST INCIDENTAL).
10. NEW 1-4" GRS CONDUIT WITH:
 - CKT #2 (2 EACH)
 - CKT #5 (2 EACH)
 - 1-4" GRS CONDUIT SPARE

MATCHLINE STA. 11+00
**GREATER KANKAKEE AIRPORT
 KANKAKEE, ILLINOIS
 REHABILITATE AIRFIELD LIGHTING SYSTEM -
 RUNWAY 16/34 AND TAXIWAY B**
**AIRFIELD LIGHTING PLAN
 RUNWAY 16/34
 STA. 0+00 TO STA. 11+00**

© Copyright CMT, Inc.
CMT
 CRAWFORD, MURPHY & TULLY, INC.
 CONSULTING ENGINEERS
 License No. BR-000515

DESIGN BY:	MND
DRAWN BY:	JRO
CHECKED BY:	MND
APPROVED BY:	
DATE:	02/29/08
JOB No:	07075-02
IL PROJECT:	IKK-3743
A.I.P. PROJECT:	3-17-0057-B13