

PE086

REVISIONS

NUMBER	BY	DATE

0 1 2
 THIS BAR IS EQUAL TO 2"
 AT FULL SCALE (34X22).
 PLOT 1

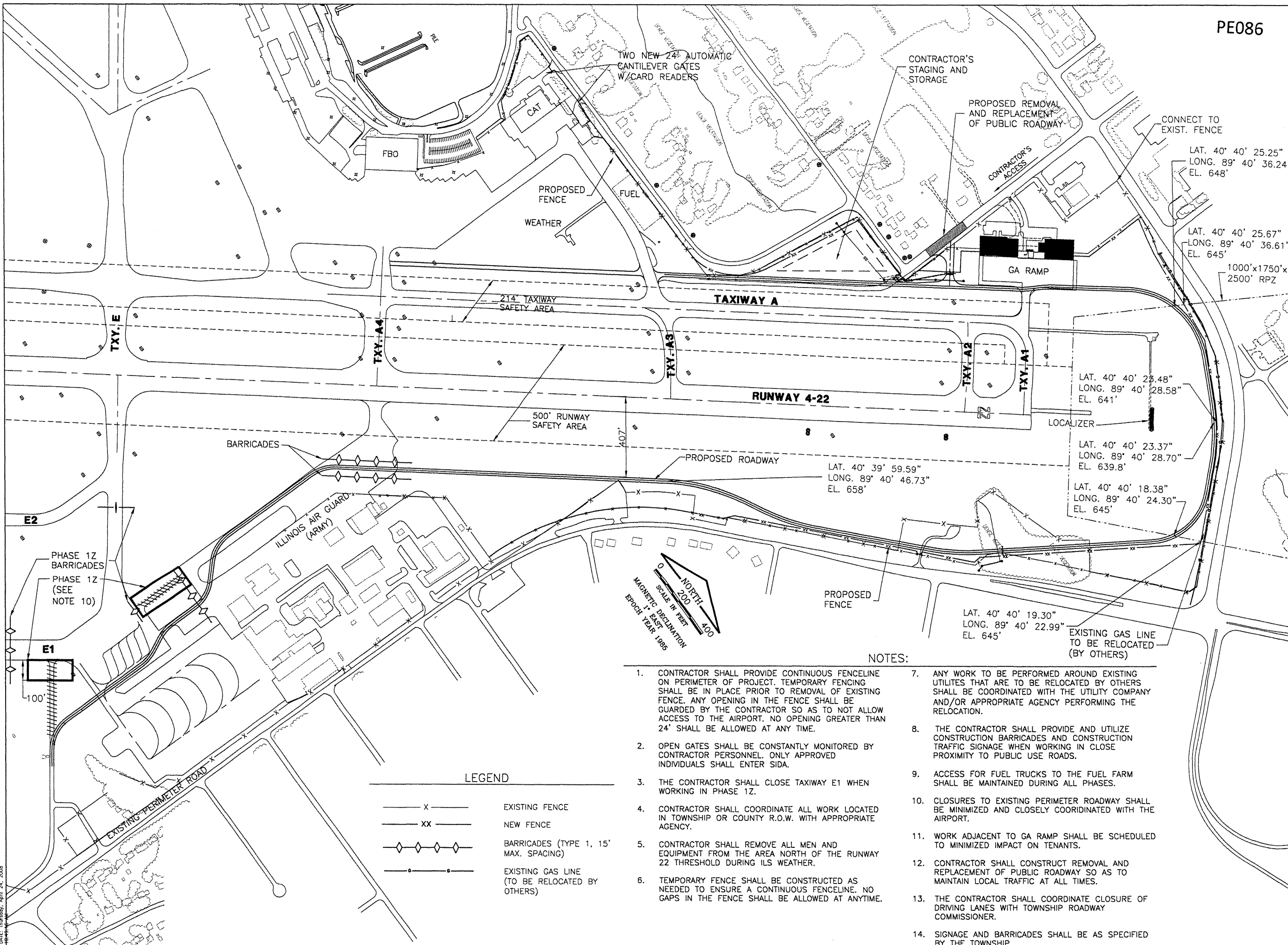

CONSTRUCT NEW PERIMETER ROAD AND PERIMETER FENCE - PROJECT 1

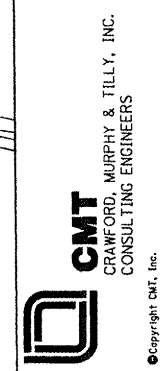

IL PROJECT: PIA-3343
AIP PROJ: 3-17-0080-XX

FILE#:	
DESIGN BY:	CET
DRAWN BY:	CMT
CHECKED BY:	XXX
APPROVED BY:	XXX
DATE:	10-26-2007
JOB No:	0706104

CONSTRUCTION ACTIVITY PLAN - PHASE 1

- NOTES:
1. CONTRACTOR SHALL PROVIDE CONTINUOUS FENCELINE ON PERIMETER OF PROJECT. TEMPORARY FENCING SHALL BE IN PLACE PRIOR TO REMOVAL OF EXISTING FENCE. ANY OPENING IN THE FENCE SHALL BE GUARDED BY THE CONTRACTOR SO AS TO NOT ALLOW ACCESS TO THE AIRPORT. NO OPENING GREATER THAN 24' SHALL BE ALLOWED AT ANY TIME.
 2. OPEN GATES SHALL BE CONSTANTLY MONITORED BY CONTRACTOR PERSONNEL. ONLY APPROVED INDIVIDUALS SHALL ENTER SIDA.
 3. THE CONTRACTOR SHALL CLOSE TAXIWAY E1 WHEN WORKING IN PHASE 1Z.
 4. CONTRACTOR SHALL COORDINATE ALL WORK LOCATED IN TOWNSHIP OR COUNTY R.O.W. WITH APPROPRIATE AGENCY.
 5. CONTRACTOR SHALL REMOVE ALL MEN AND EQUIPMENT FROM THE AREA NORTH OF THE RUNWAY 22 THRESHOLD DURING ILS WEATHER.
 6. TEMPORARY FENCE SHALL BE CONSTRUCTED AS NEEDED TO ENSURE A CONTINUOUS FENCELINE. NO GAPS IN THE FENCE SHALL BE ALLOWED AT ANYTIME.
 7. ANY WORK TO BE PERFORMED AROUND EXISTING UTILITIES THAT ARE TO BE RELOCATED BY OTHERS SHALL BE COORDINATED WITH THE UTILITY COMPANY AND/OR APPROPRIATE AGENCY PERFORMING THE RELOCATION.
 8. THE CONTRACTOR SHALL PROVIDE AND UTILIZE CONSTRUCTION BARRICADES AND CONSTRUCTION TRAFFIC SIGNAGE WHEN WORKING IN CLOSE PROXIMITY TO PUBLIC USE ROADS.
 9. ACCESS FOR FUEL TRUCKS TO THE FUEL FARM SHALL BE MAINTAINED DURING ALL PHASES.
 10. CLOSURES TO EXISTING PERIMETER ROADWAY SHALL BE MINIMIZED AND CLOSELY COORDINATED WITH THE AIRPORT.
 11. WORK ADJACENT TO GA RAMP SHALL BE SCHEDULED TO MINIMIZED IMPACT ON TENANTS.
 12. CONTRACTOR SHALL CONSTRUCT REMOVAL AND REPLACEMENT OF PUBLIC ROADWAY SO AS TO MAINTAIN LOCAL TRAFFIC AT ALL TIMES.
 13. THE CONTRACTOR SHALL COORDINATE CLOSURE OF DRIVING LANES WITH TOWNSHIP ROADWAY COMMISSIONER.
 14. SIGNAGE AND BARRICADES SHALL BE AS SPECIFIED BY THE TOWNSHIP.

LEGEND

	EXISTING FENCE
	NEW FENCE
	BARRICADES (TYPE 1, 15' MAX. SPACING)
	EXISTING GAS LINE (TO BE RELOCATED BY OTHERS)

DATE: 10/26/07
 TIME: 9:20 AM
 FILE: S:\PROJECTS\070610403\Draw\Shgts\PIA-3343-AIP-3-17-0080-XX.dwg
 USER: SPONKOWSKI, JOHN STI
 PLOT: 10/26/07 9:20 AM