

4/23/2008
K:\Peoria\070610400\Draw\Sheets\017_PLAN_07.dgn

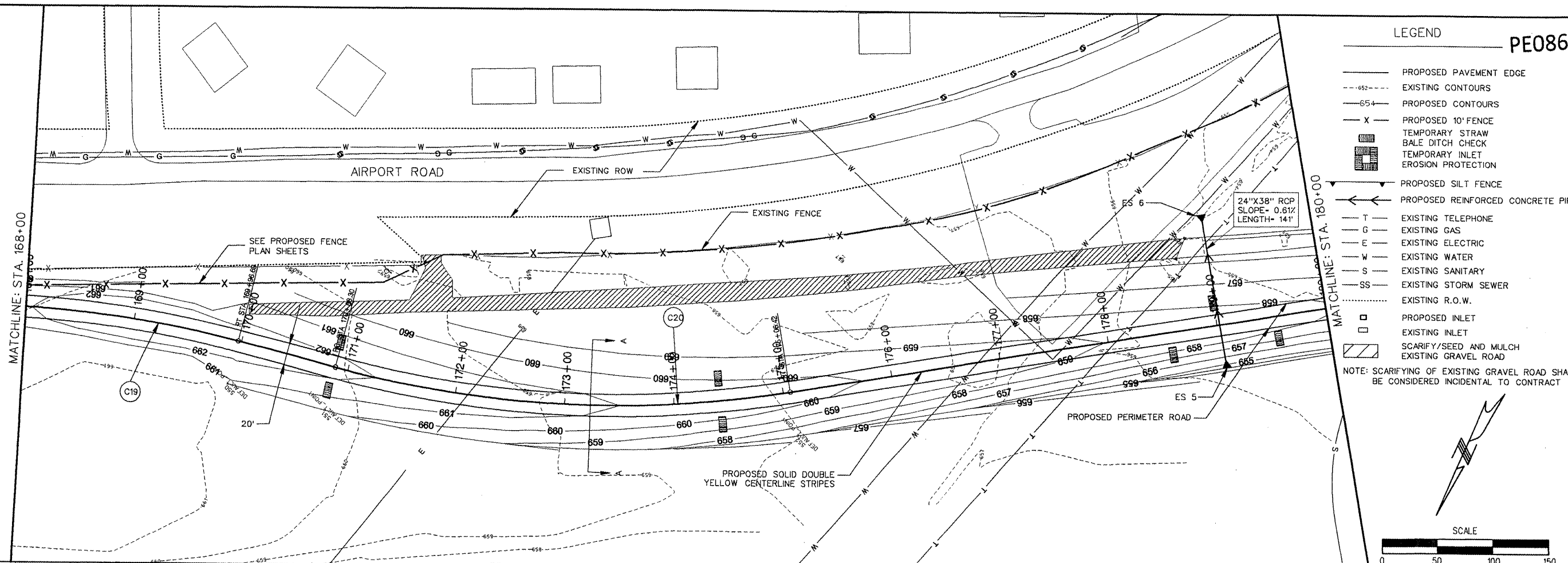

LEGEND PE086

- PROPOSED PAVEMENT EDGE
 - - - EXISTING CONTOURS
 - - - PROPOSED CONTOURS
 - X - PROPOSED 10' FENCE
 - [Hatched] TEMPORARY STRAW BALE DITCH CHECK
 - [Hatched] TEMPORARY INLET
 - [Hatched] EROSION PROTECTION
 - [Hatched] PROPOSED SILT FENCE
 - [Hatched] PROPOSED REINFORCED CONCRETE PIPE
 - T EXISTING TELEPHONE
 - G EXISTING GAS
 - E EXISTING ELECTRIC
 - W EXISTING WATER
 - S EXISTING SANITARY
 - SS EXISTING STORM SEWER
 - [Dotted] EXISTING R.O.W.
 - [Square] PROPOSED INLET
 - [Square] EXISTING INLET
 - [Hatched] SCARIFY/SEED AND MULCH
 - [Hatched] EXISTING GRAVEL ROAD
- NOTE: SCARIFYING OF EXISTING GRAVEL ROAD SHALL BE CONSIDERED INCIDENTAL TO CONTRACT

REVISIONS		
NUMBER	BY	DATE

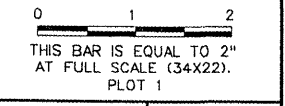

G R E A T E R
Peoria
 R E G I O N A L
Airport

CONSTRUCT NEW PERIMETER ROAD AND PERIMETER FENCE - PROJECT 1

CMT
 CRAWFORD, MURPHY & TILLY, INC.
 CONSULTING ENGINEERS
© Copyright: CMT, Inc.

IL PROJECT: PIA-3343
 AIP PROJ: 3-17-0080-XX
 FILE: ... \Draw\Sheets\017_PLAN_07.dgn
 DESIGN BY: TWM, RBL
 DRAWN BY: CAG
 CHECKED BY: RBL
 APPROVED BY: CET
 DATE: APRIL 24, 2008
 JOB No: 0706104
 PLAN AND PROFILE SHEET 7 OF 10
 SHEET 17 OF 140 SHEETS

