

REVISIONS		
NUMBER	BY	DATE

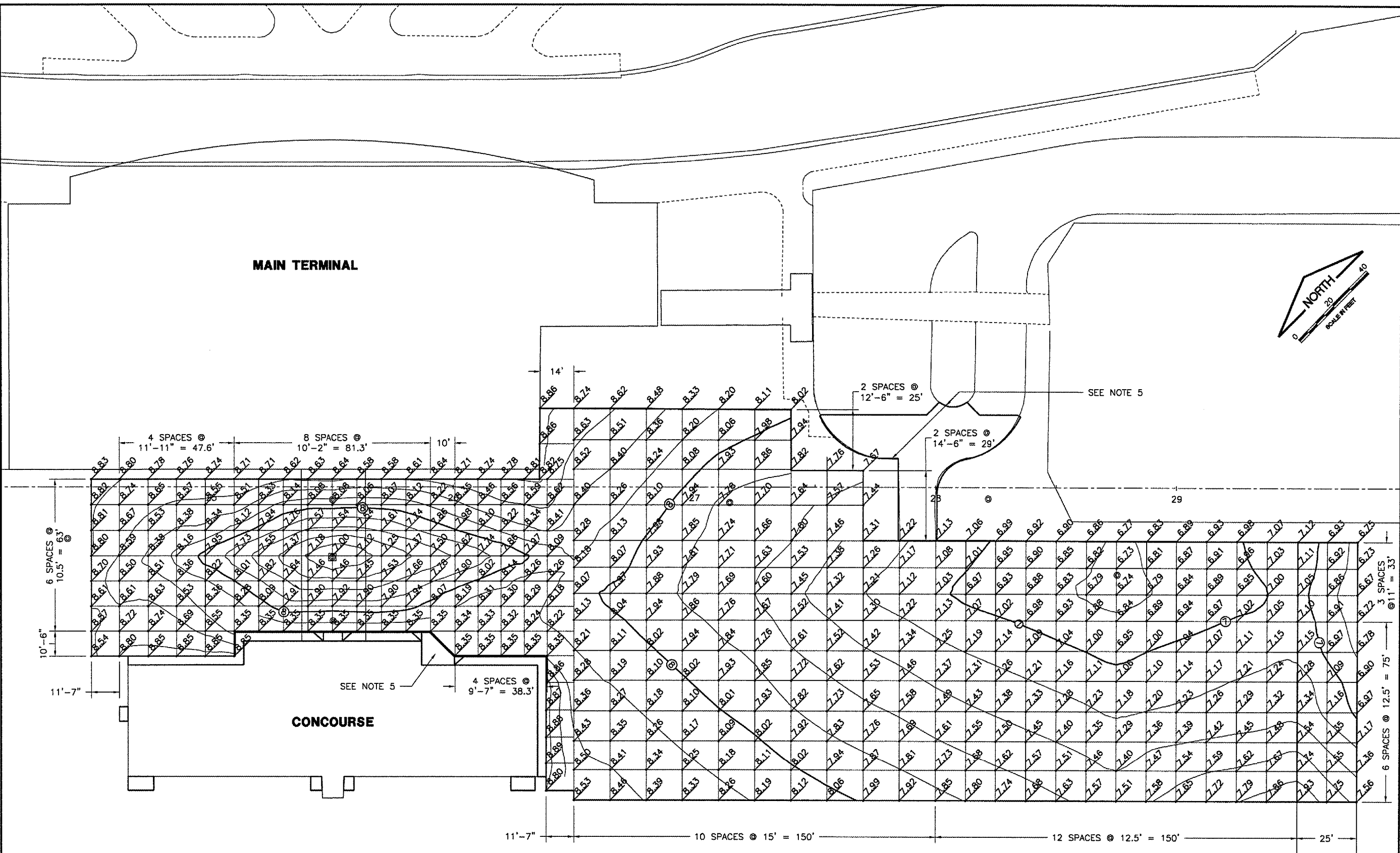
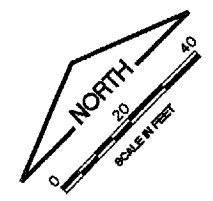
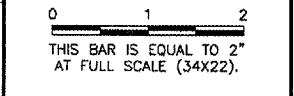

**UNIVERSITY OF ILLINOIS  
 WILLARD AIRPORT**

**REHABILITATE AIR CARRIER RAMP, PHASE 2  
 STAKING PLAN 1 - APRON**

© Copyright CMT, Inc.

**CMT**  
 CRAWFORD, MURPHY & TILLY, INC.  
 CONSULTING ENGINEERS  
 License No. 181-000815

**NOTES**

- ELEVATIONS ARE SHOWN AT NEW JOINT CORNERS.
- MATCH ELEVATION OF EXISTING MANHOLES LOCATED WITHIN NEW APRON PAVEMENT.
- ALL ELEVATIONS ARE ABOVE THE BASE ELEVATION OF 740 FEET TO INCREASE CLARITY.
- JETWAYS, BUILDING COLUMNS AND APRON LIGHT FOUNDATIONS HAVE NOT BEEN SHOWN TO INCREASE CLARITY.
- SEE CURB & SIDEWALK AND TAXI & LIMO DRIVE STAKING PLAN FOR NEW SIDEWALK, CURB AND TAXI/LIMO DRIVE PAVEMENT ELEVATIONS.

**LEGEND**

	NEW PAVEMENT ELEVATION
	NEW CONTOUR

DESIGN BY:	SMS
DRAWN BY:	CMT
CHECKED BY:	<i>SMS</i>
APPROVED BY:	<i>SMS</i>
DATE:	04/18/2008
JOB No:	0305903
CMI-3663 3-17-0016-XX	
SHEET 35 OF 57 SHEETS	