

PLAN	DATE
DESIGNED	
DRAWN	
CHECKED	
DATE	

PROFILE	DATE
DESIGNED	
DRAWN	
CHECKED	
DATE	

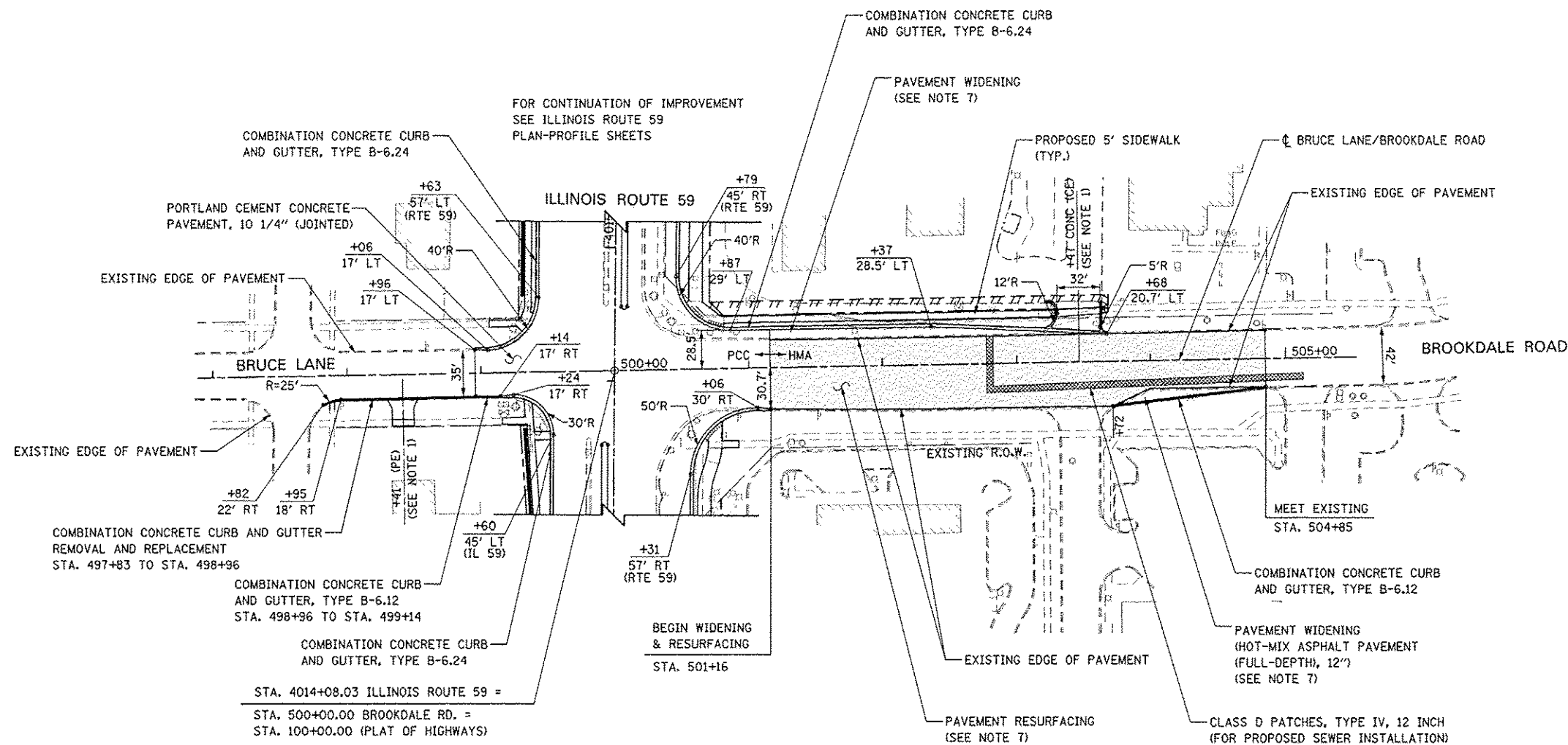

NOTES

1. SEE CORRESPONDING INTERSECTION DETAIL SHEET OR DRIVEWAY DETAILS SHEET FOR INTERSECTION OR DRIVEWAY INFORMATION.
2. FOR PROPOSED BRUCE LANE/BROOKDALE ROAD CENTERLINE INFORMATION SEE THE ALIGNMENT, BENCHMARKS, AND TIES SHEETS.
3. FOR PROPOSED SIDEWALK AND SHARED-USE PATH INFORMATION, SEE SIDEWALK/SHARED-USED PATH PLANS.
4. FOR PROPOSED RETAINING WALLS INFORMATION, SEE STRUCTURAL PLANS.
5. FOR LANDSCAPING INFORMATION, SEE LANDSCAPING PLANS.
6. FOR PROPOSED NOISE WALLS INFORMATION, SEE NOISE WALL PLAN/PROFILE SHEETS.
7. PAVEMENT WIDENING SHALL BE PAID FOR AS HOT-MIX ASPHALT PAVEMENT (FULL DEPTH), 12". SEE HMA MIXTURE CHART ON THE GENERAL NOTES SHEET FOR HMA MATERIAL REQUIREMENTS.

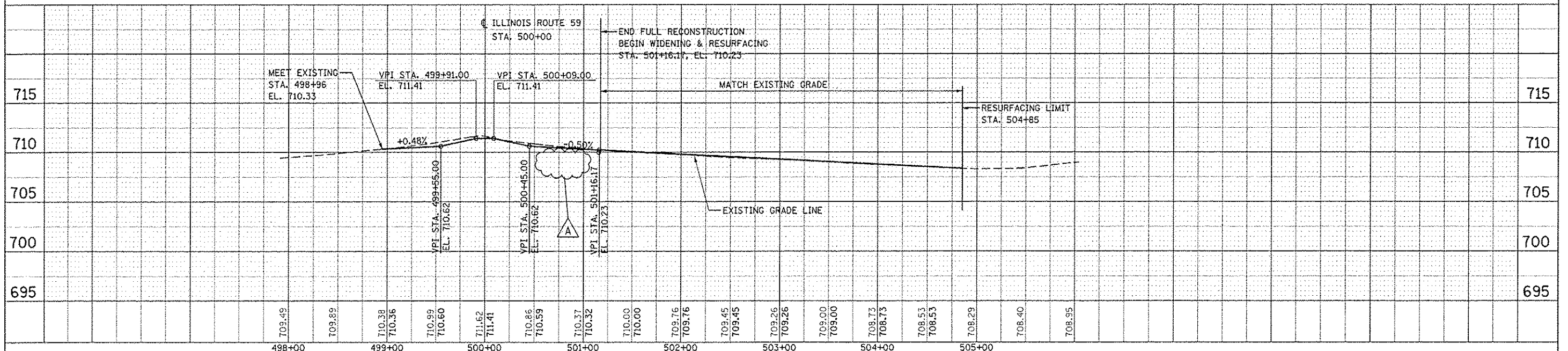
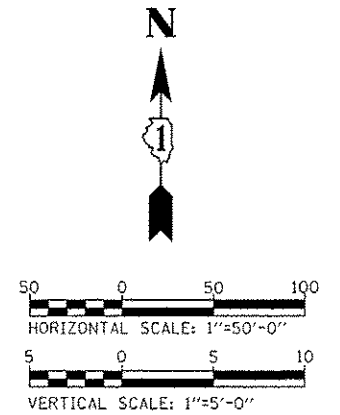

DESIGNED	<i>PJO</i>	REVISED - ADDENDUM A 02/22/2013	STATE OF ILLINOIS DEPARTMENT OF TRANSPORTATION	PLAN / PROFILE - BROOKDALE ROAD	F.A.P. RTE.	SECTION	COUNTY	TOTAL SHEETS	SHEET NO.	
DRAWN	<i>RES</i>	REVISED -			338	(112 & 113)	WRS-6	734	199	
CHECKED	<i>JCM</i>	REVISED -			CONTRACT NO. 60R31					
DATE	<i>12/14/2012</i>	REVISED -			FED. ROAD DIST. NO. [ILLINOIS] FED. AID PROJECT					