

MATCH LINE STA. 4010+00  
SEE DRAWING DE-02

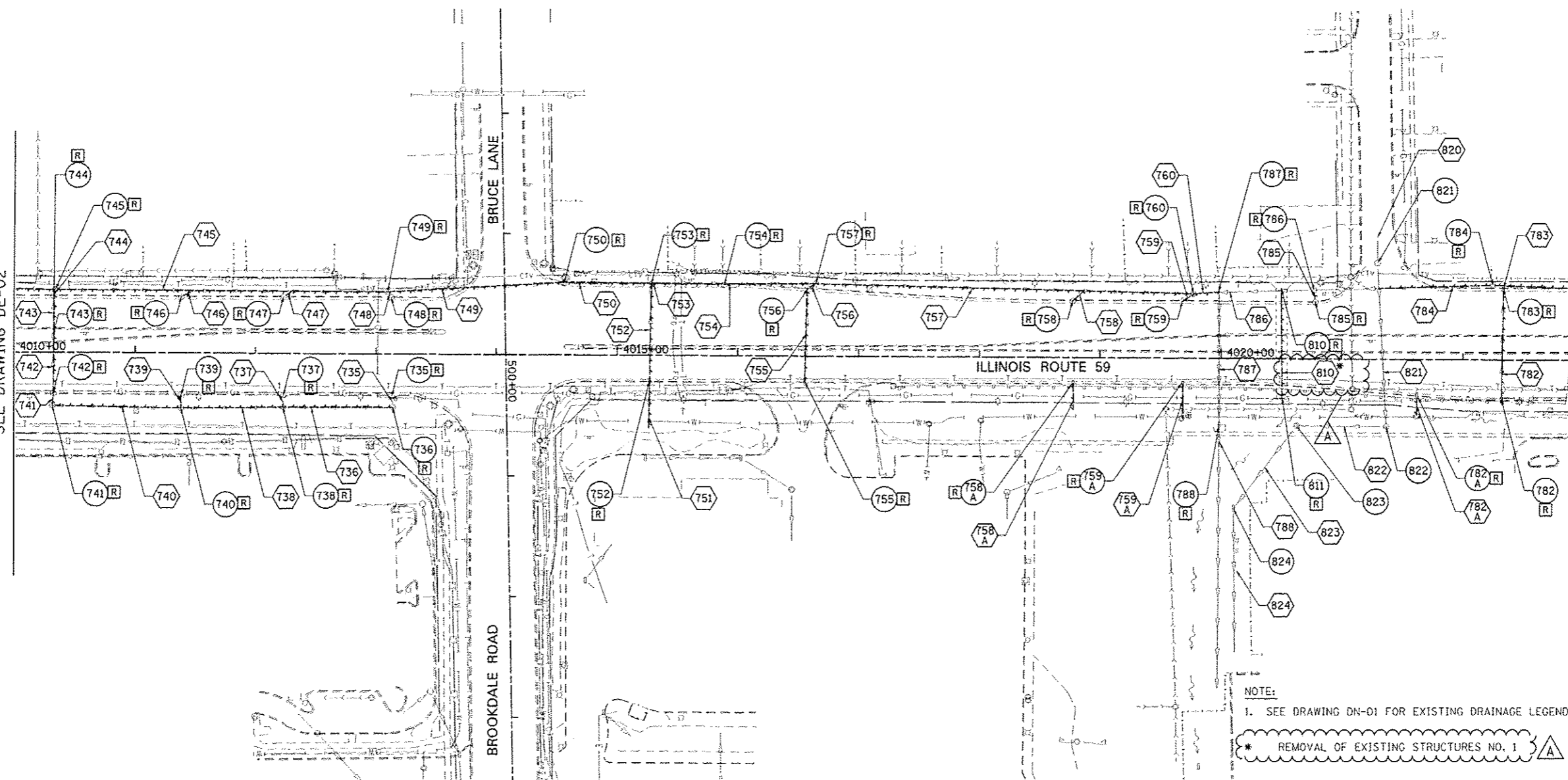

MATCH LINE STA. 4023+00  
SEE DRAWING DE-04

NOTE:  
1. SEE DRAWING DN-01 FOR EXISTING DRAINAGE LEGEND.  
\* REMOVAL OF EXISTING STRUCTURES NO. 1

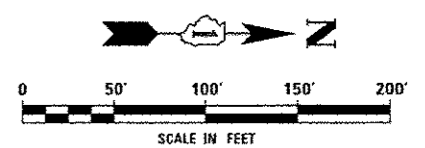

DESIGNED <i>PJO</i>	REVISED - ADDENDUM A 02/22/2013	<b>STATE OF ILLINOIS DEPARTMENT OF TRANSPORTATION</b>	<b>EXISTING DRAINAGE PLAN - ILLINOIS ROUTE 59</b>		F.A.P. RTE.	SECTION	COUNTY	TOTAL SHEETS	SHEET NO.	
DRAWN <i>KES</i>	REVISED -		SCALE: AS SHOWN	SHEET NO. 3 OF 9 SHEETS	STA. 4010+00 TO STA. 4023+00	338	(112 & 113) WRS-G	DUPAGE	734	291
CHECKED <i>KM</i>	REVISED -					<b>DE-03</b>		CONTRACT NO. 60R31		
DATE <i>12/14/2012</i>	REVISED -					ILLINOIS FED. AID PROJECT				