

**ELEVATION - FORM LINER**

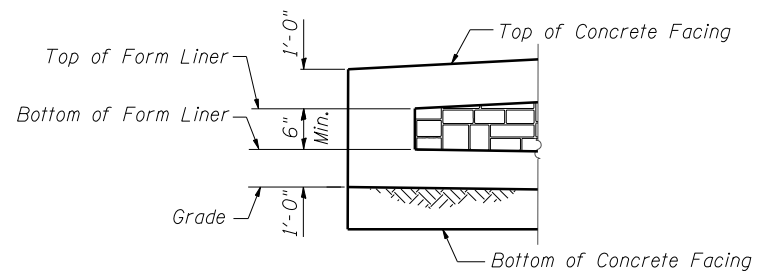

**END FORM LINER FINISH**

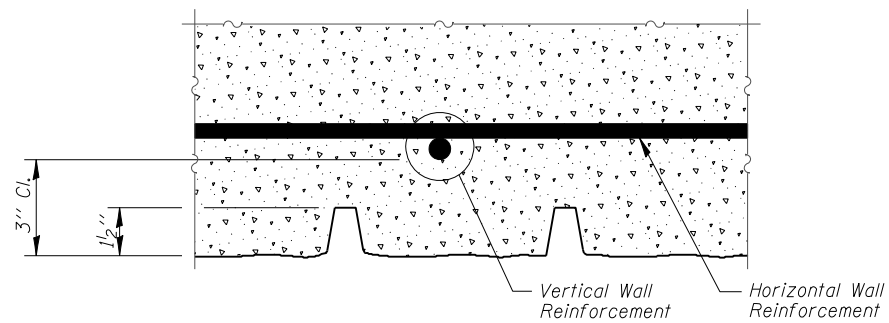

**PLAN - FORM LINER**

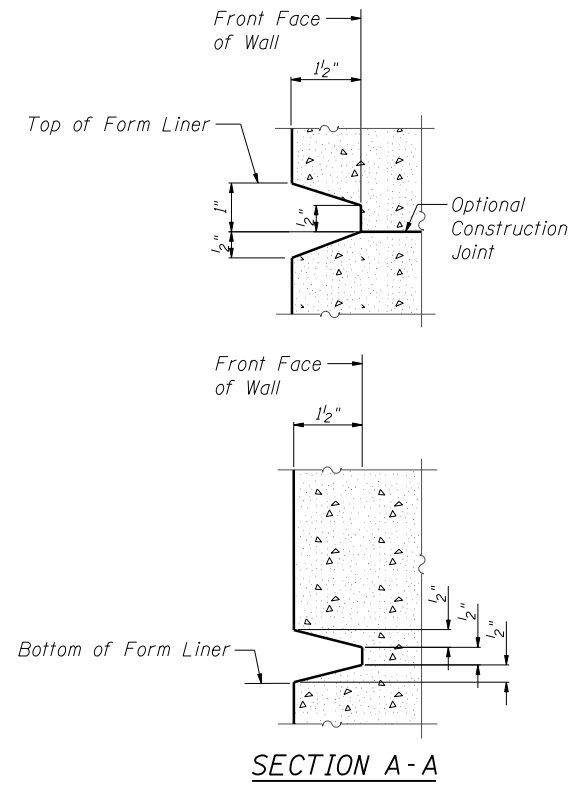

**FORM LINER ELEVATION TABLE**

Station	Form Liner Top Elevation	Form Liner Bottom Elevation
4032+14.15	708.83	708.31
4032+35.47	711.03	708.39
4032+40.00	711.50	708.41
4032+56.79	711.84	708.47
4032+78.10	712.28	708.55
4032+99.42	712.72	708.63
4033+20.74	713.15	708.71
4033+37.71	713.50	708.77
4033+42.06	713.50	708.79
4033+63.37	713.50	708.87
4033+84.69	713.50	708.95
4034+01.00	713.50	709.01
4034+06.00	710.33	709.03

FILE NAME = ...60R31-W053-008-ArchFinish.dgn



Zroka Engineering, P.C.  
4216 North Hermitage  
Chicago, IL 60613

DESIGNED - LAS	REVISED -
CHECKED - DAZ	REVISED -
DRAWN - SAW	REVISED -
CHECKED - LAS	REVISED -

STATE OF ILLINOIS  
DEPARTMENT OF TRANSPORTATION

ARCHITECTURAL FINISH DETAILS  
STA. 4032+14.15 TO STA. 4034+06.00 SN 022-W053

SHEET NO. SD-8 OF SD-10 SHEETS

F.A.P. RTE.	SECTION	COUNTY	TOTAL SHEETS	SHEET NO.
338	(112 & 113) WRS-6	DUPAGE	734	528
CONTRACT NO. 60R31				

ILLINOIS FED. AID PROJECT