

PLAN	SURVEYED	BY	DATE
	PLOTTED		
	GRADES CHECKED		
	STRUCTURE NOTATIONS CHECKED		
	FILE NAME		
	NO.		

PROFILE	SURVEYED	BY	DATE
	PLOTTED		
	GRADES CHECKED		
	STRUCTURE NOTATIONS CHECKED		
	FILE NAME		
	NO.		

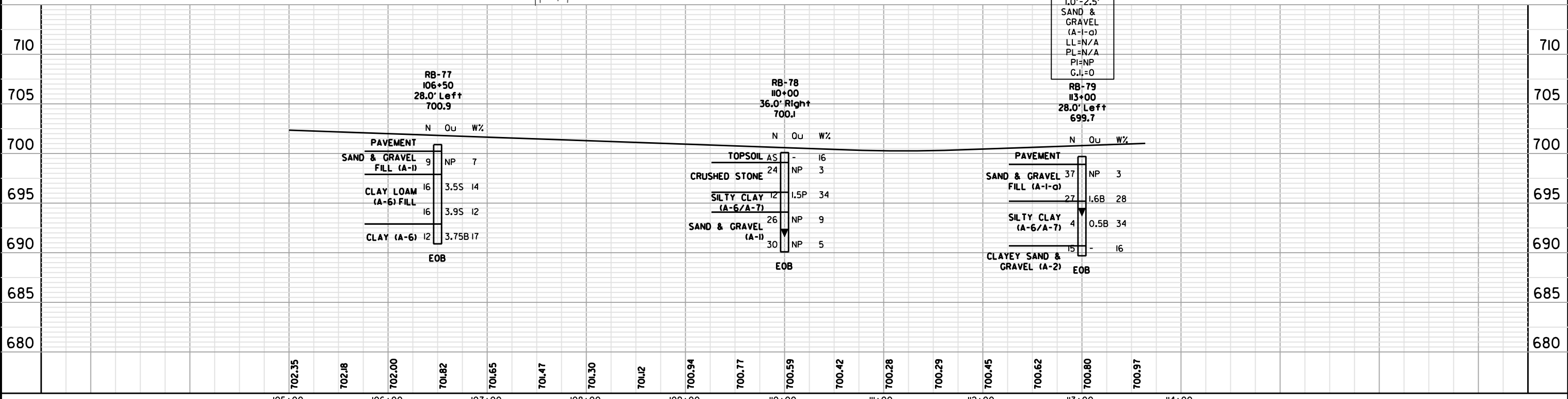
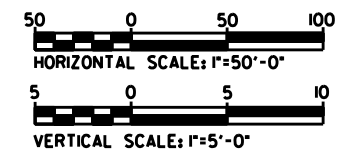
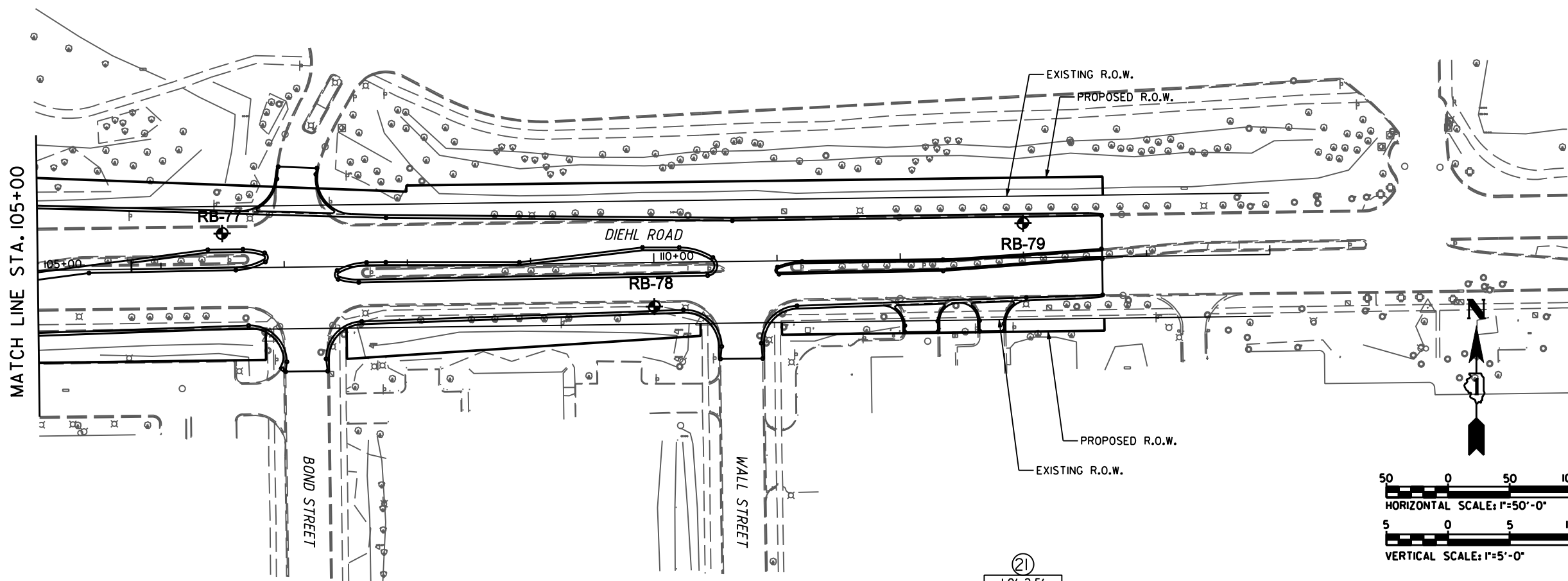

(2) 1.0'-2.5'  
SAND & GRAVEL (A-1-G)  
LL=N/A  
PL=N/A  
PI=NP  
C.I.=0

<b>Geo Services, Inc.</b> Geotechnical, Environmental & Civil Engineering 805 Ashurst Court, Suite 204 Naperville, Illinois 60563 1630-355-2838	USER NAME :	DESIGNED - RWC	REVISED -	<b>STATE OF ILLINOIS</b> <b>DEPARTMENT OF TRANSPORTATION</b>	<b>SOIL BORING</b> <b>PLAN / PROFILE DIEHL ROAD</b>			F.A.P. RTE.	SECTION	COUNTY	TOTAL SHEETS	SHEET NO.
	PLOT SCALE :	DRAWN - RWC	REVISED -		338/IL 59	482-8-131-WRS-5	DUPAGE	734	566			
	PLOT DATE :	CHECKED - AJP	REVISED -		SCALE: SHEET NO. OF SHEETS STA. 105+00 TO STA. 115+00			CONTRACT NO. 60R31				
		DATE - 3/24/2011	REVISED -		FED. ROAD DIST. NO.			ILLINOIS FED. AID PROJECT				