

|          |  |
|----------|--|
| DATE     |  |
| BY       |  |
| DESIGNED |  |
| DRAWN    |  |
| CHECKED  |  |
| DATE     |  |

|          |  |
|----------|--|
| DATE     |  |
| BY       |  |
| DESIGNED |  |
| DRAWN    |  |
| CHECKED  |  |
| DATE     |  |

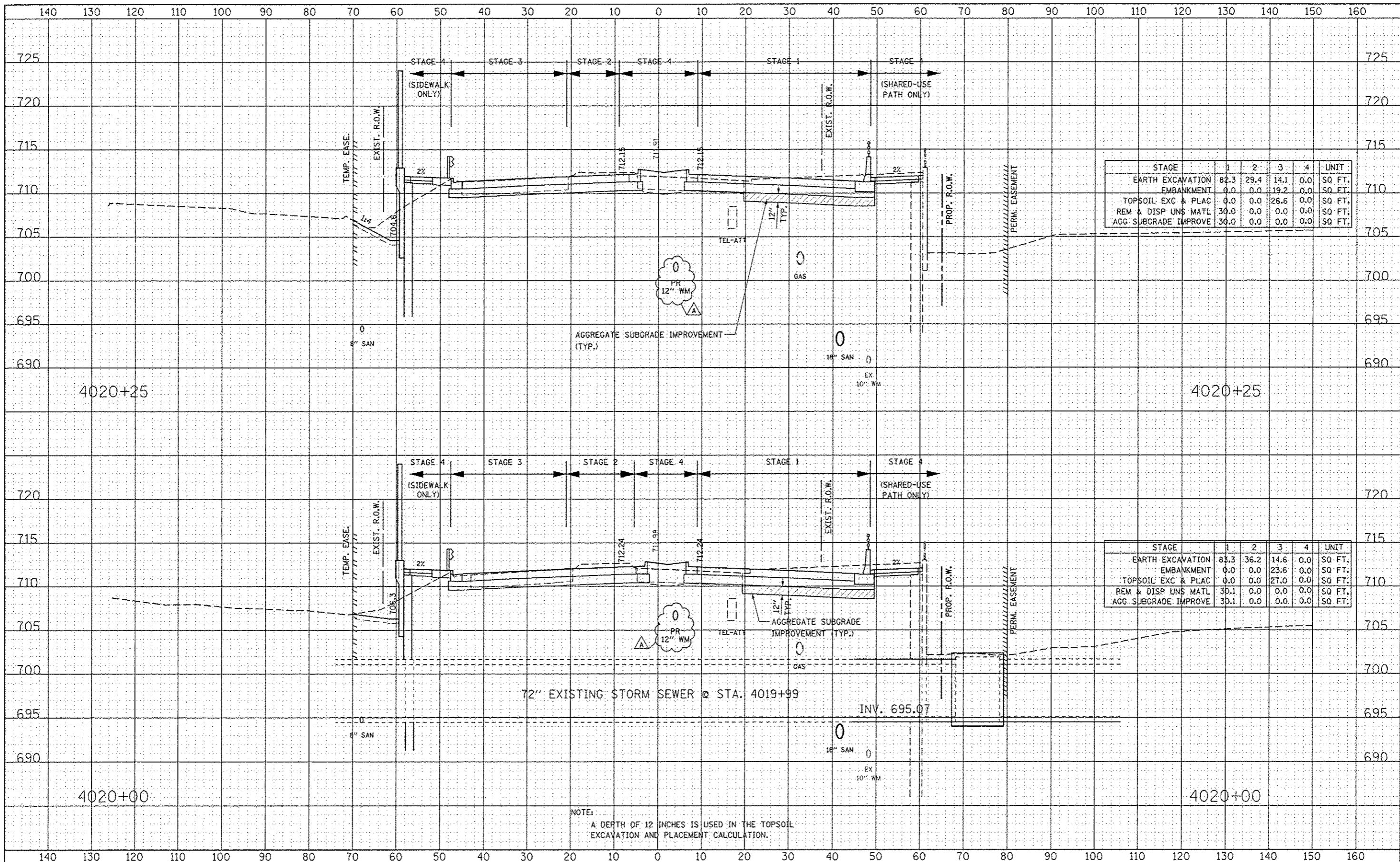

| STAGE                | 1    | 2    | 3    | 4   | UNIT   |
|----------------------|------|------|------|-----|--------|
| EARTH EXCAVATION     | 82.3 | 29.4 | 14.1 | 0.0 | SQ FT. |
| EMBANKMENT           | 0.0  | 0.0  | 19.2 | 0.0 | SQ FT. |
| TOPSOIL EXC & PLAC   | 0.0  | 0.0  | 26.6 | 0.0 | SQ FT. |
| REM & DISP UNS MATL  | 30.0 | 0.0  | 0.0  | 0.0 | SQ FT. |
| AGG SUBGRADE IMPROVE | 30.0 | 0.0  | 0.0  | 0.0 | SQ FT. |

| STAGE                | 1    | 2    | 3    | 4   | UNIT   |
|----------------------|------|------|------|-----|--------|
| EARTH EXCAVATION     | 83.3 | 36.2 | 14.6 | 0.0 | SQ FT. |
| EMBANKMENT           | 0.0  | 0.0  | 23.6 | 0.0 | SQ FT. |
| TOPSOIL EXC & PLAC   | 0.0  | 0.0  | 27.0 | 0.0 | SQ FT. |
| REM & DISP UNS MATL  | 30.1 | 0.0  | 0.0  | 0.0 | SQ FT. |
| AGG SUBGRADE IMPROVE | 30.1 | 0.0  | 0.0  | 0.0 | SQ FT. |

NOTE:  
A DEPTH OF 12 INCHES IS USED IN THE TOPSOIL EXCAVATION AND PLACEMENT CALCULATION.

|                   |                                 |
|-------------------|---------------------------------|
| DESIGNED - RTA    | REVISED - ADDENDUM A 02/22/2013 |
| DRAWN - KES       | REVISED -                       |
| CHECKED - PJO     | REVISED -                       |
| DATE - 12/14/2012 | REVISED -                       |

STATE OF ILLINOIS  
DEPARTMENT OF TRANSPORTATION

ILLINOIS ROUTE 59  
STAGE 1 THRU 4 CROSS-SECTIONS  
SCALE: SHEET NO. 36 OF 59 SHEETS STA. 4020+00 TO STA. 4020+25

|                     |                   |                           |              |           |
|---------------------|-------------------|---------------------------|--------------|-----------|
| F.A.P. RTE.         | SECTION           | COUNTY                    | TOTAL SHEETS | SHEET NO. |
| 338                 | (112 & 113) WRS-6 | DUPAGE                    | 734          | 677       |
| FED. ROAD DIST. NO. |                   | ILLINOIS FED. AID PROJECT |              |           |
| CONTRACT NO. 60R31  |                   |                           |              |           |