

DATE	
DESIGNED	
DRAWN	
CHECKED	
DATE	

DATE	
DESIGNED	
DRAWN	
CHECKED	
DATE	

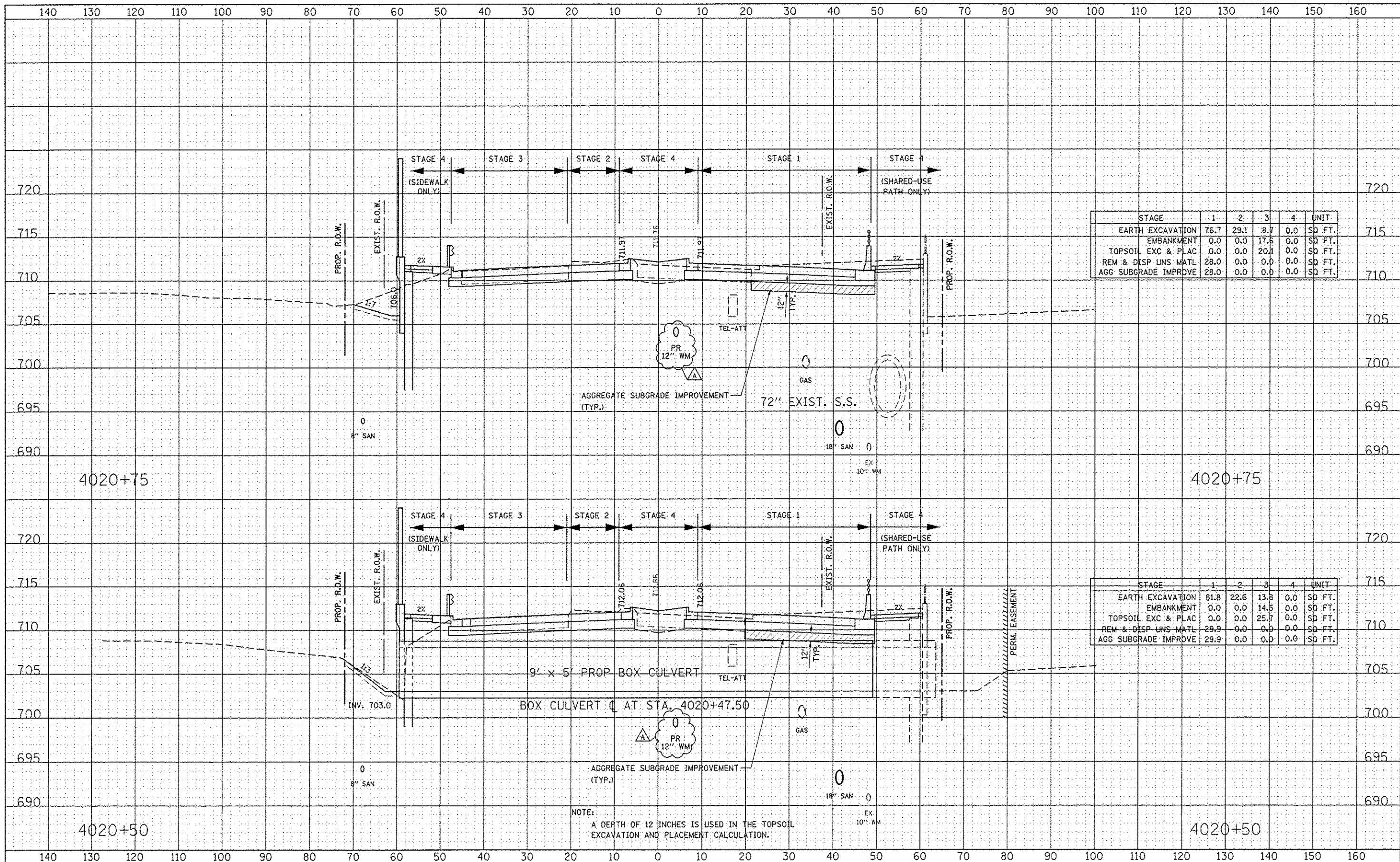

STAGE	1	2	3	4	UNIT
EARTH EXCAVATION	76.7	29.1	8.7	0.0	SD FT.
EMBANKMENT	0.0	0.0	17.5	0.0	SD FT.
TOPSOIL EXC & PLAC	0.0	0.0	20.1	0.0	SD FT.
REM & DISP UNS MATL	28.0	0.0	0.0	0.0	SD FT.
AGG SUBGRADE IMPROVE	28.0	0.0	0.0	0.0	SD FT.

STAGE	1	2	3	4	UNIT
EARTH EXCAVATION	81.8	22.6	13.3	0.0	SD FT.
EMBANKMENT	0.0	0.0	14.5	0.0	SD FT.
TOPSOIL EXC & PLAC	0.0	0.0	25.7	0.0	SD FT.
REM & DISP UNS MATL	29.9	0.0	0.0	0.0	SD FT.
AGG SUBGRADE IMPROVE	29.9	0.0	0.0	0.0	SD FT.

NOTE:
A DEPTH OF 12 INCHES IS USED IN THE TOPSOIL EXCAVATION AND PLACEMENT CALCULATION.

DESIGNED	RTA	REVISED	ADDENDUM A 02/22/2013
DRAWN	RES	REVISED	
CHECKED	PJO	REVISED	
DATE	12/14/2012	REVISED	

STATE OF ILLINOIS
DEPARTMENT OF TRANSPORTATION

ILLINOIS ROUTE 59 STAGE 1 THRU 4 CROSS-SECTIONS		F.A.P. RTE.	SECTION	COUNTY	TOTAL SHEETS	SHEET NO.
SCALE: 1" = 10'		338	(112 & 113) WRS-6	DUPAGE	734	678
SHEET NO. 37 OF 59 SHEETS		STA. 4020+50 TO STA. 4020+75		CONTRACT NO. 60R31		
		FED. ROAD DIST. NO.		ILLINOIS FED. AID PROJECT		