

LOCATON MAP #3
F.A.P. ROUTE 824 (U.S. 45)
FROM U.S. 133 IN ARCOLA TO DOUGLAS / COLES COUNTY LINE
DOUGLAS COUNTY / RURAL 2 LANE

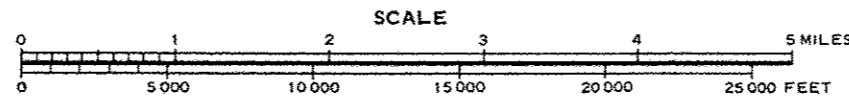

TOWNSHIPS:
ARCOLA

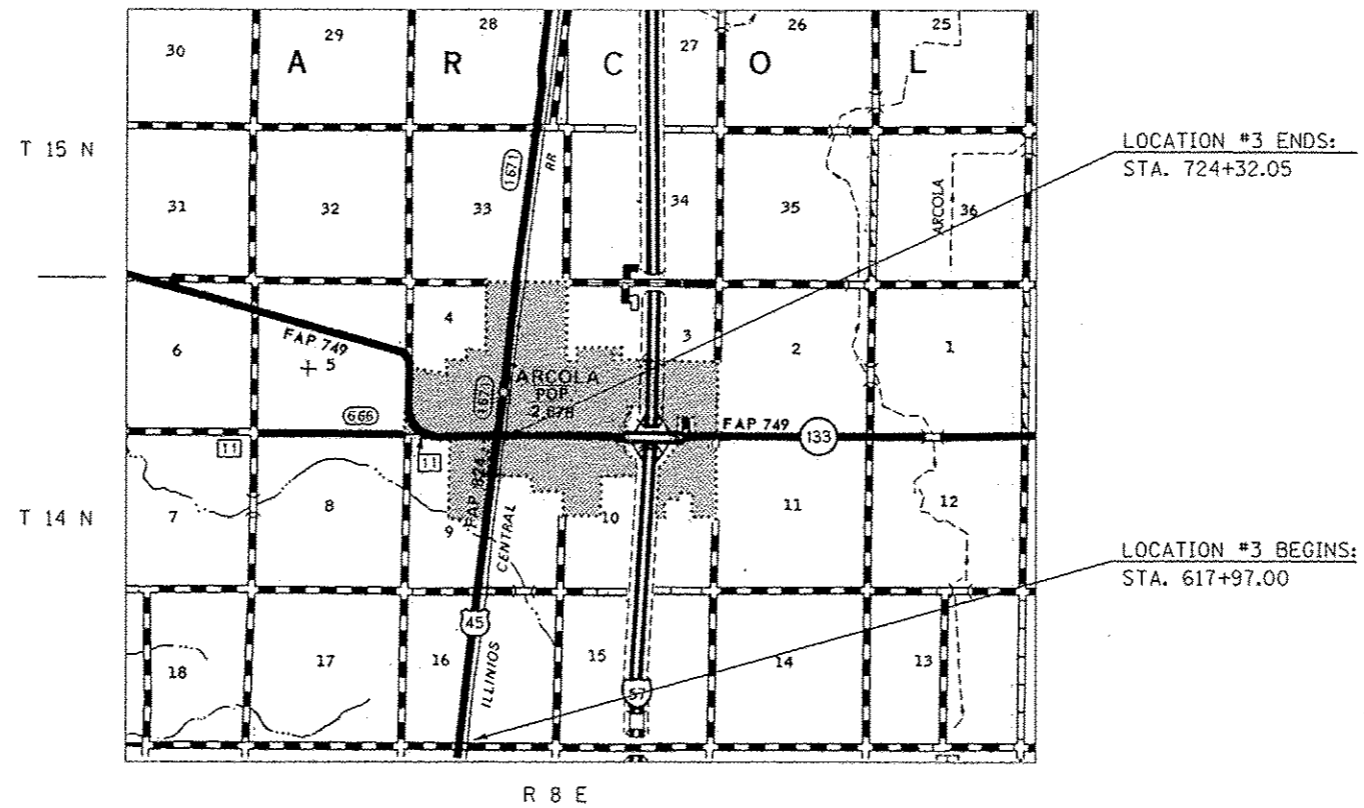

GROSS LENGTH OF LOCATION #3 = 10,635.05 FT = 2.014 MILES
NET LENGTH OF LOCATION #3 = 10,635.05 FT = 2.014 MILES

*SHOULDER REPAIR FY2013-2
 ** DOUGLAS & EDGAR

FILE NAME *	USER NAME : ceer-lockjd	DESIGNED -	REVISED -	STATE OF ILLINOIS DEPARTMENT OF TRANSPORTATION	LOCATION MAP #3 F.A.P. ROUTE 824 (U.S. 45)	F.A. RTE.	SECTION	COUNTY	TOTAL SHEETS	SHEET NO.	
cr:\p\work\pvidot\ceer-lockjd\0330898\0	70424-shi-Location Map.dgn	DRAWN -	REVISED -		SCALE:	SHEET 1 OF 1 SHEETS	STA.	TO STA.	**	15	5
	PLOT SCALE : 40.0000' / 1" =	CHECKED -	REVISED -		CONTRACT NO. 70A24						
MODELNAME	PLOT DATE : 3/20/2013	DATE -	REVISED -		ILLINOIS FED. AID PROJECT						