

STATE OF ILLINOIS
DEPARTMENT OF TRANSPORTATION

PROJECT NO.	SECTION	COUNTY	TOTAL SHEETS	SHEET NO.
108-1	D6 PAINTING	ADAMS/PIKE	16	12

C&N USGS Gaging Station (Cross Pier) in North East
1/4 Sec 11 of Mc Craney Creek Bridge Sta 1297+10 at 15'
Elev 484.69

Existing structure is a three span R.C deck girder bridge
24'-2" wide, 156'-6" long with closed abutments and two
solid piers. The contractor shall remove the existing structure
after the relocation is completed.

075-0076

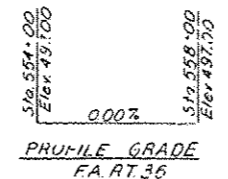

GENERAL NOTES

All reinforcement bars shall be lapped 24 diameters unless otherwise shown.
Fasteners shall be high strength bolts. Bolts 3/4", open holes 1/8", unless otherwise noted.
Calculated weight of Structural Steel = 406,100 lbs.
The Basic Lead Silico Chromate paint system shall be used for shop and field painting of structural steel.
Field welding of construction accessories will not be permitted to the bottom flange of beams or girders nor to the top flange for a distance equal to one-fourth the span length each way from the pier supports. Field welding in other areas will be permitted only when approved by the Engineer.
Anchor bolts shall be set before bolting Joints over supports.
Slope wall shall be reinforced with welded wire fabric 6" x 6" mesh, weighing 58# per 100 sq.ft.
Layout of slope walls may be varied in the field to suit ground conditions as directed by the Engineer.
The concrete rail section above the mandatory construction joint at the top of the slab shall be constructed of Class X Concrete, except the aggregates shall conform to the requirements of Handrail Concrete.
Protective Coat shall not be applied to surfaces to which Coat Tar Interlayer Protective Coat is applied.
The Contractor shall drive 4 test piles in permanent locations as directed by the Engineer before ordering the remainder of piles. 1 (Concrete) at the West Abutment, 1 (Steel HP10x42) at the East Abutment, 1 (Untreated) at Pier #1 & 1 (Steel HP8x36) at Pier #2.

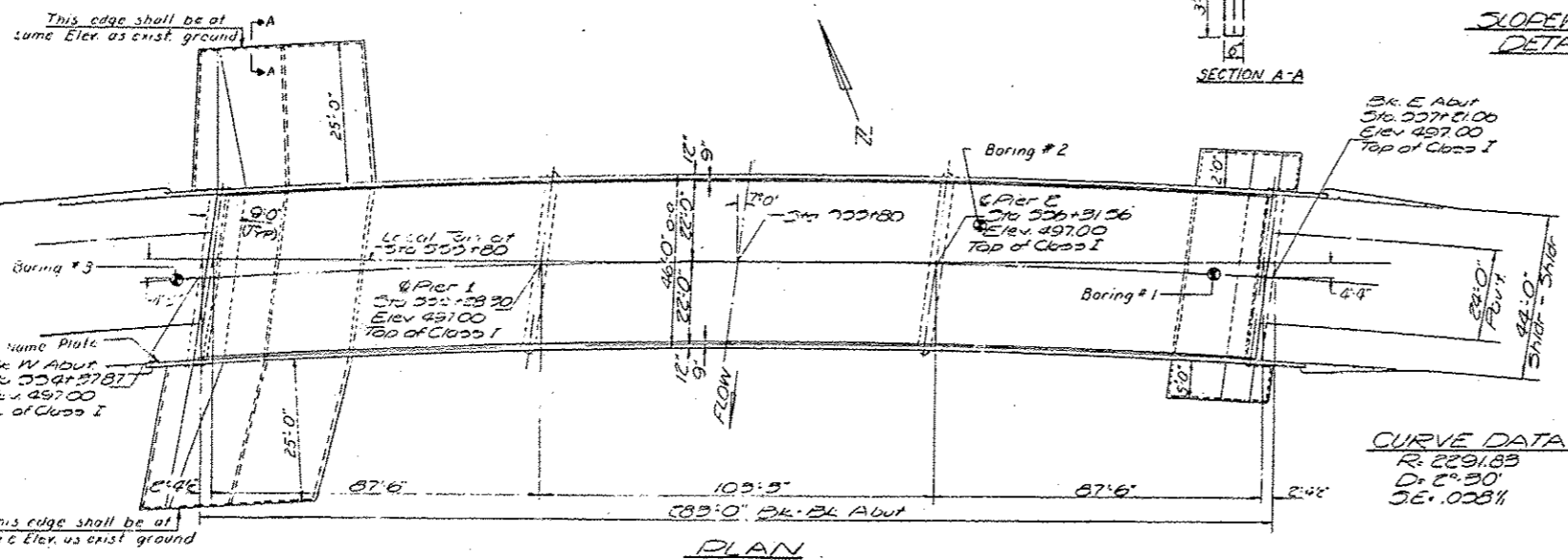
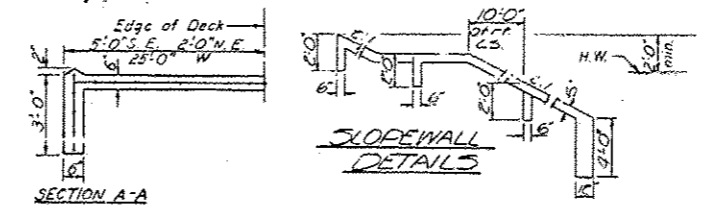
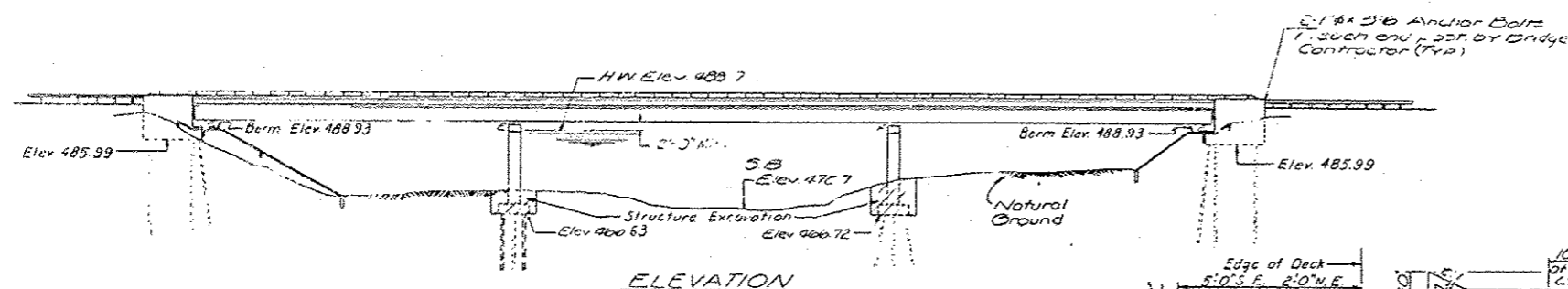

TOTAL BILL OF MATERIAL

Item	Unit	Super	Sub	Total
Bituminous Concrete Surface Course Class I	Tons	107		107
Removal of Existing Structures	Each			1
Structure Excavation	Cu. Yds.		582	582
Protective Coat	Sq. Yds.	219		219
Class X Concrete	Cu. Yds.	394.6	334.0	728.6
Structural Steel	L. S.	L. S.		L. S.
Stud Shear Connectors	Each	3024		3024
Aluminum Railing	Lin. Ft.	610		610
Reinforcement Bars	Lbs.	87570	23610	111180
Untreated Piles up to 30 ft	Lin. Ft.		874	874
Concrete Piles	Lin. Ft.		574	574
Steel Piles HP8x36	Lin. Ft.		468	468
Steel Piles HP10x42	Lin. Ft.		490	490
Test Piles Timber	Each		1	1
Test Piles Concrete	Each		1	1
Test Piles Steel HP8x36	Each		1	1
Test Piles Steel HP10x42	Each		1	1
Name Plates	Each	1		1
Slope Wall 6"	Sq. Yds.		690	690
Coal Tar Interlayer Protective Coat	Sq. Yds.	1321		1321
Preformed Joint Sealer 2 1/2"	Lin. Ft.		44	44
Neoprene Expansion Joint 2 1/2"	Lin. Ft.		46	46

CURVE DATA
R: 2291.85
D: 2°30'
GE: 0.038%

WATERWAY INFORMATION

Drainage Area: 498 sq. miles
Reach Opening: 2800 sq. ft.
Proposed Opening: 2800 sq. ft.
Q(50): 13164 cfs.

DESIGN STRESSES

f_c = 4000 psi (Sub. Curb & Parapet)
f_c = 1800 psi (Deck Slab)
f_s = 20000 psi (Reinf. & Structural)
v_c = 10 psi (Flg.)
n = 10
Design Specifications 1969 AASHTO (as applicable)
Allow. CS Los. / sq. ft. for Full W.S.

LOADING HS20-44

STATION 555+80
BUILT 197 BY
STATE OF ILLINOIS
FA RT 36 SEC 14B-1
F.A. PROJ. RF-108 (20)
LOADING HS 20

NAME PLATE
See Std. 2113

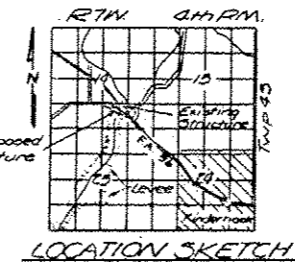

PROJECT RF-108 (20)
GENERAL PLAN AND ELEVATION
FA 36 OVER MC CRANEY CREEK
FA RTE 36 SEC 14B-1
PIKE COUNTY
STATION 555+80

DESIGNED	J. WENT.
CHECKED	James H. Hentz
R.P.S.	Ferraro
DRAWN	Ferraro
CHECKED	JNP

EXAMINED	June 2, 1977
PASSED	
APPROVED	

FOR INFORMATION ONLY