

05-24-13 SPECIAL LETTING ITEM 040

STATE OF ILLINOIS
DEPARTMENT OF TRANSPORTATION
DIVISION OF HIGHWAYS

**PROPOSED
CONTRACT MAINTENANCE**

FAS 1613 (OLD US 36)
SECTION (21)I-4
PROJECT CLASS B PATCHES
SANGAMON COUNTY

C-96-047-13

R 6 W

BEGIN PROJECT
STA. 237 + 00

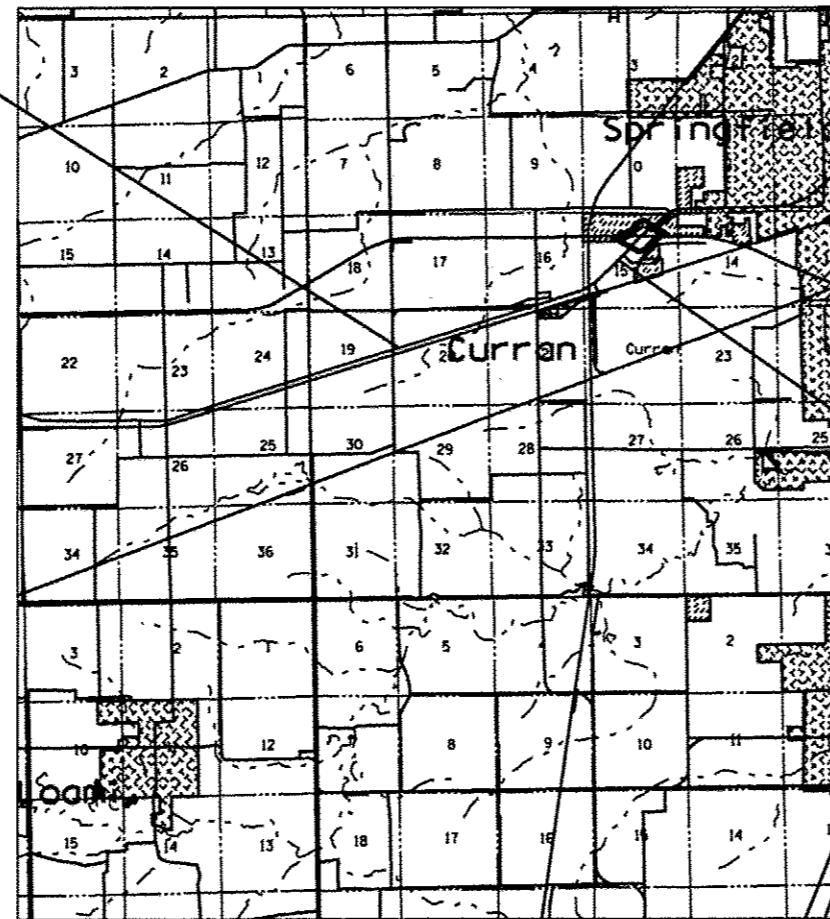

END PROJECT
STA. 342 + 25

ADT = 4,150(375)

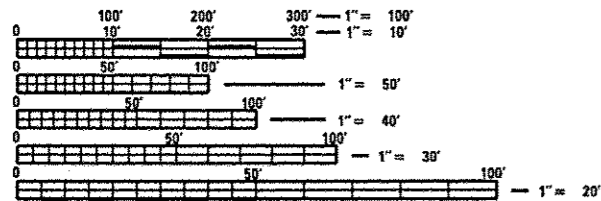

FULL SIZE PLANS HAVE BEEN PREPARED USING STANDARD ENGINEERING SCALES. REDUCED SIZED PLANS WILL NOT CONFORM TO STANDARD SCALES. IN MAKING MEASUREMENTS ON REDUCED PLANS, THE ABOVE SCALES MAY BE USED.

J.U.L.I.E.
JOINT UTILITY LOCATION INFORMATION FOR EXCAVATION
1-800-892-0123
OR 811

PLAN AND CONTRACT TECHNICIAN
TIMOTHY SHARP (217)782-7743

CONTRACT NO. 72G12

GROSS LENGTH = 10,525.00 FT. = 1.993 MILES

F.A.S. RTE.	SECTION	COUNTY	TOTAL SHEETS	SHEET NO.
1613	(21)I-4	SANGAMON	4	1
FED. ROAD DIST. NO.	ILLINOIS	CONTRACT NO. 72G12		

D-86-047-13



STATE OF ILLINOIS
DEPARTMENT OF TRANSPORTATION
DIVISION OF HIGHWAYS

SUBMITTED March 29 2013
Rp Zank
DEPUTY DIRECTOR OF HIGHWAYS, REGION ENGINEER

April 26 2013
John D. Baranzelli, P.E.
ENGINEER OF DESIGN AND ENVIRONMENT

April 26 2013
Emor Osman, P.E.
DIRECTOR OF HIGHWAYS, CHIEF ENGINEER

**PRINTED BY THE AUTHORITY
OF THE STATE OF ILLINOIS**

INDEX OF SHEETS

1. COVER
2. INDEX OF SHEETS, GENERAL NOTES, AND HIGHWAY STANDARDS
3. SUMMARY OF QUANTITIES
4. TYPICAL SECTIONS

HIGHWAY STANDARDS

- 420701-02
- 442101-07
- 701001-02
- 701006-04
- 701201-04
- 701301-04
- 701501-06
- 701901-02

GENERAL NOTES

1. ANY REFERENCE TO THE STANDARDS THROUGHOUT THE PLANS SHALL BE INTERPRETED TO BE THE LATEST STANDARDS OF THE DEPARTMENT AS INCLUDED IN THE PLANS.
2. NO EXCAVATION IS ANTICIPATED ON THIS PROJECT. SHOULD ANY EXCAVATION BE REQUIRED, J.U.L.I.E. SHALL BE NOTIFIED A MINIMUM OF 48 HOURS IN ADVANCE (800) 892-0123.

STATE OF ILLINOIS DEPARTMENT OF TRANSPORTATION DIVISION OF HIGHWAYS DISTRICT 6	
EXAMINED	3/7 _____ <i>Bill M. B...</i> ENGINEER OF OPERATIONS
EXAMINED	FEB 28 _____ <i>Jerry Z...</i> ENGINEER OF PROJECT IMPLEMENTATION
EXAMINED	March 1 _____ <i>ARMLJ</i> ENGINEER OF PROGRAM DEVELOPMENT

FILE NAME *	USER NAME * #USERS	DESIGNED -	REVISED -	STATE OF ILLINOIS DEPARTMENT OF TRANSPORTATION	INDEX OF SHEETS, HIGHWAY STANDARDS AND GENERAL NOTES	F.A.S. RTE.	SECTION	COUNTY	TOTAL SHEETS	SHEET NO.
#FILE#		DRAWN -	REVISED -			1613	211-4	SANGAMON	4	2
Default		CHECKED -	REVISED -		SCALE: _____ SHEET 1 OF 1 SHEETS STA. _____ TO STA. _____				ILLINOIS FED. AID PROJECT CONTRACT NO. 72G12	
		PLOT SCALE * #SCALE#	REVISED -							
		PLOT DATE * #DATE#	REVISED -							

CODE NO.	ITEM	UNIT	TOTAL QUANTITY	CONSTR. CODE
				100% STATE
				ROADWAY
				0005
				S. N.
44200956	CLASS B PATCHES, TYPE II, 9 INCH	SO YD	285	285
44200964	CLASS B PATCHES, TYPE IV, 9 INCH	SO YD	62	62
44201297	DOWEL BARS 1"	EACH	90	90
44213100	PAVEMENT FABRIC	SO YD	62	62
44213200	SAW CUTS	FOOT	1,655	1,655
44213204	TIE BARS 3/4"	EACH	26	26
67100100	MOBILIZATION	L SUM	1	1
70100450	TRAFFIC CONTROL AND PROTECTION, STANDARD 701201	L SUM	1	1
70102620	TRAFFIC CONTROL AND PROTECTION, STANDARD 701501	L SUM	1	1

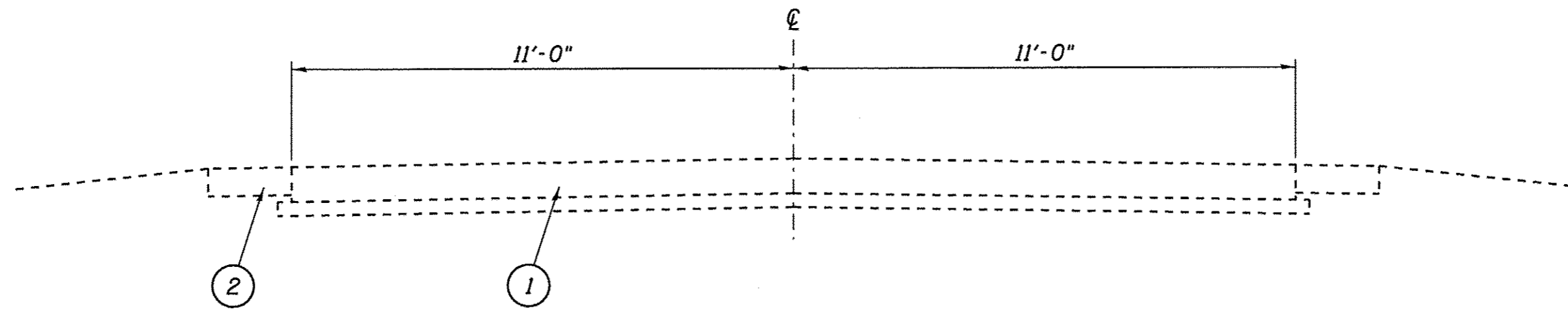

STA. 237+00 TO 342+25

LEGEND

- 1 - EXIST. P.C.C. PAVEMENT 9"
- 2 - EXIST. H.M.A. SHOULDER, 8"

FILE NAME *	USER NAME * #USER#	DESIGNED -	REVISED -	STATE OF ILLINOIS DEPARTMENT OF TRANSPORTATION	TYPICAL SECTION	F.A.S. RTE.	SECTION	COUNTY	TOTAL SHEETS	SHEET NO.	
#FILE#		DRAWN -	REVISED -			1613	2111-4	ANGAMON	4	4	
SHT_PLAN		CHECKED -	REVISED -			SCALE: _____ SHEET 1 OF 1 SHEETS STA. _____ TO STA. _____		CONTRACT NO. 72G12			
		DATE -	REVISED -			(ILLINOIS) FED. AID PROJECT					