

STATE OF ILLINOIS
 DEPARTMENT OF TRANSPORTATION
 DIVISION OF HIGHWAYS

**PROPOSED
 CONTRACT MAINTENANCE**

FAS 1613 (OLD US 36)
 SECTION (23)I-3

SANGAMON COUNTY

C-96-050-13

R 7 W

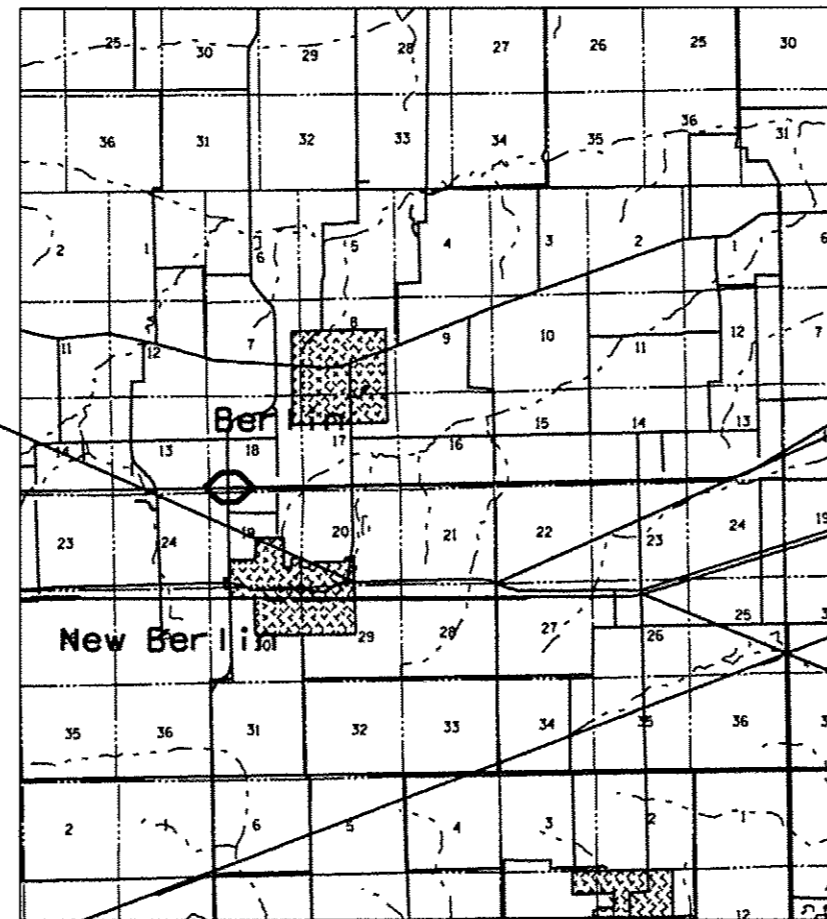

STA. EQ. 0 + 00.00bk = 633 + 60.00ah

GROSS LENGTH = 15,495.00 FT. = 2.935 MILES

F.A.S. RTE.	SECTION	COUNTY	TOTAL SHEETS	SHEET NO.
1613	(23)I-3	SANGAMON	4	1
FED. ROAD DIST. NO.	ILLINOIS	CONTRACT NO. 72G15		

D-96-050-13

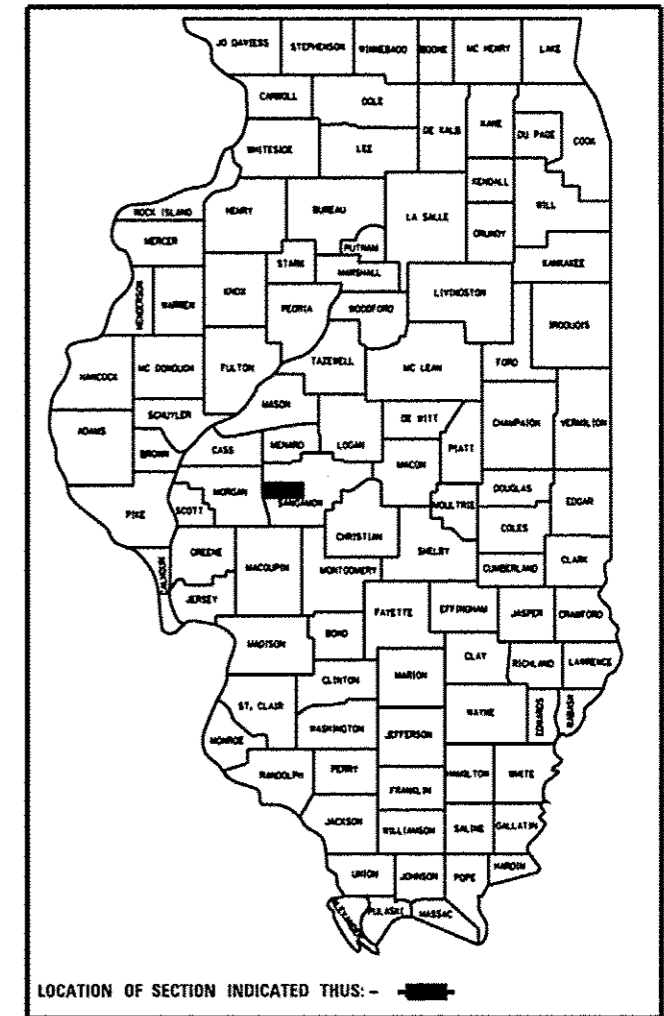

LOCATION OF SECTION INDICATED THUS: - [shaded box] -

FOR INDEX OF SHEETS, SEE SHEET NO. 2

ADT = 2,050(75)

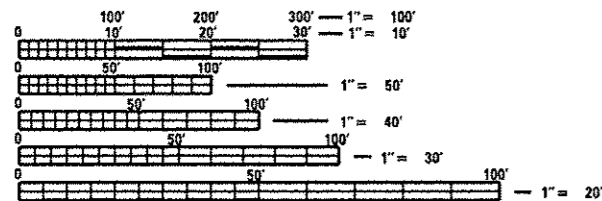

FULL SIZE PLANS HAVE BEEN PREPARED USING STANDARD ENGINEERING SCALES. REDUCED SIZED PLANS WILL NOT CONFORM TO STANDARD SCALES. IN MAKING MEASUREMENTS ON REDUCED PLANS, THE ABOVE SCALES MAY BE USED.

J.U.L.I.E.
 JOINT UTILITY LOCATION INFORMATION FOR EXCAVATION
 1-800-892-0123
 OR 811

PLAN AND CONTRACT TECHNICIAN
 TIMOTHY SHARP (217)782-7743

CONTRACT NO. 72G15

STA. EQ.
 0 + 00.00bk =
 633 + 60.00ah

END PROJECT
 STA. 83 + 19

STATE OF ILLINOIS
 DEPARTMENT OF TRANSPORTATION
 DIVISION OF HIGHWAYS

SUBMITTED March 23 2013
Ryo Zompa
 DEPUTY DIRECTOR OF HIGHWAYS, REGION ENGINEER

April 26 2013
John D. Baranzoni, PE/la
 acting ENGINEER OF DESIGN AND ENVIRONMENT

April 26 2013
Omer Osman, PE/la
 DIRECTOR OF HIGHWAYS, CHIEF ENGINEER

**PRINTED BY THE AUTHORITY
 OF THE STATE OF ILLINOIS**