

WEST EDGE OF SHOULDER

Location	Station	Offset	Theoretical Grade Elevations
S. End of South Appr. Slab	647+54.40	-4.00	445.13
A1	647+64.40	-4.00	445.33
A2	647+74.40	-4.00	445.52
N. End of South Appr. Slab	647+84.40	-4.00	445.72

WEST EDGE OF ROADWAY AND PROFILE GRADE

Location	Station	Offset	Theoretical Grade Elevations
S. End of South Appr. Slab	647+52.45	0.00	445.18
A1	647+62.45	0.00	445.37
A2	647+72.45	0.00	445.57
N. End of South Appr. Slab	647+82.45	0.00	445.76

☉ ROADWAY

Location	Station	Offset	Theoretical Grade Elevations
S. End of South Appr. Slab	647+46.60	12.00	445.25
A1	647+56.60	12.00	445.45
A2	647+66.60	12.00	445.64
N. End of South Appr. Slab	647+76.60	12.00	445.84

EAST EDGE OF ROADWAY

Location	Station	Offset	Theoretical Grade Elevations
S. End of South Appr. Slab	647+40.74	24.00	444.95
A1	647+50.74	24.00	445.15
A2	647+60.74	24.00	445.34
N. End of South Appr. Slab	647+70.74	24.00	445.53

EAST EDGE OF SHOULDER

Location	Station	Offset	Theoretical Grade Elevations
S. End of South Appr. Slab	647+35.87	34.00	444.65
A1	647+45.87	34.00	444.84
A2	647+55.87	34.00	445.04
N. End of South Appr. Slab	647+65.87	34.00	445.23

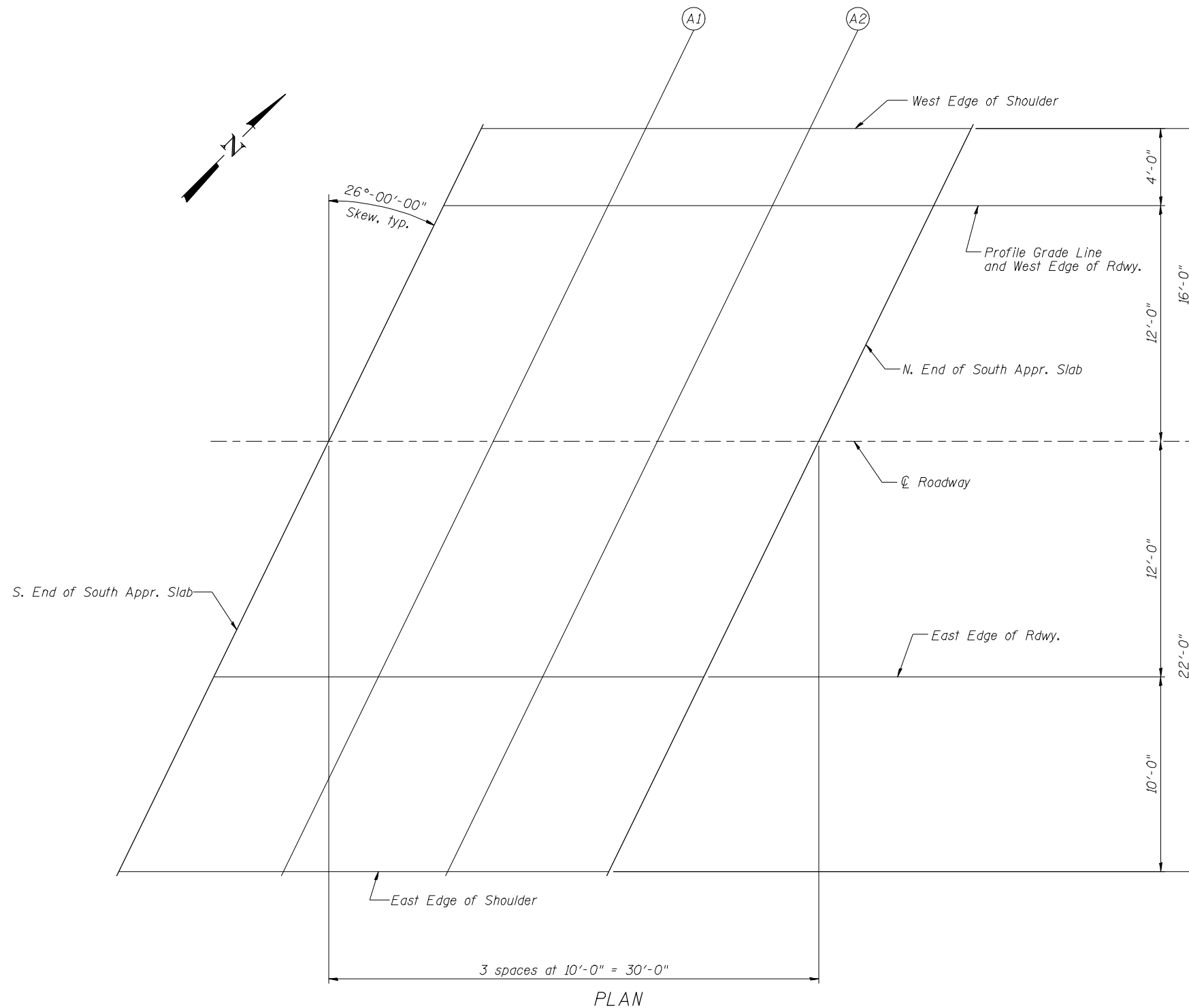

Notes:
 Units = Feet
 Offsets are measured from Profile Grade Line.
 Negative values indicate offset is to left when looking ahead station.

P:\CX\31000\100cadd\1095tr\FINAL PLANS\0820334-16848-02-Appr Slab Elev(NB).dgn
 17-OCT-2012 16:23