

WEST EDGE OF SHOULDER

| Location | Station | Offset | Theoretical Grade Elevations |
|----------------------------|-----------|--------|------------------------------|
| S. End of South Appr. Slab | 648+34.91 | -34.00 | 446.58 |
| A5 | 648+44.91 | -34.00 | 446.77 |
| A6 | 648+54.91 | -34.00 | 446.96 |
| N. End of South Appr. Slab | 648+64.91 | -34.00 | 447.14 |

WEST EDGE OF ROADWAY

| Location | Station | Offset | Theoretical Grade Elevations |
|----------------------------|-----------|--------|------------------------------|
| S. End of South Appr. Slab | 648+30.03 | -24.00 | 446.69 |
| A5 | 648+40.03 | -24.00 | 446.88 |
| A6 | 648+50.03 | -24.00 | 447.08 |
| N. End of South Appr. Slab | 648+60.03 | -24.00 | 447.26 |

CL ROADWAY

| Location | Station | Offset | Theoretical Grade Elevations |
|----------------------------|-----------|--------|------------------------------|
| S. End of South Appr. Slab | 648+24.18 | -12.00 | 446.76 |
| A5 | 648+34.18 | -12.00 | 446.96 |
| A6 | 648+44.18 | -12.00 | 447.15 |
| N. End of South Appr. Slab | 648+54.18 | -12.00 | 447.34 |

EAST EDGE OF ROADWAY AND PROFILE GRADE

| Location | Station | Offset | Theoretical Grade Elevations |
|----------------------------|-----------|--------|------------------------------|
| S. End of South Appr. Slab | 648+18.33 | 0.00 | 446.46 |
| A5 | 648+28.33 | 0.00 | 446.66 |
| A6 | 648+38.33 | 0.00 | 446.85 |
| N. End of South Appr. Slab | 648+48.33 | 0.00 | 447.04 |

EAST EDGE OF SHOULDER

| Location | Station | Offset | Theoretical Grade Elevations |
|----------------------------|-----------|--------|------------------------------|
| S. End of South Appr. Slab | 648+16.38 | 4.00 | 446.34 |
| A5 | 648+26.38 | 4.00 | 446.53 |
| A6 | 648+36.38 | 4.00 | 446.73 |
| N. End of South Appr. Slab | 648+46.38 | 4.00 | 446.92 |

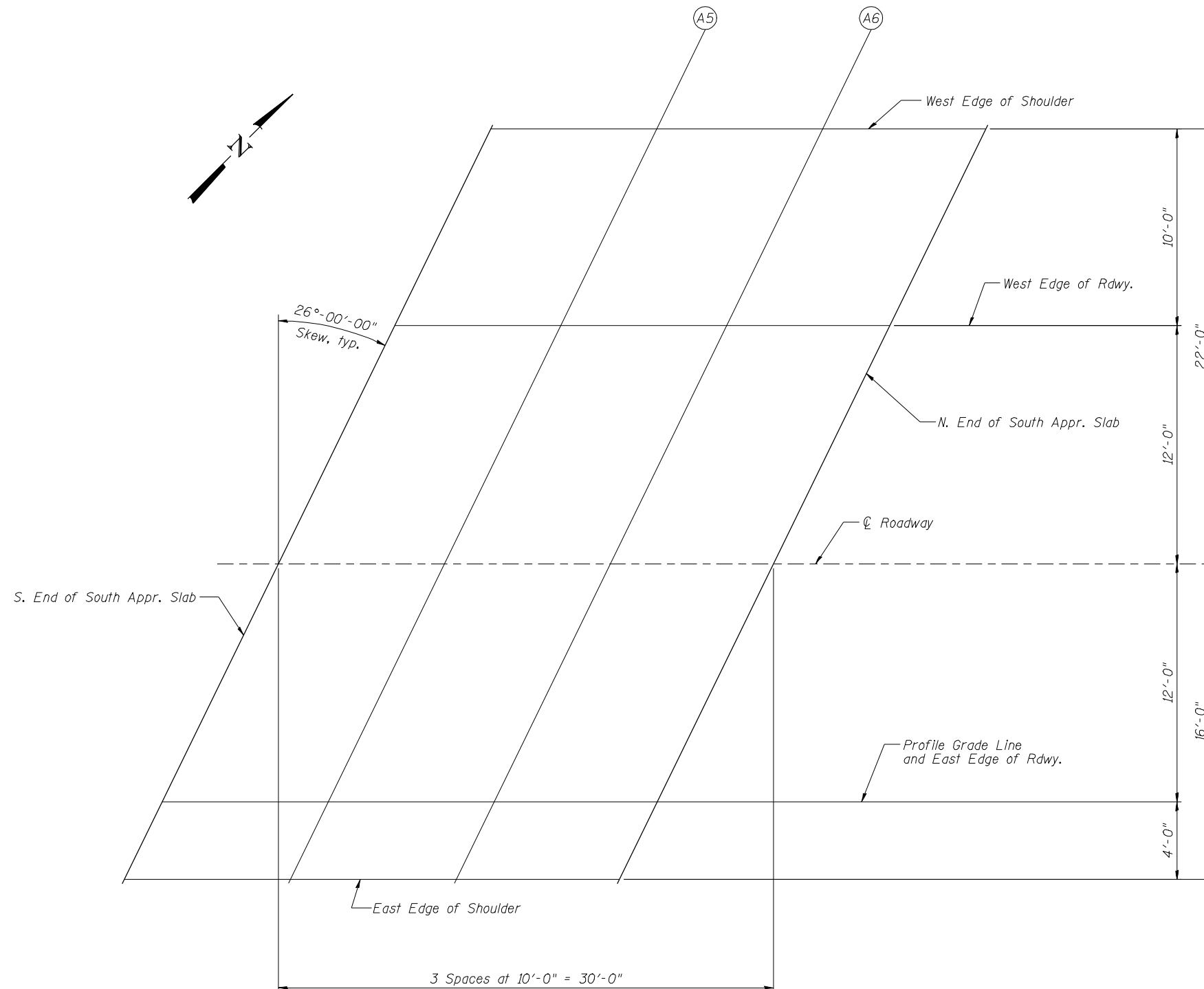

PLAN

Notes:
 Units = Feet
 Offsets are measured from Profile Grade Line.
 Negative values indicate offset is to left when looking ahead station.

P:\CX\31000\700cadd\7096tr\FINAL PLANS\0820335-76848-014-Appr_Slab Elev(SB).dgn
 17-OCT-2012
 16:23



| | | |
|-------------------------|-----------------------|-----------|
| USER NAME = | DESIGNED - S. HENNING | REVISED - |
| | CHECKED - N. KHATRI | REVISED - |
| PLOT DATE = 17-OCT-2012 | DRAWN - M. MEYER | REVISED - |
| | CHECKED - E. BAZZELL | REVISED - |

STATE OF ILLINOIS
 DEPARTMENT OF TRANSPORTATION

TOP OF SOUTH APPROACH SLAB ELEVATIONS - S.B.
 STRUCTURE NO. 082-0334 (N.B.) & 082-0335 (S.B.)

| | | | | |
|--------------------|------------|-----------|--------------|-----------|
| F.A.P. RTE. | SECTION | COUNTY | TOTAL SHEETS | SHEET NO. |
| 788 | 520-1-2HVB | ST. CLAIR | 237 | 71 |
| CONTRACT NO. 76848 | | | | |

SHEET NO. C14 OF 76 SHEETS

ILLINOIS FED. AID PROJECT

FILE NAME = 0820335-76848-014-Appr_Slab Elev(SB).dgn