

P:\CX31000\700cadd\709str\FINAL_PLANS\0820334-76848-023-Appr_Slab_Plan(NB).dgn
06-FEB-2013
11:44

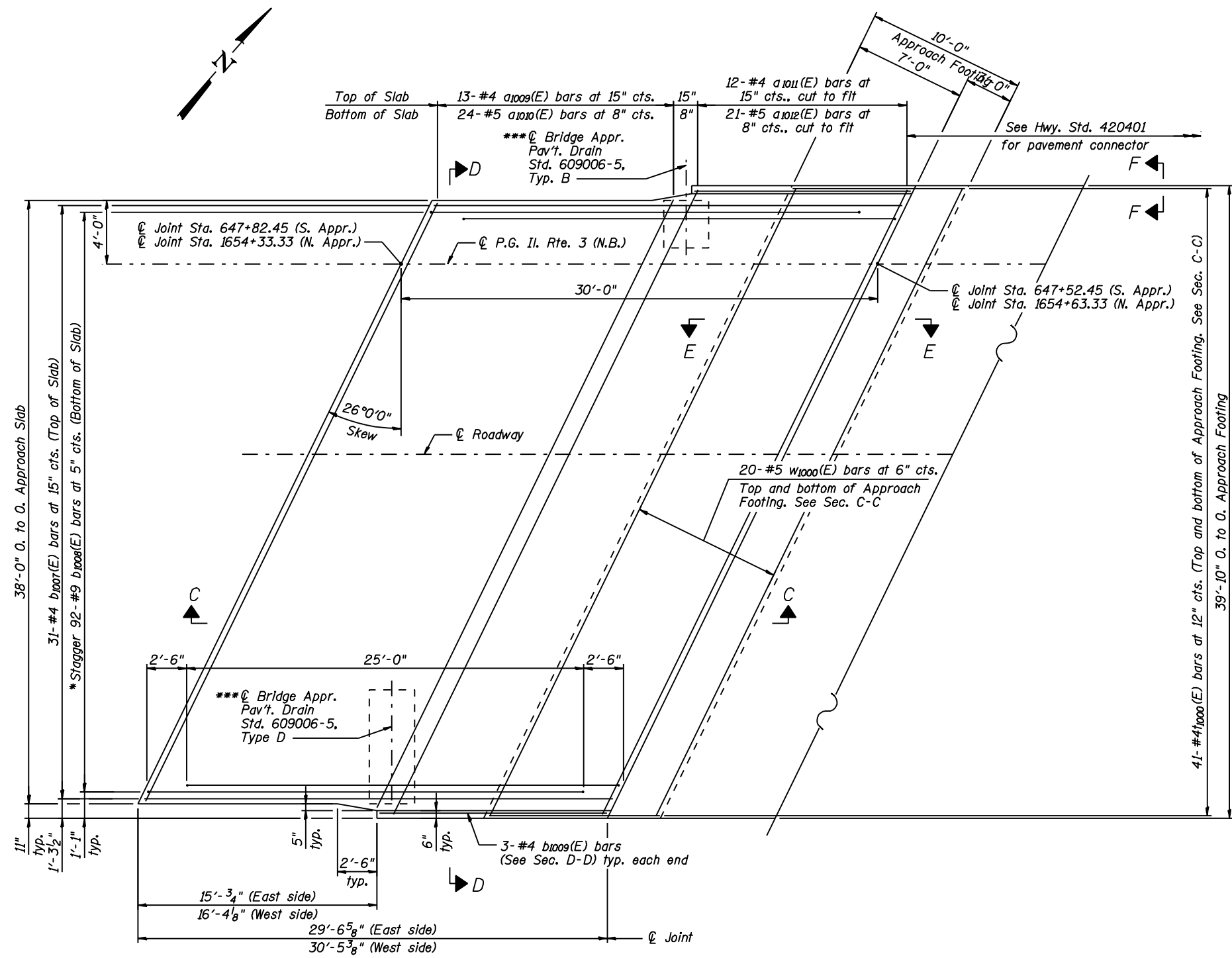

PLAN

(North Approach Slab shown, South Approach similar)

- * Tilt #9 bars as required to maintain clearance.
- ** Closed cell joint filler according to Article 1051.09 of the Std. Specifications; full depth of slab, full length of parapet. Typ. each parapet.
- *** Order bars full length. Cut bars in field to clear Bridge Approach Pavement Drain.

Notes:
See sheet C25 for Sections C-C & D-D and View E-E.
#4, #5, #6, #7, #8, #9, #10, #11, #12 bar spacings measured along \varnothing Rdwy.
The joint opening shall be determined per Article 520.04 except that on jointless structures, the distance described as the bridge length between the nearest fixed bearings each way from the joint shall be taken as half the bridge length plus the approach slab length. The minimum dimension shall be 1 1/2' for installation purposes.

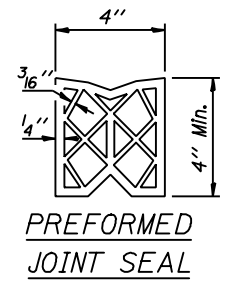
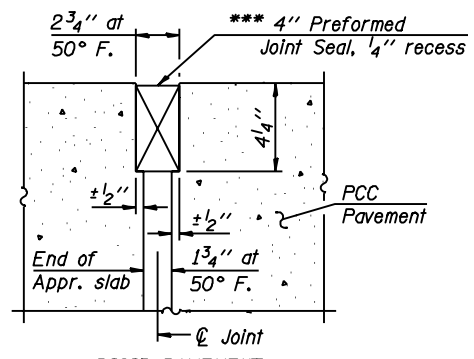
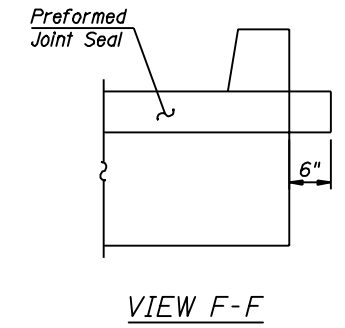

*** Cost Included with Concrete Superstructure.



USER NAME =	DESIGNED - N. KHATRI	REVISED - 02/06/13
PLOT DATE = 06-FEB-2013	CHECKED - S. HENNING	REVISED -
FILE NAME = 0820334-76848-023-Appr_Slab_Plan(NB).dgn	DRAWN - M. MEYER	REVISED -
	CHECKED - S. HENNING	REVISED -

**STATE OF ILLINOIS
DEPARTMENT OF TRANSPORTATION**

**BRIDGE APPROACH SLAB DETAILS (N.B.)
STRUCTURE NO. 082-0334 (N.B.) & 082-0335 (S.B.)**

F.A.P. RTE.	SECTION	COUNTY	TOTAL SHEETS	SHEET NO.
788	520-1-2HVB	ST. CLAIR	237	80
CONTRACT NO. 76848				

SHEET NO. C23 OF 76 SHEETS

ILLINOIS FED. AID PROJECT