

Benchmarks: MRC Horizontal/Vertical Control Monument No. 8 (Elevation 401.95)  
 Aluminum disc set in the South end of a headwall to a box culvert under Illinois Route 3; 0.7 miles South of Canal Street; 0.1 miles South of Industrial Ave. and North of railroad track.

Existing Structure: None.

**LOADING HL-93**  
 Allow 50#/sq. ft. for future wearing surface.

**DESIGN SPECIFICATIONS**  
 AASHTO LRFD Bridge Design Specifications,  
 Customary U.S. Units, 5th Edition, with 2010 Interims

**DESIGN STRESSES**

**FIELD UNITS:**  
 $f'_c = 3,500$  psi (Cast-in-Place)  
 $f_y = 60,000$  psi (Reinforcement)  
 $f_y = 50,000$  psi (Structural Steel -  
 #270 Grade 50W)

**SEISMIC DATA**

Seismic Performance Zone (SPZ) = 2  
 Design Spectral Acceleration at 1.0 sec. (SD1) = 0.238g  
 Design Spectral Acceleration at 0.2 sec. (SDs) = 0.539g  
 Soil Site Class = D

**INDEX OF SHEETS**

SHEET NO.	TITLE
B1	GENERAL PLAN AND ELEVATION
B2-B3	GENERAL DATA
B4	TOP OF SLAB ELEVATION LOCATIONS
B5-B6	TOP OF SLAB ELEVATIONS
B9-B10	TOP OF APPROACH SLAB ELEVATIONS
B11-B12	SUPERSTRUCTURE DECK
B13	SUPERSTRUCTURE CROSS SECTION
B14	SUPERSTRUCTURE DETAILS
B15-B16	DIAPHRAGM DETAILS
B17-B20	BRIDGE APPROACH SLAB DETAILS
B21-B22	STRUCTURAL STEEL
B23	FIXED BEARING DETAILS
B24-B25	ABUTMENTS, SOUTHBOUND
B26-B27	ABUTMENTS, NORTHBOUND
B28	PIER NO. 1, SOUTHBOUND
B29	PIER NO. 2, SOUTHBOUND
B30	PIER NO. 1, NORTHBOUND
B31	PIER NO. 2, NORTHBOUND
B32-B33	PIER DETAILS
B34	HP PILE DETAILS
B35	METAL SHELL PILE DETAILS
B36	BAR SPLICER ASSEMBLY AND MECHANICAL SPLICER DETAILS
B37	CANTILEVER FORMING BRACKETS FOR SUPERSTRUCTURES WITH W27 BEAMS AND SMALLER
B38-B39	BRIDGE FENCE DETAILS
B40-B50	SOIL BORING LOGS

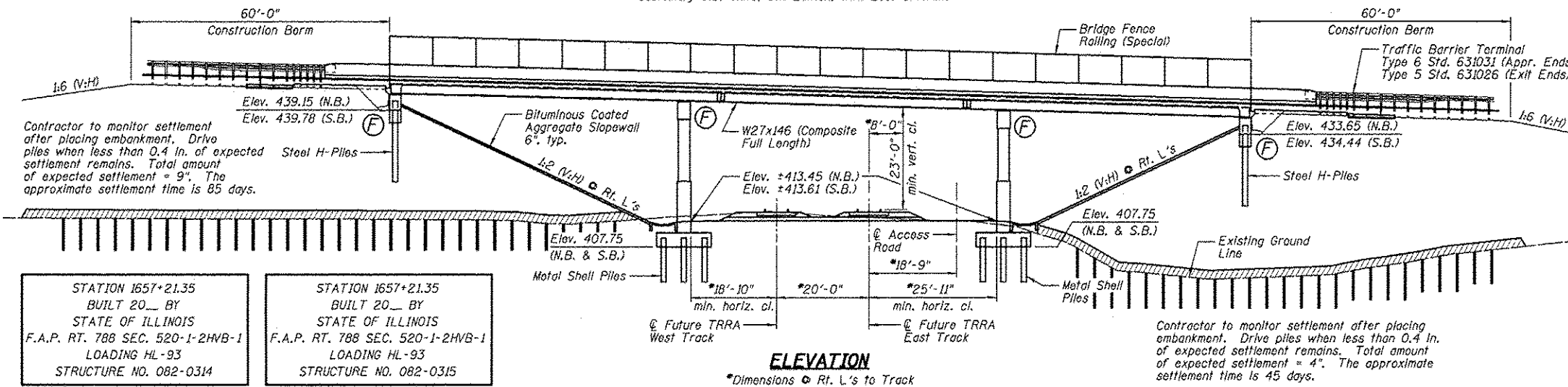

**NAME PLATE**  
 See Std. 515001

**NAME PLATE**  
 See Std. 515001

**NOTES:**

- 1.) No free fall deck drains will be permitted in the span over the tracks or within 10 ft. of cross arms of railroad pole line.
- 2.) All guardrail and inlets to be constructed under future paving contract.

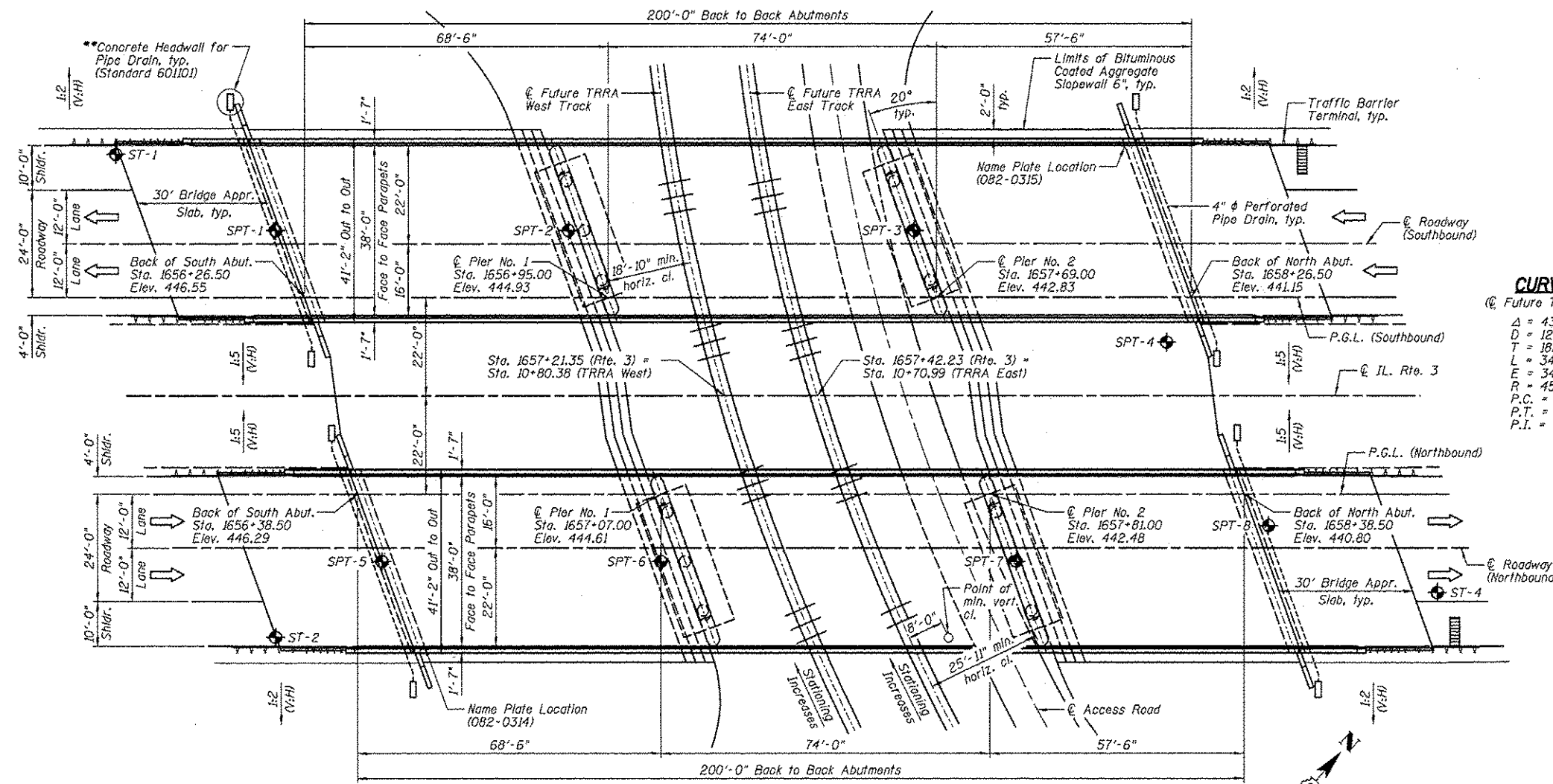

Joseph M. Lowrance Date 12-10-12  
 JOSEPH M. LOWRANCE  
 ILLINOIS STRUCTURAL ENGINEER  
 NO. 081-006446  
 Exp. Date 11/30/14

**CURVE DATA**  
 (© Future TRRA West Track)

$\Delta = 43^{\circ}21'40''$
$D = 12^{\circ}30'00''$
$T = 182.59'$
$L = 347.58'$
$E = 34.96'$
$R = 459.28'$
P.C. = Sta. 8+20.19
P.T. = Sta. 11+67.77
P.I. = Sta. 10+02.78

**APPROVED**  
 For Structural Adequacy Only

*Joseph M. Lowrance*  
 Engineer of Bridges & Structures

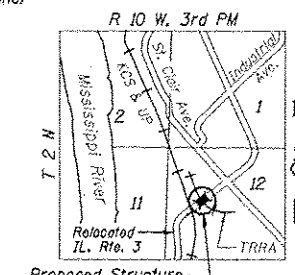

**GENERAL PLAN AND ELEVATION**  
**RELOCATED IL. ROUTE 3 OVER**  
**TRRA RAILROAD**  
**F.A.P. RTE. 788 - SECTION 520-1-2HVB-1**  
**ST. CLAIR COUNTY**  
**STATION 1657+21.35**  
**STRUCTURE NO. 082-0314 (NB)**  
**STRUCTURE NO. 082-0315 (SB)**

**Farnsworth**  
 GROUP, INC.  
 2709 McDew Drive  
 Bloomington, Illinois 61704  
 309.683.8435, 309.663.1571 fax

DESIGNED - TCR	REVISOR
CHECKED - JML	REVISOR
DRAWN - JWK/DJM	REVISOR
CHECKED - MSW	REVISOR

**STATE OF ILLINOIS**  
**DEPARTMENT OF TRANSPORTATION**

SHEET NO. B1 OF 50 SHEETS

F.A.P. RTE.	SECTION	COUNTY	TOTAL SHEETS	SHEET NO.
788	520-1-2HVB-1	ST. CLAIR	237	134
CONTRACT NO. 76848				

ILLINOIS FED. AID PROJECT