

**FORM BRACES FOR  
STAGE CONSTRUCTION**

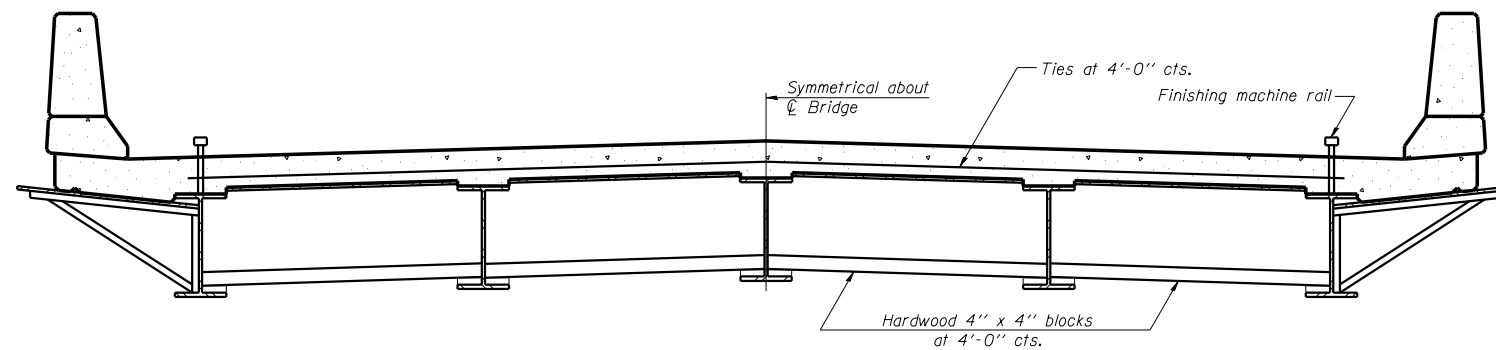

**FORM BRACES FOR  
STANDARD CONSTRUCTION**

**NOTES:**

- 1.) When cantilever forming brackets are used, the work shall be done according to Article 503.06(b) of the Standard Specifications, except as modified below and in the details shown on this sheet.
- 2.) The finishing machine rails shall be placed on the top flange of the exterior beams.
- 3.) The beams or girders, supporting cantilever forming brackets, shall be tied together at 4 foot intervals.
- 4.) For Standard construction, or Stage Construction the Hardwood bracing materials shall be placed as shown between webs of beams in each bay.

SB-1

7-1-10

**Farnsworth**  
GROUP, INC.  
2709 McGraw Drive  
Bloomington, Illinois 61704  
309/663-8435, 309/663-1571 fax

|                 |         |
|-----------------|---------|
| DESIGNED - TCR  | REVISED |
| CHECKED - JML   | REVISED |
| DRAWN - JWK/DJM | REVISED |
| CHECKED - MSW   | REVISED |
| DATE - 10/18/12 |         |

**STATE OF ILLINOIS  
DEPARTMENT OF TRANSPORTATION**

**CANTILEVER FORMING BRACKETS FOR SUPERSTRUCTURES  
WITH W27 BEAMS AND SMALLER  
STRUCTURE NO. 082-0314 NB & 082-0315 SB**

SHEET NO. B37 OF 50 SHEETS

| F.A.P. RTE.               | SECTION      | COUNTY    | TOTAL SHEETS | SHEET NO. |
|---------------------------|--------------|-----------|--------------|-----------|
| 788                       | 520-1-2HVB-1 | ST. CLAIR | 237          | 170       |
| CONTRACT NO. 76848        |              |           |              |           |
| ILLINOIS FED. AID PROJECT |              |           |              |           |