

BENCHMARK: BM #110
 CHISELED "X" ON TOP NE FLANGE BOLT ON FIRE
 HYDRANT LOCATED AT S. ENTRANCE TO "MOTO MART"
 ON E. SIDE OF IL RTE 159.
 STA. 189+32±, 22' RT, ELEV. 553.065

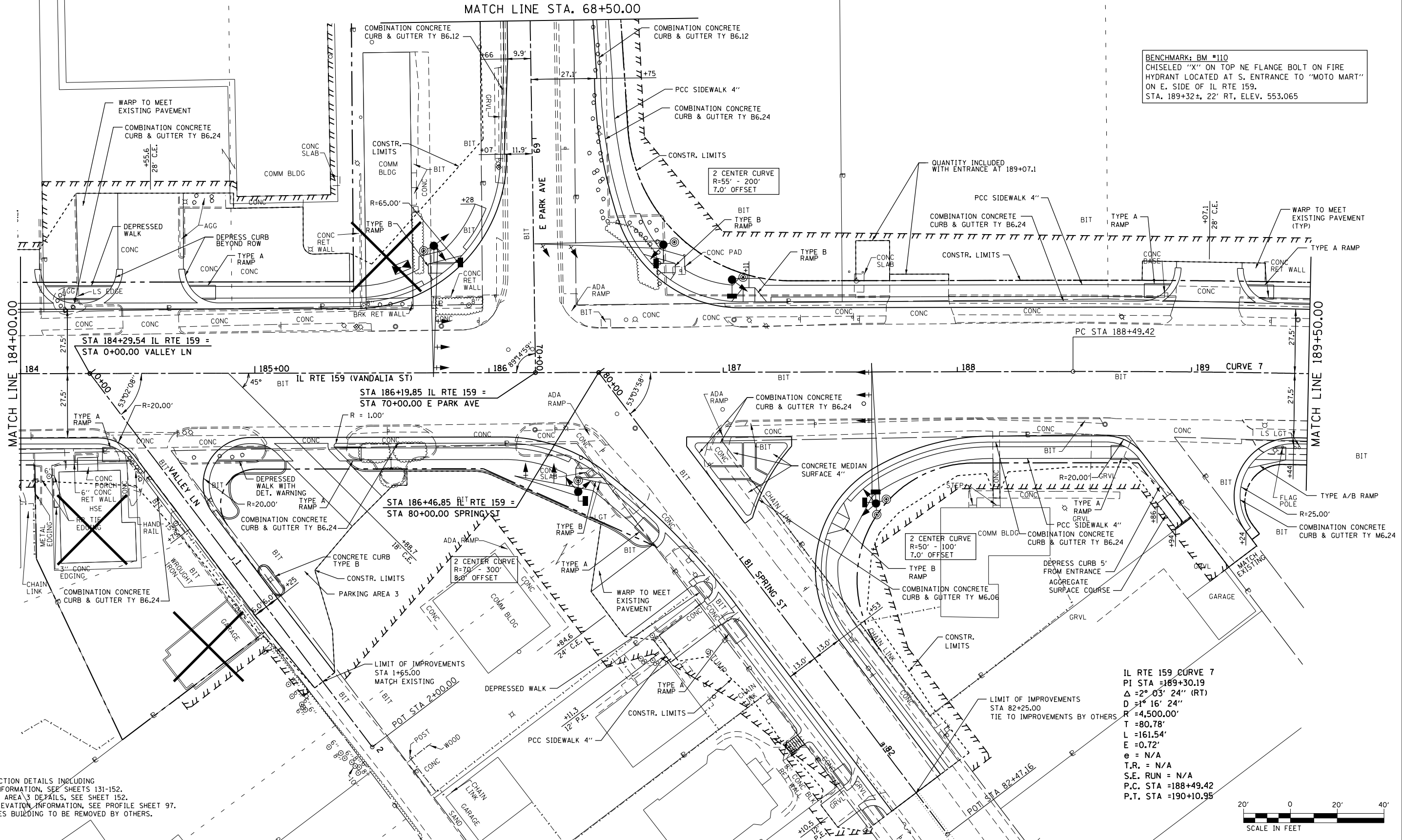

- NOTES:
1. FOR INTERSECTION DETAILS INCLUDING SIDEWALK INFORMATION, SEE SHEETS 131-152.
 2. FOR PARKING AREA 3 DETAILS, SEE SHEET 152.
 3. FOR SUPERELEVATION INFORMATION, SEE PROFILE SHEET 97.
 4. "X" INDICATES BUILDING TO BE REMOVED BY OTHERS.

IL RTE 159 CURVE 7
 PI STA = 189+30.19
 $\Delta = 2^\circ 03' 24''$ (RT)
 $D = 1^\circ 16' 24''$
 $R = 4,500.00'$
 $T = 80.78'$
 $L = 161.54'$
 $E = 0.72'$
 $e = N/A$
 $T.R. = N/A$
 $S.E. RUN = N/A$
 $P.C. STA = 188+49.42$
 $P.T. STA = 190+10.95$

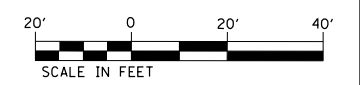

FILE NAME =	USER NAME = default	DESIGNED - AGF	REVISED -	STATE OF ILLINOIS DEPARTMENT OF TRANSPORTATION	PLAN IL ROUTE 159	F.A.P. RTE.	SECTION	COUNTY	TOTAL SHEETS	SHEET NO.
P:\Projects\513501\CADD\DN\0876885-sh1p\Inpr.f.dgn	DRAWN - AGF	REVISED -	600			60-(30,31,128)-3	MADISON	529	96	
PLOT SCALE = 40.0000' / in.	CHECKED - CLS	REVISED -	CONTRACT NO. 76885							
PLOT DATE = 1/25/2013	DATE - 01/25/2013	REVISED -	ILLINOIS FED. AID PROJECT							
				SCALE: 1" = 20'	SHEET NO. 9 OF 43 SHEETS	STA. 184+00.00 TO STA. 189+50.00				