

**NOTES:**

1. ALL PROPOSED INLET GRATE ELEVATIONS ARE EDGE OF PAVEMENT ELEVATIONS UNLESS OTHERWISE NOTED.
2. REFER TO STORM PROFILE SHEETS FOR ALL ADDITIONAL INFORMATION NOT LOCATED ON THE PLAN SHEET.
3. EXISTING UTILITIES ARE SHOWN FOR INFORMATION PURPOSES ONLY. ALL LOCATIONS AND ELEVATIONS ARE APPROXIMATE. UTILITIES IN ADDITION TO THOSE SHOWN MAY BE PRESENT. THE CONTRACTOR SHALL FIELD VERIFY THE LOCATION OF ALL UTILITIES BEFORE STARTING CONSTRUCTION.
4. THE EXISTING WATER MAIN AND WATER SERVICE LINES SHOWN ARE FOR INFORMATION PURPOSES ONLY. ALL SIZES, LOCATIONS, AND LENGTHS ARE APPROXIMATE. WATER MAIN, WATER SERVICE LINES, AND FIRE SERVICE LINES IN ADDITION TO THOSE SHOWN MAY BE PRESENT. THE CONTRACTOR SHALL FIELD VERIFY THE SIZE, LOCATION, AND LENGTH OF ALL WATER MAIN AND WATER SERVICE LINES PRIOR TO THE START OF CONSTRUCTION.
5. CONTRACTOR SHALL BE RESPONSIBLE FOR THE LOCATION OF PROPOSED WATER METERS BASED ON CITY OF COLLINGSVILLE REGULATIONS AND THE STANDARD SPECIFICATIONS FOR WATER & SEWER MAIN CONSTRUCTION IN ILLINOIS.
6. IN AREAS WHERE FLEXIBLE RUBBER GASKETS WILL BE USED ALTERNATIVE TO WATER QUALITY PIPE, THE CONTRACTOR WILL BE RESPONSIBLE FOR ALL COORDINATION BETWEEN THE CONCRETE PIPE MANUFACTURER AND THE RUBBER GASKET MANUFACTURER TO ENSURE THE CONCRETE PIPES ARE CONSTRUCTED IN ACCORDANCE WITH THE GASKET MANUFACTURER'S SPECIFICATIONS.
7. CONTRACTOR SHALL PUSH ALL WATER SERVICES FROM STATION 171+00 LT TO 175+75 LT TO AVOID DISTURBING THE HISTORIC SIDEWALK AND APPURTENANCES.

- (A) RECONSTRUCT EX SMH 3-1  
IL 159 - LINE-3  
STA. 177+28.62, 5.08' RT  
WICKLIFFE AVE - LINE - 9  
STA 60+04.27, 25.65' LT  
EX RIM = 545.15  
PR RIM = 546.17
- (B) INSTALL NEW SMH A-1  
IL 159 - LINE-A  
STA. 177+69.04, 16.50' LT  
RIM = 545.42
- (C) INSTALL NEW SMH A-2  
IL 159 - LINE-A  
STA. 178+71.05, 6.11' RT  
RIM = 544.23

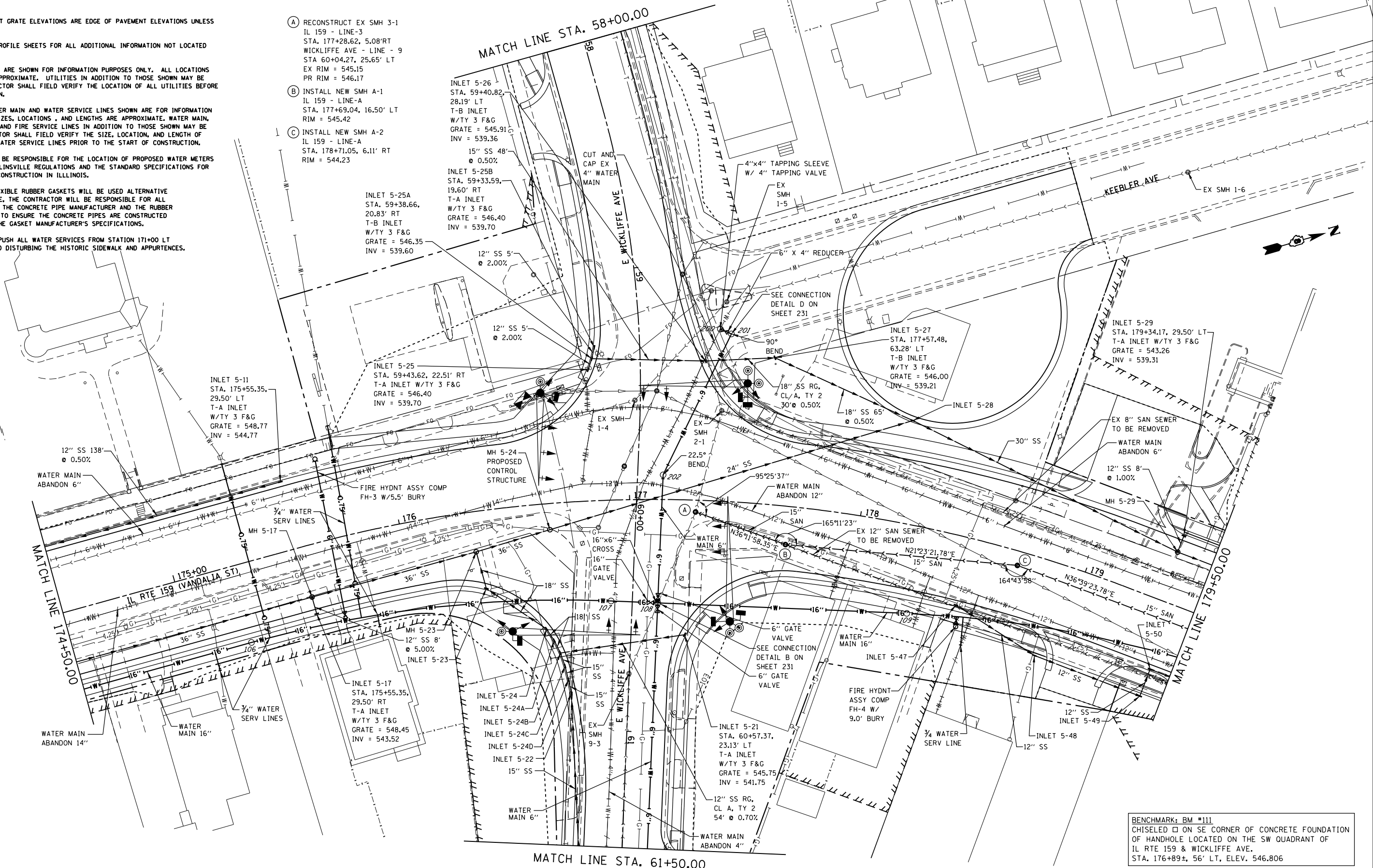

**BENCHMARK: BM #111**  
CHISELED □ ON SE CORNER OF CONCRETE FOUNDATION OF HANDHOLE LOCATED ON THE SW QUADRANT OF IL RTE 159 & WICKLIFFE AVE.  
STA. 176+89±, 56' LT, ELEV. 546.806

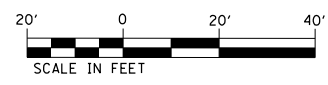

FILE NAME =	USER NAME = default	DESIGNED - DRH	REVISED -
P:\Projects\513501\CADD\DN\0876885-sht	dra\ain.dgn	DRAWN - DRH	REVISED -
	PLOT SCALE = 40.0000' / in.	CHECKED - VAM	REVISED -
	PLOT DATE = 2/1/2013	DATE - 01/25/2013	REVISED -

**STATE OF ILLINOIS  
DEPARTMENT OF TRANSPORTATION**

<b>DRAINAGE AND UTILITY PLAN</b>		
<b>IL ROUTE 159</b>		
SCALE: 1" = 20'	SHEET NO. 8 OF 73 SHEETS	STA. 174+50.00 TO STA. 179+50.00

F.A.P. RTE.	SECTION	COUNTY	TOTAL SHEETS	SHEET NO.
600	60-(30,31,128)-3	MADISON	529	161
<b>CONTRACT NO. 76B85</b>				
ILLINOIS FED. AID PROJECT				