

EAST PARK AVE PROPOSED STORM SEWER PROFILE

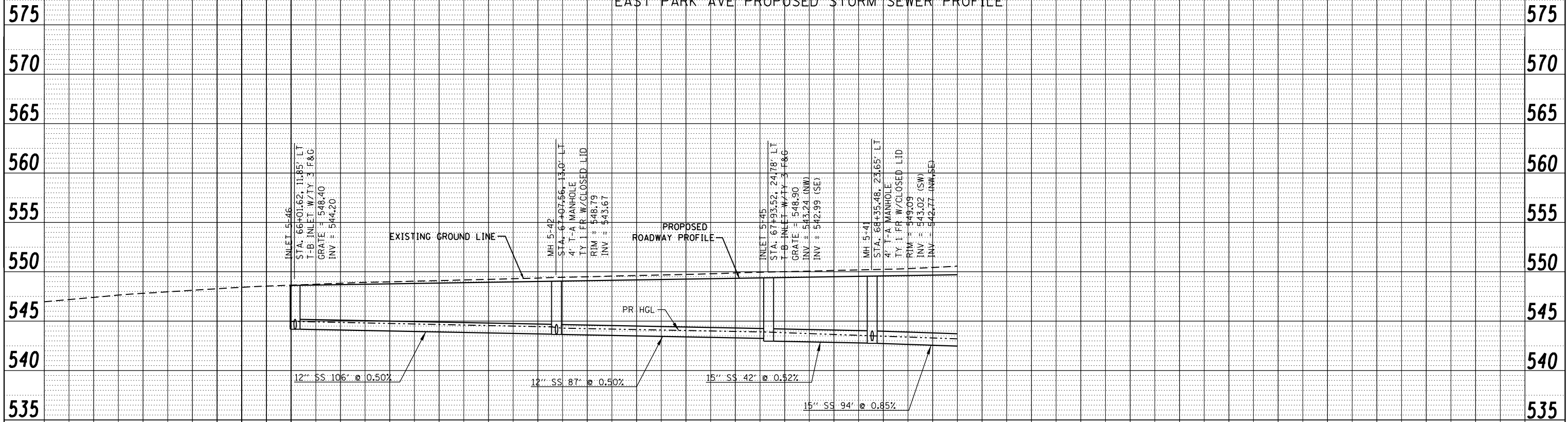

PLAN	SURVEYED	BY	DATE
	PLOTTED		
	GRADES CHECKED		
	STRUCTURE NOTED		
	NOTE BOOK NO.		
	CADD FILE NAME		

PROFILE	SURVEYED	BY	DATE
	PLOTTED		
	GRADES CHECKED		
	STRUCTURE NOTED		
	NOTE BOOK NO.		
	CADD FILE NAME		

546.96	547.97	548.65	548.82	549.05	549.02	549.68	549.22	550.01	549.42	550.32	549.62	550.97	549.82	551.31	550.08	550.84	550.77
65+00	65+50	66+00	66+50	67+00	67+50	68+00	68+50	69+00	69+50	70+00							

FILE NAME =	P:\Projects\513501\CADD\DCN\0876885-shd-drain.dgn	DESIGNED - DRH	REVISED -
USER NAME = default		DRAWN - DRH	REVISED -
PLOT SCALE = 40.0000' / in.		CHECKED - VAM	REVISED -
PLOT DATE = 2/1/2013		DATE - 01/25/2013	REVISED -

STATE OF ILLINOIS  
DEPARTMENT OF TRANSPORTATION

DRAINAGE AND UTILITY PROFILE  
E PARK AVE  
SCALE: N/A SHEET NO. 72 OF 73 SHEETS STA. 65+00.00 TO STA. 68+70.00

F.A.P. RTE.	SECTION	COUNTY	TOTAL SHEETS	SHEET NO.
600	60-(30,31,128)-3	MADISON	529	225
CONTRACT NO. 76885				
ILLINOIS FED. AID PROJECT				