

**NOTES:**

1. FOR ISLAND MARKINGS SEE DETAIL ON SHEET 289.
2. A FILE SHOWING ALL EXISTING SIGNS AND INSTRUCTIONS FOR TREATMENT WILL BE PROVIDED TO THE RESIDENT ENGINEER. SIGNS BEING REMOVED AND RELOCATED SHALL NOT BE PAID FOR SEPARATELY BUT IN ACCORDANCE WITH SECTION 107.25 OF "THE STANDARD SPECIFICATIONS FOR ROAD AND BRIDGE CONSTRUCTION."
3. ALL SIGNS FROM BEGINNING OF PROJECT TO STA. 177+57 SHALL BE MOUNTED ON DECORATIVE SIGN POSTS AS SHOWN IN DETAIL ON SHEET 369. ALL OTHER SIGNS SHALL BE MOUNTED ON TELESCOPING STEEL SIGN SUPPORTS UNLESS OTHERWISE NOTED.
4. STREET SIGNS SHALL BE GREEN AND WHITE AND AS SHOWN IN DETAIL ON SHEET 369.

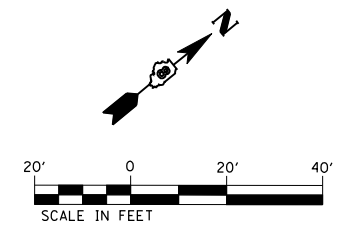
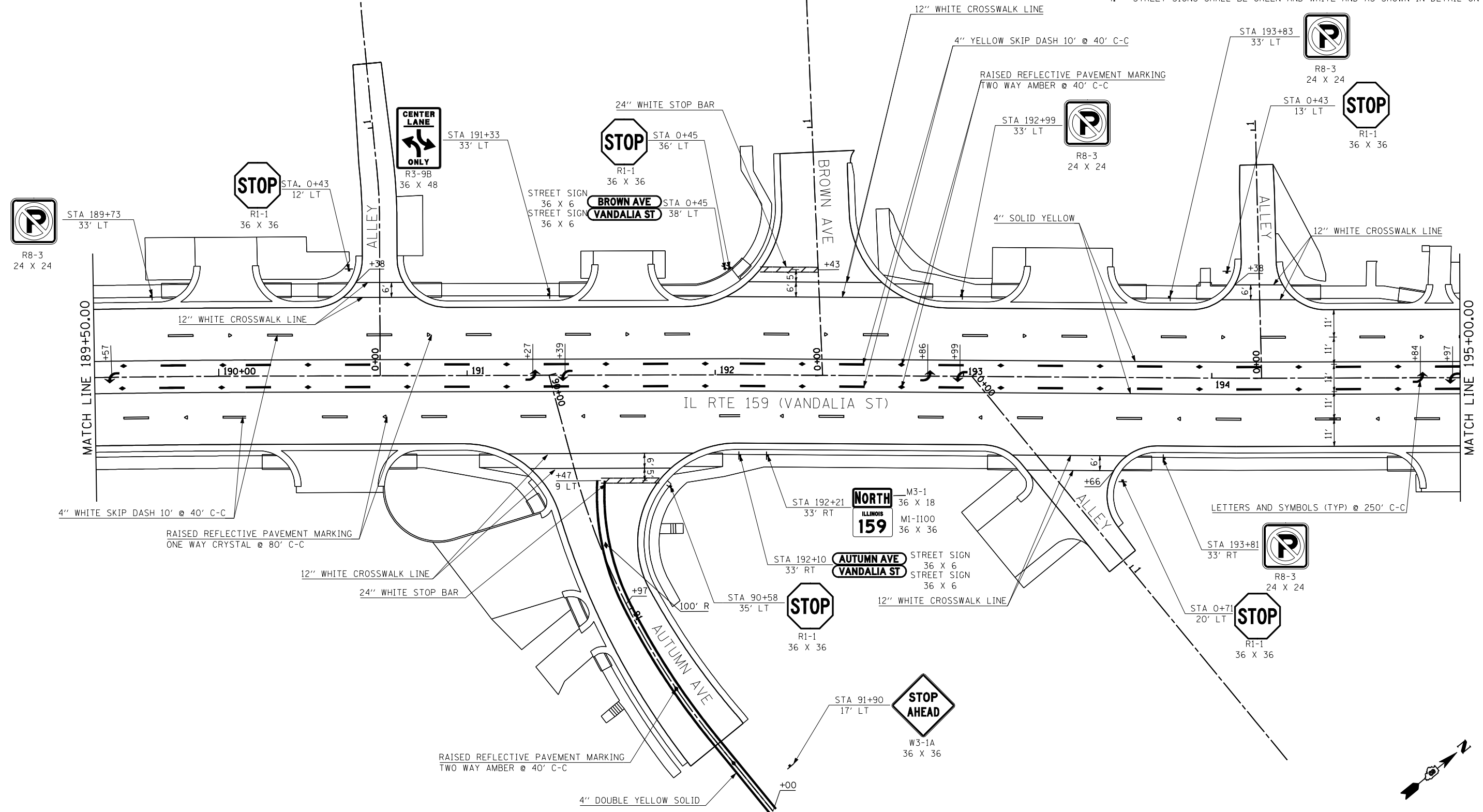

FILE NAME = P:\08-0024 Volkert-IL Rte 159 PTB 136-02	USER NAME = default	DESIGNED -	REVISED -
\\10.CAD\CADD Sheets\D876885-sht\pmk-sign.dwg		DRAWN -	REVISED -
PLOT SCALE = 40.0000' / IN.		CHECKED -	REVISED -
PLOT DATE = 3/5/2013		DATE -01/25/2013	REVISED -

**STATE OF ILLINOIS  
DEPARTMENT OF TRANSPORTATION**

**PAVEMENT MARKING AND SIGNING PLAN**

SCALE: 1" = 20"    SHEET NO. 7 OF 18 SHEETS    STA. 189+50 TO STA. 195+00

F.A.P. RTE. 600	SECTION 60-(30.31.128)-3	COUNTY MADISON	TOTAL SHEETS 529	SHEET NO. 278
CONTRACT NO. 76885				ILLINOIS FED. AID PROJECT