

NOTES:

- FOR ISLAND MARKINGS SEE DETAIL ON SHEET 289.
- A FILE SHOWING ALL EXISTING SIGNS AND INSTRUCTIONS FOR TREATMENT WILL BE PROVIDED TO THE RESIDENT ENGINEER. SIGNS BEING REMOVED AND RELOCATED SHALL NOT BE PAID FOR SEPARATELY BUT IN ACCORDANCE WITH SECTION 107.25 OF "THE STANDARD SPECIFICATIONS FOR ROAD AND BRIDGE CONSTRUCTION."
- ALL SIGNS FROM BEGINNING OF PROJECT TO STA. 177+57 SHALL BE MOUNTED ON DECORATIVE SIGN POSTS AS SHOWN IN DETAIL ON SHEET 369. ALL OTHER SIGNS SHALL BE MOUNTED ON TELESCOPING STEEL SIGN SUPPORTS UNLESS OTHERWISE NOTED.
- STREET SIGNS SHALL BE GREEN AND WHITE AND AS SHOWN IN DETAIL ON SHEET 369.

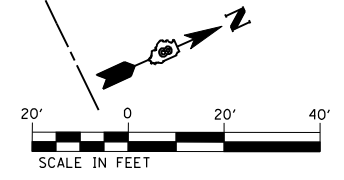
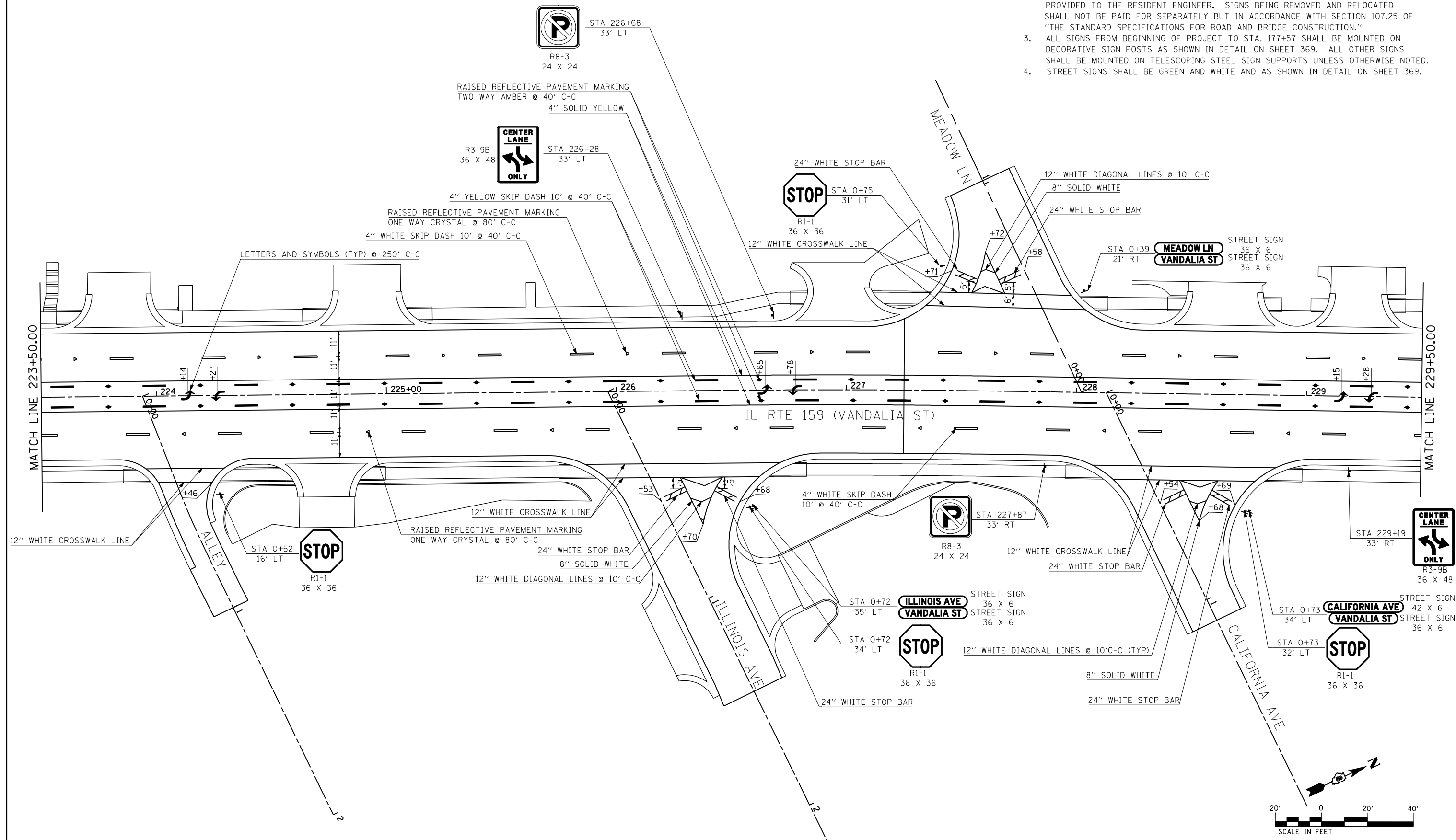

FILE NAME =	USER NAME = default	DESIGNED -	REVISED -
P:\08-0024 Volkert-IL Rte 159 PTB 136-02	X:\0_CAD\CADD Sheets\D876885-sht\pmk-sign.dwg	DRAWN -	REVISED -
	PLOT SCALE = 40.0000 ' / IN.	CHECKED -	REVISED -
	PLOT DATE = 3/5/2013	DATE -01/25/2013	REVISED -

**STATE OF ILLINOIS
DEPARTMENT OF TRANSPORTATION**

PAVEMENT MARKING AND SIGNING PLAN

SCALE: 1" = 20' SHEET NO. 13 OF 18 SHEETS STA. 223+50 TO STA. 229+50

F.A.P. RTE.	SECTION	COUNTY	TOTAL SHEETS	SHEET NO.
600	60-(30,31,128)-3	MADISON	529	284
CONTRACT NO. 76885			ILLINOIS FED. AID PROJECT	