

CONTROL POINTS CROSS TIES

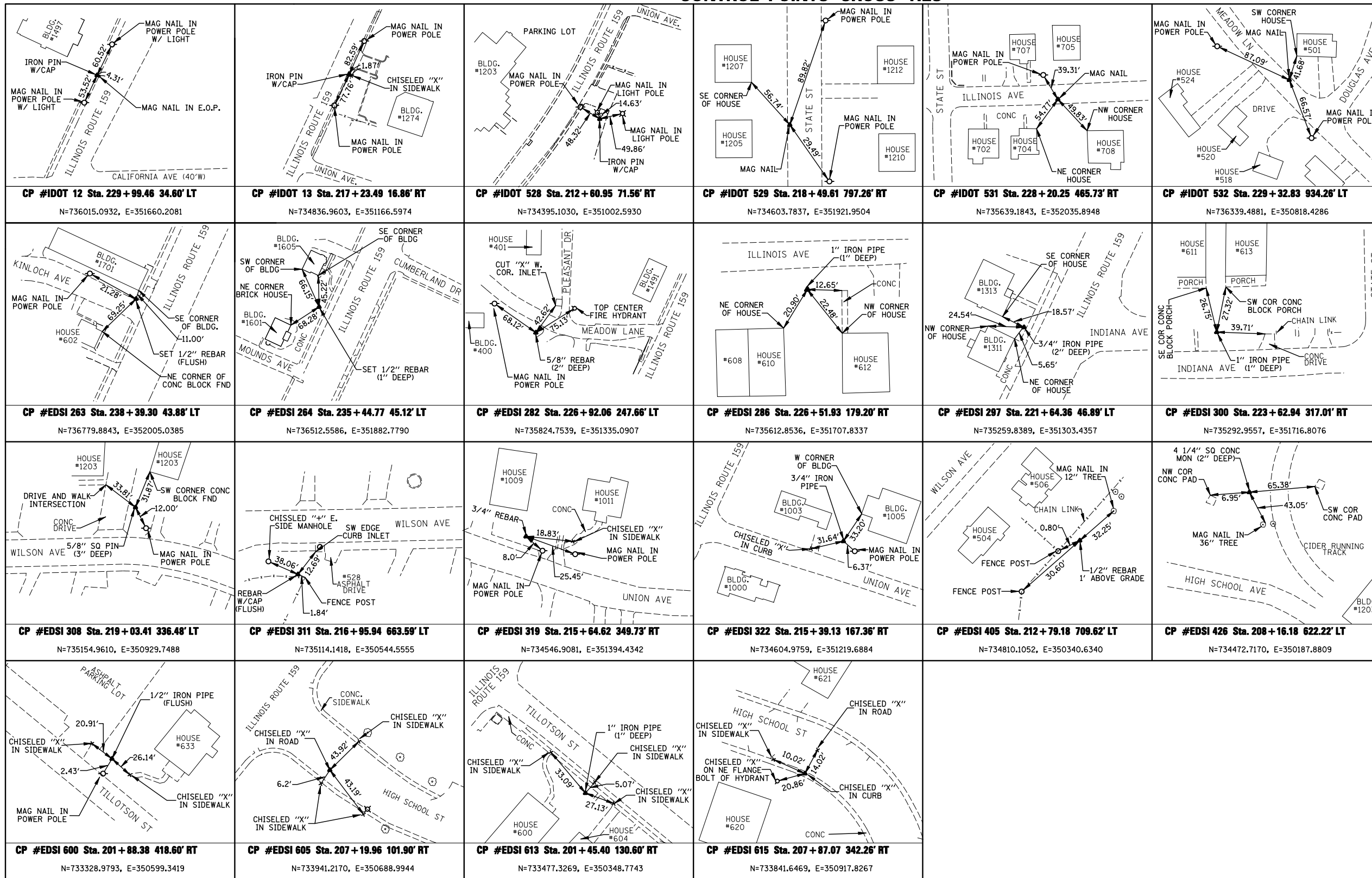

STATE OF ILLINOIS)
 COUNTY OF) SS

I, EDDIE B. MURRAY, AN ILLINOIS PROFESSIONAL LAND SURVEYOR, STATE THAT I HAVE SURVEYED THE PLAT OF HIGHWAY SHOWN HEREON AND THAT THIS PROFESSIONAL SERVICE CONFORMS TO THE CURRENT ILLINOIS MINIMUM STANDARDS FOR A BOUNDARY SURVEY FOR THE PROPOSED PARCEL(S) TO BE ACQUIRED BY THE STATE OF ILLINOIS, DEPARTMENT OF TRANSPORTATION, SHOWN HEREON.

DATED _____

EDDIE B. MURRAY, PLS NO. 35-003120
 LICENSE EXPIRATION DATE: 11/30/2010

SPACE RESERVED FOR RECORDING OFFICER

INSERT SURVEYORS SEAL HERE

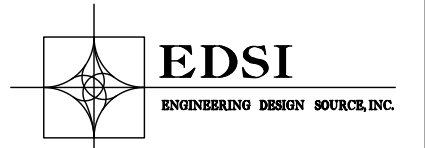

**16141 SWINGLEY RIDGE RD, SUITE 300,
 CHESTERFIELD, MO 63017
 PHONE (636) 537-5585
 REG. No 184002570**

COMPLETION DATE OF FIELD WORK PERFORMED			
LAND SURVEY:	ROW STAKING:		
ILLINOIS DEPARTMENT OF TRANSPORTATION PLAT OF HIGHWAYS FAP ROUTE 600 (IL 159) SECTION 60-(30,31,128)-3 MADISON COUNTY JOB NO. R-98-011-04 CONTROL POINTS CROSS TIES			
NOT TO SCALE		SHEET 21 OF 21	
ILLINOIS DEPARTMENT OF TRANSPORTATION DIVISION OF HIGHWAYS/REGION 5/DISTRICT 8 1102 EASTPORT PLAZA DRIVE COLLINSVILLE, ILLINOIS 62234-6198			
F.A.P. RTE.	SECTION	COUNTY	TOTAL SHEETS SHEET NO.
600	60-(30,31,128)-3	MADISON	529 348
CONTRACT NO.			
FED. ROAD DIST. NO. - ILLINOIS FED. AID PROJECT			