

DATE	
BY	
SURVEYED	
PLOTTED	
TEMPLATE	
AREAS	
CHECKED	
FINAL SURVEY	
NOTE BOOK	
NO.	

DATE	
BY	
SURVEYED	
PLOTTED	
TEMPLATE	
AREAS	
CHECKED	
ORIGINAL SURVEY	
NOTE BOOK	
NO.	

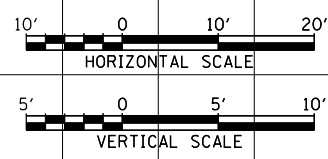
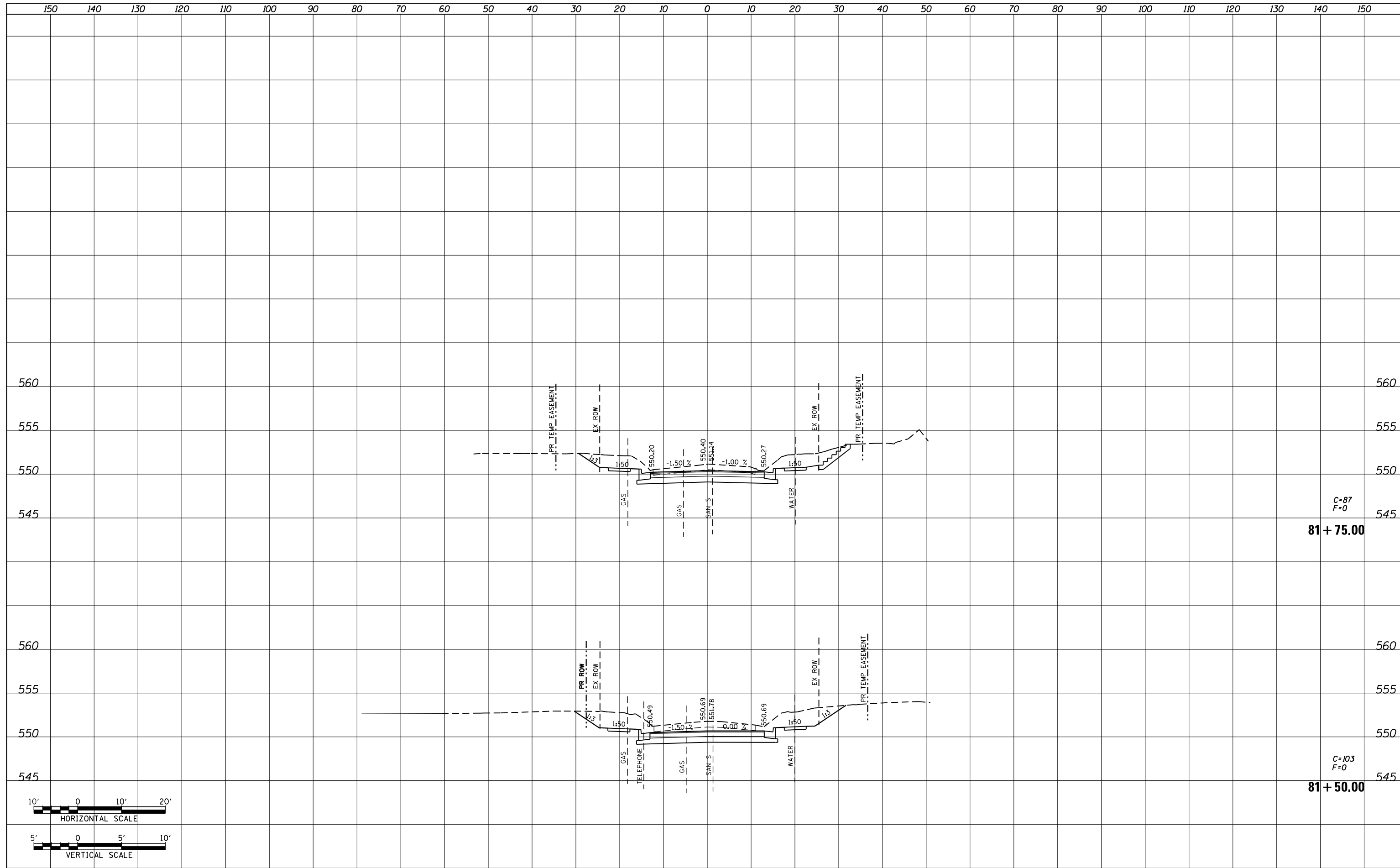

FILE NAME = P:\Projects\513501\CADD\GN\0876885-sht-xsc-spring.dgn	USER NAME = default	DESIGNED - AGF	REVISIED -	STATE OF ILLINOIS DEPARTMENT OF TRANSPORTATION	SPRING ST SIDE ROAD CROSS SECTIONS			F.A.P. RTE. 600	SECTION 60-(30,31,128)-3	COUNTY MADISON	TOTAL SHEETS 529	SHEET NO. 465
PLOT SCALE = 20.0000' / in.	CHECKED - CLS	REVISIED -	REVISIED -		SCALE: H ₁ 1"=10' V ₁ 1"=5'	SHEET NO. 3 OF 4 SHEETS	STA. 81+50.00	TO STA. 81+75.00	CONTRACT NO. 76B85			
PLOT DATE = 1/25/2013	DATE - 01/25/2013	REVISIED -	REVISIED -		ILLINOIS FED. AID PROJECT							