

FINAL SURVEY NO.	SURVEYED PLOTTED TEMPLATE AREAS CHECKED	BY	DATE

ORIGINAL SURVEY NO.	SURVEYED PLOTTED TEMPLATE AREAS CHECKED	BY	DATE

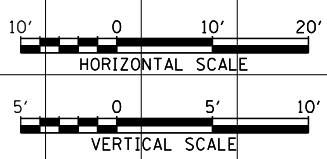
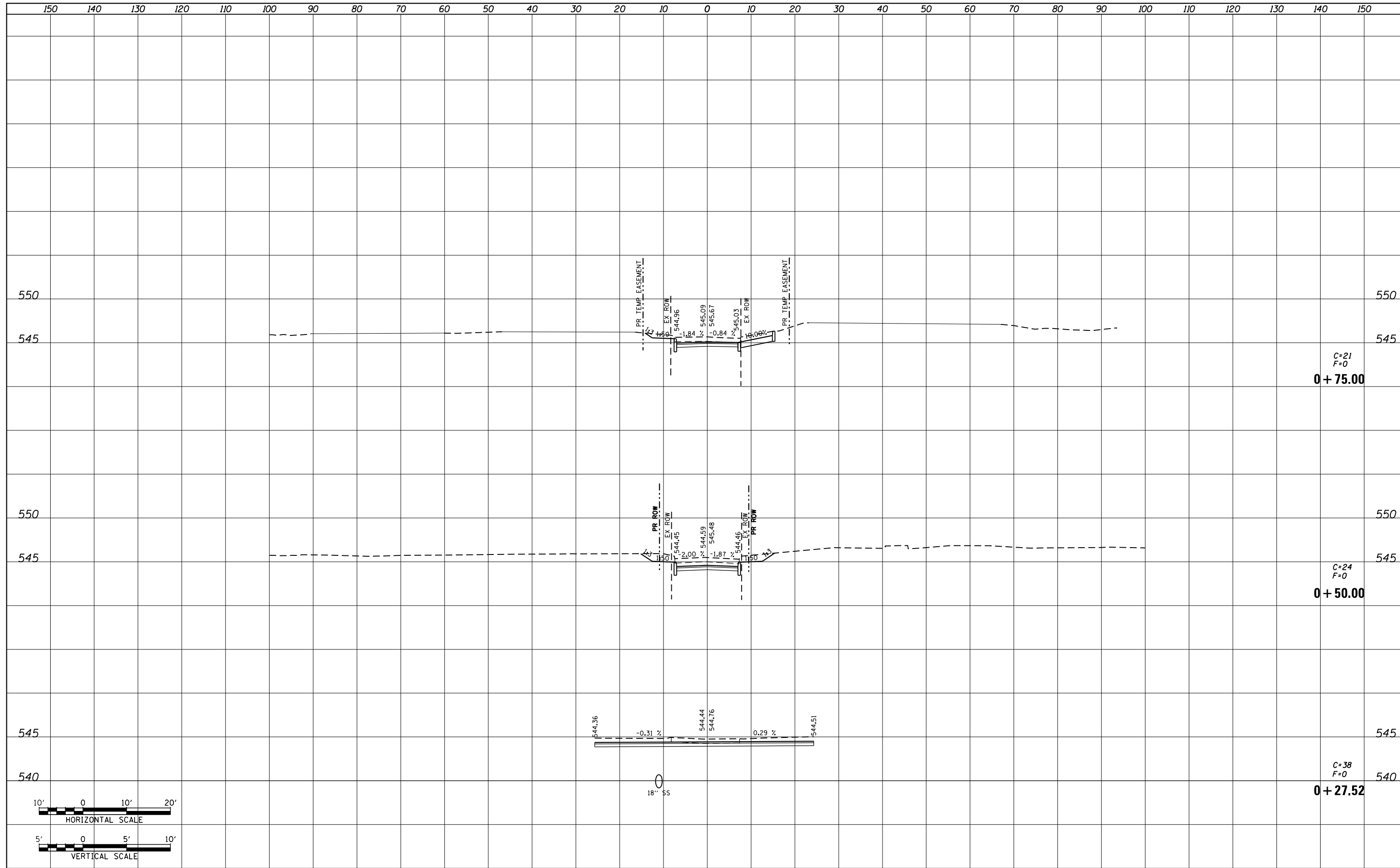

FILE NAME = P:\Projects\513501\CADD\GN\0876885-sht-xsc-all	USER NAME = default	DESIGNED - AGF	REVISIED -	STATE OF ILLINOIS DEPARTMENT OF TRANSPORTATION	ALLEY AT 201 + 69 SIDE ROAD CROSS SECTIONS			F.A.P. RTE. 600	SECTION 60-(30,31,128)-3	COUNTY MADISON	TOTAL SHEETS 529	SHEET NO. 487
	PLOT SCALE = 20.0000' / in.	CHECKED - CLS	REVISIED -		SCALE: H: 1"=10' V: 1"=5'	SHEET NO. 1 OF 2 SHEETS	STA. 0+27.52	TO STA. 0+75.00	CONTRACT NO. 76885			
	PLOT DATE = 1/25/2013	DATE - 01/25/2013	REVISIED -		ILLINOIS FED. AID PROJECT							