

STATE OF ILLINOIS
DEPARTMENT OF TRANSPORTATION

Note:
For cross section thru panels, drilled pile and joint detail see sht. 5 of 8.
For Soldier pile data & Bill of Material see sht. 6 of 8.

* order $v_3(E)$ $v_4(E)$ & $v_5(E)$ bars full length cut to fit as per Bar Cutting Diagram shown on sht. 6 of 8. Use remainder of bars on the opposite face of the wall.

Min. bar laps
(unless noted otherwise)
5 bar = 1'-8"

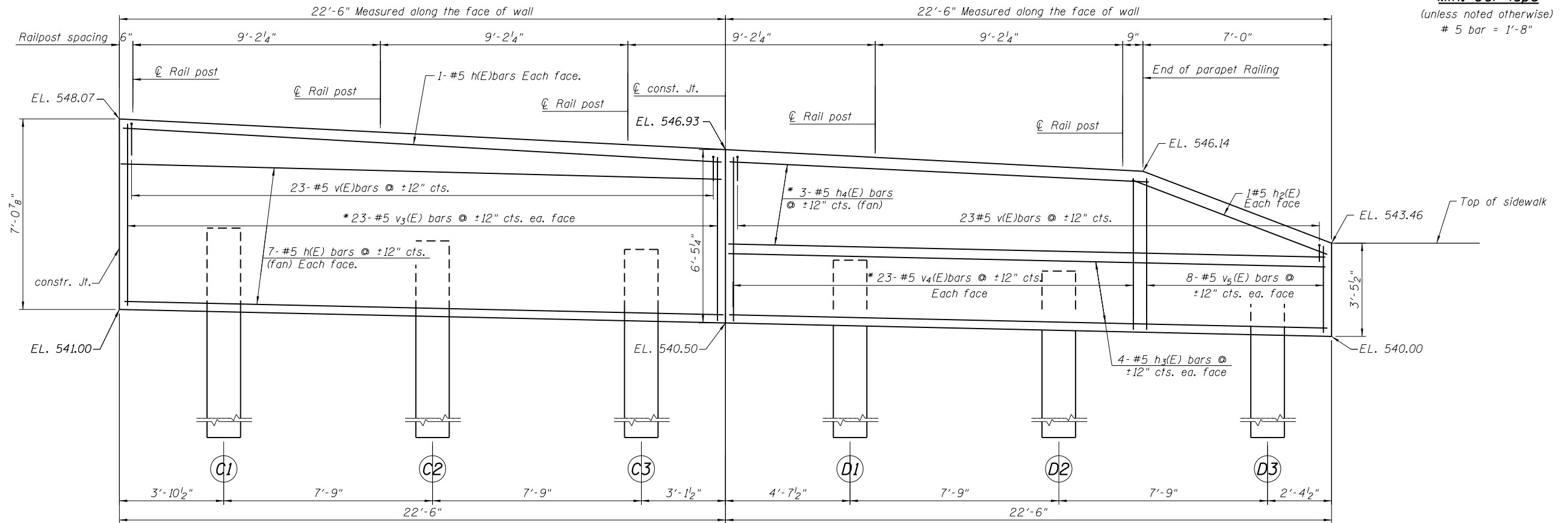

**ELEVATION
PANEL C**

**ELEVATION
PANEL D**

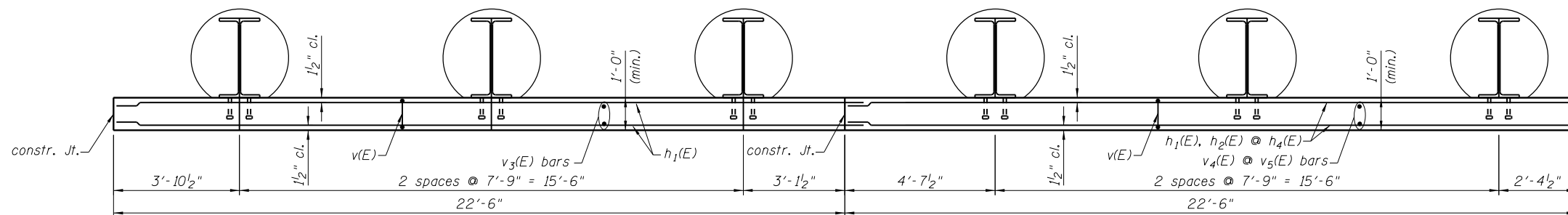

**PLAN
PANEL C**

**PLAN
PANEL D**

DESIGNED - KRG
CHECKED - MJK
DRAWN - GSJ
CHECKED - MJK

PANELS C & D

SHEET NO. 4 8 SHEETS	F.A.P. RTE.	SECTION	COUNTY	TOTAL SHEETS	SHEET NO.
	600	60-(30,31,128)-3	Madison	529	514
	RETAINING WALL 4		CONTRACT NO. 76B85		
FED. ROAD DIST. NO.		ILLINOIS FED. AID PROJECT			

MID-AMERICA ENGINEERING SERVICES