

-CABLE INSTALLATION MIN. DEPTH EXCEPT FOR UNDER PAVEMENT BOTTOM AND DITCH FLOW LINE=48"

-CABLE INSTALLATION MIN. DEPTH UNDER PAVEMENT BOTTOM AND DITCH FLOW LINE=60"

UNDRGRD C CNC 1 1/2  
8' MAX FROM FENCE  
W/FIBER OPTIC & TRACER  
CABLES IN CONDUIT

UNDRGRD C CNC 1 1/2  
8' MAX FROM FENCE  
W/FIBER OPTIC & TRACER  
CABLES IN CONDUIT

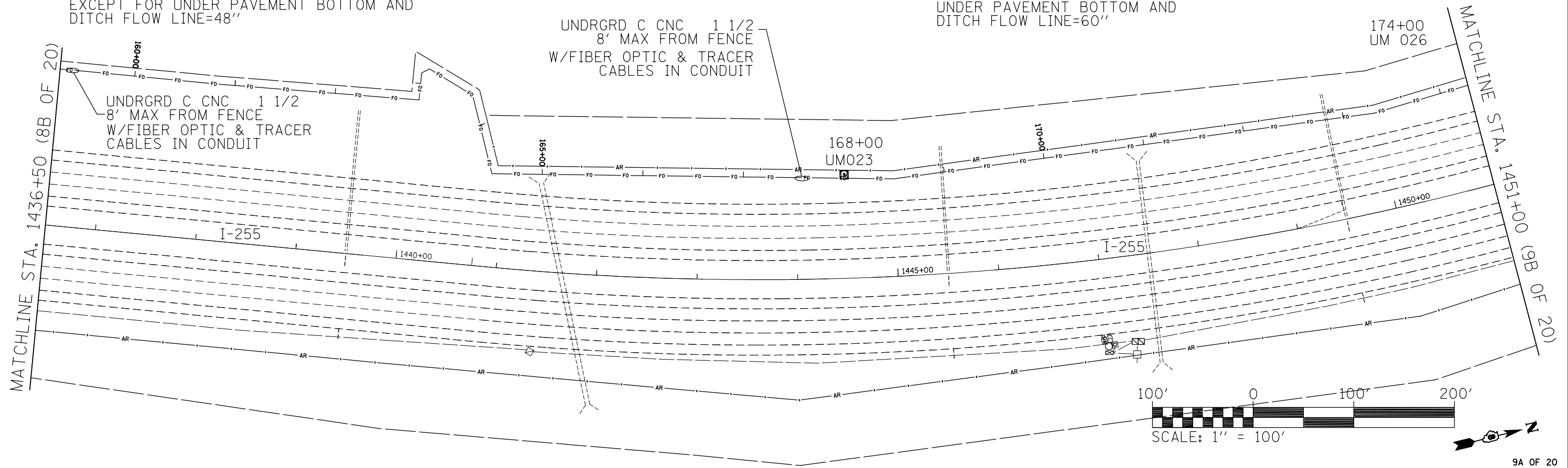

9A OF 20

-CABLE INSTALLATION MIN. DEPTH EXCEPT FOR UNDER PAVEMENT BOTTOM AND DITCH FLOW LINE=48"  
-CABLE INSTALLATION MIN. DEPTH UNDER PAVEMENT BOTTOM AND DITCH FLOW LINE=60"

UNDRGRD C CNC 1 1/2  
8' MAX FROM FENCE  
W/FIBER OPTIC & TRACER  
CABLES IN CONDUIT

UNDRGRD C CNC 1 1/2  
8' MAX FROM FENCE  
W/FIBER OPTIC & TRACER  
CABLES IN CONDUIT

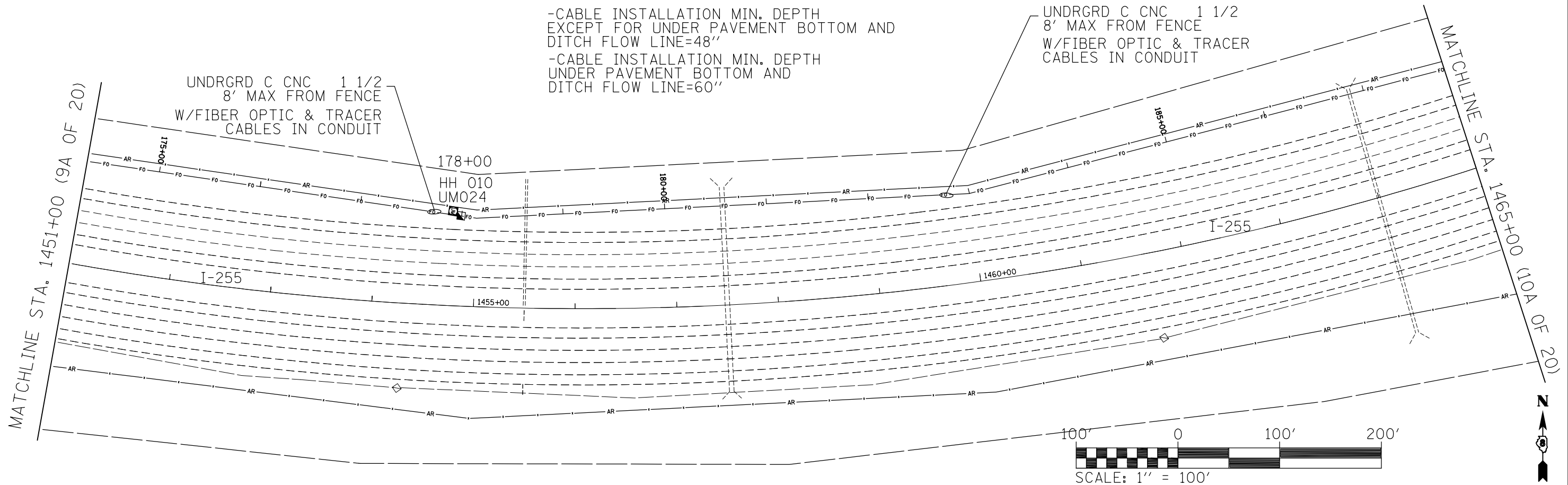

9B OF 20

FILE NAME =	USER NAME = prestonme	DESIGNED -	REVISED -
et:\pwork\pwork\prestonme\d0298000\d076f77-sht-ITS.dgn		DRAWN -	REVISED -
	PLOT SCALE = 100.0000' / 1in.	CHECKED -	REVISED -
	PLOT DATE = 3/21/2013	DATE -	REVISED -

STATE OF ILLINOIS  
DEPARTMENT OF TRANSPORTATION

I-255 STA. 1436 + 50 TO STA. 1451 + 00			
I-255 STA. 1451 + 00 TO STA. 1465 + 00			
SCALE:	SHEET NO.	OF SHEETS	STA. TO STA.

\*FAI 270/FAI 255/FAI 55/70

F.A.I. RTE.	SECTION	COUNTY	TOTAL SHEETS	SHEET NO.
*	DIST 8 ITS 2013-1	MADISON	27	15
CONTRACT NO. 76F77				
FED. ROAD DIST. NO. ILLINOIS FED. AID PROJECT				