

• 0.02 ACRES OF PROPOSED SEEDING, CLASS 2, 0.02 ACRES OF PROPOSED MULCH, METHOD 2, 1.5 LB OF PROPOSED NITROGEN FERTILIZER NUTRIENT, 1.5 LB OF PROPOSED PHOSPHORUS FERTILIZER NUTRIENT, AND 1.5 LB OF PROPOSED POTASSIUM FERTILIZER NUTRIENT ARE INCLUDED IN THE COST OF SHAPING AND GRADING DITCHES. SEEDING, CLASS 2, NITROGEN FERTILIZER NUTRIENT, PHOSPHORUS FERTILIZER NUTRIENT, AND POTASSIUM FERTILIZER NUTRIENT SHALL BE ACCORDING TO SECTION 250 OF THE STANDARD SPECIFICATIONS. MULCH, METHOD 2 SHALL BE ACCORDING TO SECTION 251 OF THE STANDARD SPECIFICATIONS.

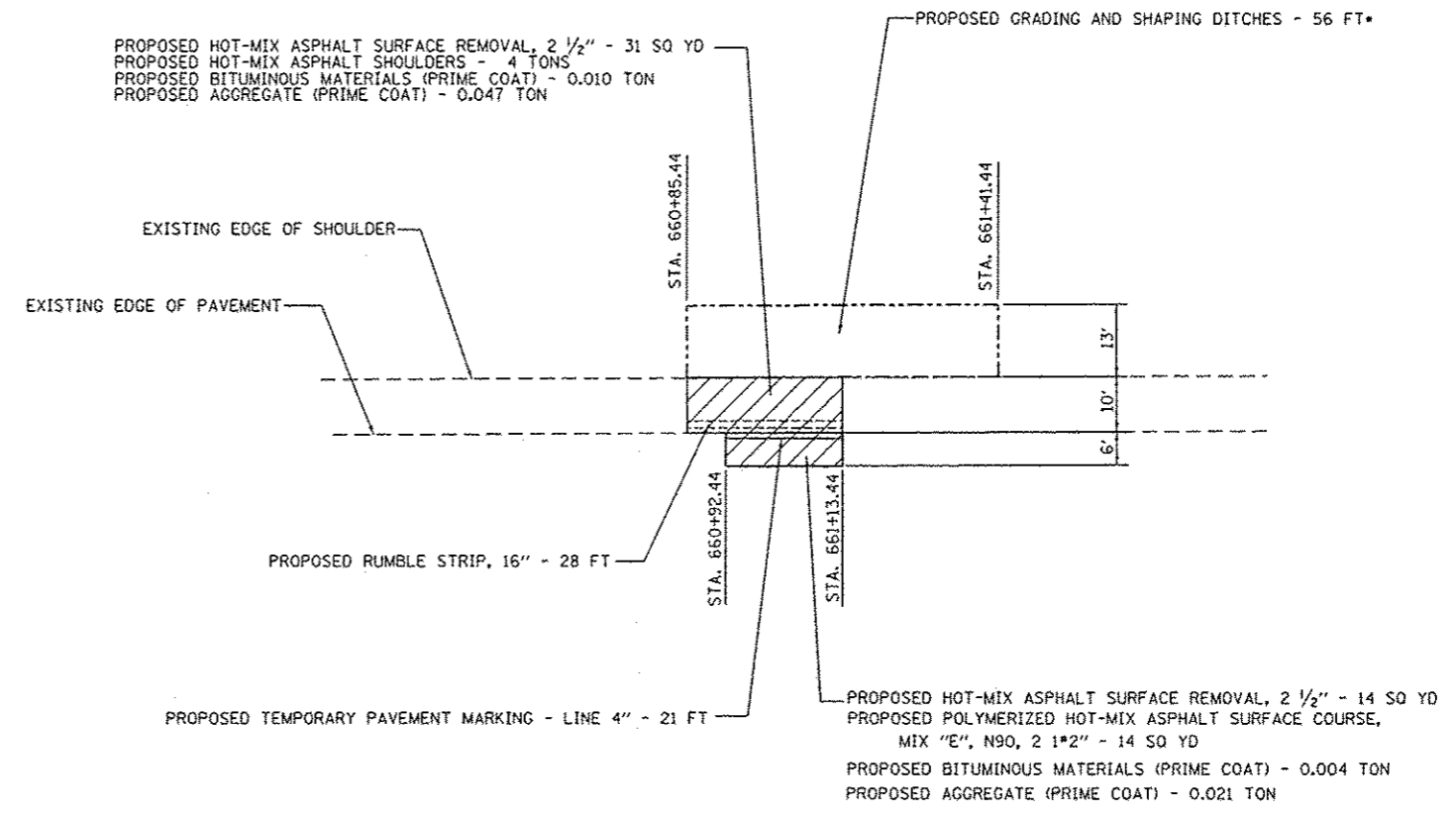

DETAIL "A"
(NOT TO SCALE)

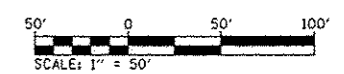
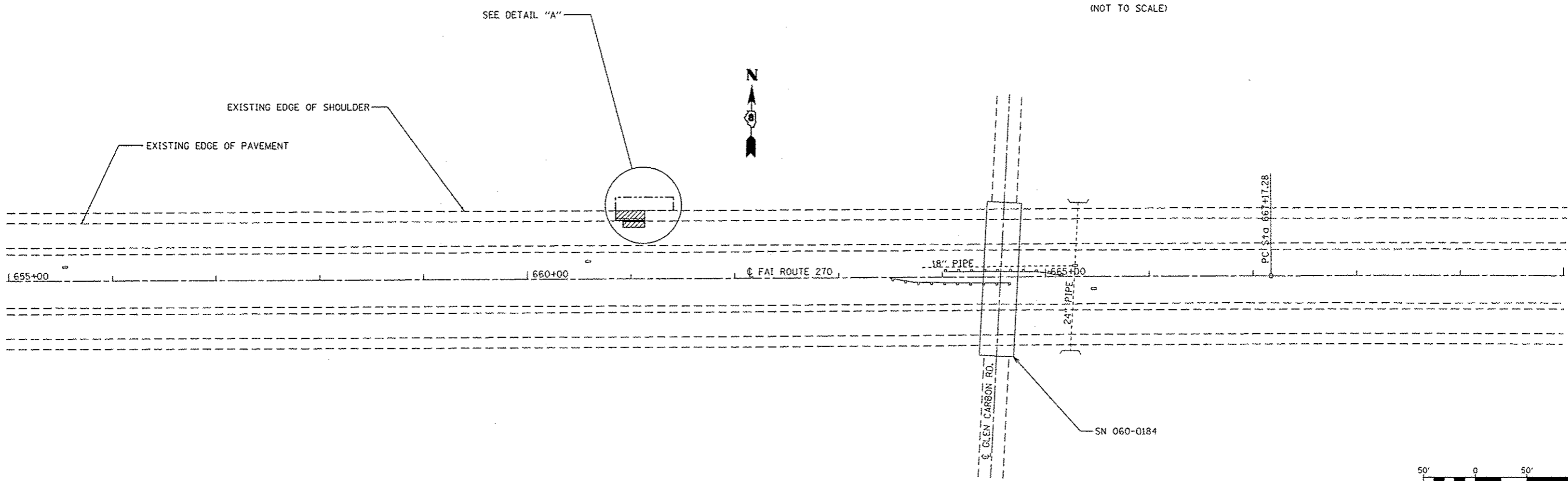

FILE NAME =	USER NAME = coppennolpe	DESIGNED -	REVISED -	STATE OF ILLINOIS DEPARTMENT OF TRANSPORTATION	PLAN	F.A.I. RTE.	SECTION	COUNTY	TOTAL SHEETS	SHEET NO.	
cr:\pw\work\p\ridot\coppennolpe\d0311321\876g03-ahs-plan.dgn	DRAWN -	REVISED -	270			60-5RS-4	MADISON	5	5		
#MODELNAME#	PLOT SCALE = 100.0000 ' / in.	CHECKED -	REVISED -			CONTRACT NO. 76G03					
	PLOT DATE = 3/29/2013	DATE -	REVISED -			ILLINOIS FED. AID PROJECT					
						SCALE: 1" = 50'	SHEET 1 OF 1 SHEETS	STA. 655+00 TO STA. 670+00			