

F.A.I. RTE.	SECTION	COUNTY	TOTAL SHEETS	SHEET NO.
55	99(1&2)	I-10	52	13
STA.		TO STA.		
FED. ROAD DIST. NO.		ILLINOIS FED. AID PROJECT		

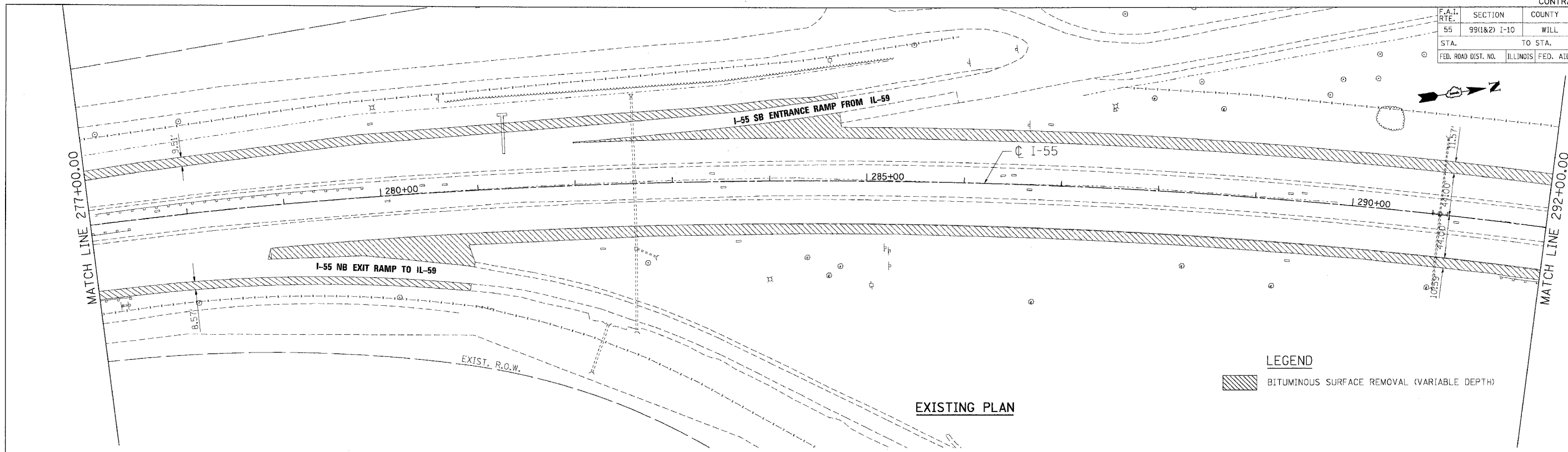

**LEGEND**  
 BITUMINOUS SURFACE REMOVAL (VARIABLE DEPTH)

**EXISTING PLAN**

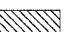
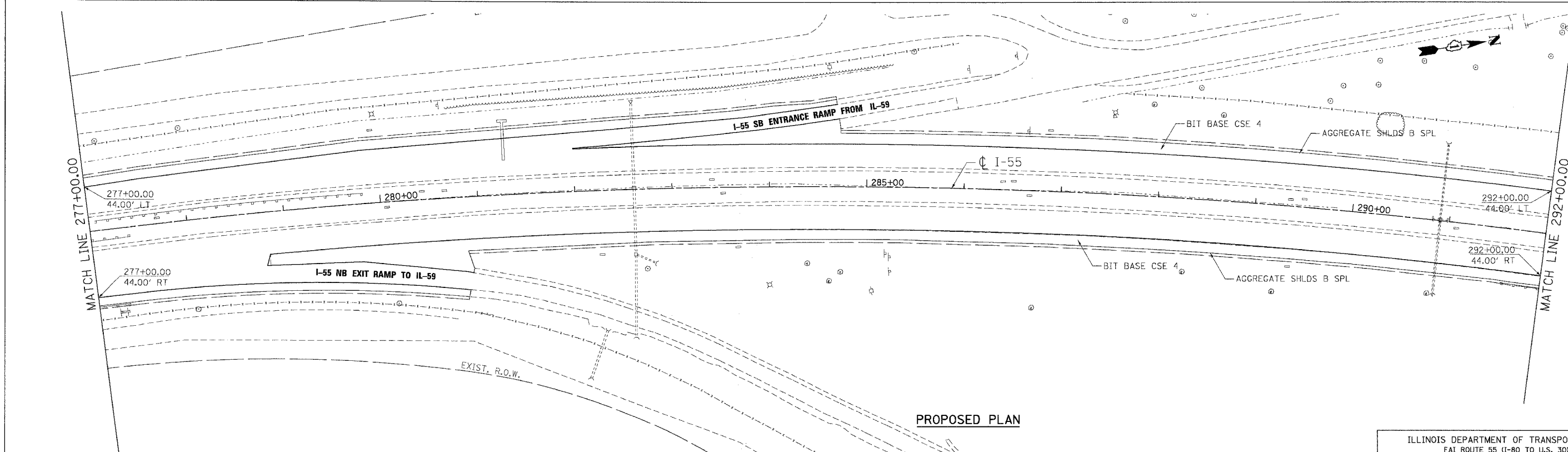

**PROPOSED PLAN**

PLOT DATE = 03/15/06  
 PLOT SCALE = 1"=50'  
 PLOT SCALE = 1"=50'  
 USER NAME = USER\*  
 \\AL051\AR01\LDN...  
 3-13-2006, 14:45:20  
 SA:\DOCUMENT\823618\ACT\1\LDN\PL051A204.SHT

REVISIONS	
NAME	DATE

ILLINOIS DEPARTMENT OF TRANSPORTATION  
 FAI ROUTE 55 (I-80 TO U.S. 30)  
 SHOULDER MILLING AND RESURFACING

**ROADWAY PLAN**  
 FAI 55  
 STA. 277+00.00 TO STA. 292+00.00

SCALE: 1"=50' DRAWN BY OP  
 DATE: 03/15/06 CHECKED BY DDH

**TENG** TENG & ASSOCIATES, INC.  
ENGINEERS/ARCHITECTS/PLANNERS  
CHICAGO, ILLINOIS