

PROFILE	SURVEYED	BY	DATE
NOTE BOOK	GRADES CHECKED		
NO.	BY		
	STRUCTURE		
	ADJUSTING		
	CHKD		

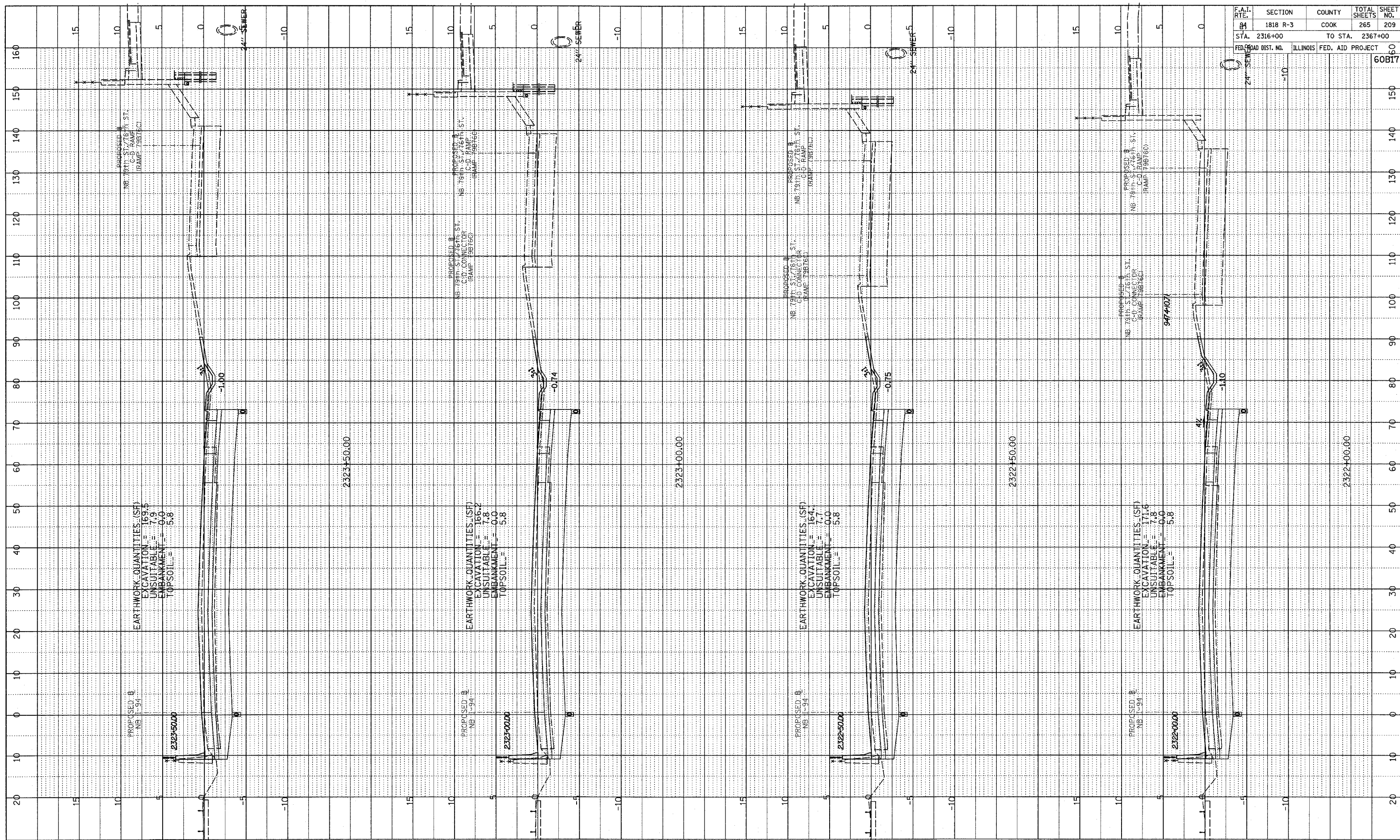

F.A.T. RTE.	SECTION	COUNTY	TOTAL SHEETS	SHEET NO.
84	1818 R-3	COOK	265	209
STA. 2316+00	TO STA. 2367+00			
FED. ROAD DIST. NO.	ILLINOIS FED. AID PROJECT		60B17	

TYLIN INTERNATIONAL

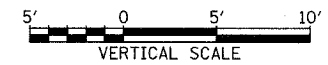
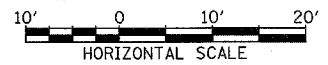

NORTHBOUND I-94 (DAN RYAN EXPWY)
STA. 2323+00 TO STA. 2324+41

03/03/2006 04:09:21 PM