

DATE	BY

PROFILE SURVEYED
 NOTE BOOK GRADES CHECKED
 B.M. NOTED
 NO. PLACED DATE NOTATIONS ERROR

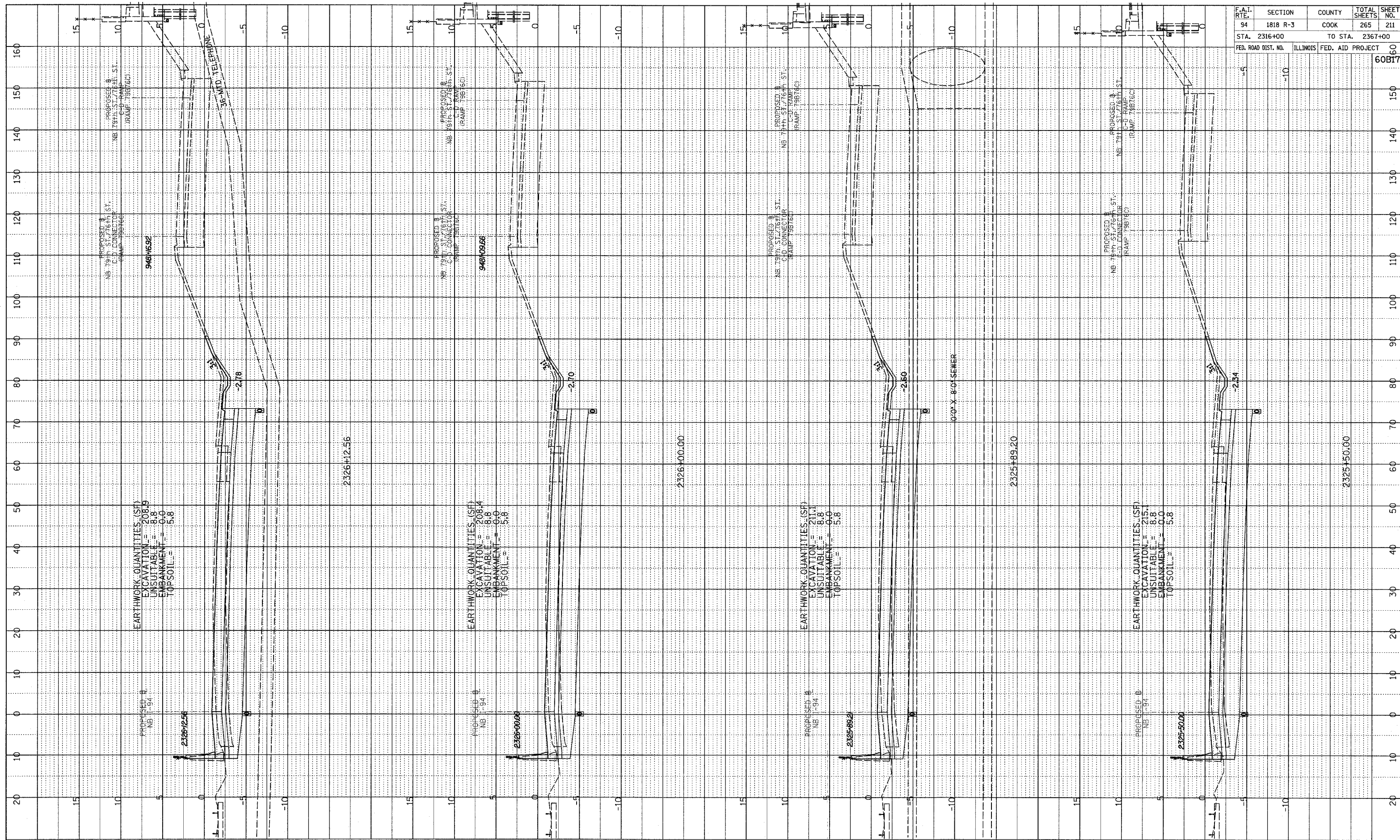

F.A.I. RTE.	SECTION	COUNTY	TOTAL SHEETS	SHEET NO.
94	1818 R-3	COOK	265	211
STA. 2316+00		TO STA. 2367+00		
FED. ROAD DIST. NO.	ILLINOIS	FED. AID PROJECT	60B17	

TYLIN INTERNATIONAL

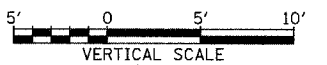
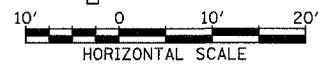

NORTHBOUND I-94 (DAN RYAN EXPWY)
 STA. 2326+00 TO STA. 2327+00

03/03/2006 04:09:22 PM