

PROFILE DRAWN BY: _____ DATE: _____
 CHECKED BY: _____
 NOTE BOOK NO.: _____
 DATE NOTED: _____
 DRAWN BY: _____
 NO. OF SHEETS: _____
 PROJECT NO.: _____
 SHEET NO.: _____

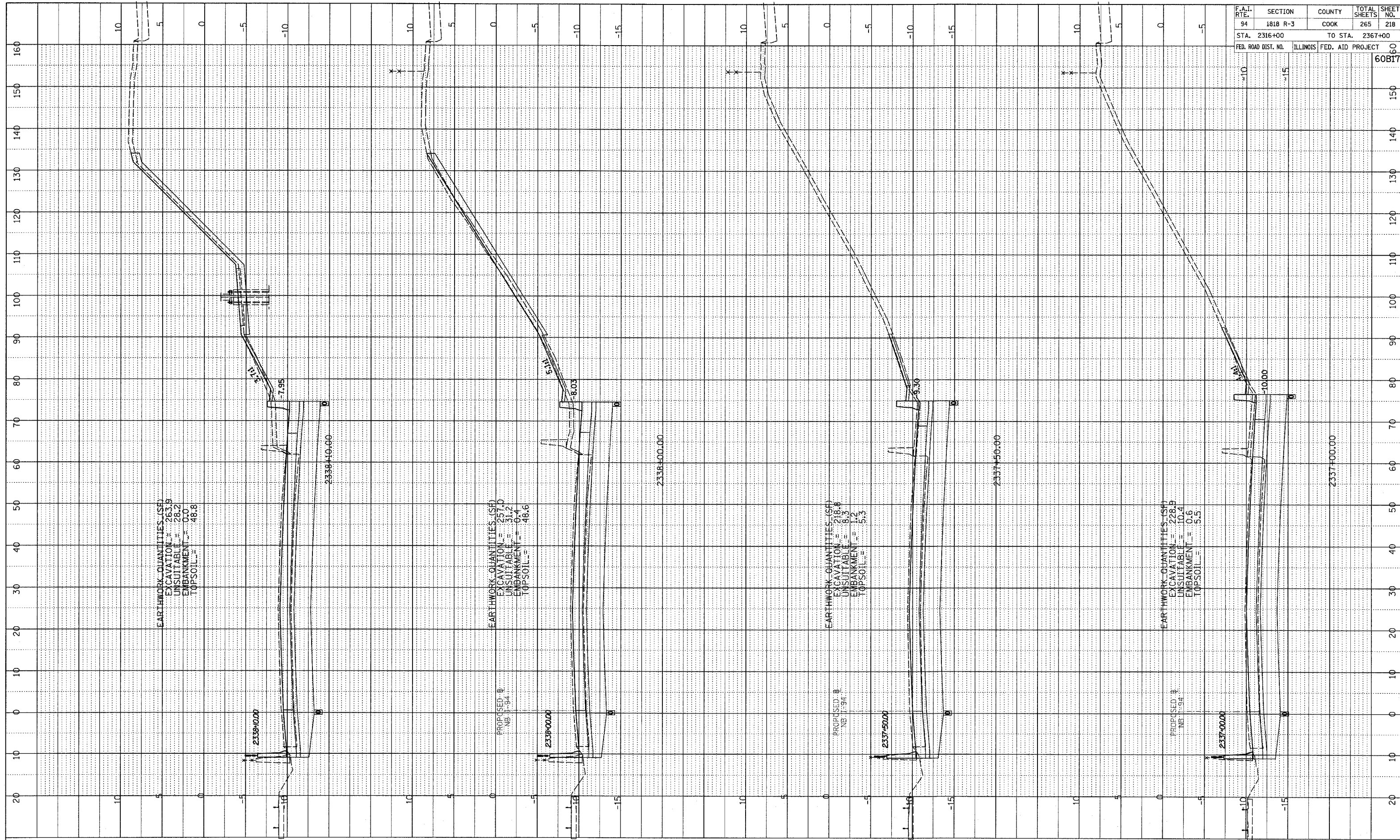

F.A.I. RTE.	SECTION	COUNTY	TOTAL SHEETS	SHEET NO.
94	1818 R-3	COOK	265	218
STA. 2316+00		TO STA. 2367+00		
FED. ROAD DIST. NO.		ILLINOIS FED. AID PROJECT		

TYLIN INTERNATIONAL

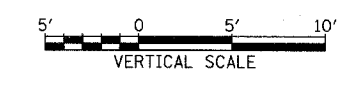
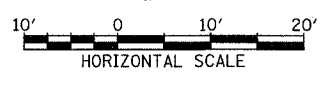

NORTHBOUND I-94 (DAN RYAN EXPWY)
 STA. 2337+50 TO STA. 2339+00

03/03/2006 04:09:25 PM