

PROFILE SURVEYED BY: _____ DATE: _____
 NOTE BOOK NO. _____
 GRADES CHECKED BY: _____
 STRUCTURE NOTATION: _____

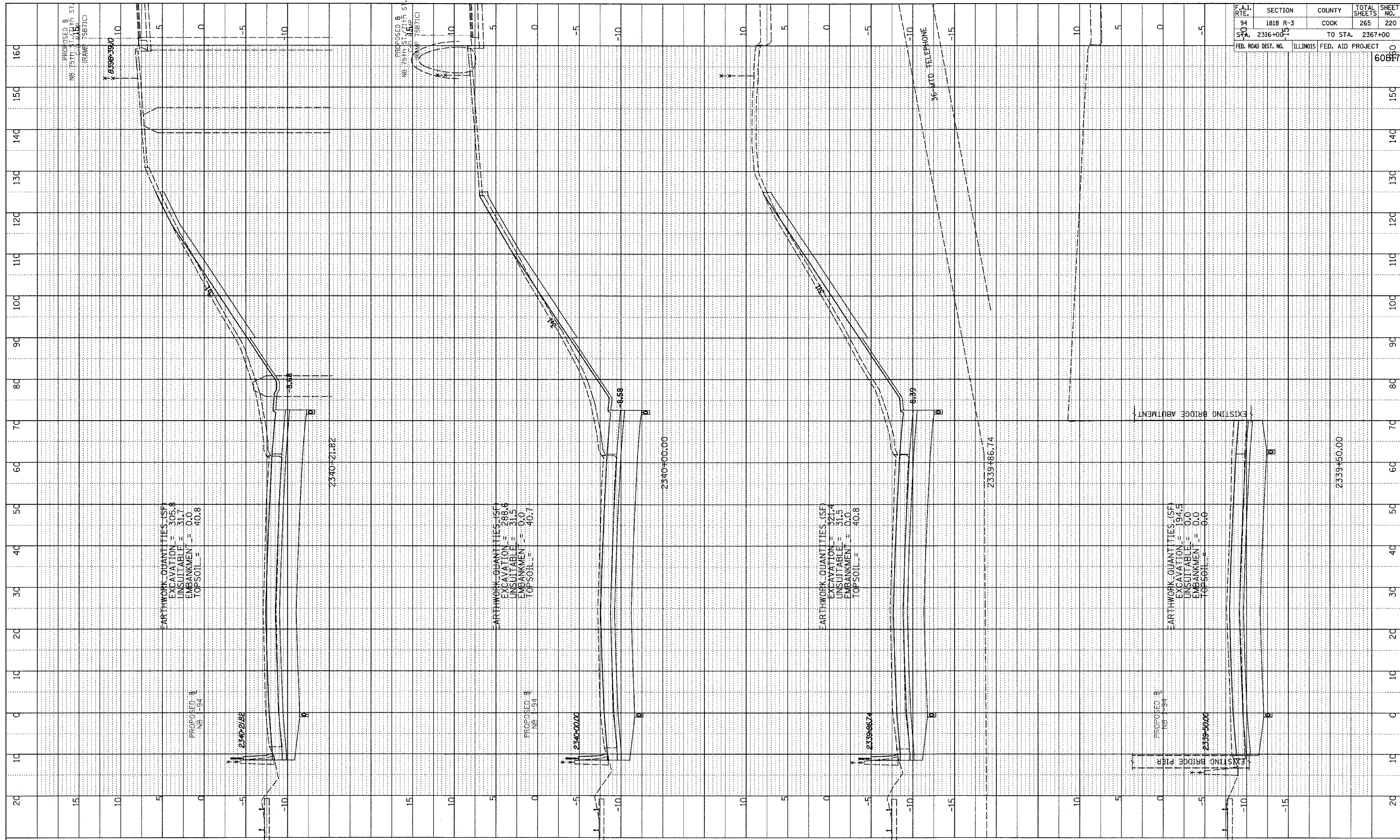

F.A.I. RTE.	SECTION	COUNTY	TOTAL SHEETS	SHEET NO.
94	1818 R-3	COOK	265	220
STA. 2316+00.00		TO STA. 2367+00		
FED. ROAD DIST. NO.		ILLINOIS FED. AID PROJECT		60B67

TYLIN INTERNATIONAL

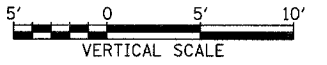
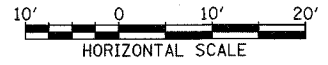

NORTHBOUND I-94 (DAN RYAN EXPWY)
 STA. 2339+50 TO STA. 2340+50

03/03/2006 03:41:15 PM