

PROFILE
 NO. _____
 DATE _____
 BY _____
 CHECKED _____
 GRADES CHECKED _____
 STRUCTURE NOTATIONS CHECKED _____

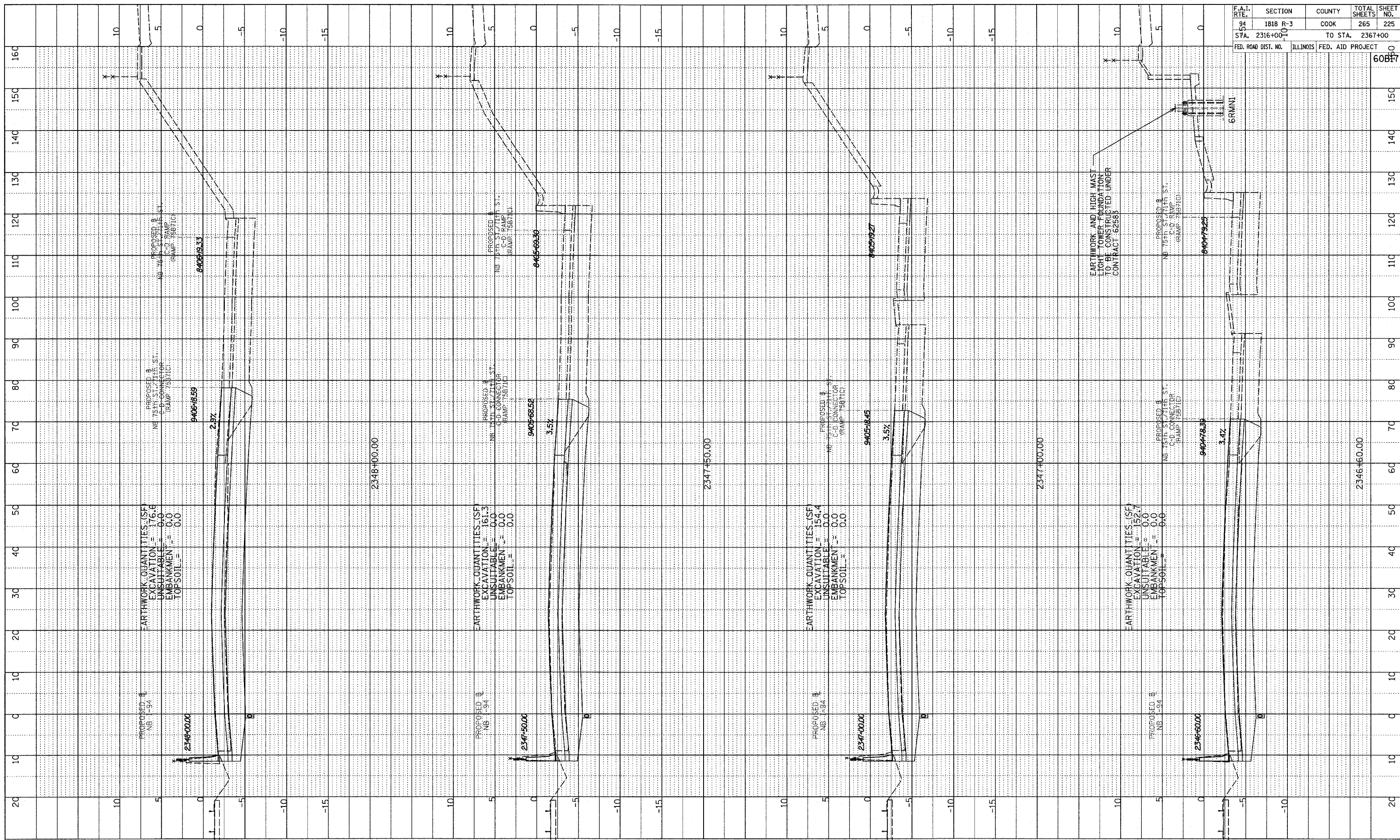

F.A.I. RTE.	SECTION	COUNTY	TOTAL SHEETS	SHEET NO.
94	1818 R-3	COOK	265	225
STA. 2316+00	TO STA. 2367+00			
FED. ROAD DIST. NO.	ILLINOIS	FED. AID PROJECT		60817

TYLIN INTERNATIONAL

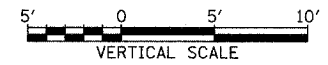
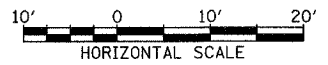

NORTHBOUND I-94 (DAN RYAN EXPWY)
 STA. 2347+00 TO STA. 2348+50

03/03/2006 03:41:17 PM