

PROFILE NUMBER: _____ DATE: _____
 BY: _____
 REVISIONS: _____
 NOTE BOOK NO.: _____ GRADES CHECKED: _____
 STRUCTURE NOTATION: _____

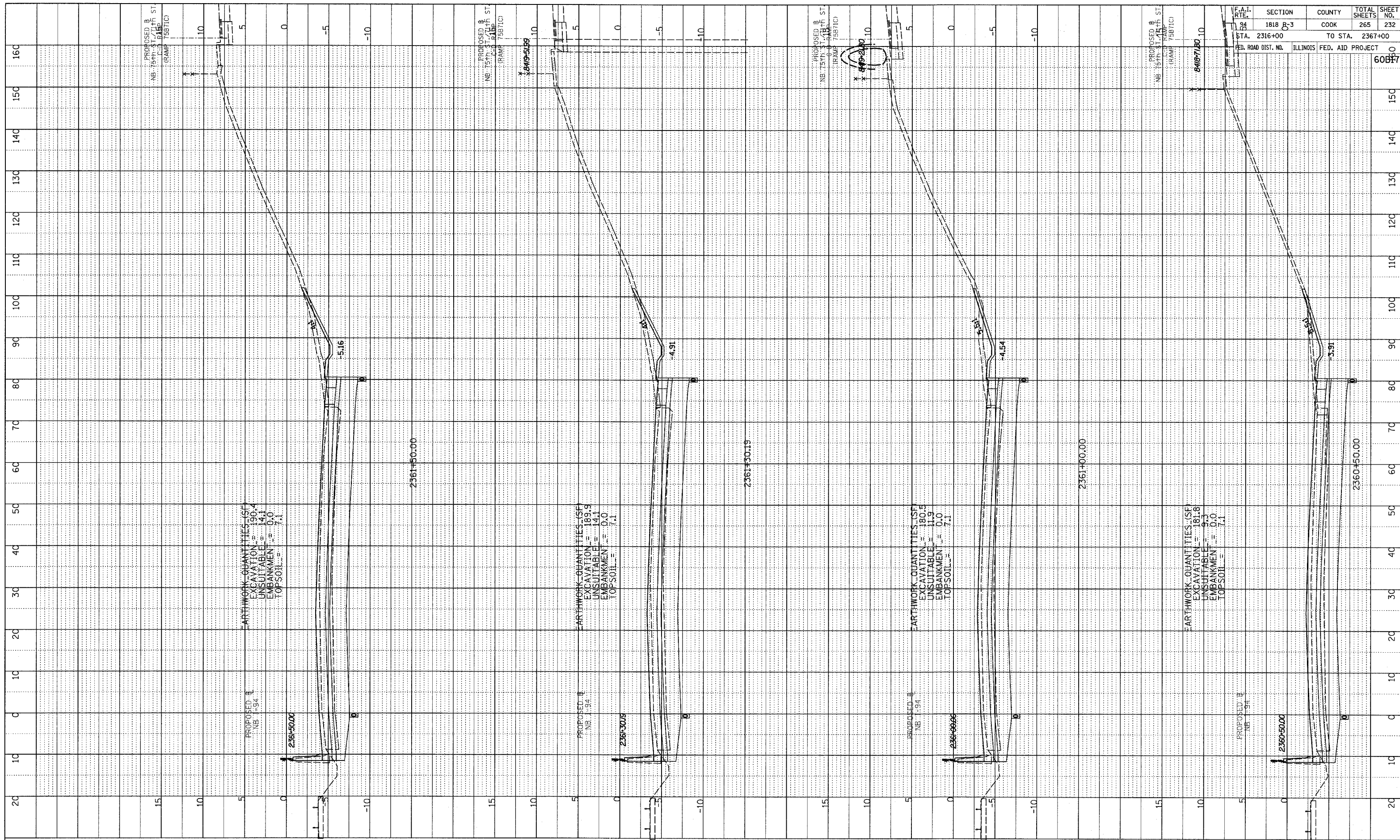

F.A.I. RTE.	SECTION	COUNTY	TOTAL SHEETS	SHEET NO.
94	1818 B-3	COOK	265	232
STA. 2316+00		TO STA. 2367+00		
FED. ROAD DIST. NO.		ILLINOIS FED. AID PROJECT		
		60817		

TYLIN INTERNATIONAL



NORTHBOUND I-94 (DAN RYAN EXPWY)
 STA. 2361+30.19 TO STA. 2362+50

03/03/2006 03:44:20 PM