

PROFILE NO.	DATE
BY	
REVISIONS	
DATE	
NOTED	
GRADES CHECKED	
STRUCTURE	
NO. 1	

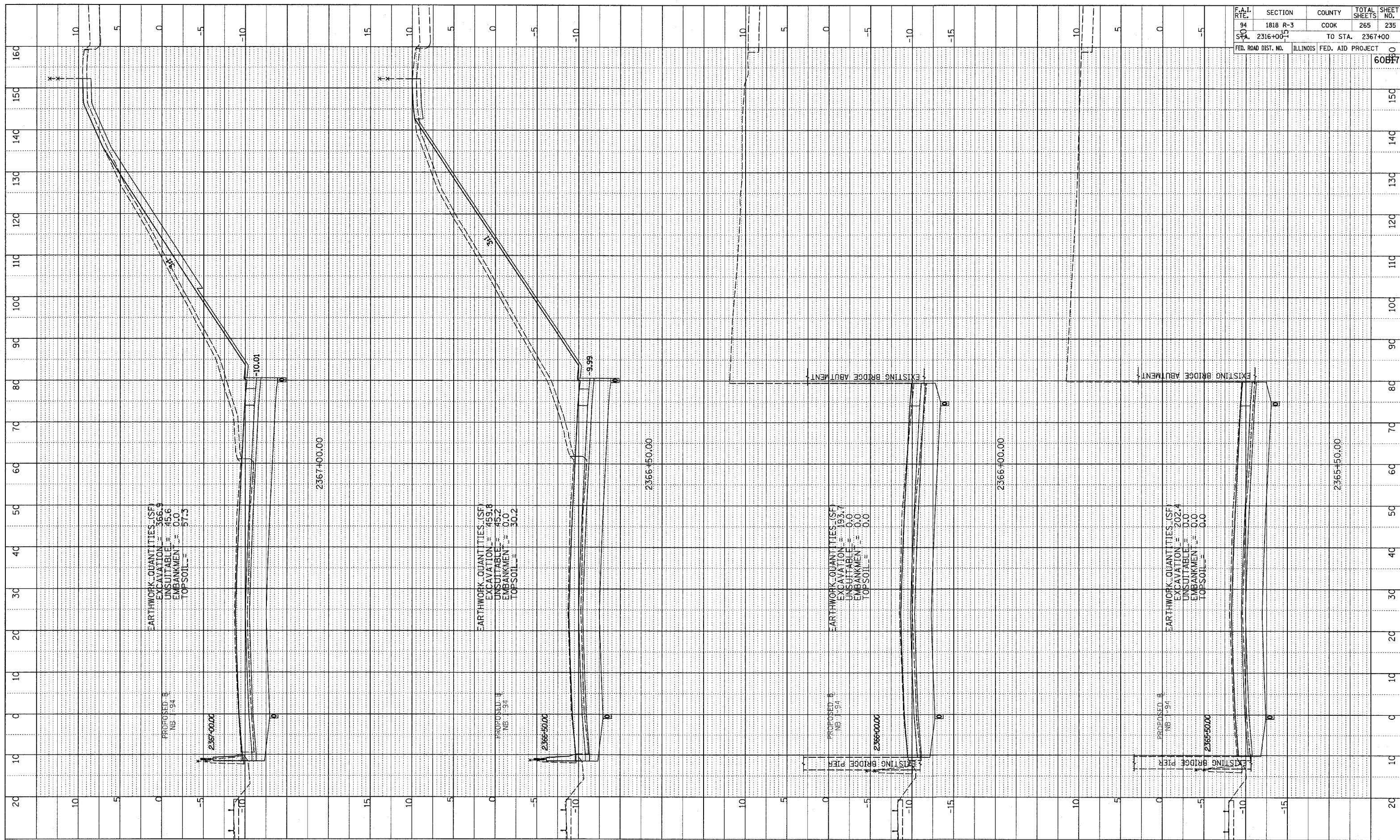

F.A.I. RTE.	SECTION	COUNTY	TOTAL SHEETS	SHEET NO.
94	1818 R-3	COOK	265	235
STA. 2316+00	TO STA. 2367+00			
FED. ROAD DIST. NO.	ILLINOIS	FED. AID PROJECT	60817	

TYLIN INTERNATIONAL

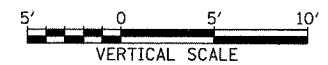

NORTHBOUND I-94 (DAN RYAN EXPWY)
 STA. 2366+50 TO STA. 2368+00

03/03/2006 03:42:22 PM