

F.A.I. RTE.	SECTION	COUNTY	TOTAL SHEETS	SHEET NO.
94		COOK	916	235
STA. 190+65 (NB I-57) TO STA. 2316+00 (NB RYAN)		FED. ROAD DIST. NO. ILLINOIS FED. AID PROJECT		
		• (1516.1, 1717, & 1818) R-4		

62304

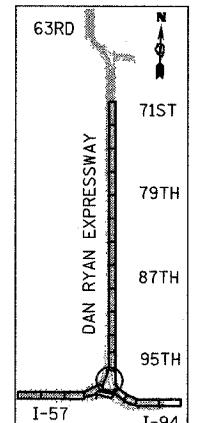

LOCATION MAP

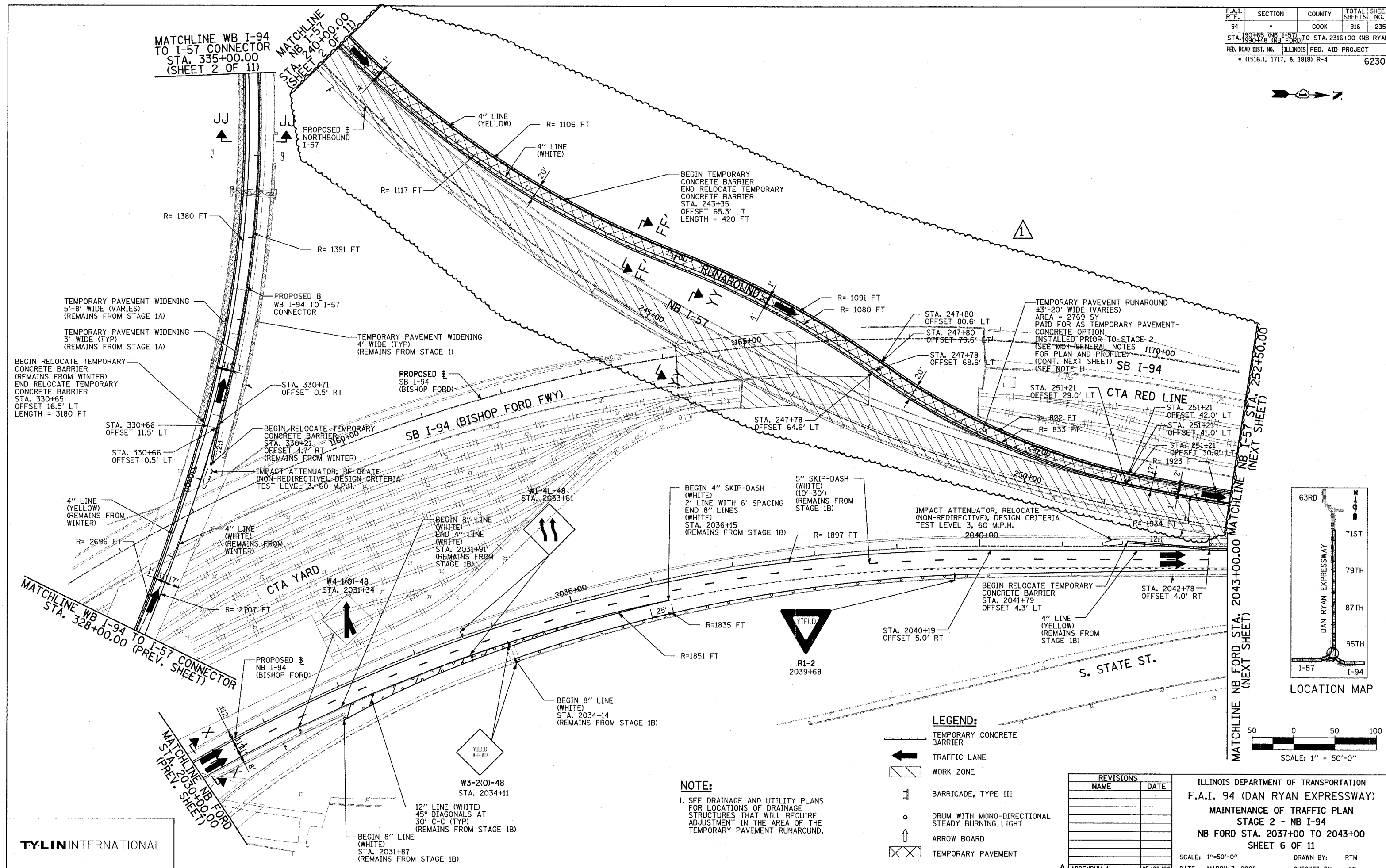
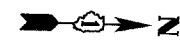
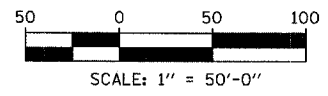

LEGEND:

- TEMPORARY CONCRETE BARRIER
- TRAFFIC LANE
- WORK ZONE
- BARRICADE, TYPE III
- DRUM WITH MONO-DIRECTIONAL STEADY BURNING LIGHT
- ARROW BOARD
- TEMPORARY PAVEMENT

NOTE:

1. SEE DRAINAGE AND UTILITY PLANS FOR LOCATIONS OF DRAINAGE STRUCTURES THAT WILL REQUIRE ADJUSTMENT IN THE AREA OF THE TEMPORARY PAVEMENT RUNAROUND.

REVISIONS	
NAME	DATE

ILLINOIS DEPARTMENT OF TRANSPORTATION
F.A.I. 94 (DAN RYAN EXPRESSWAY)
MAINTENANCE OF TRAFFIC PLAN
STAGE 2 - NB I-94
NB FORD STA. 2037+00 TO 2043+00
SHEET 6 OF 11

SCALE: 1"=50'-0"
 DATE: MARCH 7, 2006
 DRAWN BY: RTM
 CHECKED BY: JDF

TYLIN INTERNATIONAL

ADDENDUM 1 05/08/06