

PROFILE SURVEYED \_\_\_\_\_ BY \_\_\_\_\_ DATE \_\_\_\_\_  
 GRADES CHECKED \_\_\_\_\_  
 E.M. NOTED \_\_\_\_\_  
 NO. \_\_\_\_\_ STRUCTURE NOTATIONS C/P/D \_\_\_\_\_  
 05/08/06  
 ADDENDUM 1

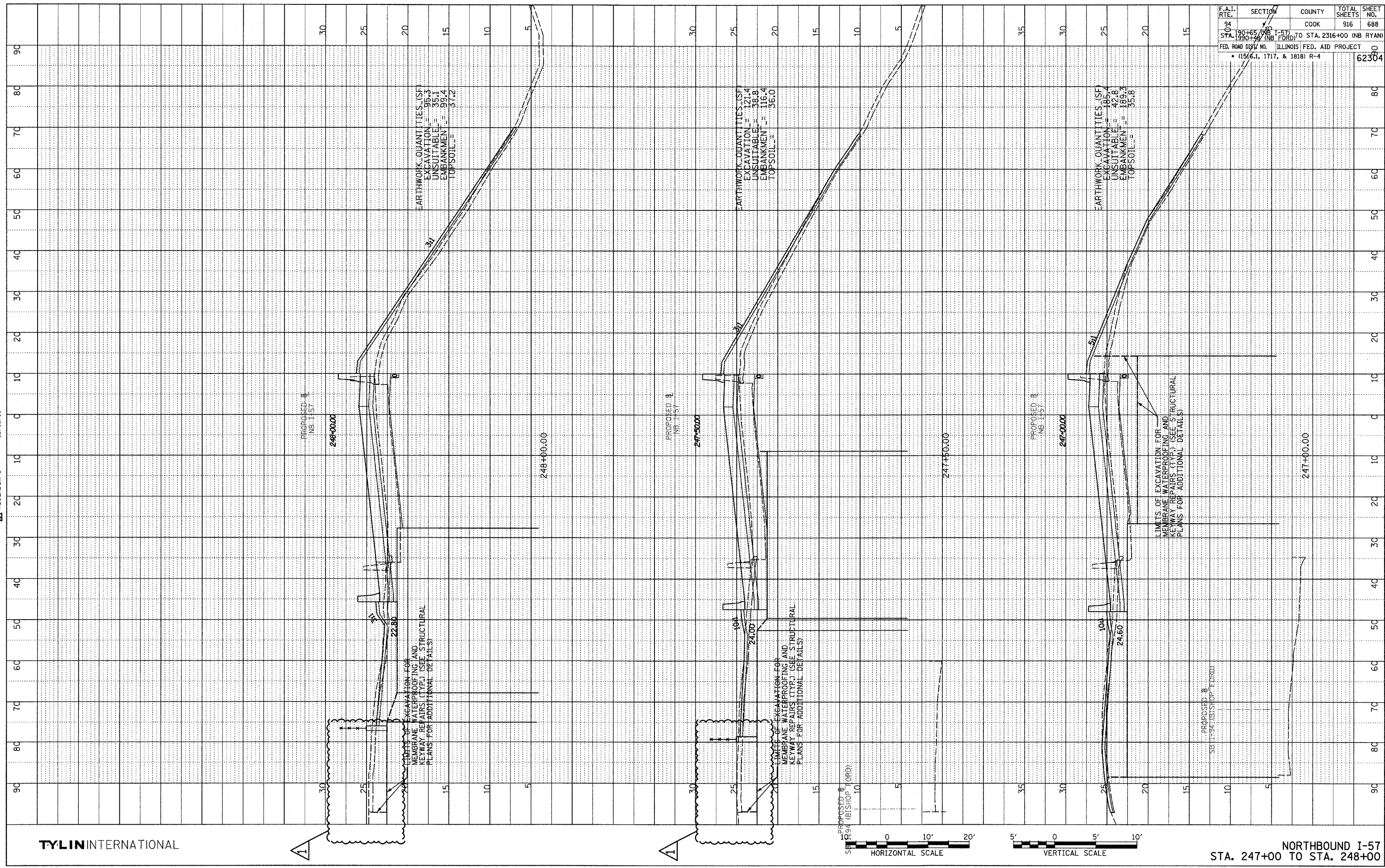

| F.A.I. RTE.                                    | SECTION                     | COUNTY | TOTAL SHEETS | SHEET NO. |
|--|-----------------------------|--------|--------------|-----------|
| 94   | 190+65 TO 2316+00 (NB I-57) | COOK   | 916          | 688       |
| 94   | 190+65 TO 2316+00 (NB I-57) | COOK   | 916          | 688       |
| ILLINOIS FED. AID PROJECT                      |                             |        |              | 62304     |
| FED. ROAD DIST. NO. (1516.1, 1717, & 1818) R-4 |                             |        |              |           |

TYLIN INTERNATIONAL

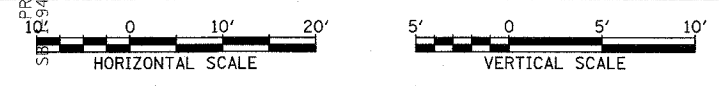

NORTHBOUND I-57  
 STA. 247+00 TO STA. 248+00

P:\0237\N\road\c20\gk\20\asst57.dgn 5/5/2006 5:42:28 PM