

| F.A.I. RTE. | SECTION | COUNTY | TOTAL SHEETS | SHEET NO. |
|-------------|---------|--------|--------------|-----------|
| 94          |         | COOK   | 916          | 78        |

STA. 190+65 (NB I-57) TO STA. 2316+00 (NB RYAN)  
 STA. 1990+48 (NB FORD)  
 FED. ROAD DIST. NO. ILLINOIS FED. AID PROJECT  
 (1516.1, 1717, & 1818) R-4 62304

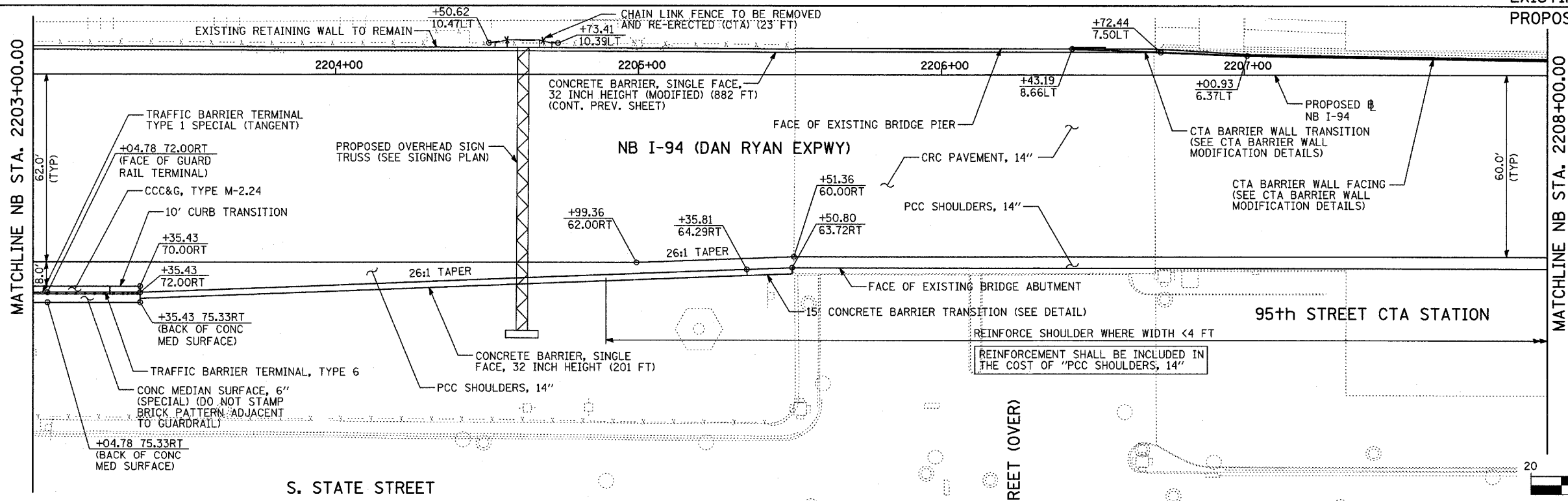

EXISTING CONDITIONS  
 PROPOSED IMPROVEMENTS

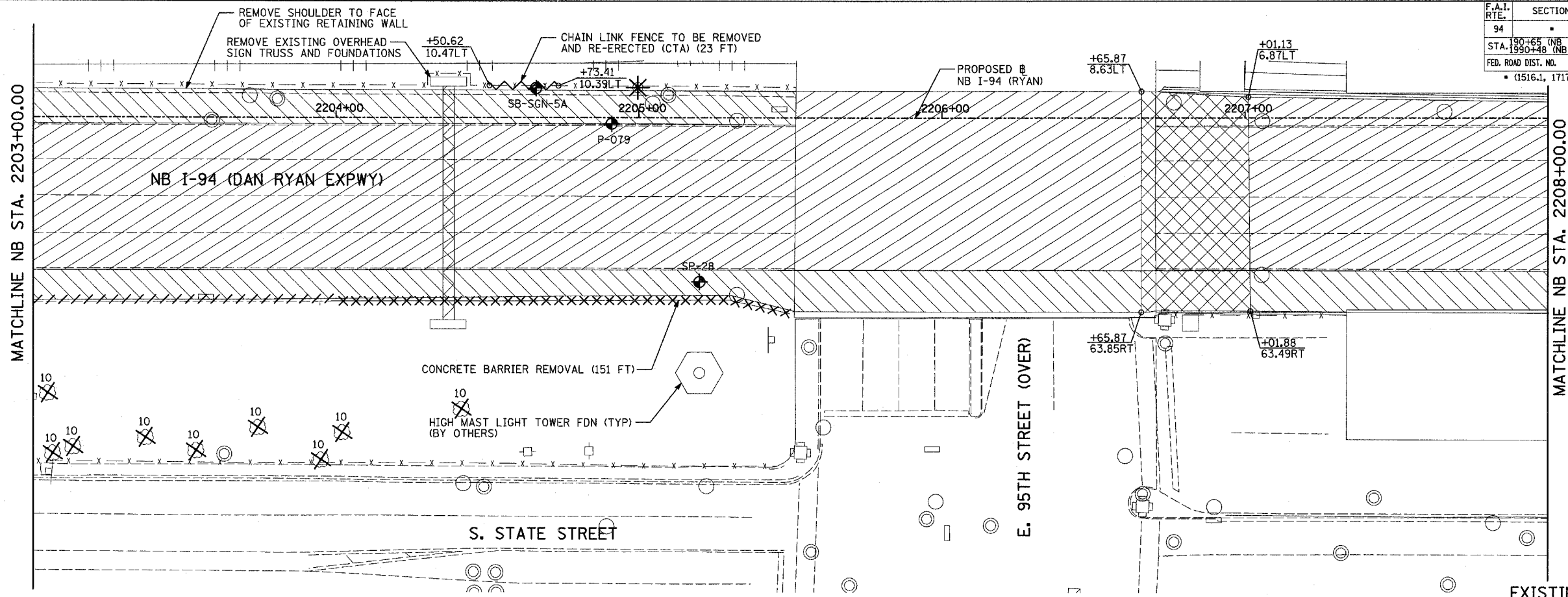
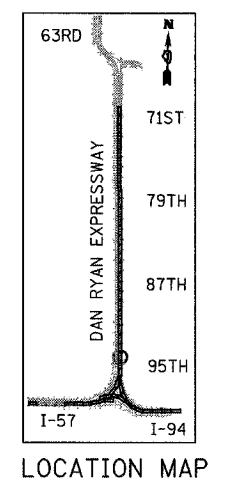

**LEGEND:**

- |       |  |         |   |
|-------|--|---------|---|
| ////  | COMB CONC CURB & GUTTER REMOVAL                            | ⊗       | LIGHT POLE FOUNDATION REMOVAL (SEE ROADWAY LIGHTING & SURVEILLANCE PLANS) |
| ~~~~  | CHAIN LINK FENCE REMOVAL                                   | +XX.XX  | MAINLINE B  |
| XXXXX | CONCRETE BARRIER/GUARDRAIL REMOVAL                         | XX.XXRT | STATION/OFFSET  |
| ⊗10   | TREE REMOVAL (UNITS) (NO UNIT SHOWN = <6)                  |         |   |
| ⊕     | SOIL BORING LOCATIONS                                      |         |   |
| ▨     | PAVEMENT REMOVAL   |         |   |
| ▧     | PAVED SHOULDER REMOVAL                                     |         |   |
| ▩     | PAVEMENT/SHOULDER REMOVAL, SPECIAL                         |         |   |
| ▪     | BITUMINOUS SURFACE REMOVAL, 4"                             |         |   |
| ▫     | BITUMINOUS SURFACE REMOVAL, 1 1/2" OR 1 3/4" (SEE CALLOUT) |         |   |

**PLAN NOTES:**

- ALL STATION/OFFSET/RADIUS CALLOUTS MEASURED TO EDGE OF PAVEMENT UNLESS OTHERWISE NOTED.
- EXACT LOCATIONS OF EXISTING PIERS/ABUTMENTS TO BE FIELD VERIFIED

**TYLIN INTERNATIONAL**

| REVISIONS |      |
|-----------|------|
| NAME      | DATE |
|           |      |
|           |      |
|           |      |
|           |      |
|           |      |
|           |      |

ILLINOIS DEPARTMENT OF TRANSPORTATION  
 F.A.I. 94 (DAN RYAN EXPRESSWAY)  
 EXISTING AND PROPOSED PLAN  
 NB I-57 AND I-94 (DAN RYAN EXPRESSWAY)  
 NB I-94 (RYAN) STA. 2203+00.00 TO  
 NB I-94 (RYAN) STA. 2208+00.00

SCALE: 1"=20'  
 DATE: MARCH 7, 2006  
 DRAWN BY: RTM  
 CHECKED BY: MPG