

F.A.I. RTE.	SECTION	COUNTY	TOTAL SHEETS	SHEET NO.
94		COOK	916	82
STA. 190+65 (NB I-57) TO STA. 2316+00 (NB RYAN)				
FED. ROAD DIST. NO. ILLINOIS FED. AID PROJECT				
(1516.1, 1717, & 1818) R-4 62304				

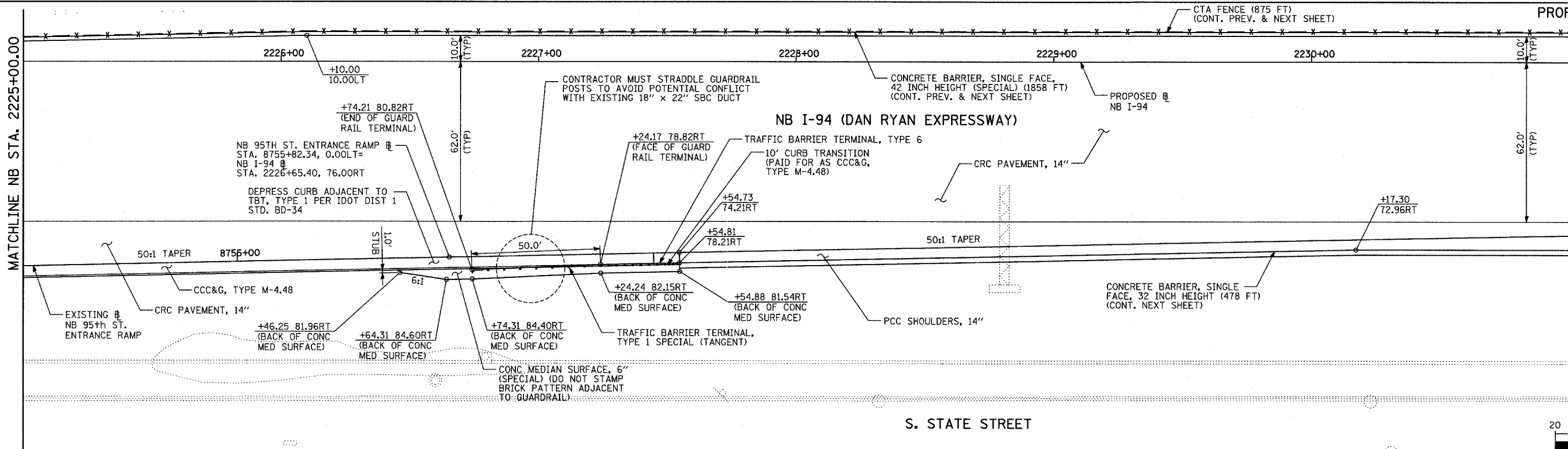

EXISTING CONDITIONS
PROPOSED IMPROVEMENTS

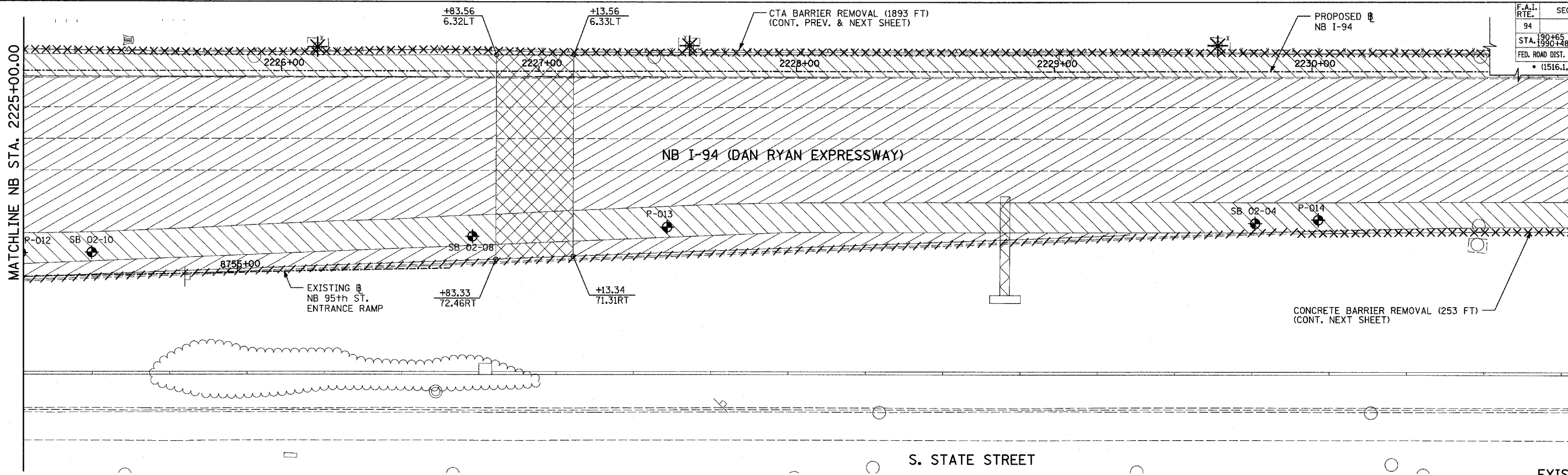
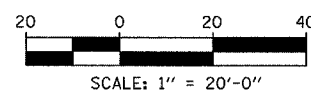
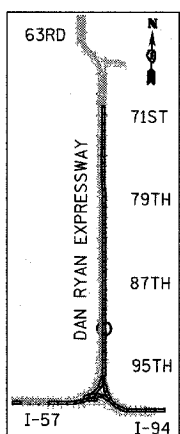

LEGEND:

- ==== COMB CONC CURB & GUTTER REMOVAL
- ~~~~ CHAIN LINK FENCE REMOVAL
- XXXXX CONCRETE BARRIER/GUARDRAIL REMOVAL
- ⊗10 TREE REMOVAL (UNITS) (NO UNIT SHOWN = 6)
- ⊕ SOIL BORING LOCATIONS

- [Hatched Box] PAVEMENT REMOVAL
- [Diagonal Lines Box] PAVED SHOULDER REMOVAL
- [Cross-hatched Box] PAVEMENT/SHOULDER REMOVAL, SPECIAL
- [Horizontal Lines Box] BITUMINOUS SURFACE REMOVAL, 4"
- [Vertical Lines Box] BITUMINOUS SURFACE REMOVAL, 1/2" OR 1 1/4" (SEE CALLOUT)

- ⊗ LIGHT POLE FOUNDATION REMOVAL (SEE ROADWAY LIGHTING & SURVEILLANCE PLANS)
 - +XX.XX MAINLINE #
 - XX.XXRT STATION/OFFSET
- PLAN NOTES:**
- ALL STATION/OFFSET/RADIUS CALLOUTS MEASURED TO EDGE OF PAVEMENT UNLESS OTHERWISE NOTED.
 - EXACT LOCATIONS OF EXISTING PIERS/ABUTMENTS TO BE FIELD VERIFIED

TYLIN INTERNATIONAL

REVISIONS	
NAME	DATE

ILLINOIS DEPARTMENT OF TRANSPORTATION
F.A.I. 94 (DAN RYAN EXPRESSWAY)
EXISTING AND PROPOSED PLAN
NB I-94 (DAN RYAN EXPRESSWAY)
NB I-94 STA. 2225+00.00 TO 2231+00.00

SCALE: 1"=20'
DATE: MARCH 7, 2006

DRAWN BY: RTM
CHECKED BY: MPG