

F.A.I. RTE.	SECTION	COUNTY	TOTAL SHEETS	SHEET NO.
94		COOK	916	101
STA. 190+65 (NB I-57) TO STA. 2316+00 (NB RYAN)				
FED. ROAD DIST. NO. ILLINOIS FED. AID PROJECT				
• (1516.1, 1717, & 1818) R-4				
				62304

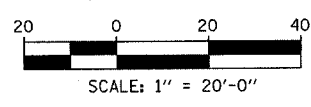
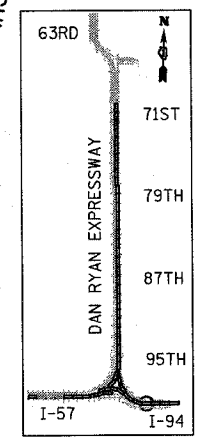
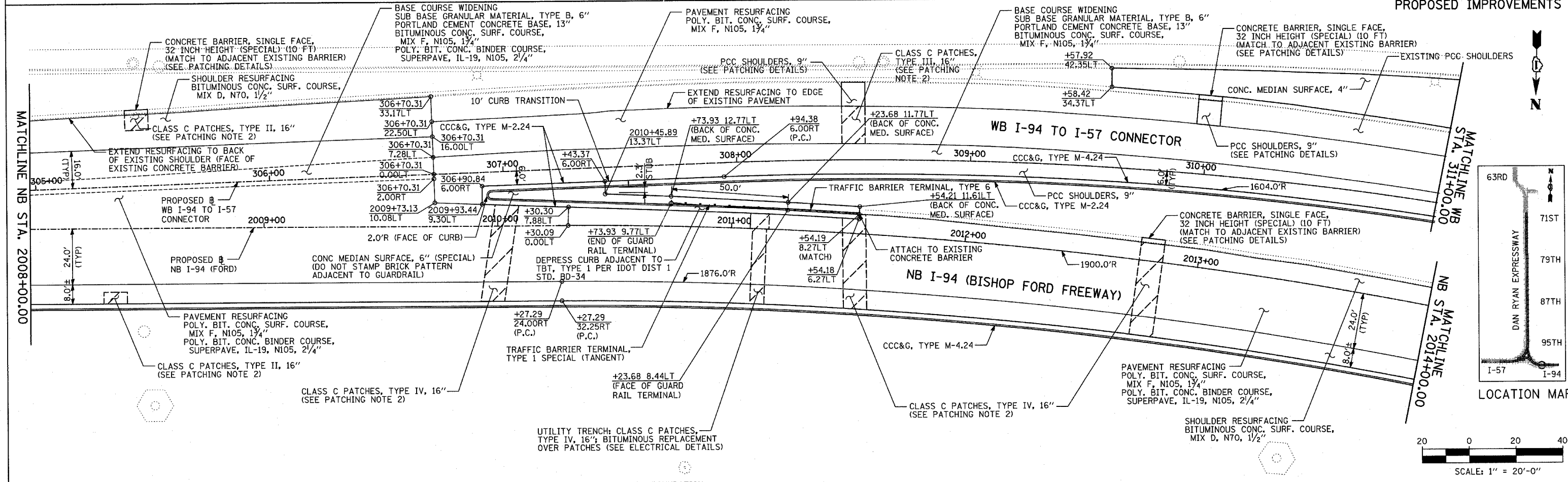
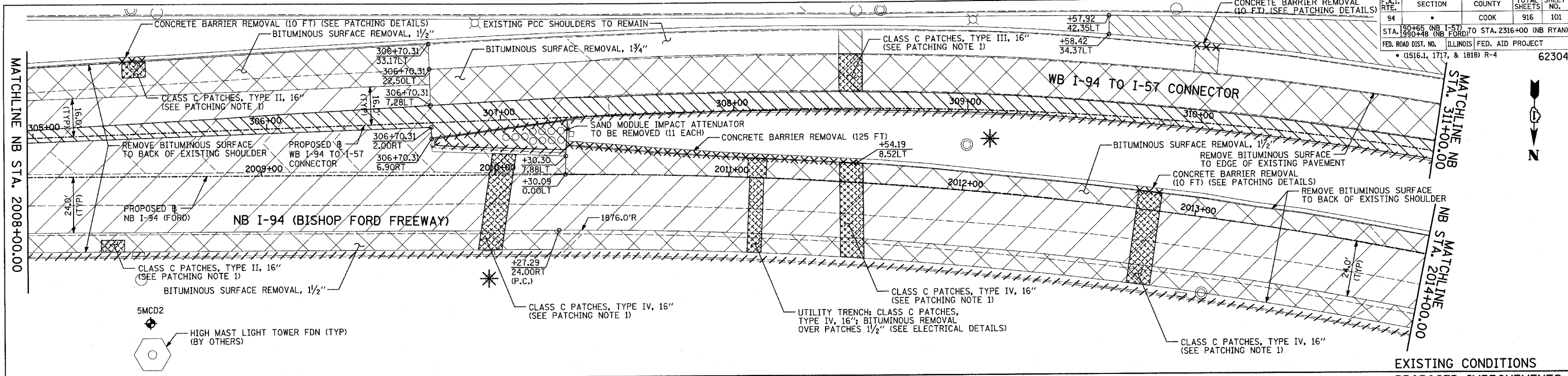

**LEGEND:**

- ////// COMB CONC CURB & GUTTER REMOVAL
- ~~~~~ CHAIN LINK FENCE REMOVAL
- XXXXXX CONCRETE BARRIER/GUARDRAIL REMOVAL
- ⊗10 TREE REMOVAL (UNITS) (NO UNIT SHOWN = <6)
- ⊕ SOIL BORING LOCATIONS
- ▨ PAVEMENT REMOVAL
- ▧ PAVED SHOULDER REMOVAL
- ▩ PAVEMENT/SHOULDER REMOVAL, SPECIAL
- BITUMINOUS SURFACE REMOVAL, 4"
- ▬ BITUMINOUS SURFACE REMOVAL, 1/2" OR 1 1/4" (SEE CALLOUT)
- ⊙ LIGHT POLE FOUNDATION REMOVAL (SEE ROADWAY LIGHTING & SURVEILLANCE PLANS)
- +XX.XX MAINLINE #
- XX.XXRT STATION/OFFSET

**PLAN NOTES:**

- ALL STATION/OFFSET/RADIUS CALLOUTS MEASURED TO EDGE OF PAVEMENT UNLESS OTHERWISE NOTED.
- EXACT LOCATIONS OF EXISTING PIERS/ABUTMENTS TO BE FIELD VERIFIED

**PATCHING NOTES:**

1. SEWER TRENCH: CLASS C PATCHES, TYPE VARIES, 16"; BITUMINOUS REMOVAL OVER PATCHES 1/2"; (SEE MISCELLANEOUS DETAILS)
2. SEWER TRENCH: CLASS C PATCHES, TYPE VARIES, 16"; BITUMINOUS REPLACEMENT OVER PATCHES, (SEE MISCELLANEOUS DETAILS)

REVISIONS	
NAME	DATE

ILLINOIS DEPARTMENT OF TRANSPORTATION  
**F.A.I. 94 (DAN RYAN EXPRESSWAY)  
 EXISTING AND PROPOSED PLAN  
 NB I-94 (BISHOP FORD FREEWAY)  
 NB STA. 2008+00.00 TO 2014+00.00  
 AND WB STA. 311+00.00**

SCALE: 1"=20'  
 DATE: MARCH 7, 2006  
 DRAWN BY: RTM  
 CHECKED BY: MPG

**TYLIN INTERNATIONAL**