

F.A. RTE.	SECTION	COUNTY	TOTAL SHEETS	SHEET NO.
	1516.1, 1717 & 1818-6	Cook	916	403
STA.	TO STA.			
FED. ROAD DIST. NO.	ILLINOIS	FED. AID PROJECT		

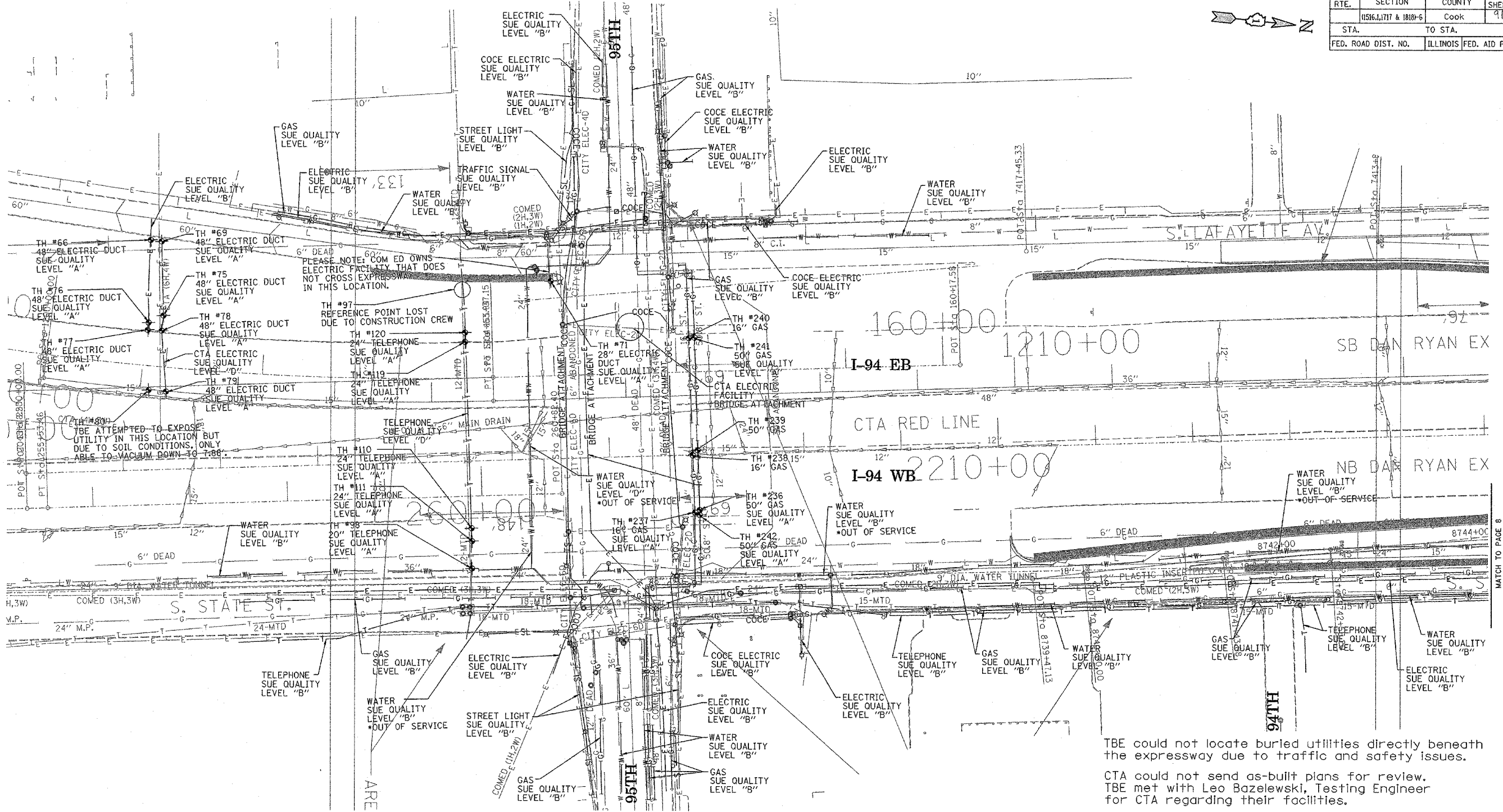
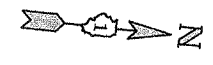

PLEASE NOTE: COM ED OWNS ELECTRIC FACILITY THAT DOES NOT CROSS EXPRESSWAY IN THIS LOCATION.

REFERENCE POINT LOST DUE TO CONSTRUCTION CREW

TBE ATTEMPTED TO EXPOSE UTILITY IN THIS LOCATION BUT DUE TO SOIL CONDITIONS, ONLY ABLE TO VACUUM DOWN TO 7-88.

TBE could not locate buried utilities directly beneath the expressway due to traffic and safety issues.

CTA could not send as-built plans for review. TBE met with Leo Bazelewski, Testing Engineer for CTA regarding their facilities.

Size given for Electric Duct is width only.

\*At the time of Quality Level "B" SUE services, the water lines were active. The lines, however, are now expected to be out of service per IDOT.

**TBE GROUP, INC.**  
 CIVIL ENGINEERING \* TRANSPORTATION \* ENVIRONMENTAL  
 \* PLANNING \* UTILITY ENGINEERING/LOCATING  
 SOUTHERN REGION: FL, GA, SC, NC  
 NORTHERN REGION: IL, IN, MI, OH, MD, NJ, NY  
 PA, VA, CANADA  
 WESTERN REGION: AZ, NV, NM, TX, CA, OR, UT, WA

IL09500164, 167, 168, 170, 171, 179, 180, 182, 204, 205, 206, 211, 212, 219, 221, 225, 226, 227, 228, 230, 232, 235, 237, 248, 249  
 TBE SUE PAGE NO: 7 of 36  
 Checked by: *Sandra Resero*  
 SUE Quality Level "A" : Test Holes  
 SUE Quality Level "B" : Designating

—TS—	—TS—	TRAFFIC SIGNAL
—SL—	—SL—	STREET LIGHT
—COCE—	—COCE—	CITY OF CHICAGO ELECTRIC
—T—	—T—	TELEPHONE
—W—	—W—	WATER
—G—	—G—	GAS
—CTV—	—CTV—	CABLE TELEVISION
—FO—	—FO—	FIBER OPTIC
—E—	—E—	ELECTRIC
●	●	TEST HOLE

Utilities shown on these plans as depicted in the legend have been investigated by TBE Group, Inc in accordance with SUE Industry Standards. All other information shown has been provided to TBE Group, Inc by others.

205 W. WACKER DRIVE  
 SUITE 1020  
 CHICAGO, IL 60606  
 (312) 704-1970

REVISIONS	
NAME	DATE
ADDITIONAL TBE TH'S	2/06/06

ILLINOIS DEPARTMENT OF TRANSPORTATION  
 SUE Investigation of Underground Utilities  
 I-94 NB & SB of Dan Ryan Expressway  
 From I-57 to 43rd Street  
 Contract No: 62586, 62589, 62590, 62594, 62693  
 SQL "A" DATE : 2/17/05  
 SQL "B" DATE : 7/22/04  
 DRAWN BY : KLC  
 SCALE : 1" = 50'

MATCH TO PAGE 8