

F.A.I. RTE.	SECTION	COUNTY	TOTAL SHEETS	SHEET NO.
94		COOK	916	475
STA. 190+65 (NB I-57) TO STA. 2316+00 (NB RYAN)				
STA. 1990+48 (NB FORD) TO STA. 2316+00 (NB RYAN)				
FED. ROAD DIST. NO. ILLINOIS FED. AID PROJECT				
• (1516.1, 1717, & 1818) R-4				
				62304

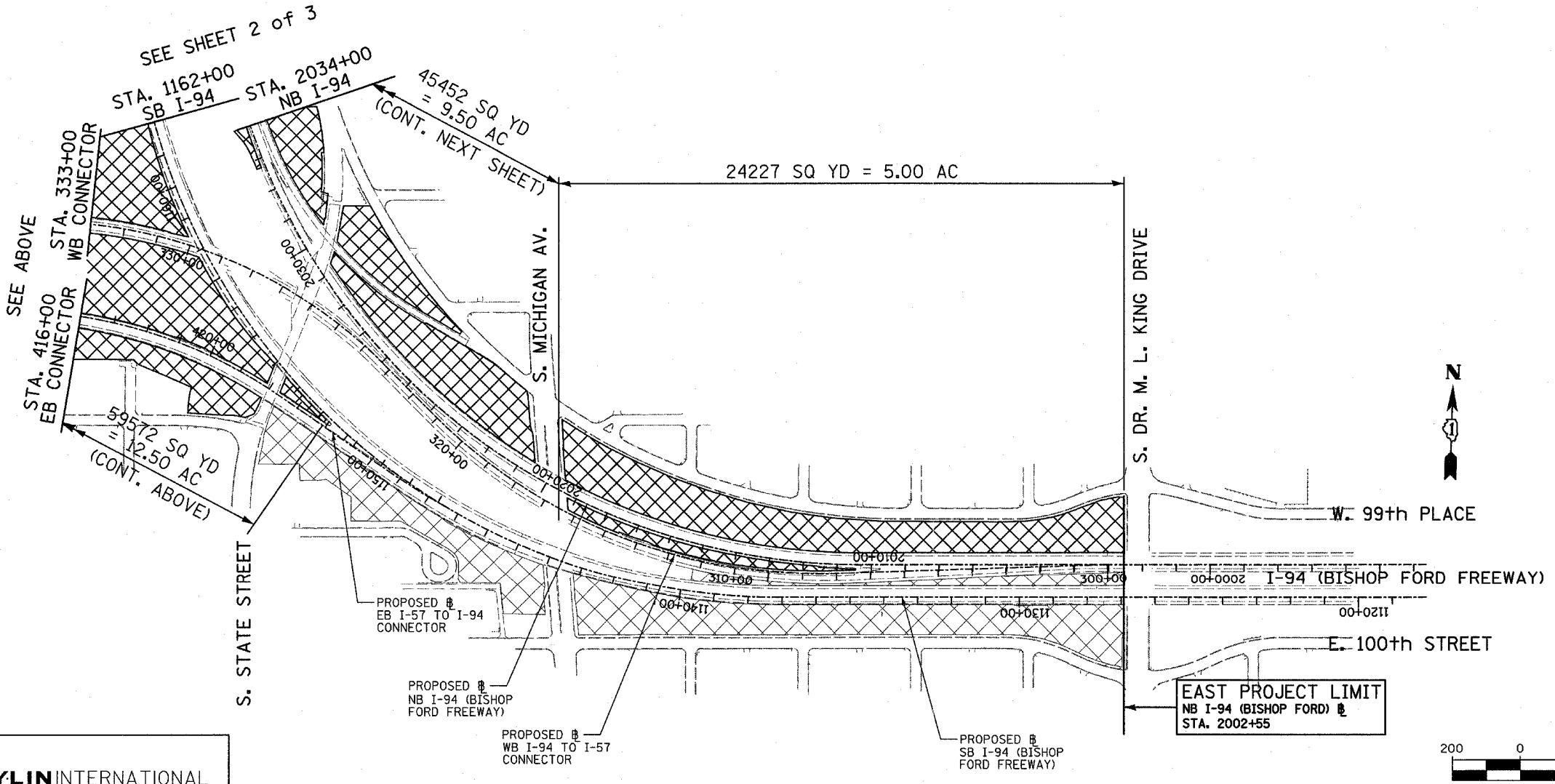

- LEGEND**
- MOWING AREAS THIS CONTRACT
  - MOWING AREAS CONTRACTS 62593 & 60B18
- NOTES**
- COORDINATE MOWING IN INTERCHANGE WITH CONTRACT 62593

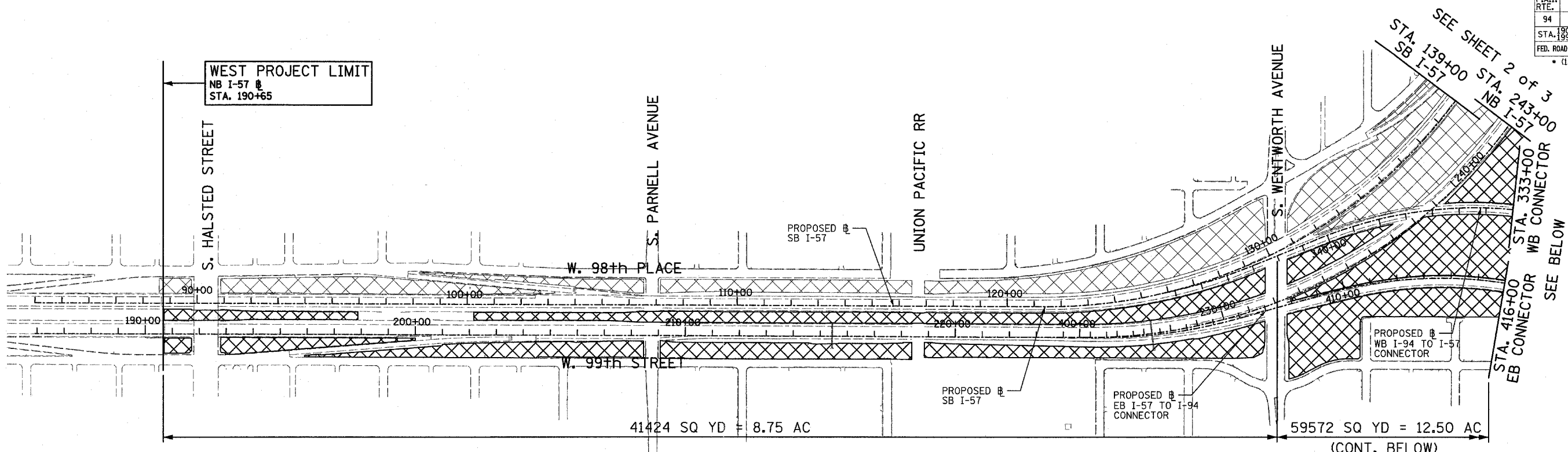
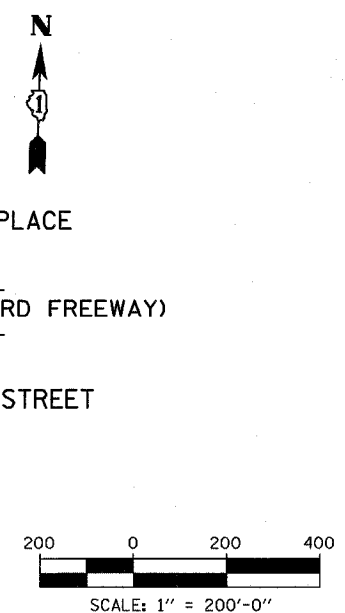

REVISIONS	
NAME	DATE

ILLINOIS DEPARTMENT OF TRANSPORTATION  
F.A.I. 94 (DAN RYAN EXPRESSWAY)

MOWING AREAS  
SHEET 1 OF 3

SCALE: 1"=200'-0"  
DATE: MARCH 7, 2006

DRAWN BY: RTM  
CHECKED BY: MPG

TYLIN INTERNATIONAL