

F.A.I. RTE.	SECTION	COUNTY	TOTAL SHEETS	SHEET NO.
94	*	COOK	916	504
STA. 2024+00		TO STA. 2010+85		
FED. ROAD DIST. NO.		ILLINOIS FED. AID PROJECT		
* (1516.I, 1717, & 1818) R-4		62304		

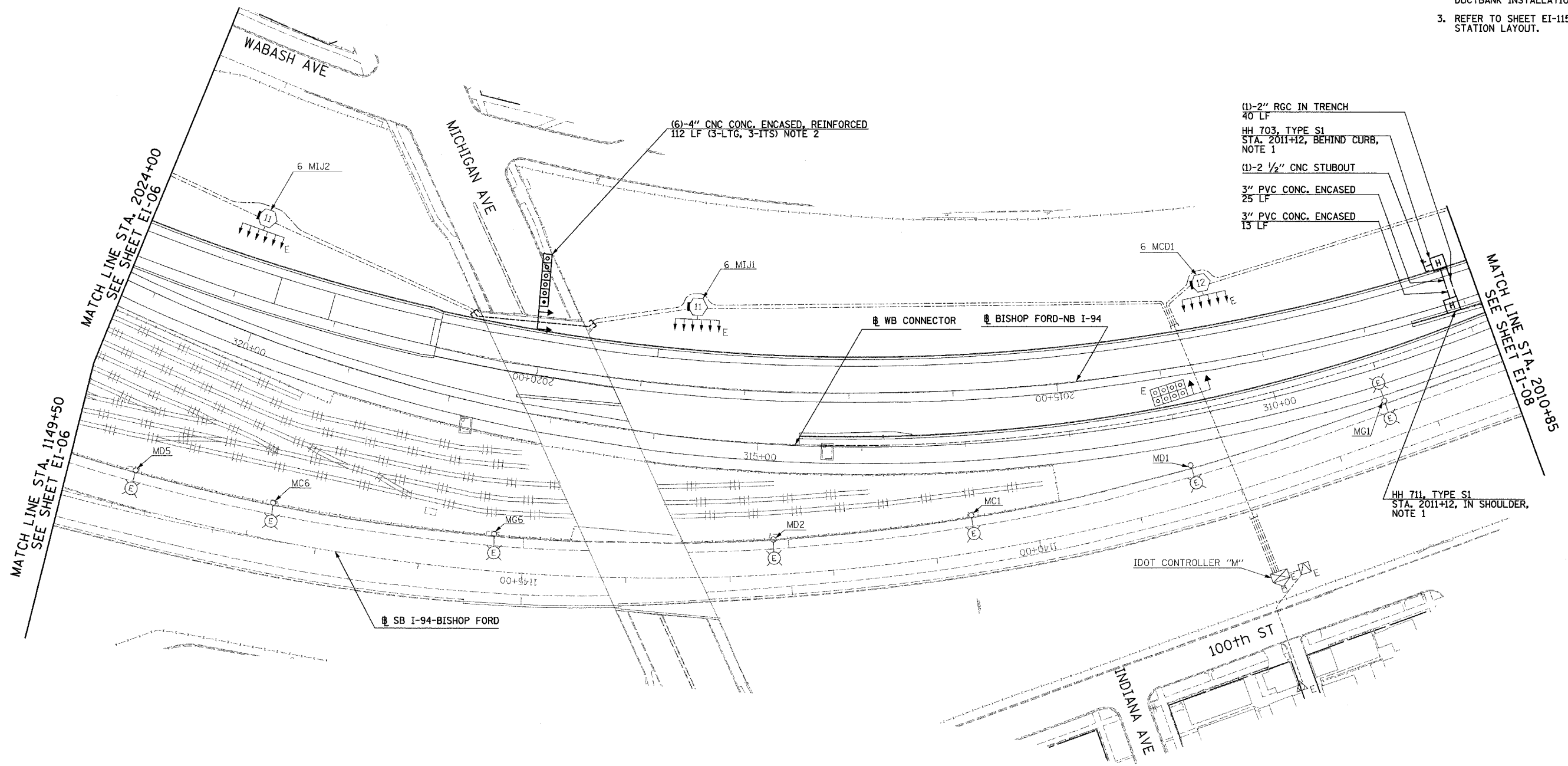

NOTES:

1. REFER TO SHEET EI-106 FOR HANDHOLE DETAILS. INSTALL HH 703 AS SHOWN ON SHEET EI-110.
2. REFER SHEET EI-102 AND EI-103 FOR DUCTBANK INSTALLATION DETAILS.
3. REFER TO SHEET EI-115 FOR DETECTOR STATION LAYOUT.



- (1)-2" RGC IN TRENCH
40 LF
- HH 703, TYPE S1
STA. 2011+12, BEHIND CURB,
NOTE 1
- (1)-2 1/2" CNC STUBOUT
- 3" PVC CONC. ENCASED
25 LF
- 3" PVC CONC. ENCASED
13 LF

MATCH LINE STA. 1149+50
SEE SHEET EI-06

MATCH LINE STA. 2024+00
SEE SHEET EI-06

MATCH LINE STA. 2010+85
SEE SHEET EI-06

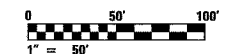

20/EI-07

SINGH
SINGH & ASSOCIATES, INC.
CONSULTING ENGINEERS

300 W. ADAMS ST.
CHICAGO, IL 60606
TEL: (312) 629-0240
FAX: (312) 629-8449

REVISIONS	
NAME	DATE

ILLINOIS DEPARTMENT OF TRANSPORTATION
F.A.I. 94 (DAN RYAN EXPRESSWAY)

ELECTRICAL INFRASTRUCTURE PLANS
PROPOSED IMPROVEMENTS
STA. 2024+00 TO STA. 2010+85

SCALE: 1"=50' DRAWN BY: VK
DATE: MARCH 7, 2006 CHECKED BY: TM

J:\715\sgn\7021753b.dwg 3/7/2006 1:44:49 PM